

advanced FLOW engineering inc.

Stage 2

Instruction Manual P/N: 51-11862 & 54-11862

Make: **BMW** Model: **3 Series E90/91/92/93** Year: **2006-2010** Engine: **L6-3.0L**



- Please read the entire instruction manual before proceeding.
- Ensure all components listed are present.
- If you are missing any of the components, call customer support at 951-493-7100.
- Ensure you have all necessary tools before proceeding.
- Do not attempt to work on your vehicle when the engine is hot.
- Disconnect the negative battery terminal before proceeding.
- Retain factory parts for future use.

Label	Qty.	Description	Part Number
A1	1	Pro Dry S Air Filter	21-60507 Grey Media (Included in 51-11862)
A2	1	Pro 5R Air Filter	24-60507 Blue Media (Included in 54-11862)
B	1	Housing	05-00746
C	1	Air Intake Tube	05-00769
D	1	Bracket	05-01115
E	1	Filter Adaptor	05-00676
F	1	Cover	05C00746
G	1	Tube Gasket	05-00075
H	1	Straight Coupling	05-00307
I	2	Clamp 056	03-50009
J	2	M4 Screws	03-50030
K	3	Button Head Screw	03-50113
L	4	M6 Hex Head Screw	03-50114
M	5	M6 Flat Washer	03-50070
N	1	M6 Nut	03-50059
O	4	M6 Wavy Washer	03-50058
P	1	MAS Gasket	05-00118

Installation will require the following tools:

4mm Hex Key, 7/16" Socket, 5/16" Socket or Nut Driver, T25 Torx Bit, Ratchet, Extension, Phillips & Flat-Head Screw Driver

Note: Legal in California for use on race vehicles only. The use of this device on vehicles used on public streets or highways is strictly prohibited in California and others states that have adopted California emission regulations.

B

C

D

E

F



G



H



I



J

K

L

M

N

O

P



A1



A2



OR



J

K

L

M

N

O



Refer to Figure A for steps 1-4

Step 1: Remove the air filter housing mounting bolts (2) ①

Step 2: Disconnect the wiring harness from the MAF sensor ②

Step 3: Loosen the hose clamp securing the intake tube to the throttle body

Step 4: Remove the entire air filter housing, intake tube and mounting bushing from the vehicle ③

**Figure B****Refer to Figure B for steps 5-8**

Step 5: Remove the active steering reservoir mounting bolts ①

Step 6: Remove the reservoir mounting bracket nuts ②

Step 7: Replace the factory reservoir mounting bracket with the supplied aFe bracket ④

Step 8: Secure the active steering reservoir to the aFe bracket using the bolts removed in the previous step

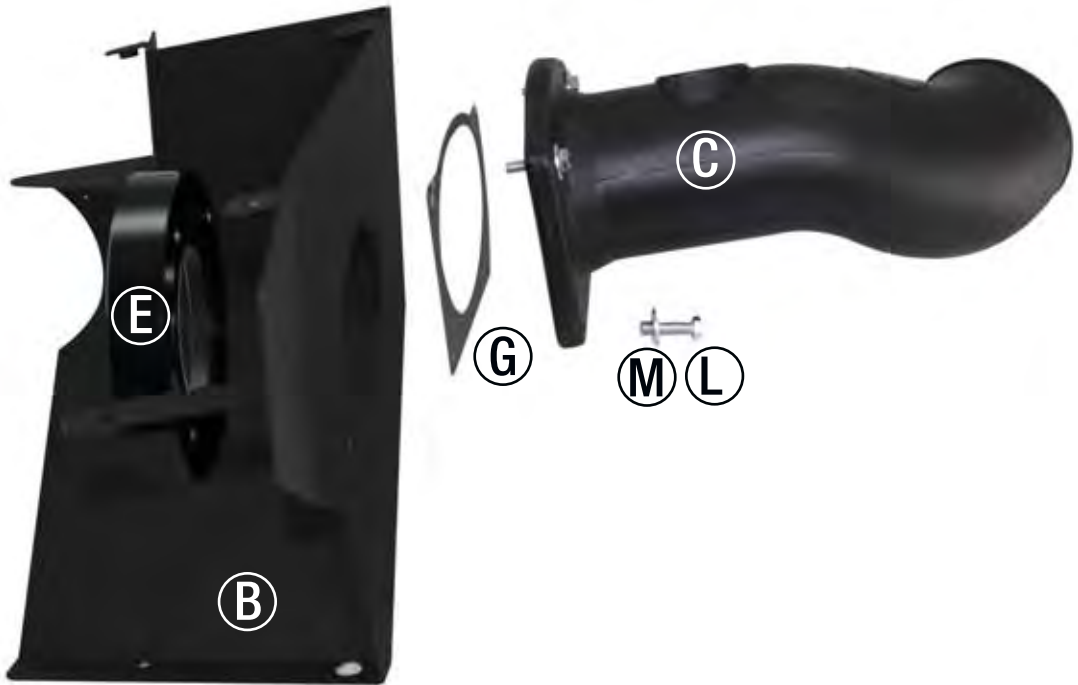
**Figure C****Refer to Figure C for step 9**

Step 9: Attach the aFe intake tube (C) to the housing (B) using the supplied hardware (M)(L) gasket (G) and filter adapter (E). The gasket should be positioned between the intake tube and the air filter housing. (Note the orientation of the tube bolt pattern)



Figure D

Refer to Figure D for steps 10

Step 10: Remove the MAF sensor from the factory air filter housing ①

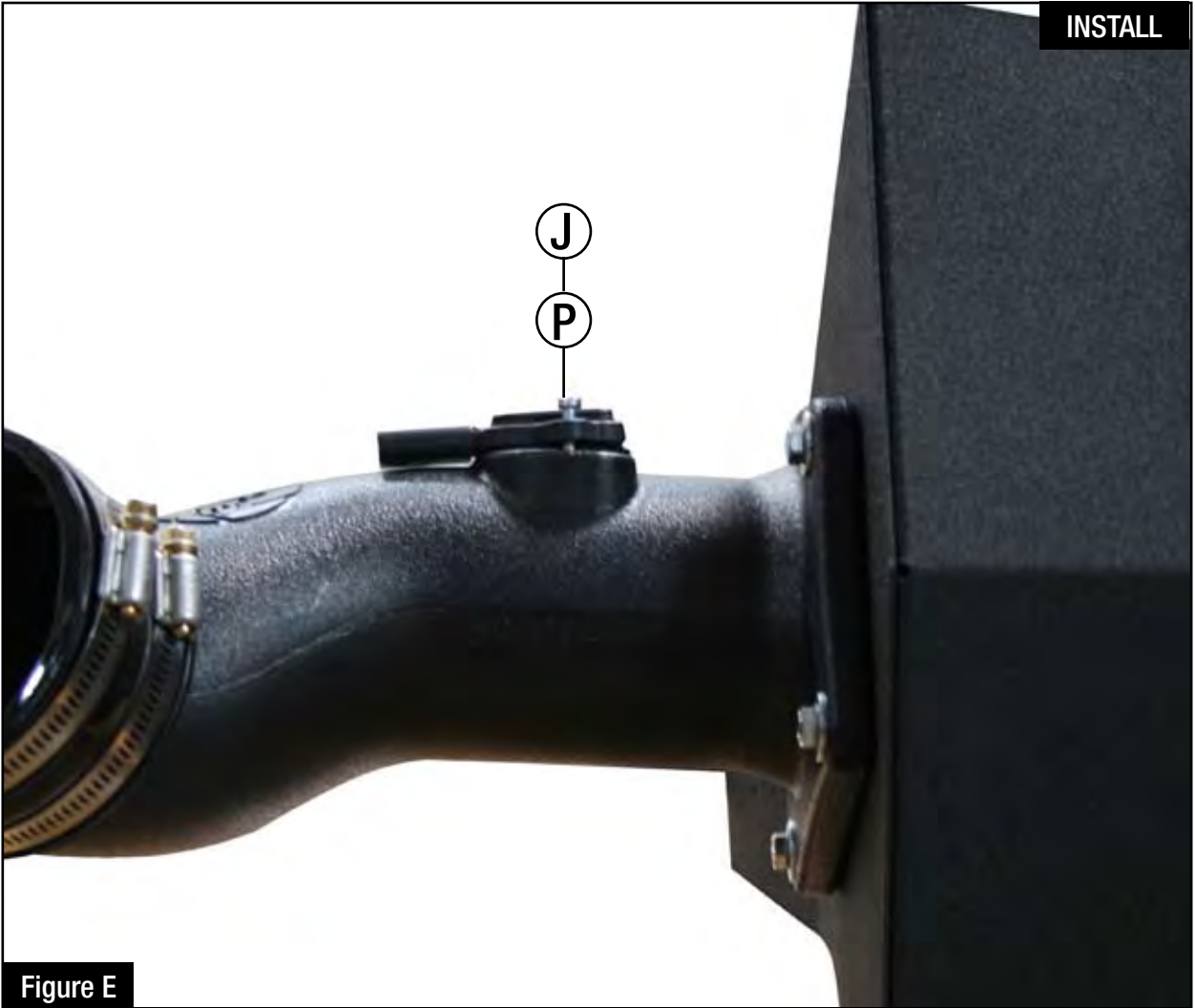

Figure E

Refer to Figure E for step 11

Step 11: Using the supplied gasket (P) and screws (J), install the MAF sensor in the aFe intake tube



Figure F

Refer to Figure F for step 12

Step 12: Loosely install the urethane coupler (H) with clamps (I) on the throttle body elbow



Figure G

Refer to Figure G for step 13

Step 13: Install the aFe intake assembly in the vehicle

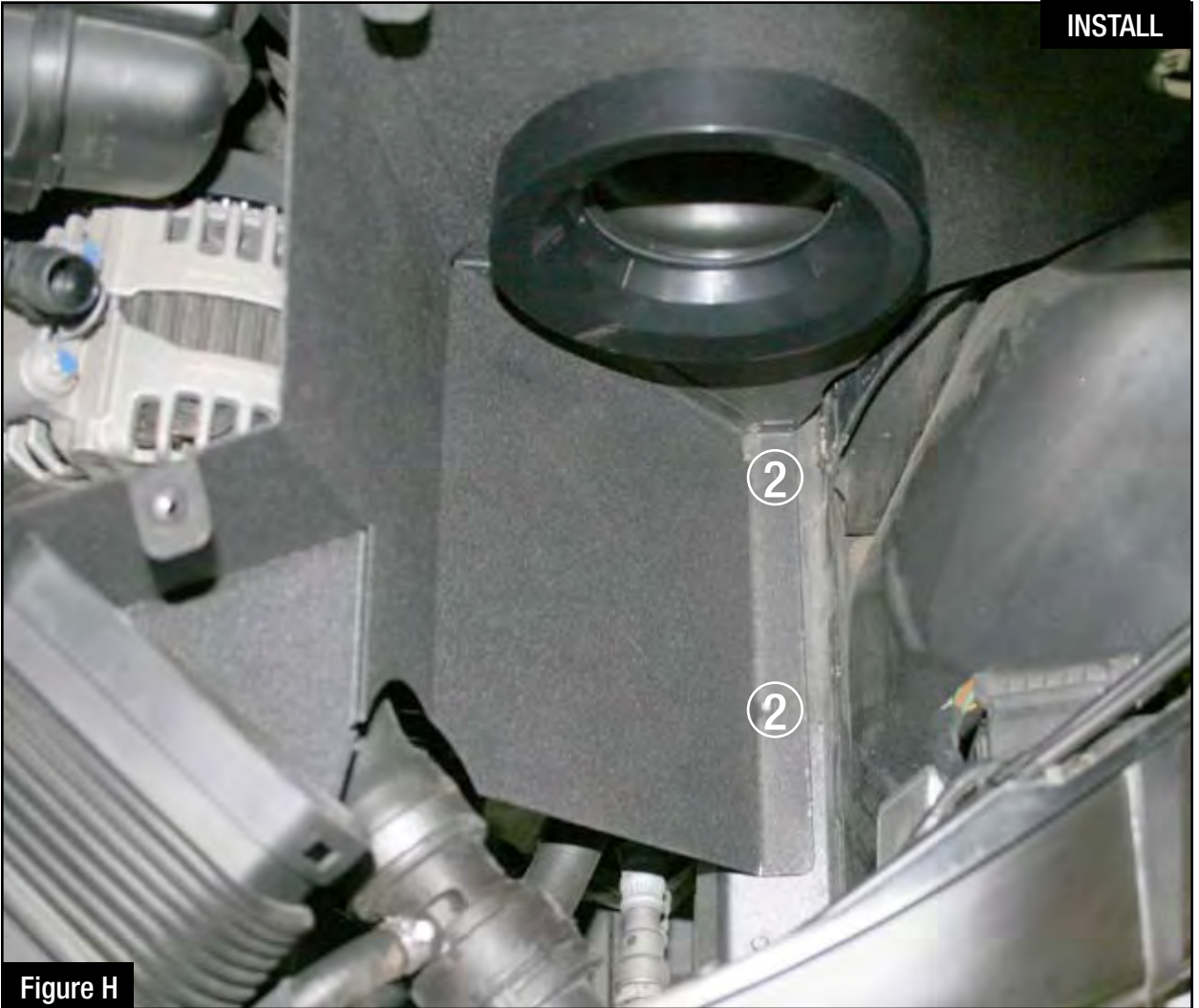

Figure H

Refer to Figure G and H for step 14

Step 14: Secure the housing to the vehicle using the three mounting points ②



Figure I

Refer to Figure I for steps 15-17

Step 15: Tighten both clamps on the urethane coupling

Step 16: Install the air filter (A) on the filter adapter and tighten the clamp

Step 17: Connect the wiring harness to the MAF sensor



Figure J

Refer to Figure J for steps 18-19

Step 18: Install the filter cover (F) and secure with supplied button head screws (K)

Step 19: Your installation is now complete. Verify all clamps are secure and re-check periodically



Pro DRY S Air Filter



P/N: 21-60507

Pro 5R Air Filter



P/N: 24-60507

Pre-Filters



P/N: 28-10111 Yellow
P/N: 28-10112 Red
P/N: 28-10113 Black
P/N: 28-10114 Blue

Pro DRY S Restore Kit



P/N: 90-59999

Blue Aerosol Restore Kit



P/N: 90-50001

Blue Squeeze Restore Kit



P/N: 90-50501

aFe Power Hat



P/N: 40-10083

aFe Key Chain



P/N: 40-10103

To purchase any of the items above, view airflow charts, dyno graphs, photos, and video; please go to aFepower.com.

Limited Warranty

aFe warrants their intake systems to be free of defects from workmanship and materials for a period of two (2) years, provided the intake system was: A) installed in an aFe recommended application according to aFe installation instructions; and B) the air filter has been properly cleaned utilizing an aFe cleaning solution and oil (not applicable on Pro DRY S filters). Damage from abuse, improper cleaning, improper oil and improper installation or from open flame is not covered by this limited warranty. In the event of a defect of an aFe product within the period covered by this limited warranty, the purchaser can return the product to the dealer where it was purchased or send the product to aFe at the address listed on the back after obtaining a Return Good Authorization (RGA) number from aFe. The original register receipt will be required as proof of purchase. Purchaser will be entitled to a refund of the entire purchase price or a replacement of the product at aFe's discretion. Purchaser shall be responsible for the cost of shipping the defective product to aFe. An RGA number can be obtained by calling aFe customer service. Products shipped without an RGA number will be refused. A refund or replacement of the product shall be the sole remedy available under this limited warranty and aFe shall not be responsible for consequential or incidental damages. (Some states do not allow this exclusion or limitation of incidental or consequential damages, so the above limitation or exclusion may not apply). This warranty gives you specific legal rights, and you may have other rights which vary from state to state.

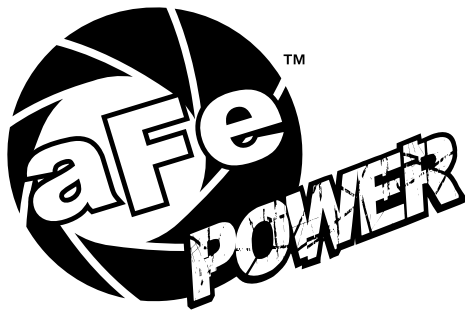

advanced FLOW engineering, inc.

252 Granite Street Corona, CA 92879

TEL: 951.493.7100 • TECH: 951.493.7100 x23

E-Mail: Tech@aFepower.com

P/N: 06-80356