



## INSTALLATION INSTRUCTIONS

MAKE: GM  
MODEL: HUMMER H2  
YEAR: 2003-2006  
ENGINE: V8-6.0L



Dual 3" Cat-Back (409SS)  
49-44010

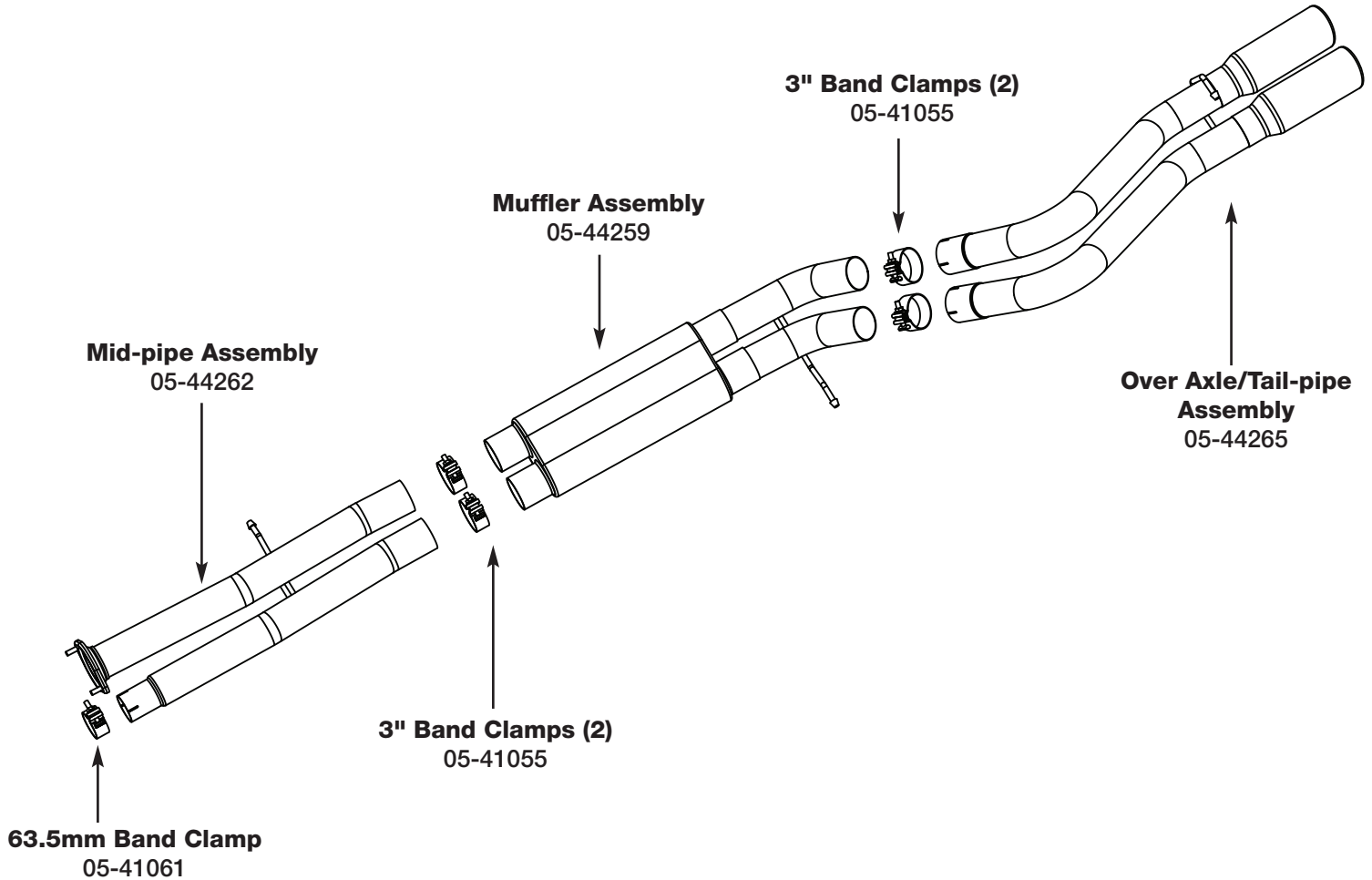

**Step 1: (Read Instructions prior to installation)** Remove your stock exhaust from the rear of your truck working your way forward, it will be necessary to cut the stock exhaust at a convenient location due to its length. Take caution not to damage the factory isolation mounts as they will be reused. **It is recommended to not fully tighten the clamps until the entire system has been installed.**

**Step 2:** For ease of installation spread the pieces of the exhaust along side of your vehicle according to the diagram shown.

**Step 3:** Install mid-pipe assembly. Re-use factory flange nuts and new 63.5mm band clamp. Do not fully tighten.

**Step 4:** Install muffler assembly with 3" band clamps. Do not fully tighten

**Step 5:** Install the over-axle tailpipe assembly with 3" band clamps, utilizing the factory isolation mounts. Do not fully tighten.

**Step 6:** Adjust for alignment and tighten all connections. Your installation is now complete. It is recommended to re-tighten all exhaust components after the first 50-100 miles.

### NOTE:

- aFe recommends that the tailpipe be at least 1/2"-1" away from any body panels to avoid heat related body damage. **Tighten and secure.**

**Caution:** Allow time for your vehicle to cool down prior to installation. When working on or under your vehicle proceed with caution. Exhaust systems reach high temperatures and may cause serious burns. Wear protective safety equipment; eye goggles and gloves to ensure a safe installation. aFe recommends professional installation on our products.