

AIR AID®

INTAKE SYSTEMS



Installation Instructions
Part Number: 300-190 Intake Kit
2006 Dodge Ram
5.7L Hemi V-8

Packing List:

#1	700-445	Airaid Premium Filter	1
#2	KIT192DC	Cool Air Dam	1
#3	KIT924T	Modular Intake Tube	1
#4	KITHUMPHS01	Silicone Hump Hose	1
#5	KITRDCR04	Reducing Coupler	1
#6	KITWSTRIP02	Weather Strip 32 3/4"	1
	KIT190HP	Hardware & Instructions	1
#7	KIT106CAP	Black Rubber Cap	1
#8	KITHS52	#52 Hose Clamp	2
#9	KITHS56	#56 Hose Clamp	2
#10	KITSNP14M4	#14 Speed Clamp	1
#11	KITSNP24GHS	#24 Speed Clamp	1
#12	KITGRMT02	Rubber Grommet	1

Tools Required For Installation:

5/16" Socket & 10mm Socket
 Ratchet & Extension

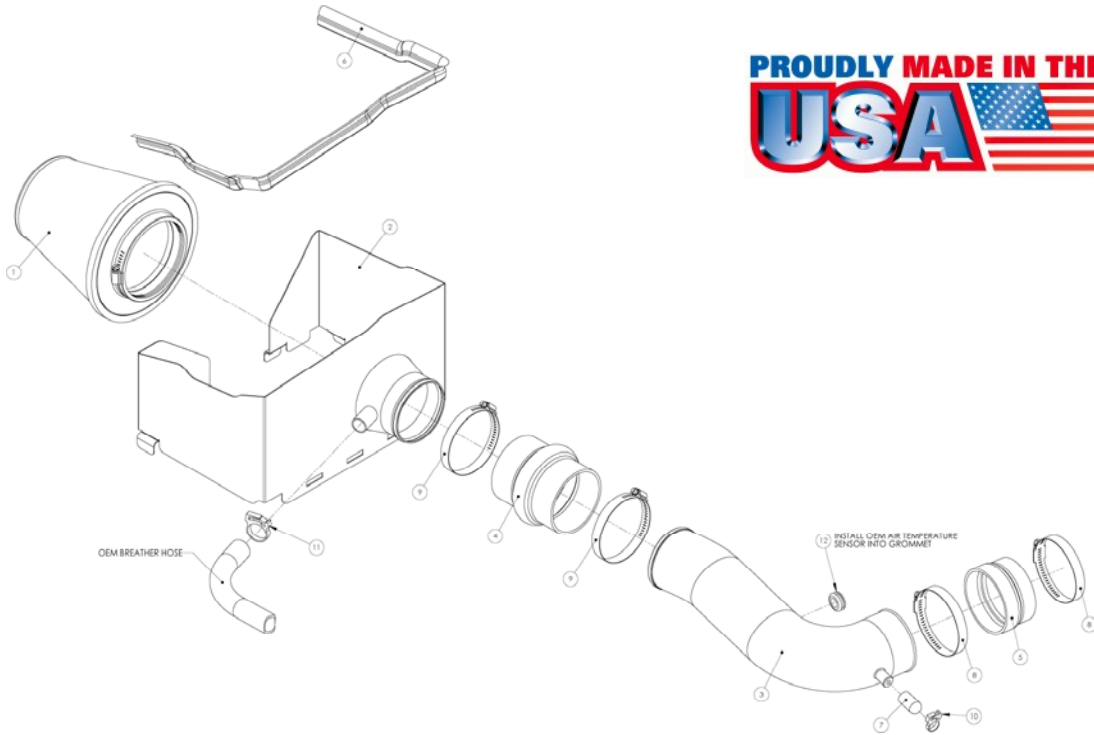

1. Disconnect the negative battery cable! Loosen the hose clamp on the resonator. Disconnect the breather hose going into the fac-

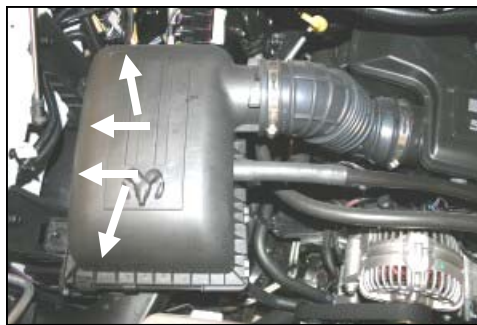

2. Unlatch 4 clips on the factory airbox lid and remove the lid and intake hose assembly. Remove the factory air filter.

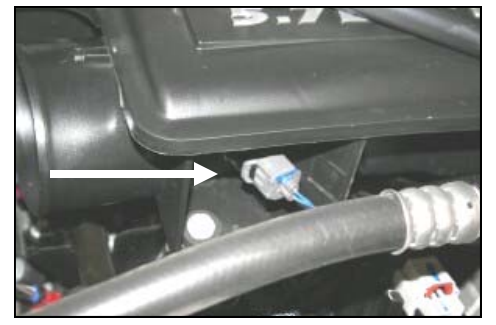

3. Squeeze the tab on the connector, and disconnect the intake temperature sensor.



4. With a 10mm socket, remove two bolts holding the intake resonator to the intake manifold. Lift and pull resonator away from the throttle body and remove it from the vehicle.



5. Remove the factory seal from the throttle body.



6. Gently twist the air temperature sensor counterclockwise and remove it from the resonator.



7. Install the supplied grommet (#12) into the Modular Intake Tube (#3). Next, carefully slide the factory temperature sensor into the grommet until it touches the tab on the temperature sensor.



8. Install the Cool Air Dam (#2) onto the factory airbox base by sliding the tabs on the base thru the CAD and then adjust the sides to fit. Relatch the 4 clips to hold the CAD securely in place.

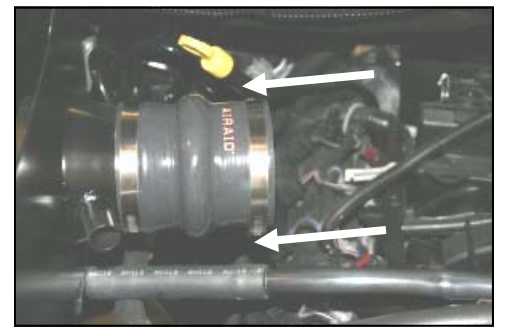

9. Install the hump hose (#4) onto the tube on the CAD using two #56 hose clamps (#9). Leave clamps loose.



10. Install the reducing coupler (#5), small end first, onto the throttle body using two #52 hose clamps (#8). Leave clamps loose.



11. Install the Modular Intake Tube (#3) into the hump hose first and then into the reducing coupler. Adjust for fit, and then tighten all 4 hose clamps.

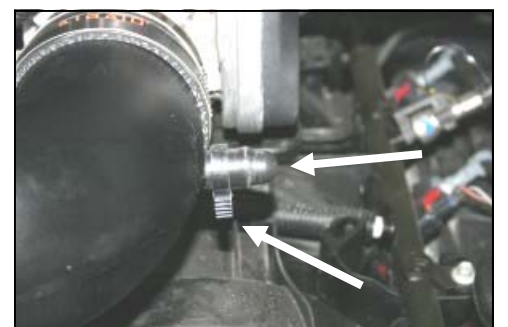

12. Install the provided rubber cap (#7) and speed clamp (#10) onto the nipple on the Modular Intake Tube, as shown.



13. (Note: Because production tolerances vary, you may need to remove the tape on the wiring loom and pull out 1 1/2" of wire to the temp sensor, and then re-install the tape. Re-connect the wiring harness to the temperature sensor.)



14. Install the Airaid Premium Filter (#1) onto the tube on the CAD and tighten the clamp. Next install the weather strip (#6) on the top of the CAD as shown. (Hint: Start at one end of the CAD and work your way towards the other end.)



15. Slip the #24 speed clamp (#11) over the factory breather hose and re-connect the factory breather hose to the nipple on the CAD. Squeeze the clamp to retain the hose in place.

16. Double check your work!

Make sure there is no foreign material in the intake path. Make sure all clamps, hoses, and wiring connections are tight.

17. Reconnect the negative battery cable!

Thank you for purchasing the Airaid Intake System. Contact Airaid @ (800) 498-6951 8:00 AM - 5:00 PM MST weekdays for questions regarding fit or instructions that are not clear to you. Your Airaid Intake System was carefully inspected and packaged. Check that no parts are missing, or were damaged during shipping. If any parts are missing, contact Airaid. The air filter element is protected from direct exposure to water and debris; care should be taken not to drive through deep water. WATER INGESTION IS THE DRIVERS RESPONSIBILITY! The air filter is reusable and should be cleaned using the Airaid Filter Tune-Up Kit periodically.

Before!



After!



**Don't Forget Your
AIRAID Filter Tune-Up
Kit!**



**P/N 790-551 Aerosol Spray
P/N 790-550 Squeeze Spray**



Instructions Revision
Date: 12/05/05