

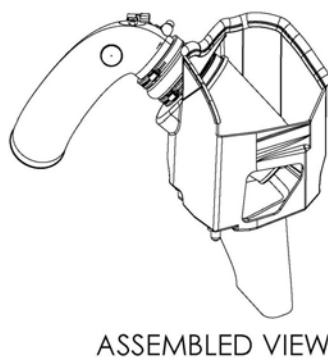

INTAKE SYSTEMS

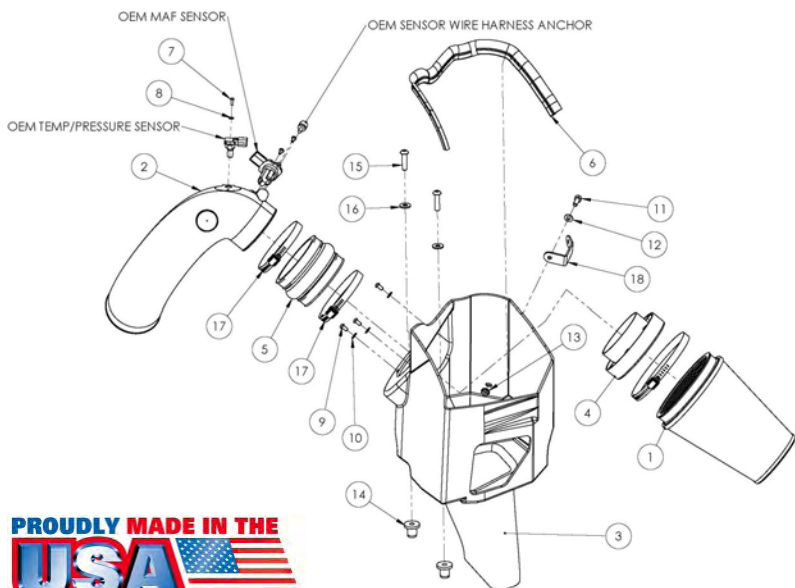

Installation Instructions Part Number 301-254 MXP 2010-12 Dodge Ram 6.7L Cummins Diesel

Packing List:

#1	701-469	Airaid Premium Filter	1
#2	KIT221T	Airaid Intake Tube	1
#3	KIT254CAB	Cool Air Box	1
#4	KIT1121MAFADA	Filter Adapter	1
#5	KITHUMPHS05	Urethane Hump Hose	1
#6	KITWSTRIP03	Weather Strip 26 1/2"	1
	KIT254HP	Hardware & Instructions	1
#7	KIT15BHC3050	8/32 x 1/2" Button Head Screw	3
#8	KIT15FW3016	#8 Flat Washer	3
#9	KIT15DHC3050	1/4-20 Button Head Bolt	3
#10	KIT09FWZ019	1/4" Flat Washer	3
#11	KIT31C75HCS5	5/16-18 x 3/4" Hex Head Bolt	1
#12	KIT25NWUSPZ	5/16" Flat Washer	1
#13	KIT31CNNEH	5/16" Flange Nut	1
#14	KITNUT01	3/8-16 Well Nut	2
#15	KIT15BHC3150	3/8-16 x 1 1/2" Button Head	2
#16	KIT31WUSPZ	3/8" Flat Washer	2
#17	KITHS72	#72 Hose Clamp	2
#18	KIT193B	#193 Bracket	1

Tools Required For Installation:

Ratchet & Extension
7mm, 1/4", 5/16", 10mm, 13mm, 1/2" Sockets
3/32, 5/32", 7/32" Allen Wrenches
1/2" Wrench



1. Disconnect the negative battery cables.
A) Disconnect the air sensors on the upper half of the Factory Airbox, and detach the wire harness. B) Loosen the hose clamp that secures the factory intake tube assembly to the Airbox, unclip the Airbox lid, and remove the upper half of the factory airbox from the vehicle.

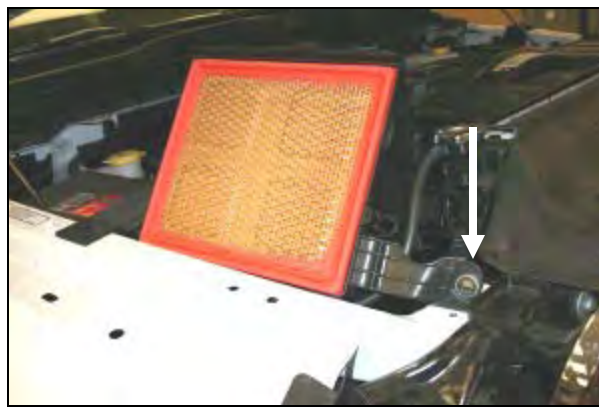

2. Using a 10 mm socket, remove the nut that secures the factory airbox, lower half, to the radiator support. Rock the factory airbox assembly side to side to release it from its mounting grommets, and remove it from the vehicle.



3. Loosen the hose clamp that secures the factory intake tube assembly to the rubber elbow on the turbo inlet, and remove the assembly from the vehicle.

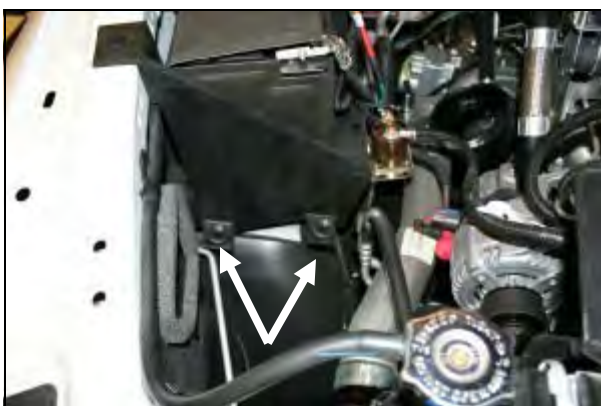

4. Remove the two Factory Airbox grommets and set aside. They will not be reused.

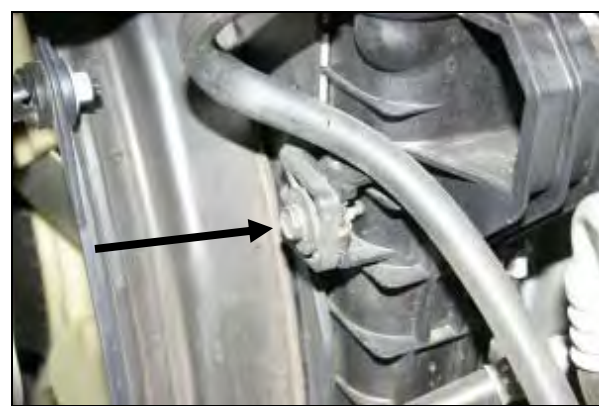

5. Using a 13mm socket remove one bolt that secures the fan shroud to the radiator on the passenger side of the vehicle.



6. Install the bracket (#18) onto the radiator shroud as shown using the factory hardware. Leave the bolt slightly loose for now.



7. Install the Two supplied well nuts (#14) into the factory airbox mounting holes as shown.



8. Install the filter adapter (#4) into the Cool Air Box, (CAB), (#3) using three 1/4" Button Head bolts (#9) and flat washers (#10) as shown.

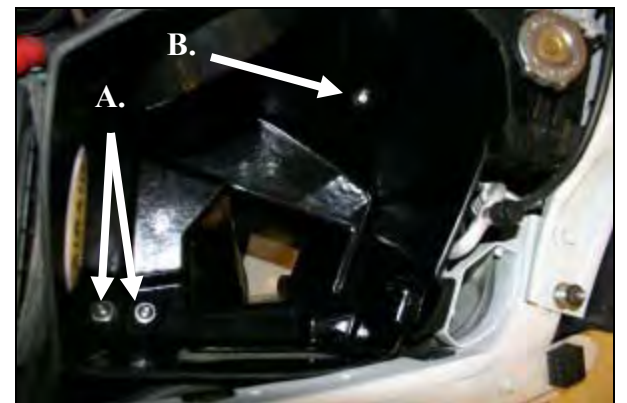

9. Install the CAB into the vehicle as shown. A.) Install the 3/8" button head bolts (#15) and flat washer (#16) thru the CAB and into the well nuts. B.) Install the 5/16" bolt (#11) flat washer (#12), and flange nut (#13) thru the CAB and L-bracket. Tighten all mounting bolts at this time.



10. Install the supplied hump hose (#5) onto the filter adapter using two #72 hose clamps (#17). Leave the clamps loose for now.

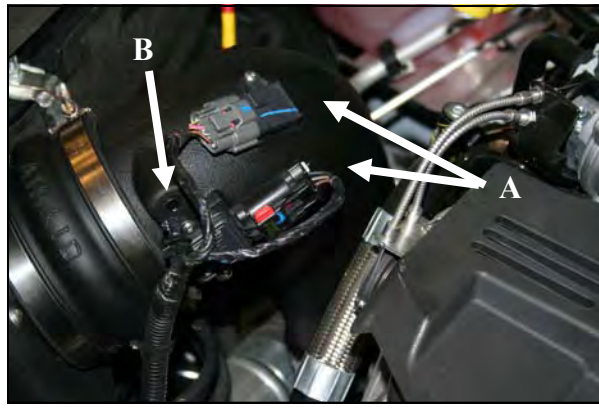

11. **A)** Install the Airaid Intake Tube (#2) into the factory turbo elbow and then into the hump hose. Adjust for fit, and then tighten all three hose clamps. Reinstall the intake temperature sensor and Mass Air Flow sensor into the Airaid Intake Tube using three 8-32 button head screws (#7) and #8 flat washers (#8). **Do Not Use The Factory Screws!** **B)** Reinstall the factory wiring harness anchor into the hole in the Airaid Intake Tube.



12. Install the Airaid Premium Filter (#1) onto the filter adapter and tighten the clamp. Install the weather strip onto the top of the CAB starting at the right fender and working your way towards the radiator.

13. Double check your work!

Make sure there is no foreign material in the intake path. Make sure all clamps, hoses, bolts, and screws are tight.

14. Reconnect the negative battery cables!

Thank you for purchasing the Airaid Intake System. Contact Airaid @ (800) 498-6951 8:00 AM - 5:00 PM MST weekdays for questions regarding fit or instructions that are not clear to you. Your Airaid Intake System was carefully inspected and packaged. Check that no parts are missing, or were damaged during shipping. If any parts are missing, contact Airaid. The air filter element is protected from direct exposure to water and debris; care should be taken not to drive through deep water. WATER INGESTION IS THE DRIVERS RESPONSIBILITY! .

Before!



After!



SynthaMax®

Do Not Oil



Synthamax Air Filters do not require oil. Service air filter as needed by cleaning with common non-petroleum all-purpose household cleaner and water. Simple Green®, Formula 409® or equivalent works great. Apply cleaner to outside of air filter and allow to soak. Then flush filter clean from the inside out with a garden hose and repeat steps if necessary. Do not apply high pressure water or air to clean filter. Allow filter to air dry and reinstall