

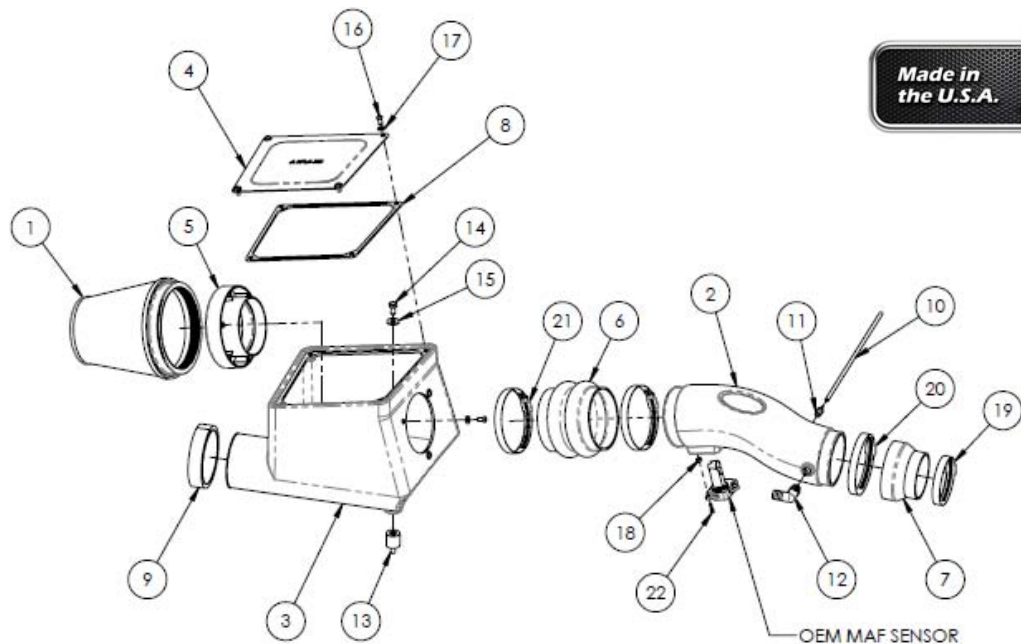

INTAKE SYSTEMS



Installation Instructions Part Number 510-301 2005-2011 Toyota Tacoma 2007-2009 FJ Cruiser 4.0 L V6

Packing List:

#1	700-462	Airaid Premium Filter	1
#2	KIT301T	Airaid Intake Tube	1
#3	KIT301CAB	Cold Air Box	1
#4	KIT301LID	Air Box Lid	1
#5	KIT1121MAFADA	Filter Adapter	1
#6	KITHUMPHS33	Hump Hose	1
#7	KITRDCR22	Reducing Coupler	1
#7	KIT301HP	Hardware & Instructions	1
#8	-KIT301G	Airbox Gasket	x1
#9	-KITWSTRIP06	Foam Weather Strip	x1
#10	-KITHOSE07	1/8 x 20 1/2" Vacuum Line	x1
#11	-KITFITTING19	1/8 NPT Barbed Fitting	x1
#12	-KITFITTING29	3/8 NPT Barbed Elbow	x1
#13	-KIT301MOUNT	M8 CAB Mount	x3
#14	-KIT20CSCZ160	8 mm x 1.25 x 16 Bolt	x3
#15	-KIT31NWUSPZ	5/16 Flat Washer	x3
#16	-KIT15DHC3050	1/4-20 x 1/2 Button Head Bolt	x7
#17	-KIT09FWZ019	1/4 Flat Washer	x7
#18	-KITSPACER01	#8 spacer	x2
#19	-KITHS48	#48 Hose Clamp	x1
#20	-KITHS64	#64 Hose Clamp	x1
#21	-KITHS68	#68 Hose Clamp	x2
#22	-KIT10SHCP	8-32 Socket Head Screw	x2

Tools Required:

Standard and Phillips tip Screw Driver. Ratchet and Extension. 8mm, 10mm, 12mm and 13mm sockets. Standard Allen wrench set.

Full color instructions can be viewed on our web site at [Airaid.com](http://www.airaid.com). Use the **Product Search** function to find your part number, and click **View Details** or go to <http://www.airaid.com/InstallationPDF/510-301.pdf>

Note: This intake system is not compatible with the factory engine cover.

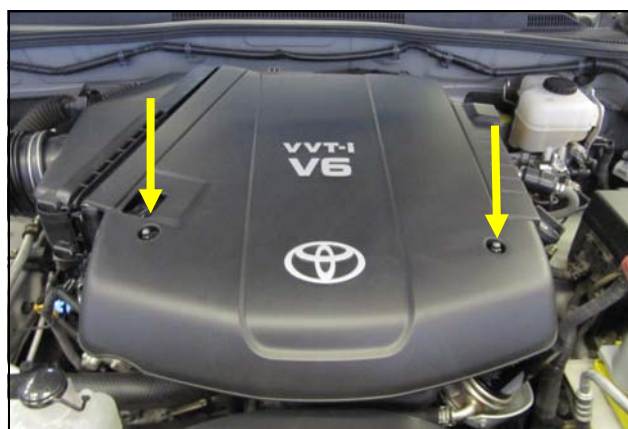

Disconnect The Negative Battery Terminal.

1. Using a 10mm Socket, remove the two acorn nuts on the top of the motor and remove the engine cover.

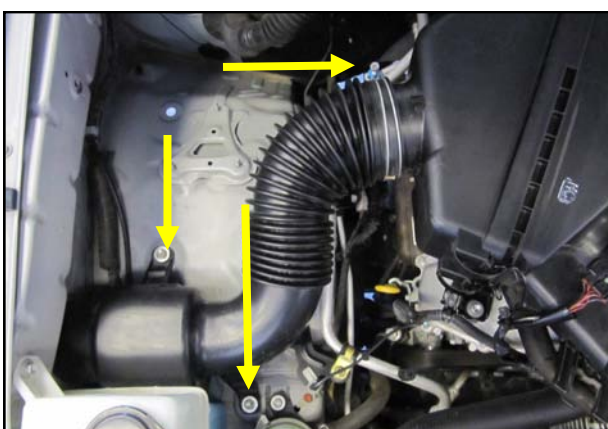

2. Loosen the clamp on the factory intake tube and remove the two 8mm bolts securing the other end on the inner fender. Slide the intake tube out from the inner fender hole and set it aside.

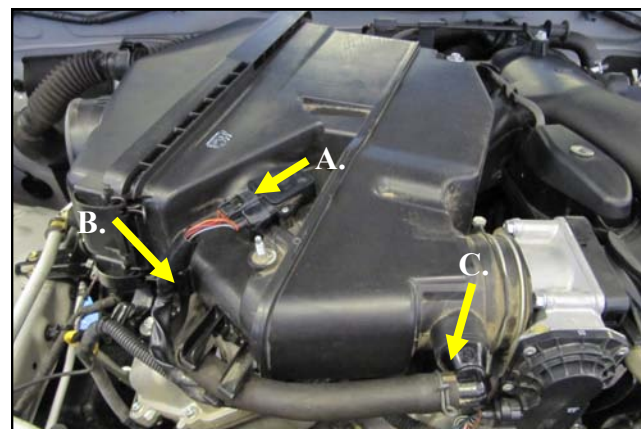

3. A.) Disconnect the Mass Air Flow meter.
B.) Pry the wire harness anchor out of the airbox.
C.) Disconnect the crankcase breather line.



4. Remove the factory airbox

Loosen the clamp on the throttle body side of the factory airbox and remove the two 6mm bolts securing it to the motor. Remove the entire airbox assembly from the vehicle.

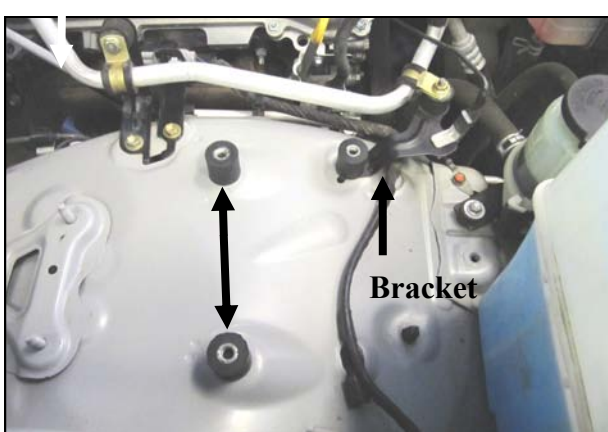

5. Install two of the M8 CAB Mounts (#13), hand tight, into the weld nuts on the inner fender as shown. Use the third CAB Mount to replace the 8mm bolt holding the A/C bracket.



6. Apply the self adhesive, Foam Weatherstrip (#9) onto the air inlet on the Cold Air Box (#3).



7. Mount the Filter Adapter (#5) to the Cold Air Box, as shown, using three 1/4-20 x 1/2" Button head Bolts (#16) and 1/4" Flat Washers (#17).

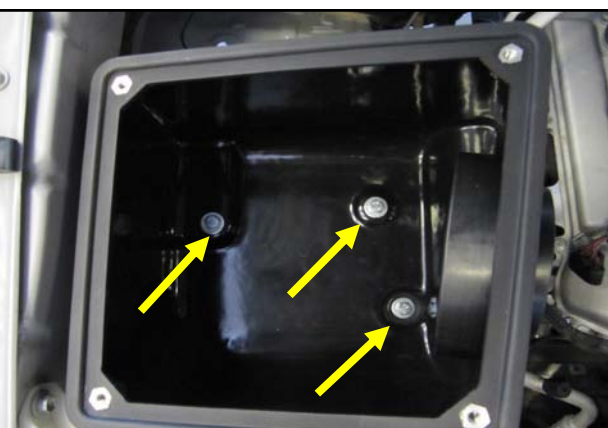

7. Mount the Cold Air Box onto the CAB Mounts using the three 8mm Bolts (#14) and 5/16 Flat Washers (#15).

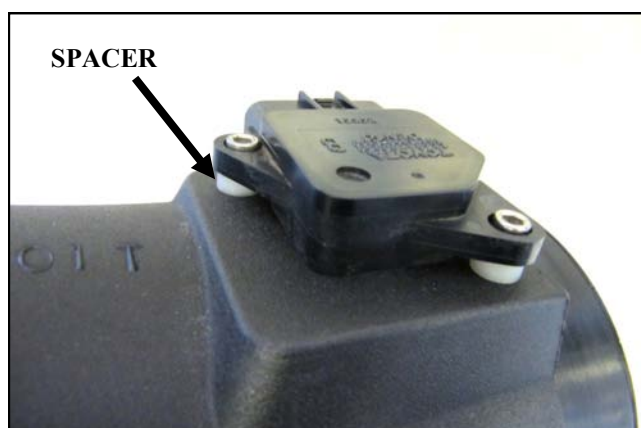

8. Transfer the Mass Air Flow sensor from the factory airbox, into the Airaid Intake tube and secure using the two #8 Spacers (#18) and 8-32 Socket Head screws (#22). **Do not use the factory screws.**



9. Install the 1/8" and 3/8" barbed fittings (#s 11 and 12) into the Airaid Intake Tube as shown.



10. Slide the Hump Hose (#6), and two #68 Hose Clamps (#21), onto the Intake Tube as shown. Slide the Reducing Coupler (#7) and the #48 (#19) and #64 Clamps (#20) on the other end of the Intake Tube. Leave the Clamps loose for now.



11. Install the Airaid Intake Tube onto the Cold Air Box and the throttle body, align and tighten all four of the Clamps. Reconnect the Mass Air Flow sensor.



12. replace the OEM vacuum line on the fuel pressure regulator with the supplied 20 1/2' 1/8" line. Connect the 1/8" line to the small Fitting on the Intake tube.



13. Connect the factory crank case breather line to the 3/8 Barbed Elbow on the Intake Tube.

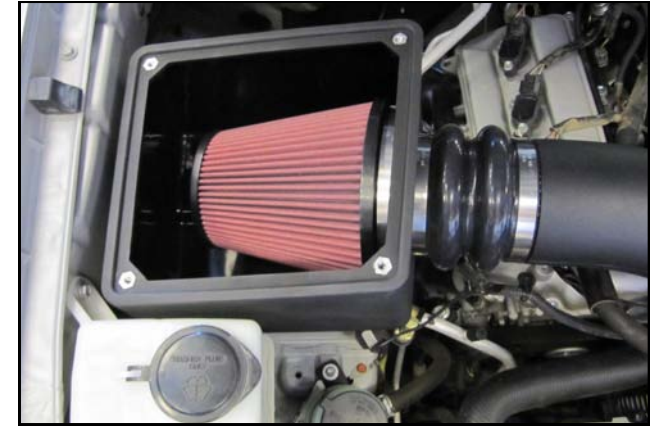

13. Install the Airaid Premium Filter onto the Filter Adapter inside of the airbox and tighten the clamp..



15. Place the Gasket (#8) onto the underside of the Air Box Lid (#4) and peel off the protective film. Mount the lid on the Air Box using four 1/4-20 x 1/2" Button Head Bolts (#16), and 1/4" Flat washers (#17).



16. Double check your work!
Make sure there is no foreign material in the intake path. Make sure all clamps, hoses, bolts, and screws are tight. Double check the hood clearance!
Reconnect the negative battery cable!



Pre Filter Option- Part Number 799-445
For maximum protection in the harshest of environments Airaid offers a slip on Pre Filter.
- Prolongs Cleaning Intervals
- Water Repellant
- Free Flowing Protection

Thank you for purchasing the Airaid Intake System. Contact Airaid @ (800) 498-6951 8:00 AM - 5:00 PM MST weekdays for questions regarding fit or instructions that are not clear to you. Your Airaid Intake System was carefully inspected and packaged. Check that no parts are missing, or were damaged during shipping. If any parts are missing, contact Airaid. The air filter element is protected from direct exposure to water and debris; care should be taken not to drive through deep water. WATER INGESTION IS THE DRIVERS RESPONSIBILITY! The air filter is reusable and should be cleaned periodically depending on usage.

Before!



After!



Don't Forget Your AIRAID Filter Tune-Up Kit!



P/N 790-551 Aerosol Spray
P/N 790-550 Squeeze