



BX1697

2011-13 Chevy Cruze Eco Installation Instructions

Serial Number

Please read BOTH these Installation Instructions and the General Instructions before attempting to install or operate this equipment.

1. Blue Ox® towing products and accessories are intended to be installed by Blue Ox® Dealers who are familiar with our products and have the equipment and knowledge to do “fit work”. When necessary Blue Ox® Dealers can be found at www.blueox.com or by contacting our Customer Care Department at (402) 385-3051.
2. Many Blue Ox® baseplates are designed to use existing holes and hardware to mount the baseplate to the towed vehicle. Even though bolts are there, do not assume they are adequate for baseplate mounting. Always use hardware supplied in the hardware kit or existing hardware specified in the Baseplate Towing Installation Instructions.

Attachment Tab Height: 14-1/4”
Attachment Tab Width: 20”

Bolt Torque Specifications
Torque in Foot-Pounds for Metric Bolts

Bolt Size	Grade 8.8	Grade 10.9
6MM	6	8
8MM	16	22
10MM	31	40
12MM	54	70
14MM	89	117

Confirm the towability and pre-towing procedures for your vehicle with the owner’s manual or contact the vehicle’s manufacturer for specific towing procedures.

Bolt Torque Specifications
Torque in Foot-Pounds for Inch Bolts

Bolt Size	Grade 5	Grade 8
1/4”	10	14
5/16”	19	29
3/8”	33	47
7/16”	54	78
1/2”	78	119
5/8”	154	230



If the front of your vehicle looks different than this, call us at (402) 385-3051.

! WARNING

Failure to read and follow these instructions could result in separation of the towed vehicle from the tow bar, causing property damage, loss of towed vehicle, personal injury or death.

BX1697

2011-13 Chevy Cruze Eco

Installation Instructions

Ref. No.	Qty.	Part No.	Description
1	1	61-6883.....	WLDM'T, BX1697
2	1	61-6884.....	WLDM'T, SUPPORT, DS, BX1697
3	1	61-6885.....	WLDM'T, SUPPORT, PS, BX1697
4	8	61-5208.....	WLD, NUT PLT, 1/4X1X1, 3/8"/14"WIRE
5	4	EXISTING METRIC BOLT
6	6	201-0440.....	3/8-16 X 1 1/2 HEX BOLT, GRD.5, ZP
7	4	201-0444.....	3/8-16 X 2 HEX BOLT GRADE 5 ZP.
8	10	203-0010.....	3/8 LOCK WASHER, ZP
9	2	202-0090.....	3/8-16 HEX NYL. INS. LOCK NUT, ZP
10	2	62-3469.....	ATT TAB ASSY, REM, SF/LB, 1 HOLE
11	3	201-0050.....	1/4-20 X 3/4 HEX BOLT GRD.5, ZP
12	2	201-0192.....	10-32 X 1/2 SLOT, RD. HD. SCREW
13	3	202-0102.....	1/4-20 HEX NYL NUT, ZP
14	2	203-0054.....	#10 LOCK WASHER
15	2	202-0047.....	#10-32 HEX NUT
16	1	102-7204.....	BREAKAWAY BRKT, BX1697
17	1	101-6135.....	BRACKET ELECTRICAL, 90 DEGR. (Not Shown)
2	2	226-0046.....	BASEPLATE SAFETY CABLE, 36" CL III (Not Shown)
2	2	229-0359.....	QUICKLINK, 3/8, ZP (Not Shown)
2	2	290-0437.....	RECEIVER, CAP PLUG (BLK) (Not Shown)
4	2	290-0275.....	CABLE TIE, 8 INCH NYLON (Not Shown)

Tools Required	
8MM Socket	Small Flat Screwdriver
10MM Socket	Utility Knife
13MM Socket	Torque Wrench
18MM Socket/Wrench	Tape Measure
9/16" Socket/Wrench	Drill
T20 Torx	Hammer
Large Vise Grip	1 1/4" Hole Saw
Diagonal Cutters	1/4" Drill Bit
Reciprocating Saw	13/32" Drill Bit
Pry Bar	Loctite® RED

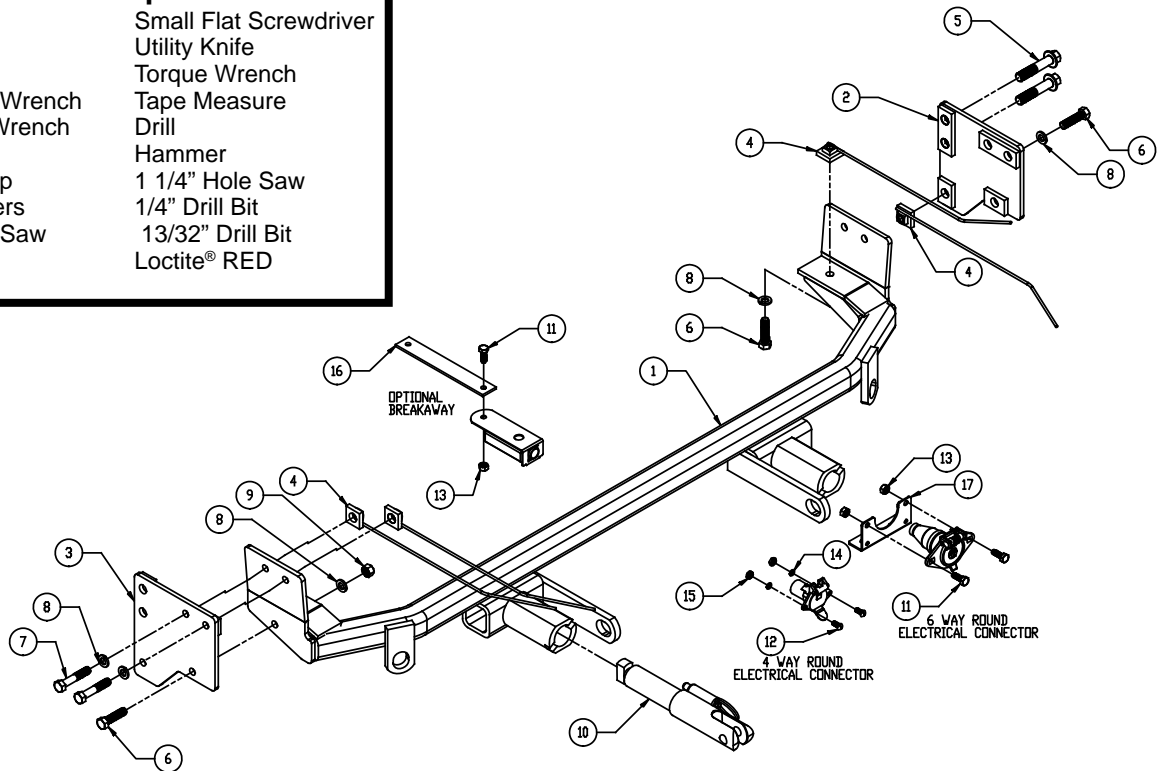

Important:

Use only genuine factory replacement parts on your baseplate. Do NOT substitute homemade or non-typical parts. If a bolt is lost or in need of replacement, for your safety and the preservation of your baseplate, be sure to use a replacement bolt of the same grade (In most cases it will be Grade 5, please reference the parts list above). Replacement parts may be ordered through your nearest Blue Ox® Dealer or Distributor. Failing to follow and/or altering these installation instructions in either installation or required equipment will void the manufacturer's warranty.

BX1697

2011-13 Chevy Cruze Eco

Installation Instructions

Attachment Tabs: Due to the design of the removable tabs, the RangeFinder II, Acclaim and Ambassador tow bars can not be used. Adapters, except the BX8833 and BX88151, can not be used with this baseplate.

Vehicles equipped with the "Active Air Shutter System" will require trimming of louvers to allow the baseplate attachment tabs to come through the grille opening.

Instruction Notes: The front fascia, belly pan, horn bracket and air intake tube are removed for baseplate installation. Drilling is required. Trimming of air dam, front fascia and shutters is required.

The dimensional variations between otherwise identical vehicles can be considerable. While the baseplate was designed for easy installation, it may be necessary to tailor the baseplate slightly to compensate for auto manufacturer's tolerances. These minor adjustments may include filing a hole slightly, bending electrical rods or bending end plates.

The BX8869 Bulb and Socket Wiring Kit is available for this vehicle.



Possible location for Bulb and Socket Wiring Kit (BX8869)

Installation Instructions:

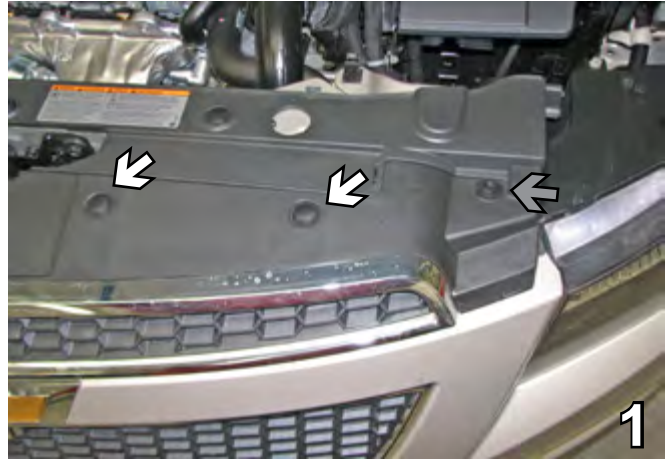

1. Remove the two (2) push pins (white arrows) from the black plastic cover just above the radiator. Using a 10MM socket, remove the metric bolt at the edge of the fascia (gray arrow). Do this on both sides. Set pins and bolts aside to be reinstalled later.



2. Just forward of front tire, on the edge of the wheel well, are three (3) bolts to remove with the T20 Torx, both sides. Set bolts aside to be reinstalled later.

Do not use the towed vehicle for storing luggage, equipment, etc. This may cause you to exceed the towing capacity of the tow bar, baseplate, and its accessories.

Handling of some cosmetic parts when installing this product may require the use of protective covers, rags, specialty tools, etc. to prevent damage.

BX1697
2011-13 Chevy Cruze Eco
Installation Instructions

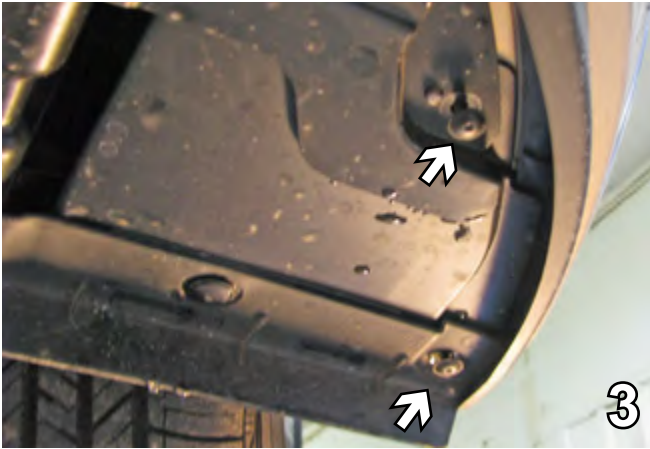

3. Remove the two (2) bolts from underneath the fascia, just forward of front tires with the T20 Torx, both sides. Set the bolts aside to be reinstalled later.

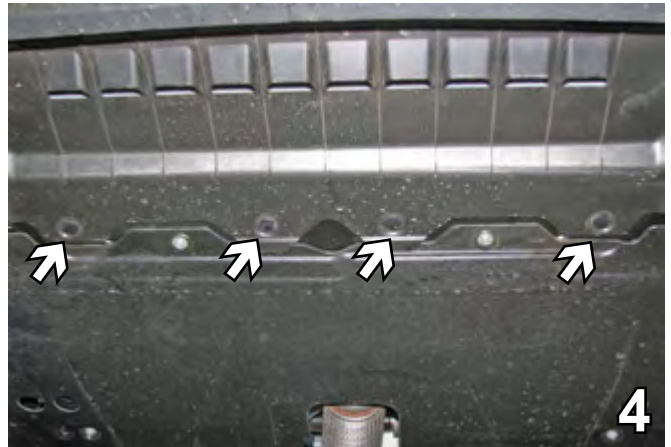

4. Remove the four (4) push pins from underneath the fascia. Set pins aside to be reinstalled later.



5. Pull out and to the side on the outside corner of the fascia next to the wheel to release the first tab. Using a small flat screwdriver push in on each of the four (4) tabs as you pull the fascia. Do this on both sides. Remove the fascia and set aside carefully to be reinstalled later.



6. Remove one (1) push pin from the bottom of the belly pan. Do this on both sides. Set push pins aside to be reinstalled later.

7. Inside the wheel well, remove two (2) push pins. Do this on both sides. Set push pins aside to be reinstalled later.



BX1697
2011-13 Chevy Cruze Eco
Installation Instructions

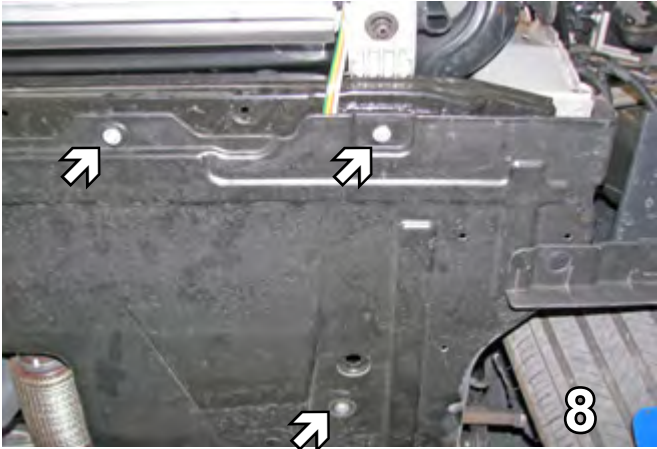

8. Using an 8MM socket, remove two (2) metric bolts across the front of the belly pan and another across from the tire. Do this on both sides. Set bolts aside to be reinstalled later.



9. Using an 8MM socket, remove one (1) more metric bolt toward the back of the belly pan. Do this on both sides. Set bolts aside to be reinstalled later.



10. Using the 13MM socket, remove the metric bolt from the horn bracket on the driver side, unplug and set the bolt and horn aside to be reinstalled later.



11. Using a 10MM socket, remove the metric bolt from the top of the air intake tube. Set the bolt aside to be reinstalled later.



12. On the passenger side below the headlight, detach the air intake tube from the bottom section of the tube. Set aside to be reinstalled later.

BX1697
2011-13 Chevy Cruze Eco
Installation Instructions

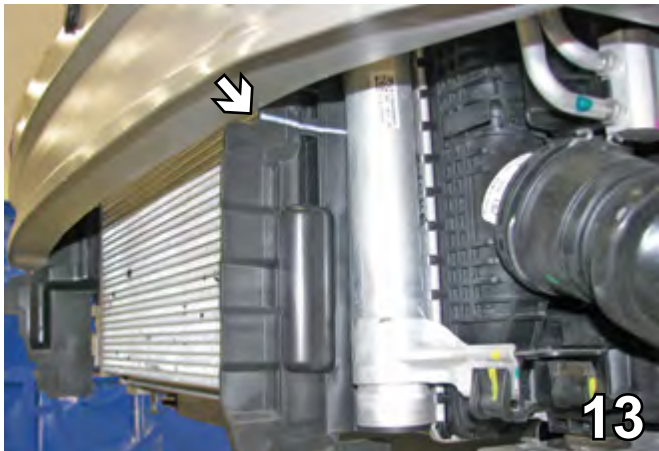

13. Using the utility knife, cut the plastic air dam along the top even with the bottom of the bumper and remove lower section. Do this on both sides.

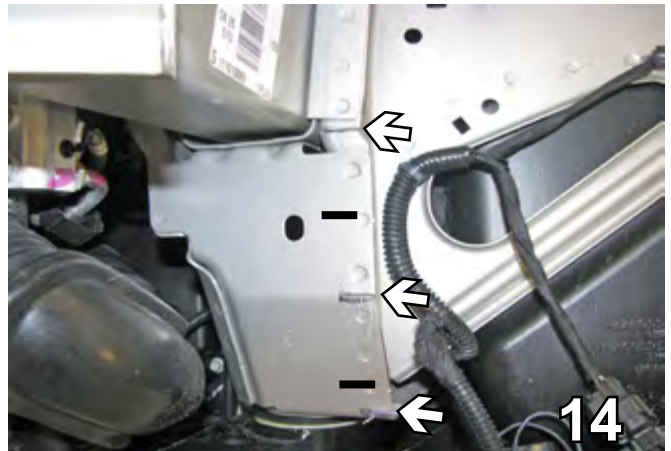

14. Cut frame webbing at the top, at the bend and at the bottom with a reciprocating saw. Be careful not to cut the main part of the frame. Do this on both sides.



15. Using vice grips, bend the frame webbing over and flatten with a hammer. Do this on both sides.



16. Using an 18MM socket and a wrench on the other side, remove the two (2) metric bolts next to the flattened area. Do this on both sides.

17. Using the 1-1/4" hole saw, drill a hole centered in the bumper, just in front of the frame end to be used for inserting 3/8" nut plates. Do this on both sides.

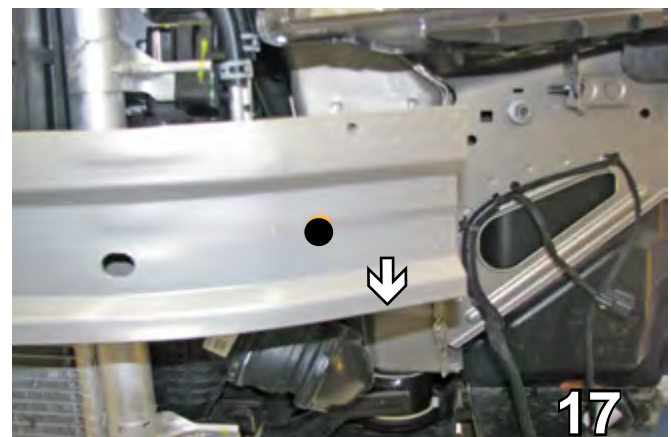

BX1697
2011-13 Chevy Cruze Eco
Installation Instructions



18. Inside the 1-1/2" drilled hole is a cross piece, which may need to be bent vertically with a pry bar in order to insert 3/8" nut plate. Do this on both sides.

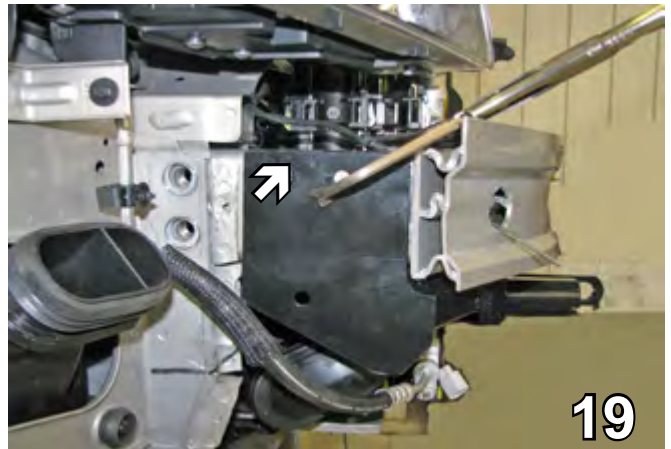

19. Slide the baseplate onto the frame rail flush with the top and as far forward as possible. Be sure support plate holes are in line with the existing holes (step 21). Then clamp the baseplate to the frame rail with the large vise grip.



20. Using the baseplate as a template, drill a hole on the bottom side with the 13/32" drill bit. Insert 3/8"-16 x 1-1/2" hex bolt with Loctite Red and 3/8" lock washer. Attach to 3/8" nut plate inserted through the 1-1/2" lower opening on bumper. Do this to both sides.

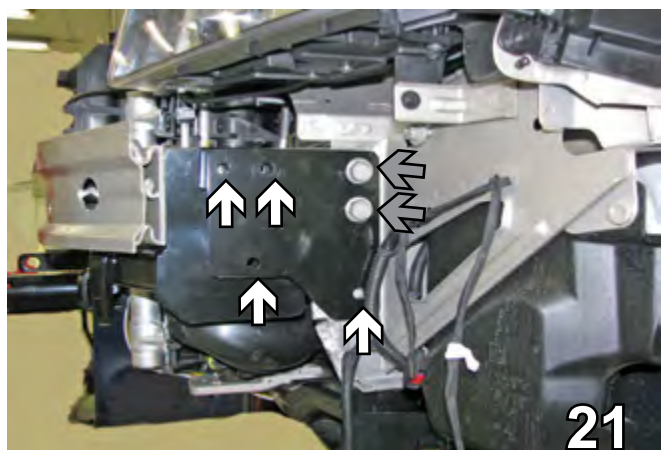

21. Using bolts removed in step 16, bolt the support plates to the existing holes on the outside of the frame (gray arrows). Use 18MM socket and a wrench on the other side to tighten bolts in order to sandwich the baseplate between the frame and the support plates. Using the support plate as a template, drill the other four (4) holes with a 13/32" drill bit (white arrows). Do this on both sides.

When using power drills be aware of the dangers of torque and drill bit length.

BX1697
2011-13 Chevy Cruze Eco
Installation Instructions

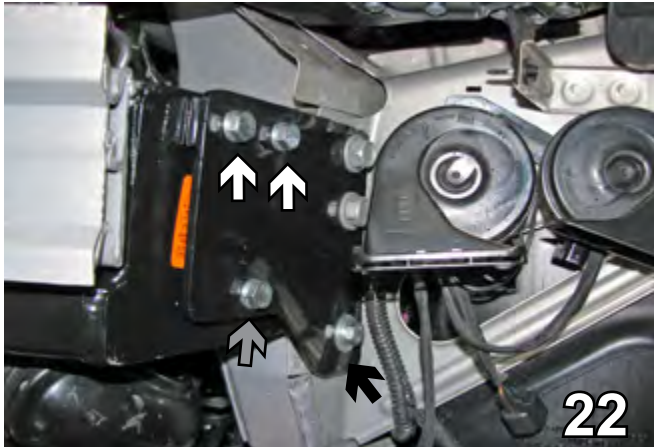

22. Bolt the upper two (2) holes (white arrows) with 3/8"-16 x 2" hex bolts, 3/8" lock washers and fasten to 3/8" nut plates inserted through the drilled hole in the bumper. In the lower outside hole (gray arrow) bolt the support plate to the baseplate with 3/8"-16 x 1-1/2" hex bolt fastened with 3/8" lock washer and 3/8"-16 hex nut. Be sure to use Loctite Red on all bolts. Do this on both sides.

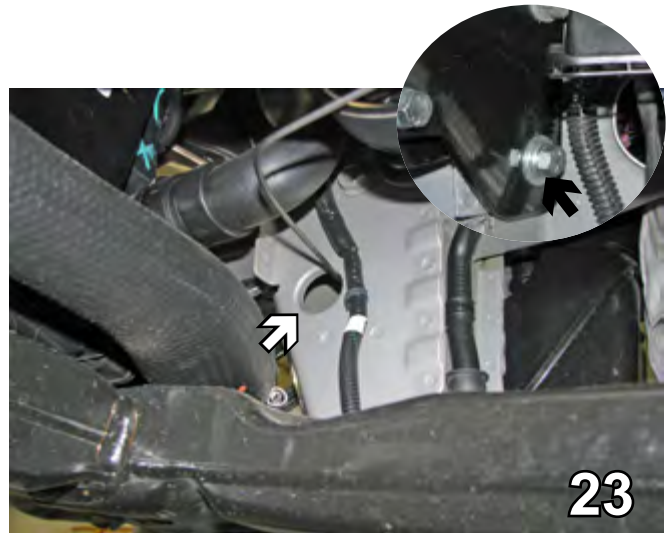

23. Insert 3/8"-16 x 1-1/2" hex bolt with 3/8" lock washer into the lower inside hole on the baseplate (black arrow step 22). Fasten to a 3/8" nut plate inserted through an existing hole underneath in the frame (white arrow). Do this on both sides. Be sure to use Loctite Red on the bolts.

BE SURE TO USE LOCTITE® RED ON ALL BOLTS BEFORE TIGHTENING. TIGHTEN ALL BOLTS ACCORDING TO THE TORQUE CHART ON THE FRONT PAGE OF THESE INSTRUCTIONS OR ON PAGE 3 OF THE BASEPLATE GENERAL TOWING INSTRUCTIONS.

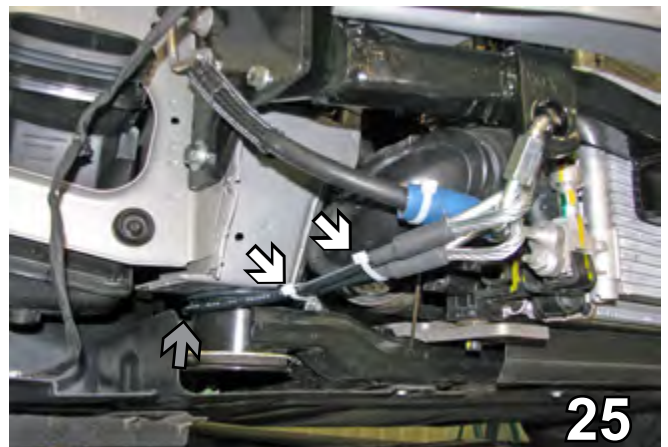

25. Attach the permanent baseplate safety cables to the provided convenience link on the front of baseplate. Cable ties are provided to reduce clearance issues with moving parts of engine compartment (white arrows). The photo above shows the recommended installation of the cables to lower cross member of vehicle (gray arrow). Additional options may interfere with suggested mounting; in this case secure the cables to a solid piece of the frame as described in the instructions included with the permanent baseplate safety cables. Be sure the safety cables do not rub against any hoses or moving parts. Do this to both sides of the vehicle.



24. On the passenger side in the corner next to the baseplate, drill a 1/4" hole below the large hole (gray arrow) and pop the clip back in (white arrow). Be sure it is low enough so that the line clears the baseplate. Reattach the horn bracket on the driver's side. Reattach the air intake tube and the belly pan.

BX1697
 2011-13 Chevy Cruze Eco
 Installation Instructions



26. On the backside of the fascia, locate the top louver of the air shutter system, measure and mark over 6-1/2" from the left end of the air shutter system. Using the diagonal cutters, make a vertical cut across the louver and remove the 6-1/2" end portion. Do this to both sides of the vehicle. Driver side is shown.

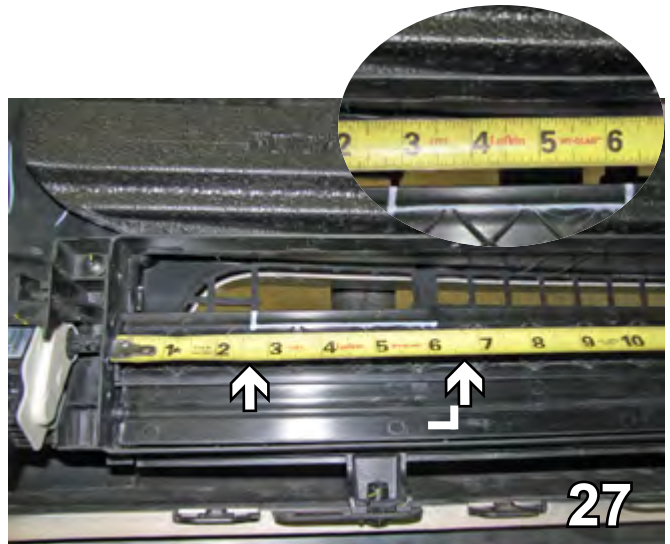

27. On the backside of the fascia, locate the left side of the middle louver on the air shutter system, measure over 2-3/4" mark the louver, continue to measure to 6-1/2", mark the louver again. Using the diagonal cutters and utility knife trim out the area between the marks 3/8" down from the top edge of the louver. Do this to both sides of the shutter system. Driver side is shown.



28. Hold fascia up to its original position. Using the diagonal cutters, cut out the upper outside area of the front fascia allowing room for the attachment tabs to come through the grille. Do this on both sides. Reinstall the fascia.

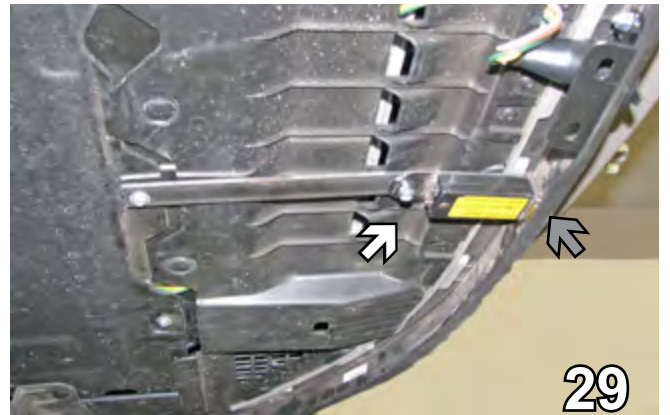

29. **Optional:** Attach the breakaway and the bracket to the underside of the vehicle with 1/4"-20 x 3/4" bolt and 1/4"-20 hex nut (white arrow). Cut opening in lower air dam to allow front of breakaway to come through (gray arrow).

Be sure that ALL electrical connections are plugged in properly and functioning BEFORE installing the fascia.



30. Possible location to mount the 4 or 6 pin electrical coupler on the fascia's lower air dam.

BX1697
2011-13 Chevy Cruze Eco
Installation Instructions

Install the tow bar and safety cables according to the instructions included in their packages. When demonstrating this to the customer, be sure to include all the contents and packages.

Do **NOT** substitute other devices if the tow bar pin and clip are misplaced.



Shown without removable tabs installed.



Shown with removable tabs installed.

If the baseplate is in an accident, it must be replaced. DO NOT use it again! An accident can cause unseen damage and using it again could result in more damage or serious injury. DO NOT use the baseplate if it is damaged or missing parts.

DEALER or INSTALLER:
Be certain the user receives the instruction sheets for their products.

CUSTOMER SERVICE COMMITMENT

Blue Ox is committed to providing you with exceptional customer care throughout your lifetime with our products. Our team is here to assist you with any questions you may have regarding the performance of your product. Simply call (402) 385-3051 and you can speak with our customer care team.

Additionally, please visit our website to see which rallies our Destination America team will be attending. For a nominal fee, our service technician will service your towing system to ensure it's in proper working condition. Also, as a commitment to our customers, should you visit our factory, you can stay at our full service Blue Ox campground at no charge along with enjoying a factory tour.

Again, thank you for being our customer and for the confidence you have shown in the performance of our products. It is because of customers like you we enjoy the success we have today.



© 2011 Blue Ox
One Mill Road, Industrial Park
Pender, Nebraska 68047
Phone: (402) 385-3051
Fax: (402) 385-3360
www.blueox.com