



# BX2633

## 2012 Ford Focus 2013 Ford Focus Titanium Installation Instructions

Serial Number

**Please read BOTH these Installation Instructions and the General Towing Instructions before attempting to install or operate this equipment.**

- Blue Ox® towing products and accessories are intended to be installed by Blue Ox® Dealers who are familiar with our products and have the equipment and knowledge to do “fit work”. When necessary, Blue Ox® Dealers can be found at [www.blueox.com](http://www.blueox.com) or by contacting our 24/7 Customer Care Department at (402) 385-3051.
- Many Blue Ox® Baseplates are designed to use existing holes and hardware to mount the baseplate to the towed vehicle. Even though bolts are there, do not assume they are adequate for baseplate mounting. Always use hardware supplied in the hardware kit or existing hardware specified in the Baseplate Installation Instructions.

Attachment Tab Height: 14-1/2"  
Attachment Tab Width: 17-1/2"

### Bolt Torque Specifications

Torque in Foot-Pounds per Metric Bolts

Bolt Size	Grade 8.8	Grade 10.9
6MM	6	8
8MM	16	22
10MM	31	40
12MM	54	70
14MM	89	117

**Reference your vehicle owner’s manual for manufacturer’s towing specifications.**

### Bolt Torque Specifications

Torque in Foot-Pounds per Inch Bolts

Bolt Size	Grade 5	Grade 8
1/4"	10	14
5/16"	19	29
3/8"	33	47
7/16"	54	78
1/2"	78	119
5/8"	154	230



**If the front of your vehicle looks different than this, call us at (402) 385-3051.**



## WARNING

Failure to read and follow these instructions could result in separation of the towed vehicle from the tow bar, causing property damage, loss of towed vehicle, personal injury or death.



# BX2633

## 2012 Ford Focus 2013 Ford Focus Titanium Installation Instructions

### Tools Required

- Loctite® RED
- Utility Knife
- T27 Torx
- T30 Torx
- Tape Measure
- Flat Screwdriver
- Torque Wrench
- 13/32" Drill Bit
- Drill
- 1 1/4" Hole Saw
- 8MM Socket
- 10MM Socket
- 9/16" Socket
- Large Vise Grips
- Reciprocating Saw

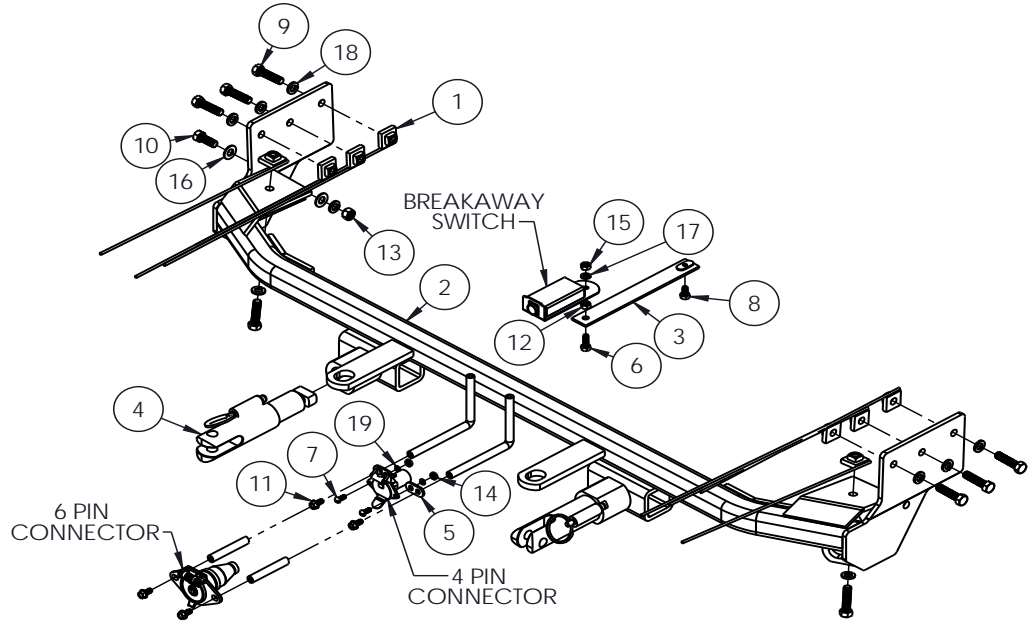

Item No.	Part No.	Description	Qty.
1.....	61-5208 .....	3/8"-16 Nut Plate .....	8
2.....	61-6913 .....	BX2633 Baseplate.....	1
3.....	61-6914 .....	Mount Bracket .....	1
4.....	62-3468 .....	Attachment Tab Assembly with Hole .....	2
5.....	101-5822 .....	4 Way Connector Adapter .....	2
6.....	201-0050 .....	1/4"-20 x 3/4" Hex Head Bolt, Grade 5, ZP .....	1
7.....	201-0192 .....	#10-32 1/2" Round Slotted Head Screw.....	2
8.....	201-0193 .....	1/4"-20 x 1/2" Hex Head Bolt, Grade 5, ZP .....	1
9.....	201-0440 .....	3/8" - 16 x 1-1/2" Hex Head Bolt, Grade 5, ZP .....	8
10.....	201-0443 .....	3/8"-16 x 1" Hex Head Bolt, Grade 5, ZP .....	1
11.....	201-0553 .....	1/4"-20 x 1/2" Hex Wshd Bolt Type F TCS, ZP.....	2
12.....	202-0001 .....	1/4"-20 Hex Nut, ZP.....	1
13.....	202-0003 .....	3/8"-16 Hex Nut, ZP.....	1
14.....	202-0047 .....	#10-32 Hex Nut .....	2
15.....	202-0102 .....	1/4"-20 Hex Nylon Nut, ZP .....	1
16.....	203-0003 .....	3/8" Flat Washer, ZP.....	2
17.....	203-0008 .....	1/4" Lock Washer, ZP .....	1
18.....	203-0010 .....	3/8" Lock Washer, ZP .....	9
19.....	203-0054 .....	#10 Lock Washer, ZP .....	2
20.....	226-0046(not shown) .....	Class III Safety Cables .....	2
21.....	229-0359(not shown) .....	3/8" Quicklink, ZP .....	4
22.....	290-0437(not shown) .....	Black Cap Plug Receiver.....	1
23.....	293-1339(not provided).....	Breakaway Switch .....	1
24.....	294-0805(not provided).....	4 Pin Connector.....	1
25.....	294-0902(not provided).....	6 Pin Connector.....	1



# BX2633

## 2012 Ford Focus 2013 Ford Focus Titanium

### Installation Instructions

**Attachment Tabs:** Due to the design of the removable tabs, the RangeFinder II, Acclaim and Ambassador tow bars can not be used. Adapters, except the BX8833 and BX88151, can not be used with this baseplate.

**Installation Notes:** The fascia, bellypan and washer reservoir are removed and reinstalled during installation of the baseplate. Some drilling may be required. Trimming of the fascia and bumper is required.

The dimensional variations between otherwise identical vehicles can be considerable. While the baseplate was designed for easy installation, it may be necessary to tailor the baseplate slightly to compensate for auto manufacturer's tolerances. These minor adjustments may include filing a hole slightly, bending electrical rods, and/or bending end plates.

The BX8869 Wiring Kit is recommended for this vehicle.



Possible location for the Bulb and Socket Wiring Kit (BX8869).

### Installation Instructions



1. Using a T27 Torx, remove the two screws from the driver's side front wheel well (white arrows). Using a flat screwdriver, remove the push pin from the driver's side front wheel well (gray arrow). Repeat this on the passenger's side and set aside to be reinstalled later.

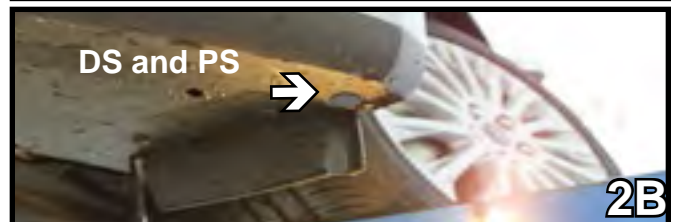

2. Starting forward of the driver's side front tire, use a flat screwdriver and remove six push pins from the lower edge of fascia. Set pins aside to be reinstalled later.

## BX2633

### 2012 Ford Focus 2013 Ford Focus Titanium

#### Installation Instructions

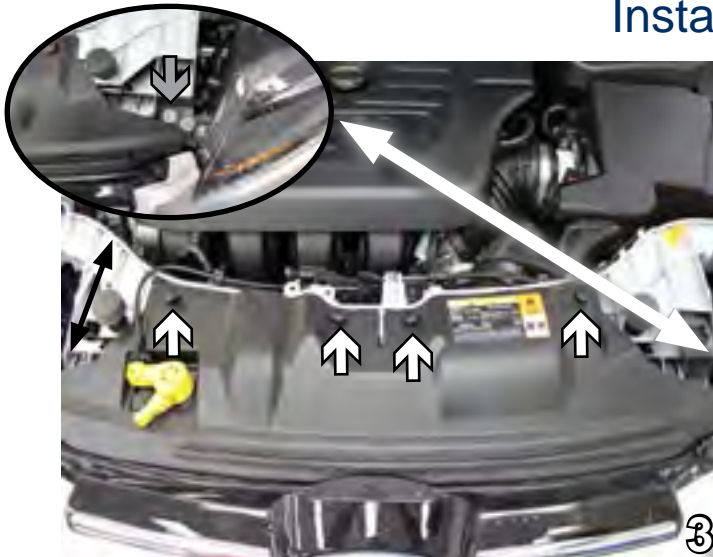

3. From the top of the fascia, using a T30 Torx, remove the inner-most bolt from each side (gray arrow). Remove four push pins (white arrows). Set all bolts and pins aside to be reinstalled later.

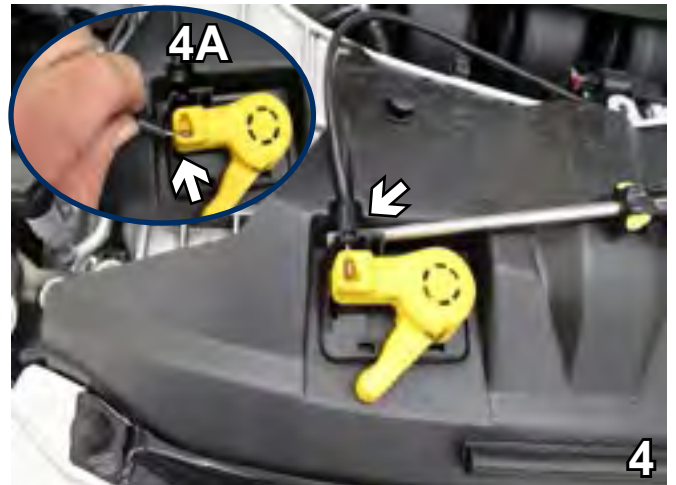

4. Using a flat screwdriver, pry the black hood latch cable out of the black mounting bracket (white arrow). Then rotate the wire left to release it (4A).



5. On the driver's side, locate the running lights main electrical cord. Disconnect the plug, and carefully remove the fascia.

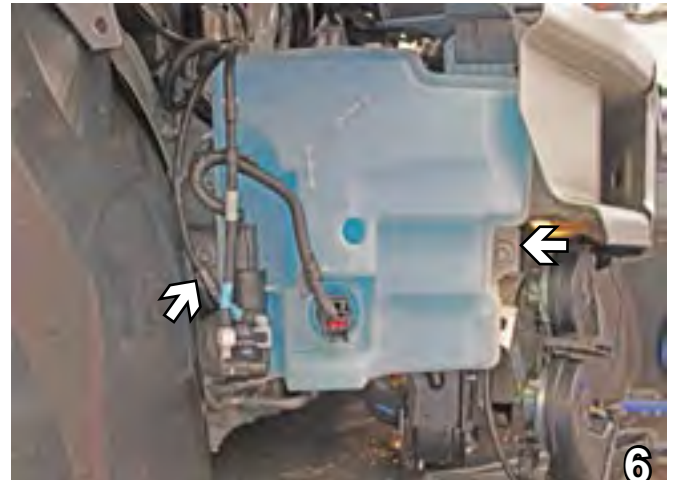

6. Using a 10MM socket, remove two bolts from the washer reservoir on the passenger's side only. Disconnect all electric and fluid lines (plug lines). Set back bolt and reservoir aside to be reinstalled later. The front bolt can be discarded.

7. Using a 10MM socket, remove the bolt from the passenger's side horn bracket. Disconnect and set horn bracket aside to be reinstalled later. The bolt may be discarded as a new one is provided.



## BX2633

### 2012 Ford Focus 2013 Ford Focus Titanium

### Installation Instructions



8. Using a T30 Torx, remove the flexible intake cover. Set aside with bolts to be reinstalled later.

When using power drills be aware of the dangers of torque and drill bit length.



9. On the front bumper, using a 1-1/4" hole saw, slowly drill a hole centered vertically and horizontally on the flat area as shown. Do this on both sides of the vehicle. NOTE: The hole cut is used to place nut plates for future steps.



10. On the driver's side, use a 8MM socket to remove the bolt from the frame webbing (10A). Once bolt is removed, bend the webbing outward with a pair of large vice grips far enough to fit the baseplate on top of it (10B). Set bolt aside to be reinstalled later.

Using a good quality paint, spray cut edges of frame to prevent rusting.

11. Locate on the driver's side, the rectangular plastic knob attached to the front bumper. With a utility knife, trim inward from flush with the metal part of the bumper through the knob to its innermost edge. Do this on both sides.

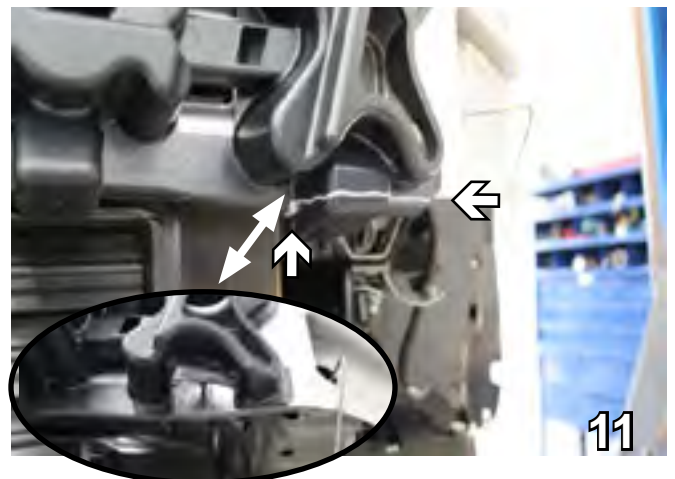



# BX2633

## 2012 Ford Focus 2013 Ford Focus Titanium Installation Instructions

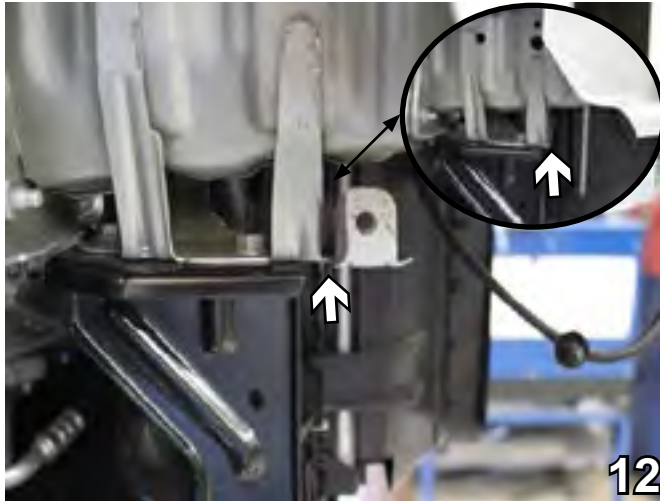

12. On the passenger's side only, use a reciprocating saw to remove the washer reservoir bracket and horn front bracket.

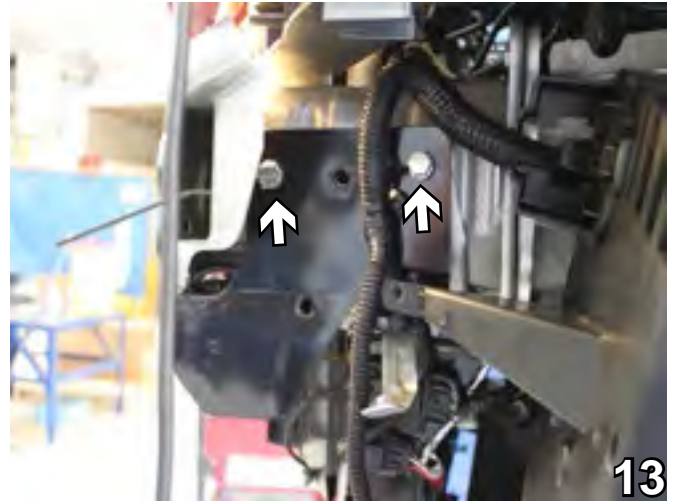

13. On the driver's side, slide the baseplate on top of the bracket we bent down earlier until the top back hole is aligned with the top back existing hole on the frame webbing. Insert a 3/8-16 x 1 1/2" hex bolt and 3/8" lock washer with a 1/4" x 1" x 1" nut plate. Also secure the top front hole the same way. **DO NOT** tighten bolts all the way, wait until directed to do so. Do this on both sides of the vehicle.



14. Using the baseplate as a template, drill a hole through the bottom of the frame webbing using a 13/32" drill bit (14A). Do this on both sides of the vehicle. Insert a 3/8-16 x 1 1/2" hex bolt with a 3/8" lock washer and 1/4" x 1" x 1" nut plate through the hole on the bottom of the baseplate. Make sure baseplate is level, then tighten (14B). Do this to both of the bottom holes **FIRST**, then tighten the two top bolts on each side (13). Tighten all bolts with Loctite Red.



**BE SURE TO USE LOCTITE® RED ON ALL BOLTS BEFORE TIGHTENING. TIGHTEN ALL BOLTS ACCORDING TO THE TORQUE CHART ON THE FRONT PAGE OF THESE INSTRUCTIONS OR ON PAGE 3 OF THE BASEPLATE TOWING GENERAL INSTRUCTIONS.**



## BX2633

### 2012 Ford Focus 2013 Ford Focus Titanium Installation Instructions



15. If necessary, drill a hole through any obstruction from frame webbing in the middle hole of the baseplate with a 13/32" drill bit. Insert a 3/8-16 x 1 1/2" hex bolt and 3/8" lock washer with a 1/4" x 1" x 1" nut plate. Tighten with Loctite Red. Do this on both sides.

17. To reattach the horn, use the existing hole in the frame webbing on the passenger's side and the existing hole on the horn bracket, and insert a 1/4-20 x 3/4" hex bolt with a 1/4" lock washer and 1/4-20 nut. Reattach all electrical connections. Tighten all bolts with Loctite Red.

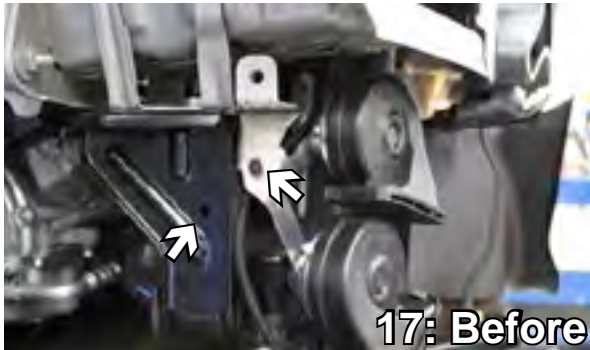

17: Before

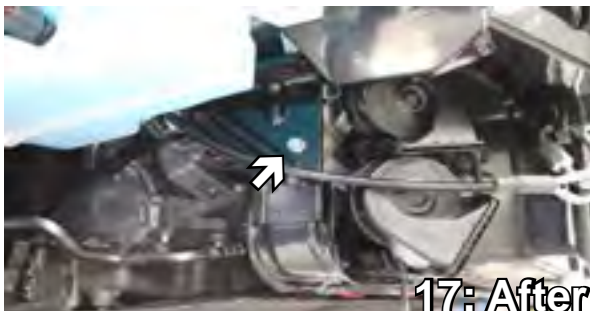

17: After

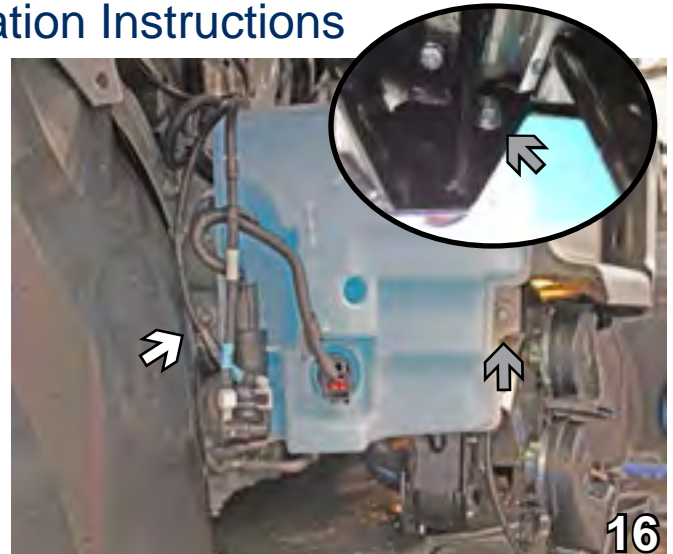

16. Reattach the washer reservoir on the passenger's side. Use the existing bolt in the back (white arrow). Use a 3/8-16 x 1" hex bolt with a 3/8" flat washer and a 3/8" hex nut and secure the front hole to the baseplate (gray arrow). Tighten bolts with Loctite Red.

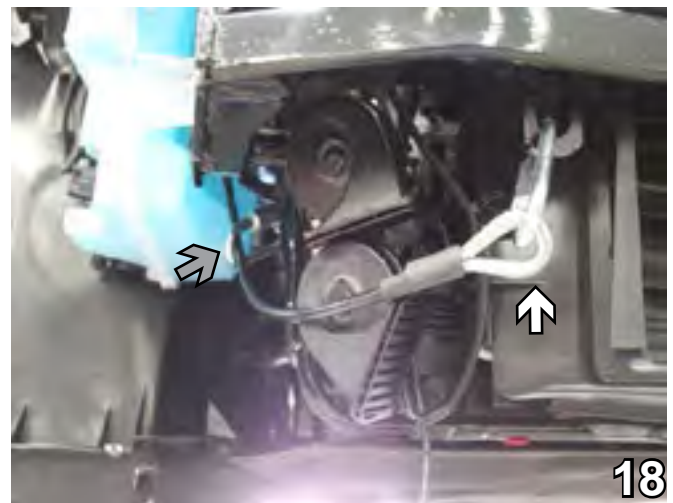

18. Attach the permanent baseplate safety cables to the provided convenience link on the baseplate (white arrow). The photo above shows the recommended installation of the permanent baseplate safety cables to frame of the vehicle (gray arrow). If the vehicle has additional options, not shown above, which interfere with mounting the permanent baseplate safety cables, secure the cable to a solid piece of the vehicle's frame as described in the instructions included with the permanent baseplate safety cables.



# BX2633

## 2012 Ford Focus 2013 Ford Focus Titanium

### Installation Instructions



19. Bend the webbing bracket back to its original position and reinstall the 10MM bolt.

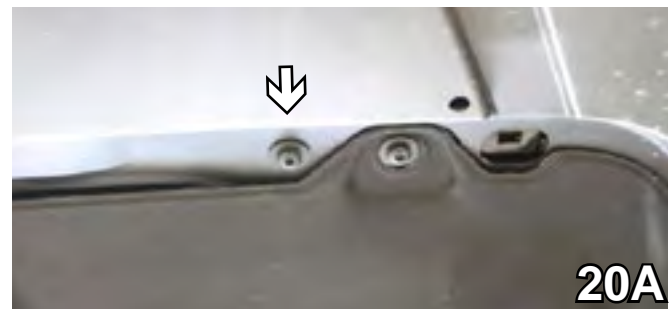

20. **Optional:** To install a breakaway switch, you must remove the belly pan with a T30 Torx. Remove four bolts (total) from in front of both the driver's and passenger's side tires and follow the pan toward the middle of the vehicle removing the three specified bolts (A and B). Total of seven bolts. Set all bolts and pan aside to be reinstalled later.



21. **Optional:** Using a 1/4-20 x 1/2" hex bolt with a 1/4" lock washer, attach the breakaway bracket to an existing hole on the frame webbing, just slightly toward the passenger's side of the vehicle (white arrow). Attach the breakaway using a 1/4-20 x 3/4" hex bolt, a 1/4" spacer nut, and a 1/4-20 hex nylon nut (gray arrow). Attach all electrical connections. Tighten all bolts with Loctite Red. NOTE: Breakaway should stick out the bottom of the fascia once reinstalled.





# BX2633

## 2012 Ford Focus 2013 Ford Focus Titanium Installation Instructions

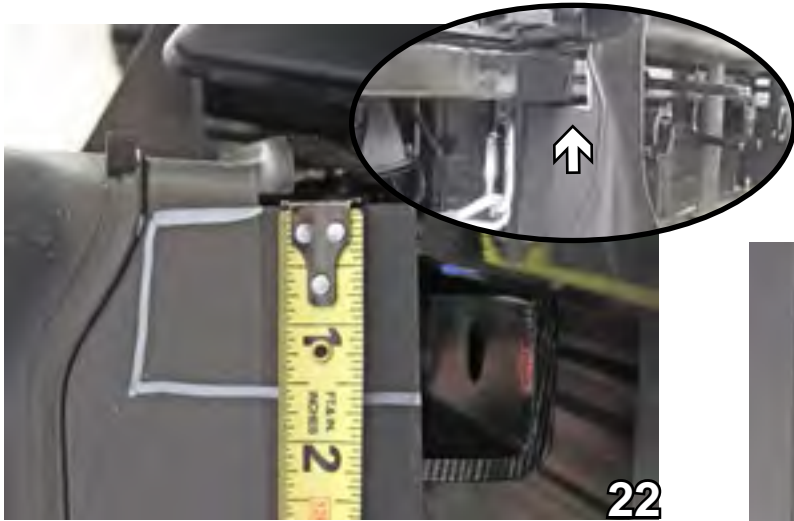

22. To reattach the intake cover, use a utility knife to cut from the back upper corner of the side wall a 2 1/2" x 1 1/2" rectangle from each side of the cover. Reinstall using the two T30 Torx bolts from step 8. NOTE: If breakaway was installed, make sure that bottom of the cover goes below the breakaway bracket (22:NOTE).



23. Align the fascia to its original position and trim the opening for the attachment tabs with a utility knife (white arrows). Do this on both sides of the vehicle. **Optional:** Attach the electrical bracket to the center of the fascia (gray arrow).

Be sure that **ALL** electrical connections are plugged in properly and functioning **BEFORE** installing the fascia.

24. Reconnect the large electrical plug from step 5. Reinstall belly pan, fascia, bolts and push pins.



## **BX2633**

### 2012 Ford Focus 2013 Ford Focus Titanium Installation Instructions

Install the tow bar and safety cables according to the instructions provided in their packages. When demonstrating to customer, be sure to include all original content and packages. Do **NOT** substitute other devices if the tow bar pins and clips are misplaced.

**DEALER or INSTALLER:**  
**Be certain the user receives the instruction sheets for their products.**

### **Customer Service Commitment**

Blue Ox is committed to providing you with exceptional customer care throughout your lifetime with our products. Our team is here to assist you with any questions you may have regarding the performance of your product. Simply call (402) 385-3051 and you can speak with our customer care team.

Additionally, please visit our website to see which rallies our Destination America team will be attending. For a nominal fee, our service technician will service your towing system to ensure it's in proper working condition. Also, as a commitment to our customers, should you visit our factory, you can stay at our full service Blue Ox campground at no charge along with enjoying a factory tour.

Again, thank you for being our customer and for the confidence you have shown in the performance of our products. It is because of customers like you we enjoy the success we have today.



**Shown without removable tabs installed.**



**Shown with removable tabs installed.**

**If the baseplate is in an accident, it must be replaced. DO NOT use it again! An accident can cause unseen damage and using it again could result in more damage or serious injury. DO NOT use the baseplate if it is damaged or missing parts.**



© 2012 Blue Ox  
One Mill Road, Industrial Park  
Pender, Nebraska 68047  
Phone: (402) 385-3051 • Fax: (402) 385-3360  
[www.blueox.com](http://www.blueox.com)