

**11469****TOYOTA PRIUS**

9/17/2009

**GROSS LOAD CAPACITY WHEN USED AS A WEIGHT CARRYING HITCH: 2,000 LBS. TRAILER WEIGHT & 200 LBS. TONGUE WEIGHT.**

\*\*\*DO NOT EXCEED VEHICLE MANUFACTURER'S RECOMMENDED TOWING CAPACITY.\*\*\*

**WARNING: ALL NON-TRAILER LOADS APPLIED TO THIS PRODUCT MUST BE SUPPORTED BY AUXILIARY STABILIZING STRAPS.**

\*\* FAILURE TO PROPERLY SUPPORT NON-TRAILER LOADS WILL VOID PRODUCT WARRANTY\*\*

**HAVING INSTALLATION QUESTIONS? CALL TECHNICAL SUPPORT AT 1-800-798-0813**

## Parts List

ITEM	QTY	PART NUMBER	DESCRIPTION
1	4	M12 - 1.25 x 40 HEX	HEX BOLT
2	4	1/2"	CONICAL TOOTHED WASHER

## TOOLS REQUIRED

RATCHET

TORQUE WRENCH

EXTENSION

17mm SOCKET

19mm SOCKET

NOTE: BALL MOUNT MUST BE USED IN RISE POSITION ONLY

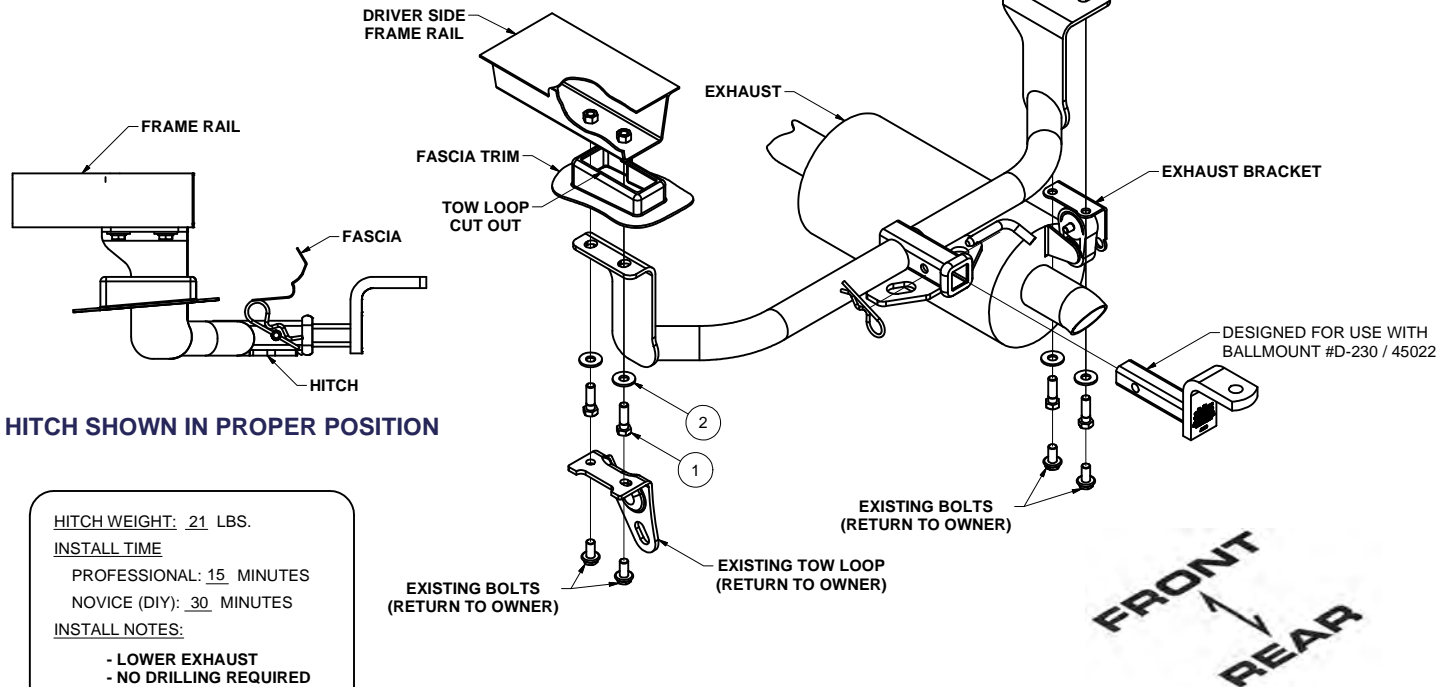
**HITCH SHOWN IN PROPER POSITION**HITCH WEIGHT: 21 LBS.

## INSTALL TIME

PROFESSIONAL: 15 MINUTESNOVICE (DIY): 30 MINUTES

## INSTALL NOTES:

- LOWER EXHAUST
- NO DRILLING REQUIRED

**INSTALLATION STEPS**

1. Remove existing bolts from exhaust hanger and lower exhaust. Support exhaust as needed to prevent damage. Return bolts to owner.
2. Remove existing bolts from tow loop. Return tow loop and bolts to owner.  
**NOTE: Access bolts through tow loop cut out in fascia.**
3. Position hitch by raising the driver side plate through the tow loop cut out and up against the frame rail. Secure using a M12 - 1.25 X 40mm bolts and 1/2" conical toothed washers into existing weldnuts as shown.
4. Sandwich the passenger side plate between the frame rail and exhaust bracket. Secure using M12 - 1.25 X 40mm bolts and 1/2" conical toothed washers as shown.
5. Torque all 12mm fasteners to 65 ft-lbs.

PERIODICALLY CHECK THIS RECEIVER HITCH TO ENSURE THAT ALL FASTENERS ARE TIGHT AND THAT ALL STRUCTURAL COMPONENTS ARE SOUND.

Curt Manufacturing Inc., warrants this product to be free of defects in material and/or workmanship at the time of retail purchase by the original purchaser. If the product is found to be defective, Curt Manufacturing Inc., may repair or replace the product, at their option, when the product is returned, prepaid, with proof of purchase. Alteration to, misuse of, or improper installation of this product voids the warranty. Curt Manufacturing Inc.'s liability is limited to repair or replacement of products found to be defective, and specifically excludes liability for incidental or consequential loss or damage.