

13070**2000-06 BMW X5 SUV****3/3/2011****GROSS LOAD CAPACITY WHEN USED AS A WEIGHT CARRYING HITCH: 5,000 LBS. TRAILER WEIGHT & 500 LBS. TONGUE WEIGHT.**

DO NOT EXCEED VEHICLE MANUFACTURER'S RECOMMENDED TOWING CAPACITY.

WARNING: ALL NON-TRAILER LOADS APPLIED TO THIS PRODUCT MUST BE SUPPORTED BY AUXILIARY STABILIZING STRAPS.

** FAILURE TO PROPERLY SUPPORT NON-TRAILER LOADS WILL VOID PRODUCT WARRANTY**

HAVING INSTALLATION QUESTIONS? CALL TECHNICAL SUPPORT AT 1-800-798-0813

Parts List			
ITEM	QTY	PART NUMBER	DESCRIPTION
1	2	1/2-13 x 1 3/4	HEX BOLT
2	2	HFN 1213	HEX FLANGE NUT
3	2	7/16-14 x 1 1/4	HEX BOLT
4	2	7/16-14	HEX FLANGE NUT

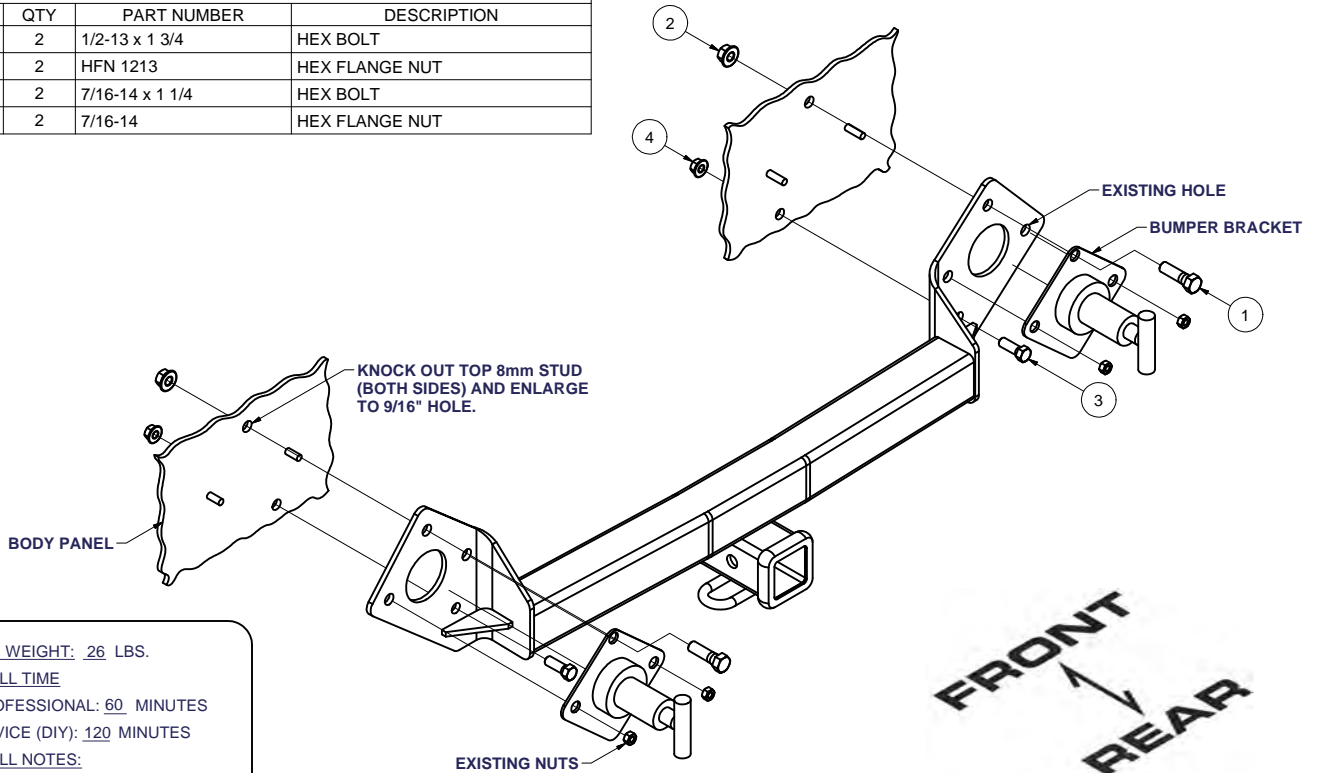
HITCH WEIGHT: 26 LBS.

INSTALL TIME

PROFESSIONAL: 60 MINUTESNOVICE (DIY): 120 MINUTES

INSTALL NOTES:

- DRILLING REQUIRED

INSTALLATION STEPS

- 1) Remove fascia screws located at wheel wells and a vertical bolt (Torx T-55 socket) at each tubular bumper bracket above exhaust tips. Remove three screws (four clips on later models) securing lower fascia near center. Small fascia "window" panel will be removed for hitch receiver.
- 2) Left and right interior panels along with three plastic "trays" must be temporarily removed for bumper bracket fastener removal and frame rail access inside the rear of the vehicle.
- 3) Remove both bumper brackets (three 8mm nuts) and bumper carrier by removing (10) Torx T-50 fasteners. Bumper carrier (black steel cross member) is not reinstalled.
- 4) Remove (only) top two 8mm studs from the body panel for bumper bracket flanges (knock out with hammer). Enlarge these holes to 9/16" diameter for 1/2"-13 bolts.
- 5) Reinstall bumper brackets over hitch and secure with 1/2"-13 x 1 3/4" bolt and 1/2" hex flange nut in the top hole of each bumper bracket and hitch mounting plate, the 7/16"-14 x 1 1/4" bolt and 7/16" hex flange nut in the bottom hitch hole, and the existing 8mm nuts. (Before torquing hardware verify the bumper bracket support hole distance matches the mounting hole distance in bumper).
- 6) Secure any wires that may come in contact with the hitch. (Trim fascia knock out to provide clearance for receiver.)
- 7) Torque 7/16" hardware to 50 lb.-ft., 1/2" hardware to 75 lb.-ft, and existing M8 hardware to 17 lb.-ft. Reinstall interior items and bumper fascia. Return unused items to owner.

PERIODICALLY CHECK THIS RECEIVER HITCH TO ENSURE THAT ALL FASTENERS ARE TIGHT AND THAT ALL STRUCTURAL COMPONENTS ARE SOUND.

Curt Manufacturing Inc., warrants this product to be free of defects in material and/or workmanship at the time of retail purchase by the original purchaser. If the product is found to be defective, Curt Manufacturing Inc., may repair or replace the product, at their option, when the product is returned, prepaid, with proof of purchase. Alteration to, misuse of, or improper installation of this product voids the warranty. Curt Manufacturing Inc.'s liability is limited to repair or replacement of products found to be defective, and specifically excludes liability for incidental or consequential loss or damage.

75148 / 757234