



INSTALLATION INSTRUCTIONS FOR PART 99-5812

APPLICATIONS

FORD

Edge 2007-2009 / Expedition 2007-2009
 Explorer 2006-2009 / Explorer Sport Trac 2006-2009
 F-150 2004-2008 / F Series 2005-2008
 Five-Hundred 2005-2007 / Focus 2005-2007 / FreeStar 2004-2007
 Freestyle 2005-2007 / Fusion 2006-2009
 Mustang 2005-2009 / Super Duty 2008-2009
 Taurus 2008 / Taurus X 2008-2009

MERCURY

Monterey 2004-2007 / Milan 2006-2008
 Montego 2005-2007 / Mountaineer 2006-2009
 Sable 2008-2009

LINCOLN

Mark LT 2005-2008
 Factory Navigation Only: MKX 2007-2007-2009 / Navigator 2007-2009

99-5812



KIT FEATURES

- DIN Head Unit Provision with Pocket
- ISO DIN Head Unit Provision with Pocket

KIT COMPONENTS

A) Radio Housing • B) ISO Brackets • C) Trim Plate • D) Side brackets • E) Spacers • F) (4) Screws

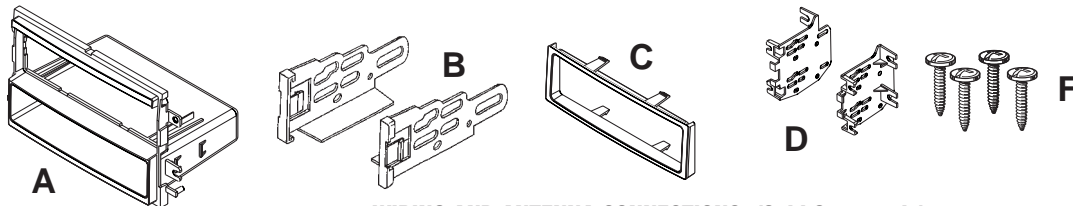

WIRING AND ANTENNA CONNECTIONS (Sold Separately)

Harness:

- 70-5520 - Ford Harness 2003-up
- 70-5521 - Ford Amplified Harness 2003-up
- 70-5522 - Ford Sub Harness 2003-up
- XSVI-5520 NAV - Ford Interface 2006-up

Antenna Adapter:

- 40-CR10 - Chrysler/GM Antenna Adapter 2002-up

TOOLS REQUIRED:

Cutting Tool • Phillips Screwdriver • Socket Wrench

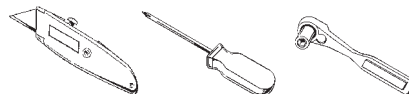

1-800-221-0932



www.metraonline.com

© COPYRIGHT 2004-2009 METRA ELECTRONICS CORPORATION

TABLE OF CONTENTS

Dash Disassembly

Ford Edge 2007-2009.....	1
Ford F-150 2004-2008 / Expedition 2007-2009.....	1
Lincoln Mark LT 2005-2008	1
Ford Mustang 2005-2009.....	2
Ford Five Hundred 2005-2007	3
Mercury Sable 2008-2009.....	3
Ford Taurus 2008-2009	3
Mercury Montego 2005-2007.....	3
Ford Fusion 2006-2009.....	4
Mercury Milan 2006-2008.....	4
Ford Freestyle 2005-2007.....	5
Ford Taurus X 2008 -2009	5
Ford Freestar 2004-2007	6
Mercury Monterey 2004-2007	6
Ford Focus 2005-2007.....	7
Ford Explorer 2006-2009	8
Ford Explorer Sport Trac 2006-2009	8
Mercury Mountaineer 2006-2009	8
Ford F Series Super Duty 2005-2008.....	9
Ford Super Duty 2008-2009.....	10
Lincoln MKX 2007-2009	11
Lincoln Navigator 2007-2009.....	12

Kit Assembly

DIN Head Unit Provision.....	13
ISO DIN Head Unit Provision	14

Final Assembly	15
-----------------------------	-----------

**Note: Refer also to the instructions included with the aftermarket radio.*



KNOWLEDGE IS POWER

Enhance your installation and fabrication skills by enrolling in the most recognized and respected mobile electronics school in our industry. Log onto www.installerinstitute.com or call 800-354-6782 for more information and take steps toward a better tomorrow.

FORD F-150 2004-2008
LINCOLN MARK LT 2005-2008
FORD EXPEDITION 2007-2009
FORD EDGE 2007-2009

- 1** Disconnect the negative battery terminal to prevent an accidental short circuit.
- 2** Unsnap and remove entire panel surrounding the radio and climate controls. (Figure A)
- 3** Remove (4) 9/32" screws to remove the factory radio. (Figure B)

Continue to kit assembly

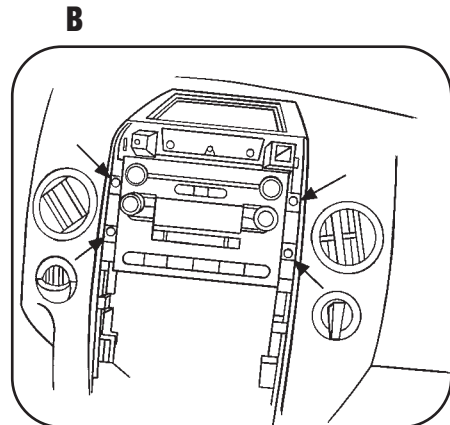
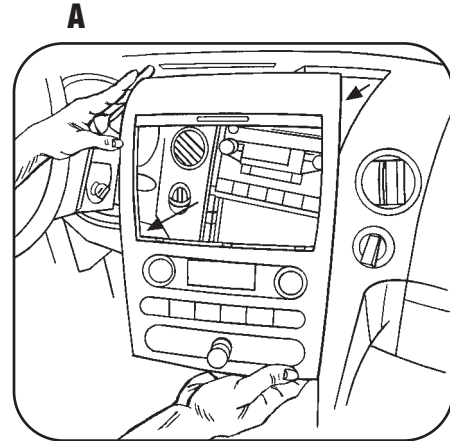

FORD MUSTANG 2005-2009

- 1 Disconnect the negative battery terminal to prevent an accidental short circuit.
- 2 Remove the small rectangular shifter lever trim panel if equipped. (Figure A)
- 3 Remove (2) Phillips screws from under the center armrest at the back of the shifter trim panel (including cup holders). (Figure B)
- 4 Unclip and remove panel. (Figure B)
- 5 Unclip and remove the (2) center stack trim panels from the left and right side of the radio and climate controls. (Figure C)
- 6 Remove (6) 9/32" screws from center trim panel surrounding the radio and climate controls then unclip and remove panel. (Figure D)
- 7 Remove (4) 9/32" screws from the radio to remove. (Figure E)

Continue to kit assembly

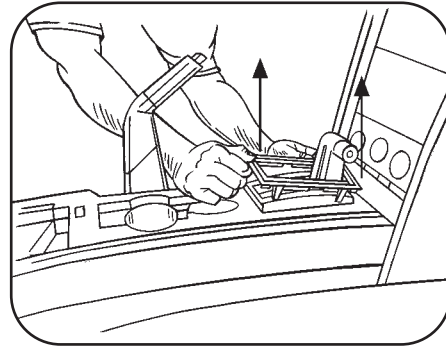
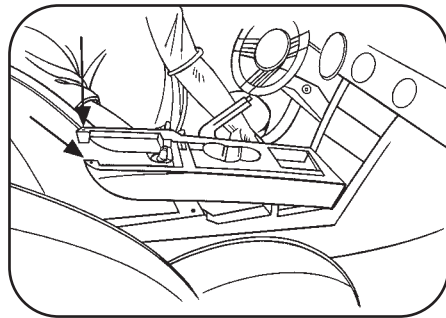
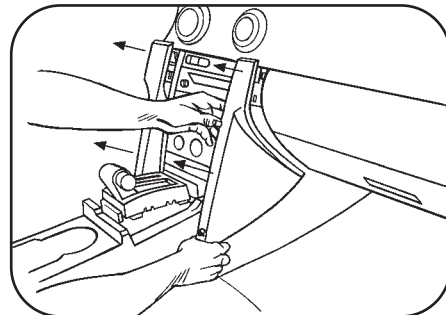
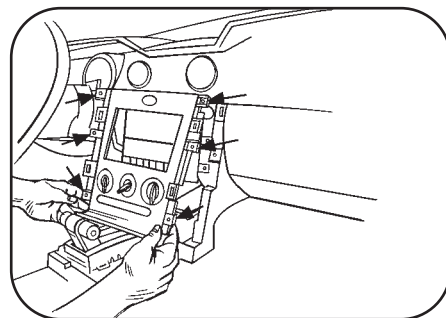
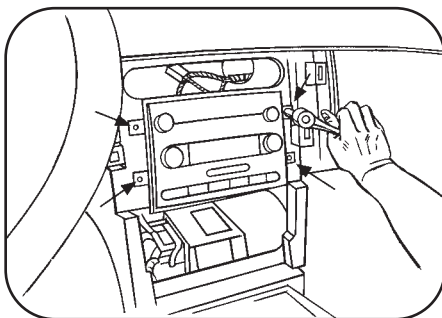
A**B****C****D****E**

**FORD FIVE-HUNDRED 2005-2007, FORD TAURUS 2008-09
MERCURY MONTEGO 2005-2007, MERCURY SABLE 2008-09**

- 1** Disconnect the negative battery terminal to prevent an accidental short circuit.
- 2** Unclip and remove the small rectangular trim around shift lever. (Figure A)
- 3** Unclip and remove the entire panel (including cup holders) surrounding the shift lever. (Figure B)
- 4** Remove (2) 9/32" screws at the bottom of the center radio/ climate control panel. (Figure C)
- 5** Unclip and remove the center panel. (Figure D)
- 6** Remove (4) 9/32" screws from the radio to remove. (Figure E)

Continue to kit assembly

A

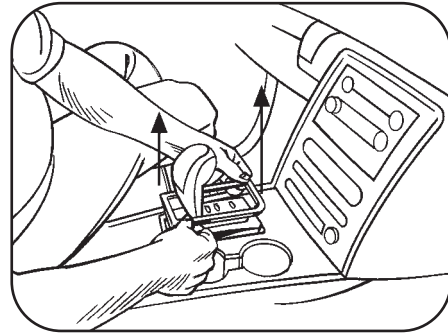

B

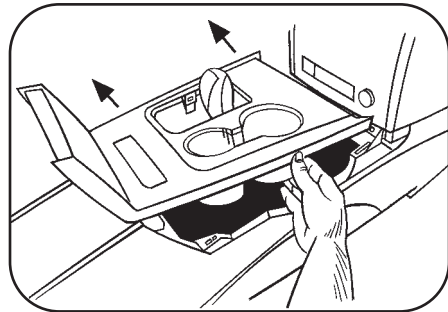

C

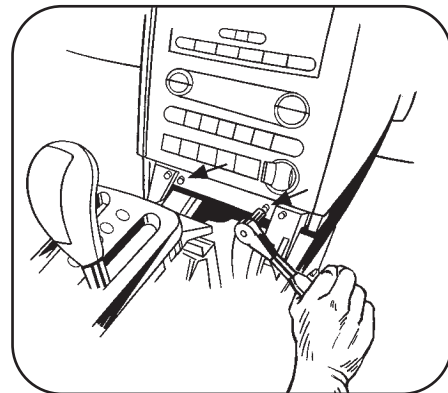

D

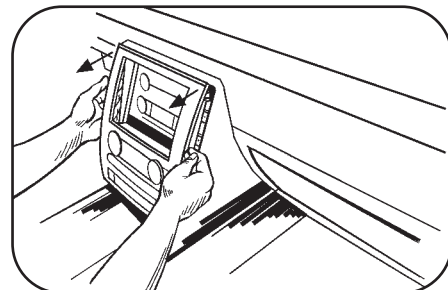

E

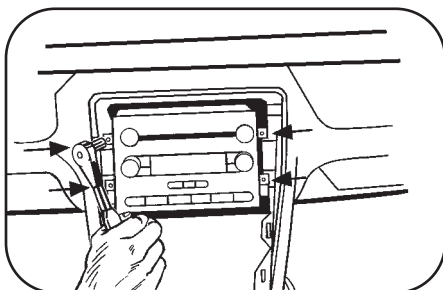

FORD FUSION 2006-2008 MERCURY MILAN 2006-2008

- 1 Disconnect the negative battery terminal to prevent an accidental short circuit.
- 2 Unsnap and remove entire panel surrounding the radio and climate controls. (Figure A)
- 3 Remove (4) 9/32" screws to remove the factory radio. (Figure B)

Continue to kit assembly

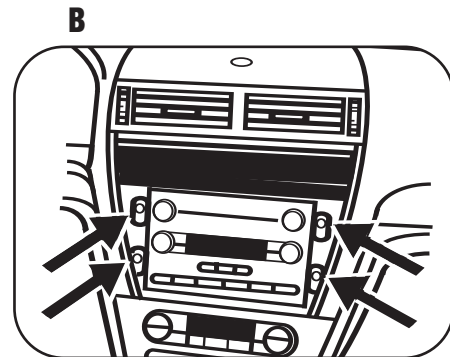
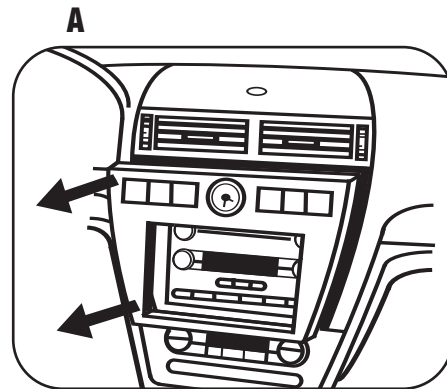

FORD FREESTYLE 2005-2007**FORD TAURUS X 2008-09**

- 1** Disconnect the negative battery terminal to prevent an accidental short circuit.
- 2** Unclip and remove entire panel surrounding the radio and a/c controls. (Figure A)
- 3** Remove (4) 9/32" screws from radio to remove. (Figure B)

Continue to kit assembly

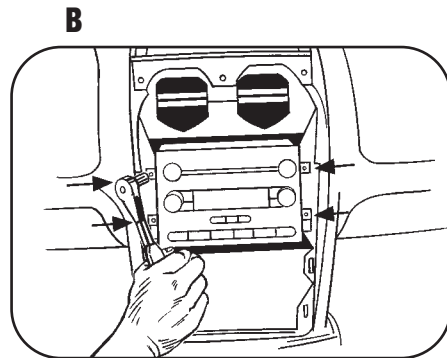
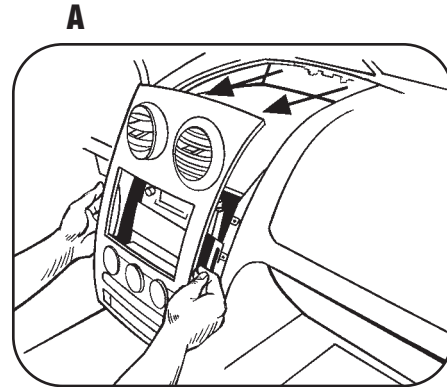

FORD FREESTAR 2005-2007
MERCURY MONTEREY 2004-2007

- 1** Disconnect the negative battery terminal to prevent an accidental short circuit.
- 2** Unsnap and remove entire panel surrounding the radio and climate controls. (Figure A)
- 3** Remove (4) 9/32" screws to remove the factory radio. (Figure B)

Continue to kit assembly

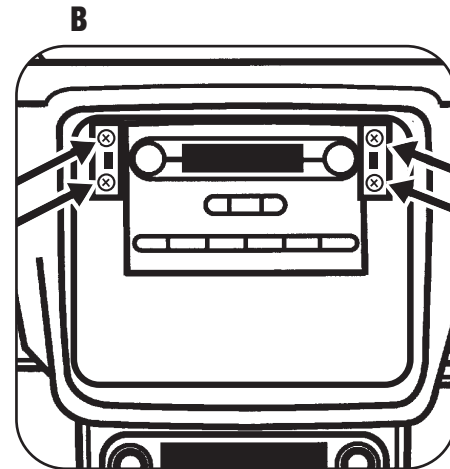
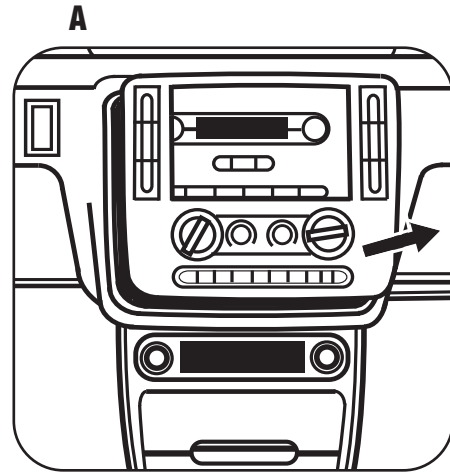

FORD FOCUS 2005-2007

- 1** Disconnect the negative battery terminal to prevent an accidental short circuit.
- 2** Unsnap and remove entire panel surrounding the radio and climate controls. (Figure A)
- 3** Remove (4) 9/32" screws to remove the factory radio. (Figure B)

Continue to kit assembly

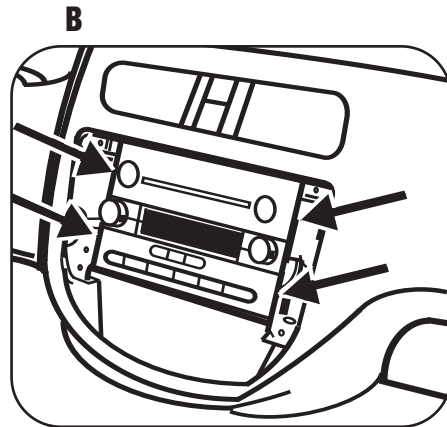
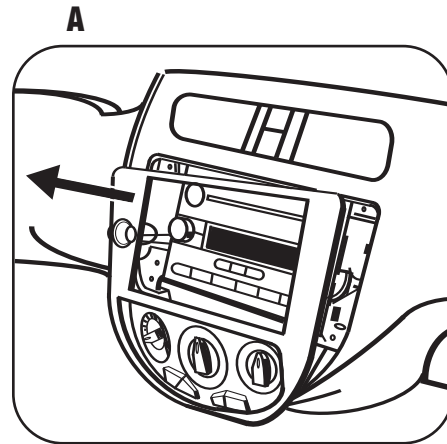

FORD EXPLORER 2006-2009

FORD SPORT TRAC 2006-2009

MERCURY MOUNTAINEER 2006-2009

- 1 Disconnect the negative battery terminal to prevent an accidental short circuit.
- 2 Open center console and remove (2) Phillips screws then unclip and remove entire panel surrounding shifter. (Figure A)

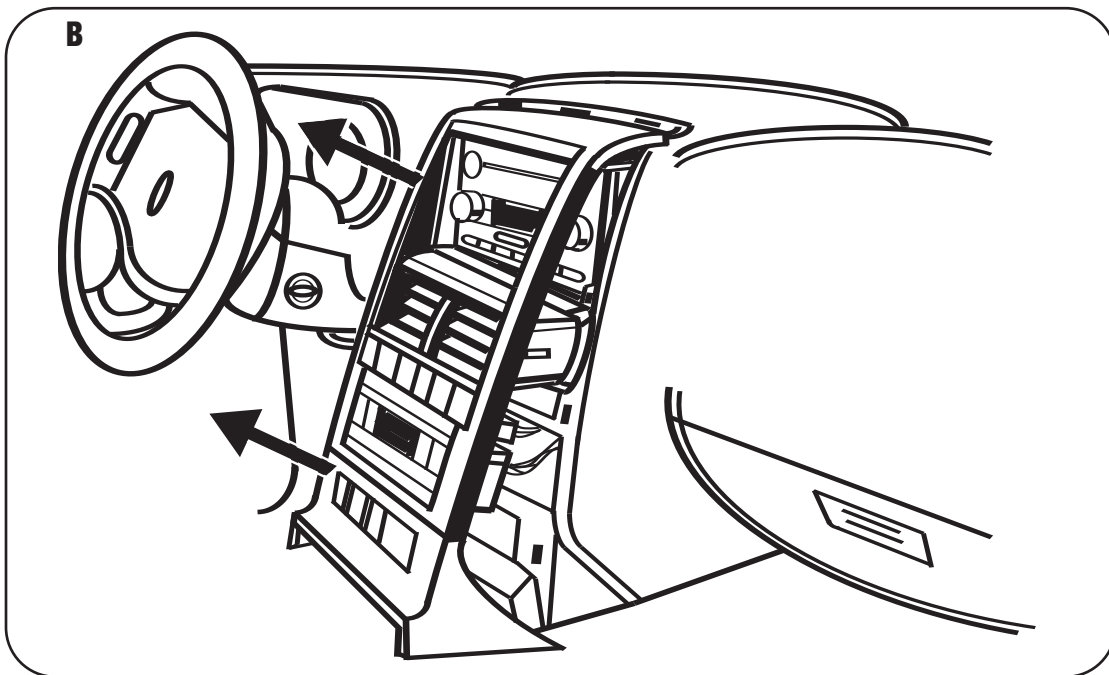
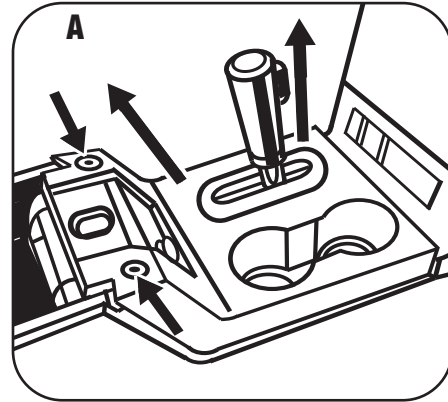

- 3 Remove dash panel surrounding radio to access the factory radio screws. (Figure B)

- 4 Remove (4) 9/32" screws to remove the factory radio. (Figure C)

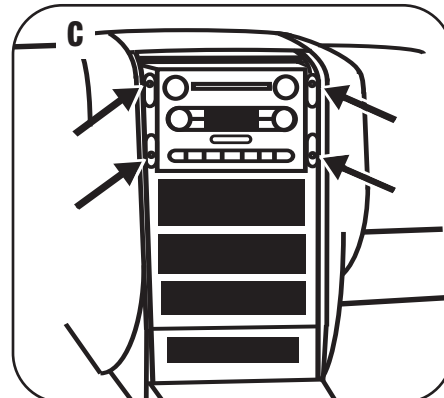

Continue to kit assembly

FORD F SERIES SUPER DUTY 2005-2009

- 1** Disconnect the negative battery terminal to prevent an accidental short circuit.
- 2** Unsnap and remove entire panel surrounding the radio and climate controls. (Figure A)

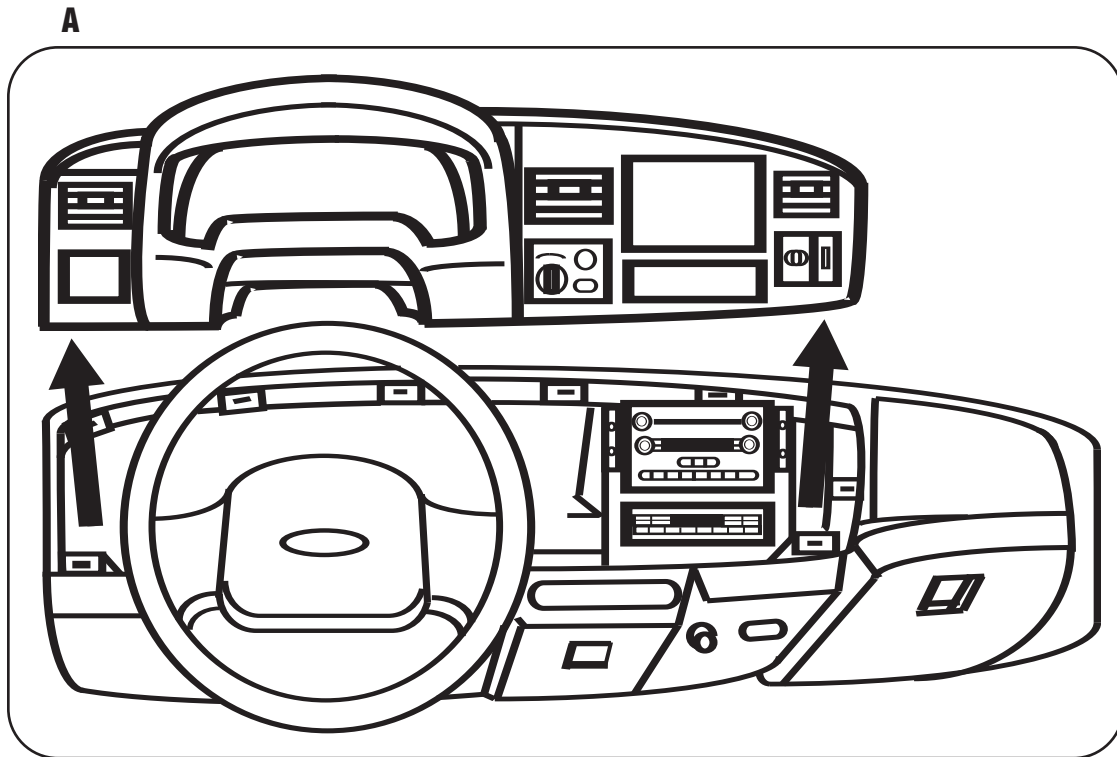

- 3** Remove (4) 9/32" screws to remove the factory radio. (Figure B)

Continue to kit assembly

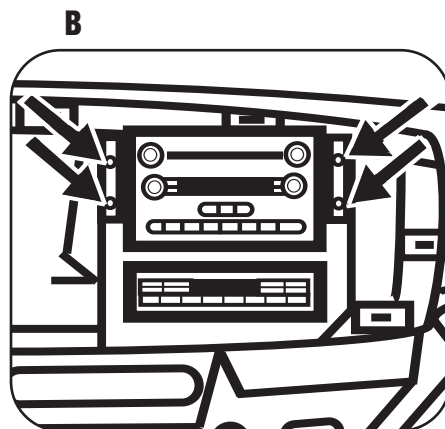

FORD SUPER DUTY 2008-2009

- 1 Disconnect the negative battery terminal to prevent an accidental short circuit.
- 2 Unclip and remove the power outlet panel and the blank panel on the left and right side of the radio trim panel.
(Figure A)

A

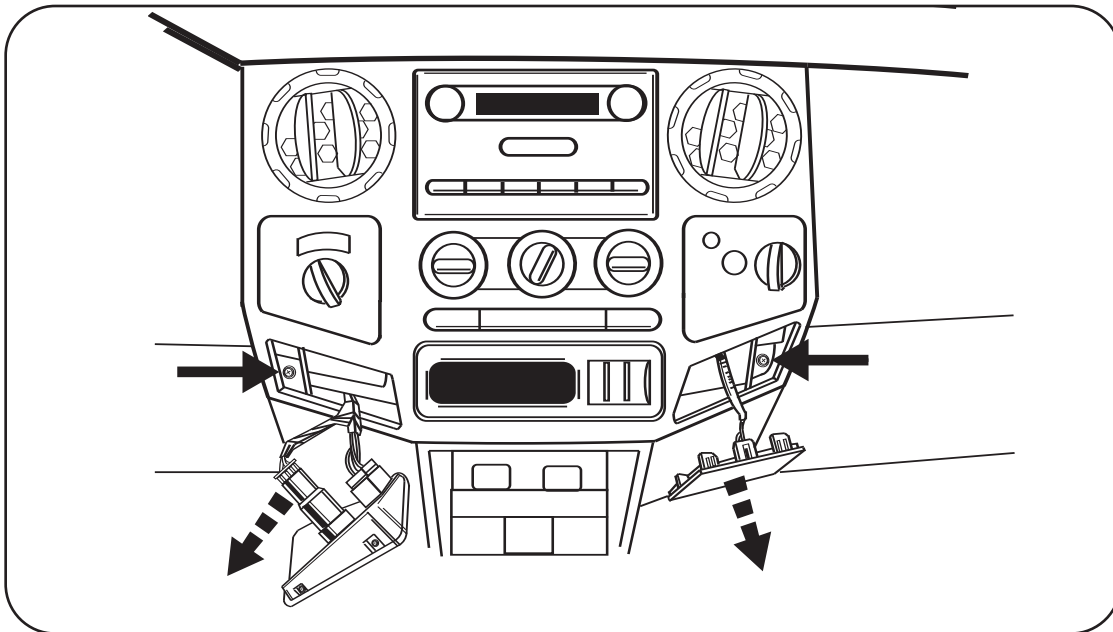

- 3 Remove the (2) 9/32" screws exposed behind the two panels remove in step 2.
- 4 Unclip and remove the entire radio trim panel including the a/c control and vents.
- 5 Remove (4) 9/32" screws securing the radio.

Continue to kit assembly

LINCOLN MKX 2007-2009

- 1** Disconnect the negative battery terminal to prevent an accidental short circuit.
- 2** Open center console lid and unclip and remove the center console trim panel surrounding the shifter. (Figure A)
- 3** Remove (2) Phillips screws from the storage bin then unclip and remove the bin. (Figure B)
- 4** Unclip and remove the upper and lower center trim panel as one assembly. (Figure C)
- 5** Remove (4) 9/32" screws securing the radio. Unplug and remove the Radio.

Continue to kit assembly

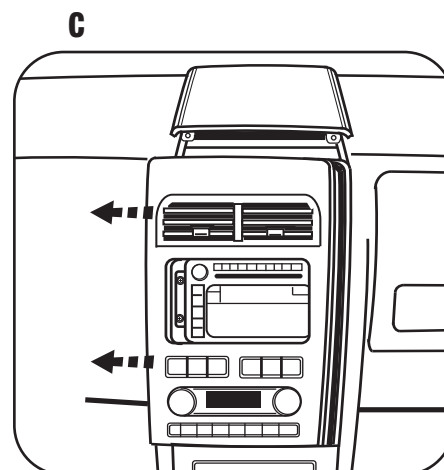
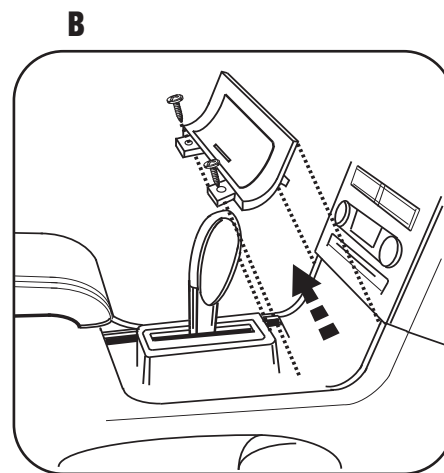
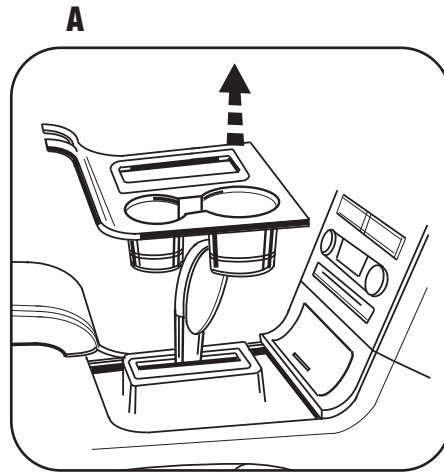

LINCOLN NAVIGATOR 2007-2009

- 1** Disconnect the negative battery terminal to prevent an accidental short circuit.
- 2** Unclip and remove the panel surrounding the shifter. (Figure A)
- 3** Remove (2) 9/32" screws from the bottom of the radio/climate control trim panel. (Figure B)
- 4** Unclip and remove the entire panel surrounding the radio and including the climate controls. (Figure B)
- 5** Remove (4) 9/32" screws securing the radio. Unplug and remove the Radio.

Continue to kit assembly

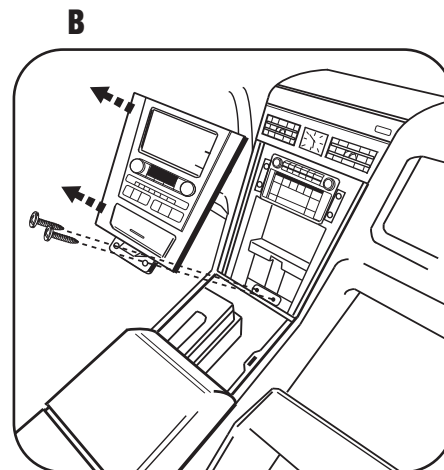
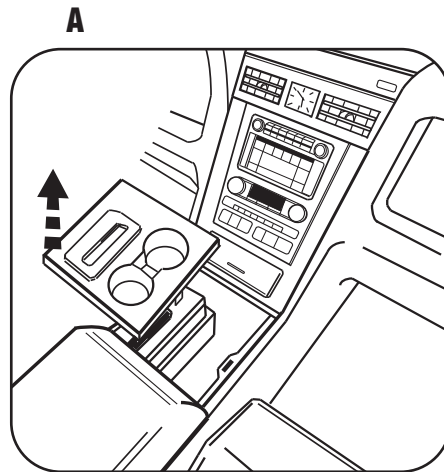

DIN HEAD UNIT PROVISION

NOTE: Refer also to the instructions included with the aftermarket radio.

- 1** (a) For the **Ford Edge/Expedition 2007, Explorer 2006-07, Fusion 2006-07, Mustang 2007 and the Super Duty 2008** attach the included spacers to the back of the radio housing mounting tabs. **(Figure 1A)**

NOTE: Use the screws supplied with this kit to mount the radio housing in the vehicles that require the spacers.

1A

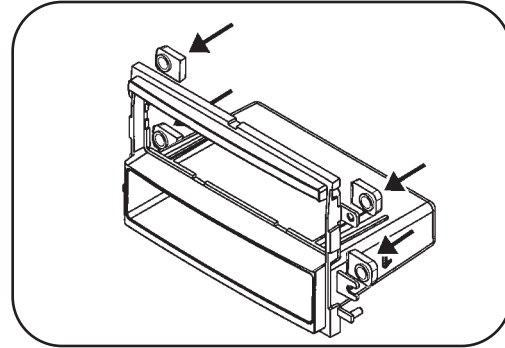

- (b) For the **Ford Freestar 2004-07, Monterey 2004-07, Focus 2005-07, and the F Series Super Duty 2005-07**, slide the included brackets onto the sides of the radio housings pocket from the back of the housing forward. **(Figure 1B)**

1B

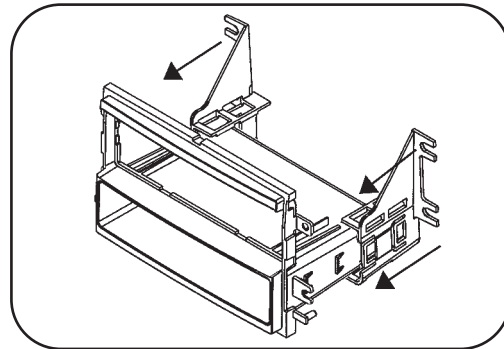

If your vehicle is not listed above move to step 2.

- 2** Slide the DIN cage into the Radio Housing and secure by bending the metal locking tabs outward. **(Figure A)**

A

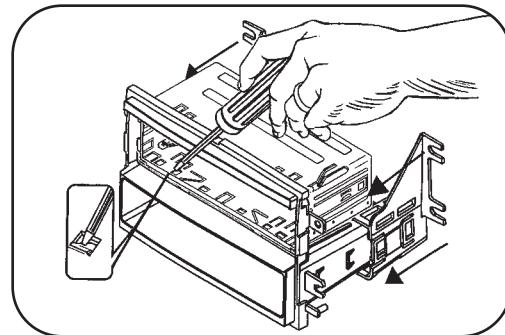

B

- 3** Slide the aftermarket radio into the cage until it snaps in place. **(Figure B)**

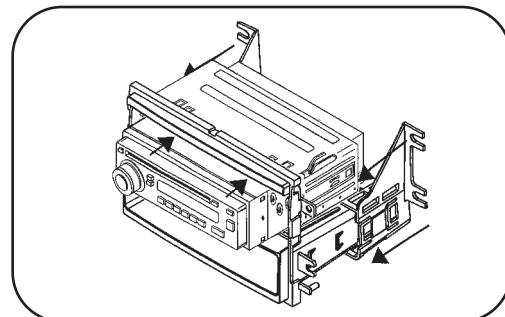

Continue to final assembly

ISO DIN HEAD UNIT PROVISION

NOTE: Refer also to the instructions included with the aftermarket radio.

- 1** (a) For the **Ford/Edge Expedition 2007, Explorer 2006-07, Fusion 2006-07, Mustang 2007** and the **Super Duty 2008** attach the included spacers to the back of the radio housing mounting tabs. **(Figure 1A)**

1A

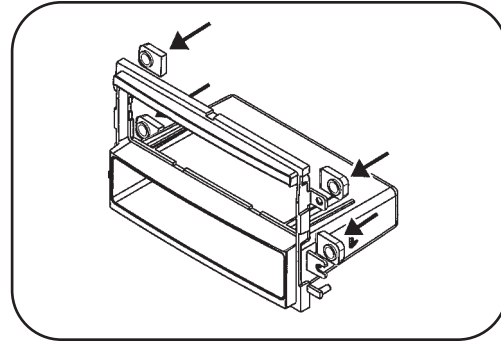

NOTE: Use the screws supplied with this kit to mount the radio housing in the vehicles that require the spacers.

- (b) For the **Ford Freestar 2004-07, Monterey 2004-07, Focus 2005-07,** and the **F Series Super Duty 2005-07**, slide the included brackets onto the sides of the radio housings pocket from the back of the housing forward. **(Figure 1B)**

1B

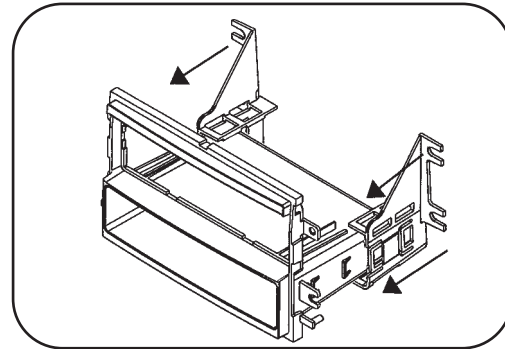

If your vehicle is not listed above move to step 2.

- 2** Mount the ISO Brackets to the head unit with the screws supplied with the unit. **(Figure A)**

A

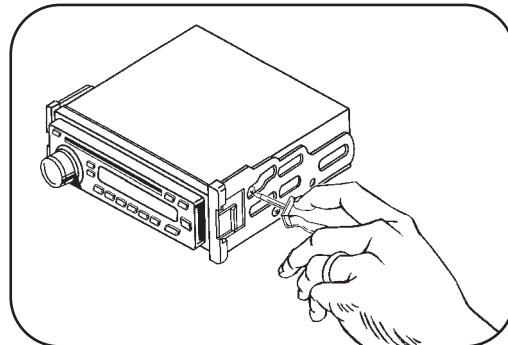

- 3** Slide the head unit into the radio opening until the side clips engage **(Figure B)**

B

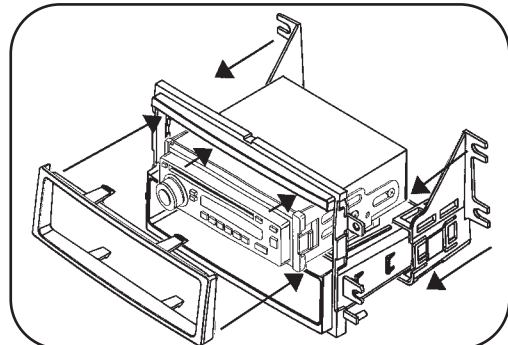

- 4** Snap the Trim plate into the Radio Housing. **(Figure B)**

FINAL ASSEMBLY

- 1** Locate the factory wiring harness in the dash and make the connection as shown. Metra recommends using the proper mating adapter and making the connections as shown. (Isolate and individually tape off the ends of any unused wires to prevent electrical short circuit.)
- 2** Re-connect the negative battery terminal and test the unit for proper operation.
- 3** Reassemble radio and dash assemblies in reverse order of disassembly.

NOTE: Use the screws supplied with this kit to mount the radio housing in the vehicles that require the spacers.

FINAL WIRING CONNECTIONS

Make wiring connections using the EIA color code chart shown below and the instructions included with the head unit. Metra recommends making connections as shown below; Strip, Splice, Solder, Tape. Isolate and individually tape off ends of any unused wires to prevent electrical short circuit.

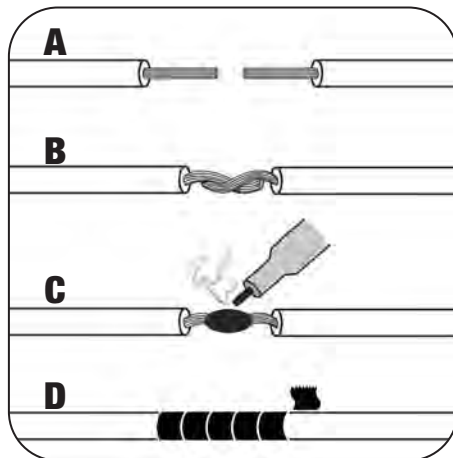

- A) Strip wire ends back 1/2"**
- B) Twist ends together**
- C) Solder**
- D) Tape**

METRA / EIA WIRING CODE

12V Ignition / Acc . . . Red	Right Front (+) Gray
12V Batt / Memory . . Yellow	Right Front (-) Gray / Black
Ground Black*	Left Front (+) White
Power Antenna Blue	Left Front (-) White / Black
Amp Turn-On Blue / White	Right Rear (+) Violet
Amp Ground Black / White	Right Rear (-) Violet / Black
Illumination Orange	Left Rear (+) Green
Dimmer Orange / White	Left Rear (-) Green / Black

***NOTE:** When Black a wire is not present, ground radio to vehicle chassis.

All colors may not be present on all leads due to manufacturer's specifications.

99-5812 INSTRUCTIONS



1-800-221-0932



www.metraonline.com

REV. 05/05/09

© COPYRIGHT 2004-2009 METRA ELECTRONICS CORPORATION

INST99-5812