

## KIT COMPONENTS

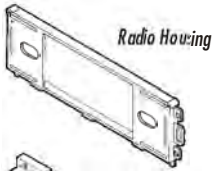

Radio Housing

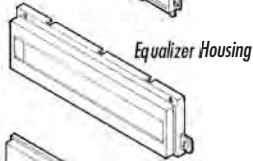

Equalizer Housing

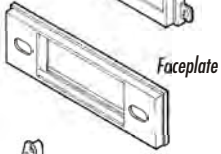

Faceplate

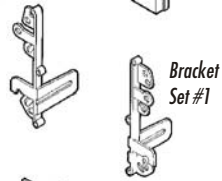

Bracket Set #1



Bracket Set #2



Filler Bar

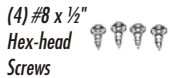

(4) #8 x 1/2" Hex-head Screws



(6) #8 x 3/4" Hex-head Screws

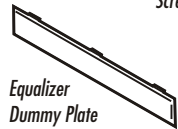

Equalizer Dummy Plate

## TOOLS REQUIRED



Phillips screwdriver



Cutting tool

# 99-7000 AW-612MI DW-7000 INSTALLATION INSTRUCTIONS

## APPLICATIONS

### CAR

### PAGE

#### DODGE

Colt 1987-88.....	1
Colt 1989-92.....	2
D-50 Pickup 1987-93.....	3
Raider 1987-91.....	4

#### EAGLE

Summit 1989-92.....	2
Summit (wagon) 1992-96.....	5
Talon 1990-94.....	6

#### MINI

Eclipse 1990-94.....	6
Expo 1992-95.....	5
Galant 1985-88.....	7
Galant 1989-93.....	8
Mighty Max Pickup 1987-96.....	3
Mirage 1985-88.....	1
Mirage 1989-92.....	2
Montero 1987-91.....	4
Sigma 1989-90.....	7
Van 1987-90.....	9

#### PLYMOUTH

Colt Vista 1992-94.....	5
Laser 1990-94.....	6



1-800-221-0932



www.metraonline.com

© COPYRIGHT 2001 METRA ELECTRONICS CORPORATION

rev. 230701

# DODGE Colt 1987-88

## MITSUBISHI Mirage 1985-88

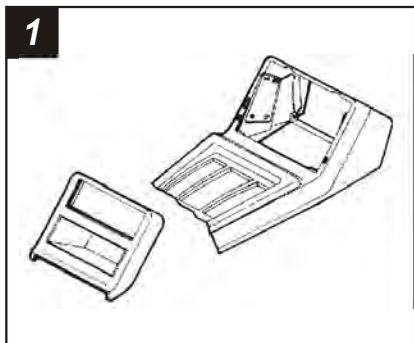

Disconnect the negative battery terminal to prevent an accidental short circuit. Remove the ashtray and (2) screws exposed. Unclip the gear shifter trim bezel and remove (4) screws exposed. Pop off the hazard switch and remove (1) screw exposed. Remove the dummy cap located below the brake lever and (2) screws exposed. Remove the screws securing the factory head unit and disconnect the wiring.

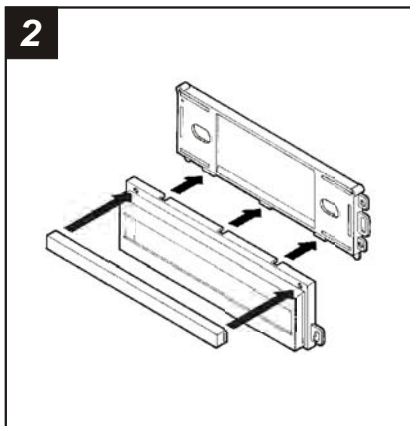

Snap the **Filler Bar** onto the **Equalizer Housing** and slide the assembly onto the bottom of the **Radio Housing**.

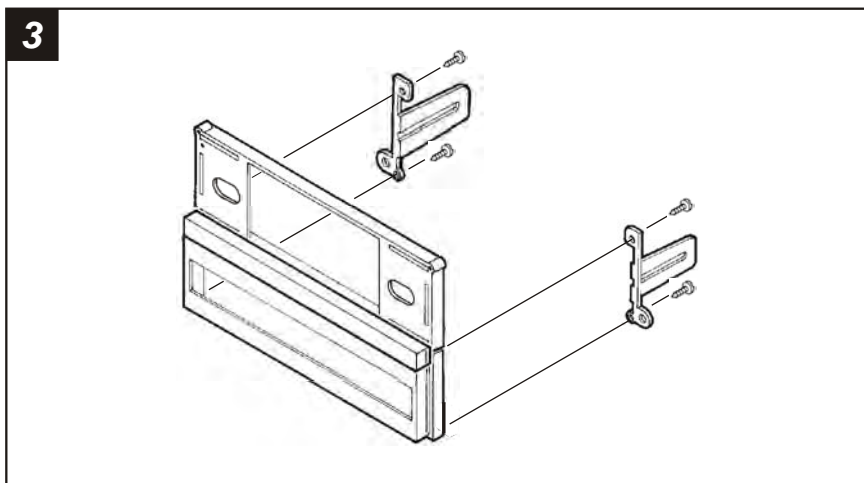

Mount **Bracket Set #2** to the back of the **Equalizer Housing** with (4) #8 x 1/2" Hex-head **Screws** supplied. Skip to the **Installation Instructions for ALL VEHICLES** on Page #10.

# DODGE Colt 1989-92 / EAGLE Summit 1989-92 MITSUBISHI Mirage 1989-92

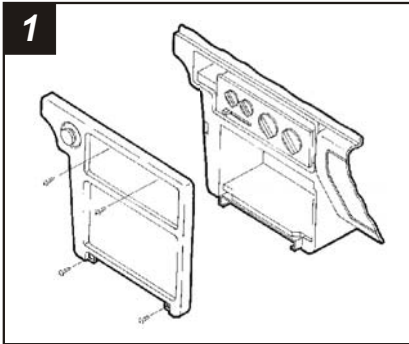

1  
Disconnect the negative battery terminal to prevent an accidental short circuit. Remove the ashtray. Remove (2) Phillips screws above the climate controls. Remove (2) Phillips screws from the bottom edge of the radio trim bezel and remove the bezel. Remove (4) Phillips securing the factory head unit and disconnect the wiring.

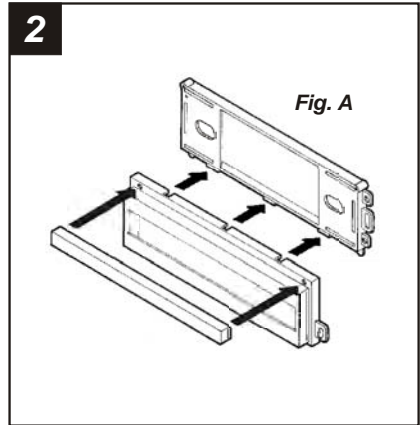

2  
Snap the **Filler Bar** onto the **Equalizer Housing** and slide the assembly onto the bottom of the **Radio Housing**. (see Fig. A). (The factory pocket may be used by omitting this step and mounting the pocket under the Radio Housing during installation).

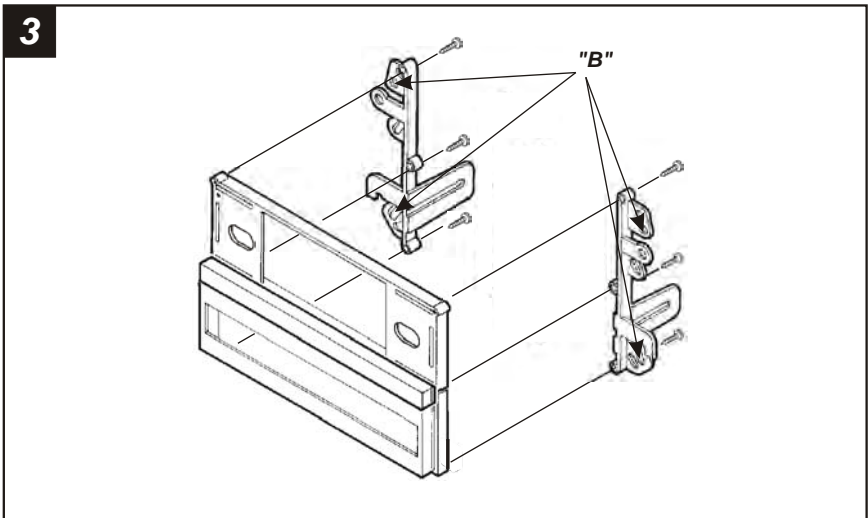

3  
Cut and remove all mounting tabs on **Bracket Set #1** EXCEPT tabs "B". The mounting tabs can be identified by the stamped letter on the back of each tab. Mount the converted Brackets to the back of the assembly with (6) #8 x 3/4" **Hex-head Screws** supplied. Skip to the *Installation Instructions for ALL VEHICLES* on Page #10.

# DODGE D-50 Pickup 1987-93

## MITSUBISHI Mighty Max 1987-96

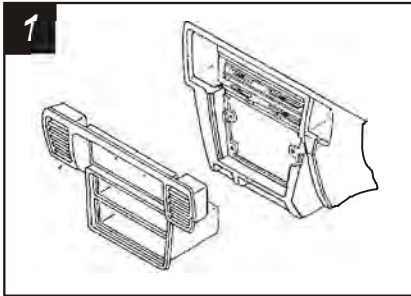

1  
Disconnect the negative battery terminal to prevent an accidental short circuit. Remove (2) screws located under the a/c vents. Remove the climate control knobs. Remove (2) screws above the climate controls. Using a small screwdriver, unclip the top of the dash trim bezel and remove the bezel. Remove (4) Phillips screws securing the factory head unit and disconnect the wiring.

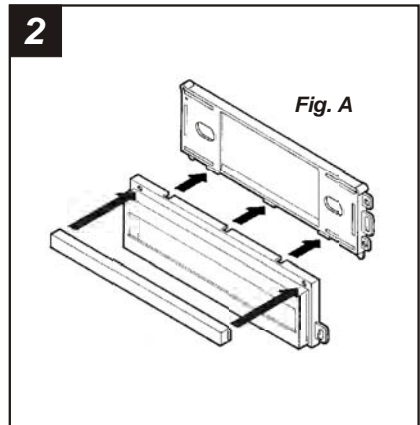

2  
Snap the **Filler Bar** onto the **Equalizer Housing** and slide the assembly onto the bottom of the **Radio Housing**. (see Fig. A). (The factory pocket may be used by omitting this step and mounting the pocket under the Radio Housing during installation).

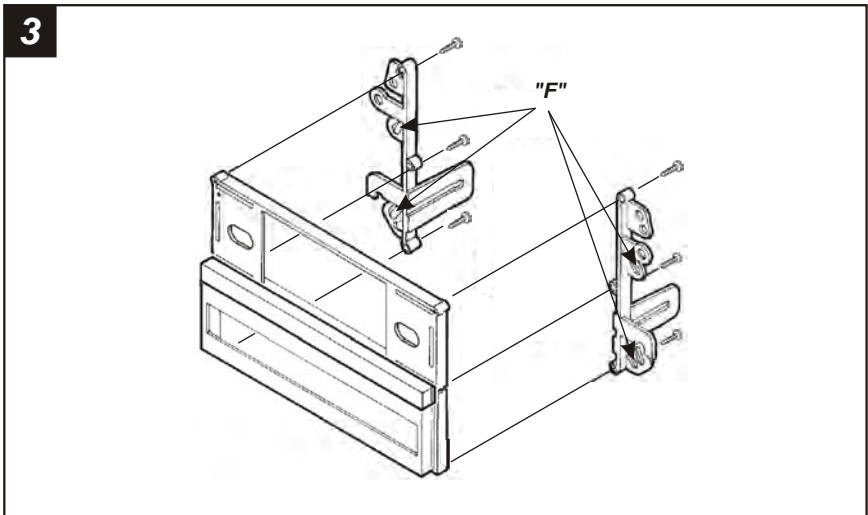

3  
Cut and remove all mounting tabs on **Bracket Set #1** EXCEPT tabs "F". The mounting tabs can be identified by the stamped letter on the back of each tab. Mount the converted Brackets to the back of the assembly with (6) #8 x 3/4" **Hex-head Screws** supplied. Skip to the *Installation Instructions for ALL VEHICLES on Page #10.*

# DODGE Raider 1987-91 MITSUBISHI Montero 1987-91

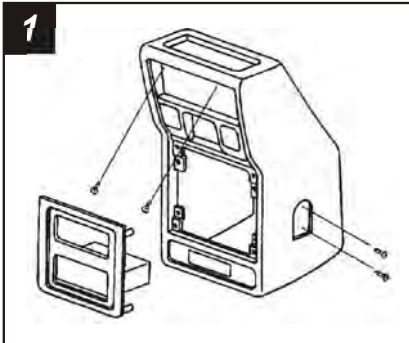

Disconnect the negative battery terminal to prevent an accidental short circuit. Remove the climate control knobs. Remove (2) screws above the climate controls. Pop off the cover caps from the sides of the dash console and remove (4) screws exposed. Remove (4) screws from the gear shifter plate and remove the plate. Pull the dash console assembly forward and disconnect the wiring. Remove (4) screws securing the radio trim bezel to the console and remove. Remove (4) screws securing the factory head unit and disconnect the wiring.

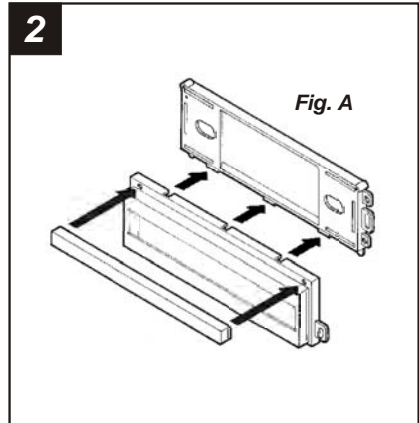

Snap the **Filler Bar** onto the **Equalizer Housing** and slide the assembly onto the bottom of the **Radio Housing**. (see Fig. A). (The factory pocket may be used by omitting this step and mounting the pocket under the Radio Housing during installation).

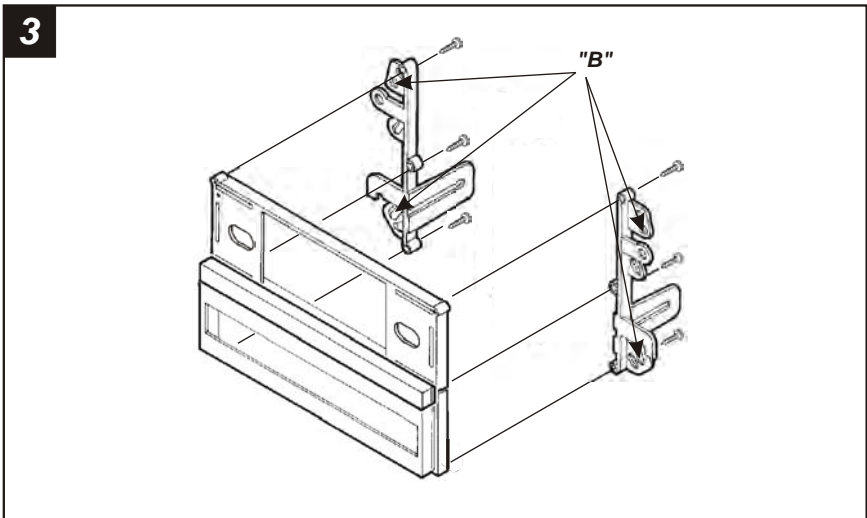

Cut and remove all mounting tabs on **Bracket Set #1** EXCEPT tabs "B". The mounting tabs can be identified by the stamped letter on the back of each tab. Mount the converted Brackets to the back of the assembly with (6) **#8 x 3/4" Hex-head Screws** supplied. Skip to the *Installation Instructions for ALL VEHICLES* on Page #10.

**EAGLE Summit (wagon) 1992-96 / MITSUBISHI Expo 1992-95  
PLYMOUTH Colt Vista 1992-94**

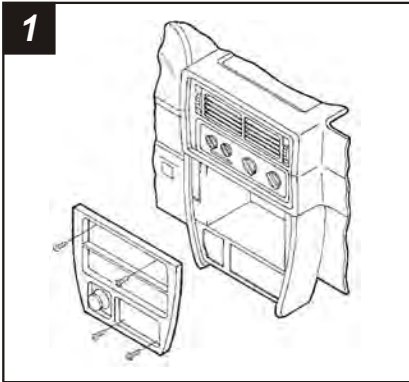

Disconnect the negative battery terminal to prevent an accidental short circuit. Remove (2) screws from the top of the radio trim bezel. Remove the ashtray and (2) screws exposed. Unclip the radio trim bezel and disconnect the cigarette lighter wiring. Remove the screws securing the factory head unit and disconnect the wiring.

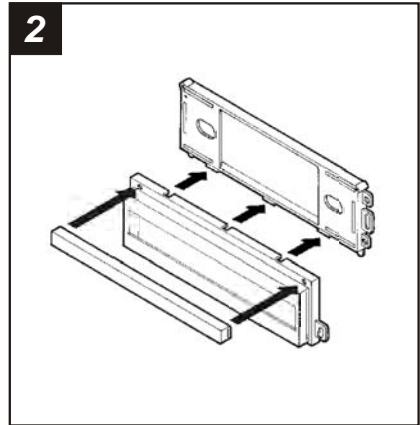

Snap the **Filler Bar** onto the **Equalizer Housing** and slide the assembly onto the bottom of the **Radio Housing**.

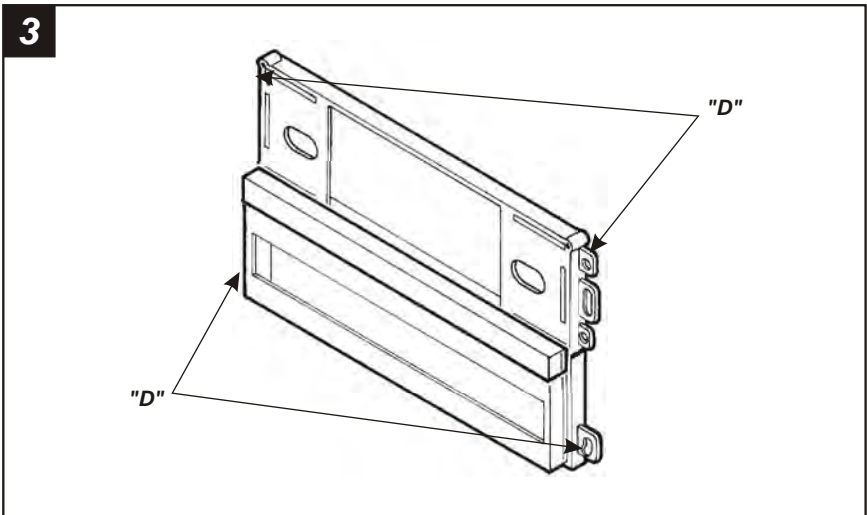

Cut and remove all mounting tabs on the **Radio Housing** EXCEPT tabs "D". The mounting tabs can be identified by the stamped letter on the back of each tab. *Skip to the Installation Instructions for ALL VEHICLES on Page #10.*

**EAGLE Talon 1990-94 / MITSUBISHI Eclipse 1990-94  
PLYMOUTH Laser 1990-94**

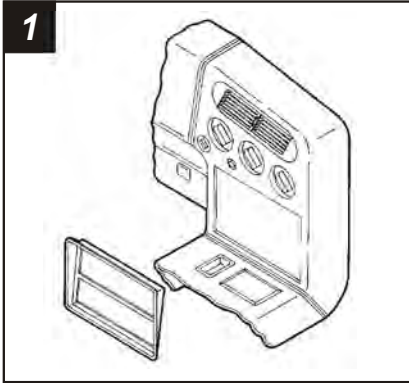

1  
Disconnect the negative battery terminal to prevent an accidental short circuit. Unclip the radio trim bezel and remove. Remove (4) Phillips securing the factory head unit and disconnect the wiring.

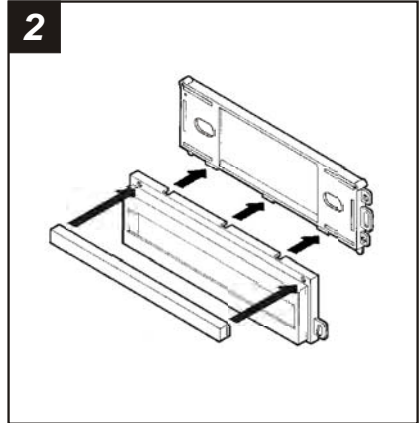

2  
Snap the **Filler Bar** onto the **Equalizer Housing** and slide the assembly onto the bottom of the **Radio Housing**.

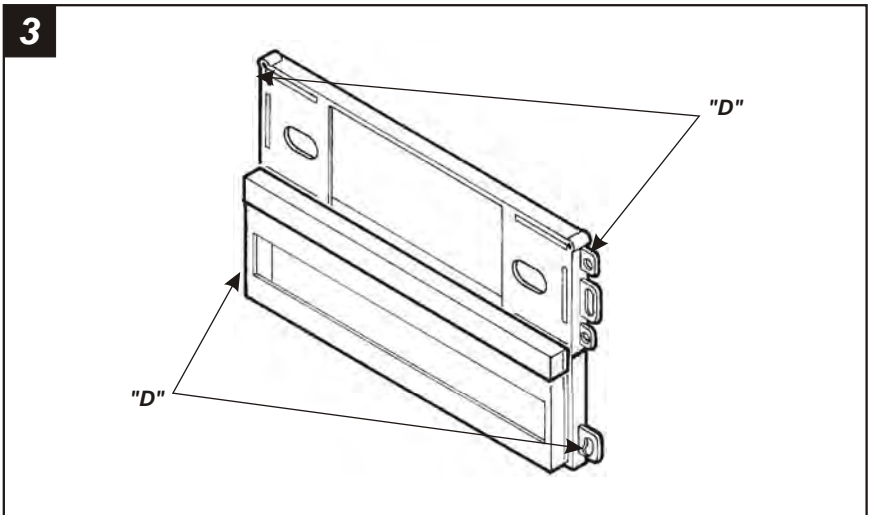

3  
Cut and remove all mounting tabs on the **Radio Housing** EXCEPT tabs "D". The mounting tabs can be identified by the stamped letter on the back of each tab. Skip to the *Installation Instructions for ALL VEHICLES* on Page #10.

# MITSUBISHI Galant 1985-88 / Sigma 1989-90

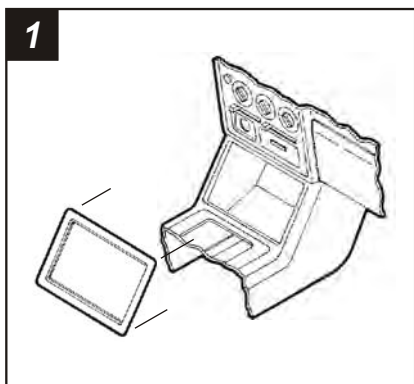

Disconnect the negative battery terminal to prevent an accidental short circuit. Unclip the radio trim bezel and remove. Remove (4) screws securing the factory head unit and disconnect the wiring.

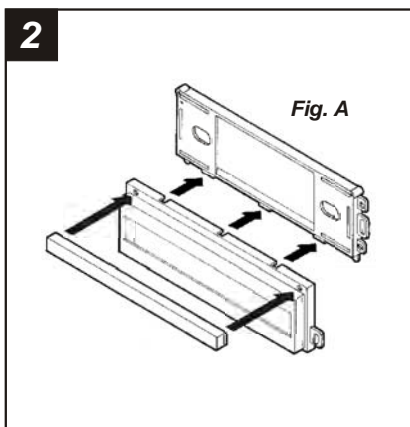

Snap the **Filler Bar** onto the **Equalizer Housing** and slide the assembly onto the bottom of the **Radio Housing**. (see Fig. A). (The factory pocket may be used by omitting this step and mounting the pocket under the Radio Housing during installation).

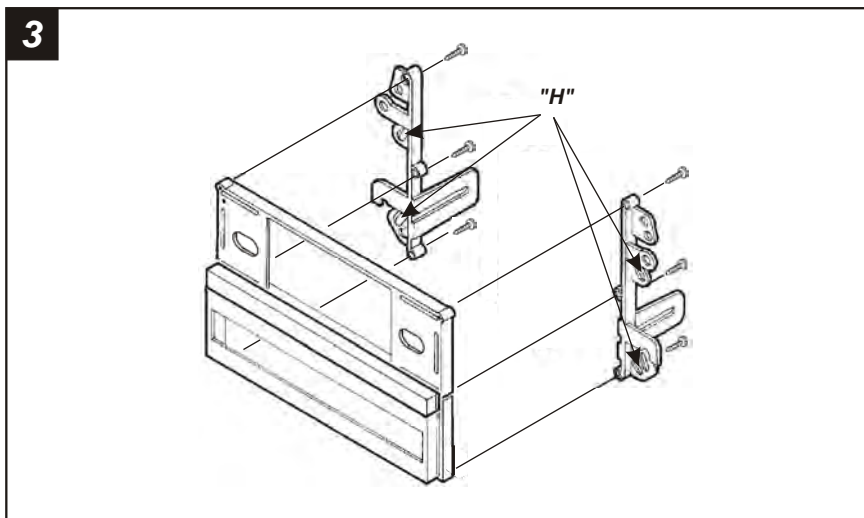

Cut and remove all mounting tabs on **Bracket Set #1** EXCEPT tabs "H". The mounting tabs can be identified by the stamped letter on the back of each tab. Mount the converted Brackets to the back of the assembly with (6) #8 x 3/4" **Hex-head Screws** supplied. Skip to the *Installation Instructions for ALL VEHICLES on Page #10.*



## MITSUBISHI Galant 1989-93

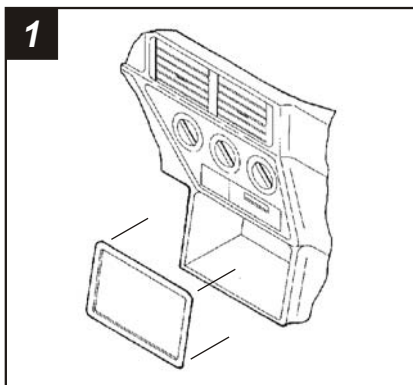

1  
Disconnect the negative battery terminal to prevent an accidental short circuit. Unclip the radio trim bezel and remove. Remove (4) screws securing the factory head unit and disconnect the wiring.

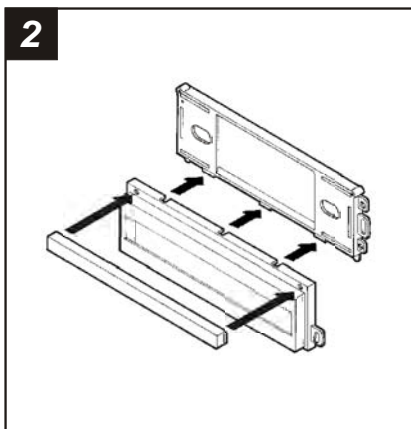

2  
Snap the **Filler Bar** onto the **Equalizer Housing** and slide the assembly onto the bottom of the **Radio Housing**.

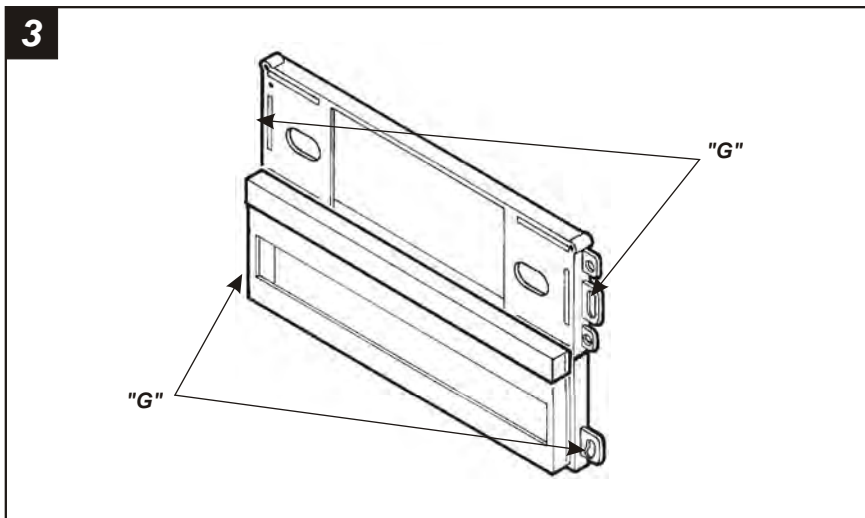

3  
Cut and remove all mounting tabs on the **Radio Housing** EXCEPT tabs "G". The mounting tabs can be identified by the stamped letter on the back of each tab. *Skip to the Installation Instructions for ALL VEHICLES on Page #10.*

# MITSUBISHI Van 1987-90

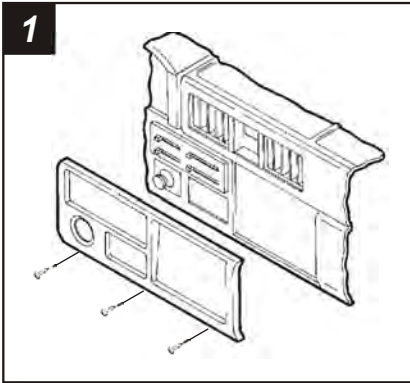

1  
Disconnect the negative battery terminal to prevent an accidental short circuit. Remove (3) screws from the bottom edge of the dash trim bezel and remove the bezel. Remove (4) screws securing the factory head unit and disconnect the wiring.

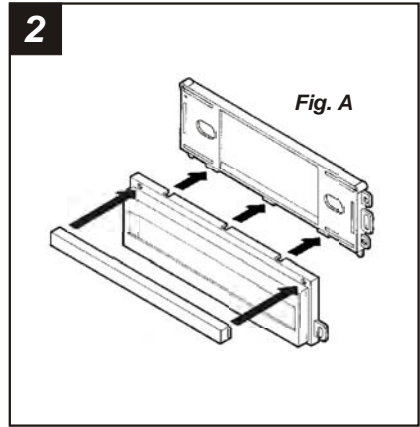

2  
Snap the **Filler Bar** onto the **Equalizer Housing** and slide the assembly onto the bottom of the **Radio Housing**. (see Fig. A). (The factory pocket may be used by omitting this step and mounting the pocket under the Radio Housing during installation).

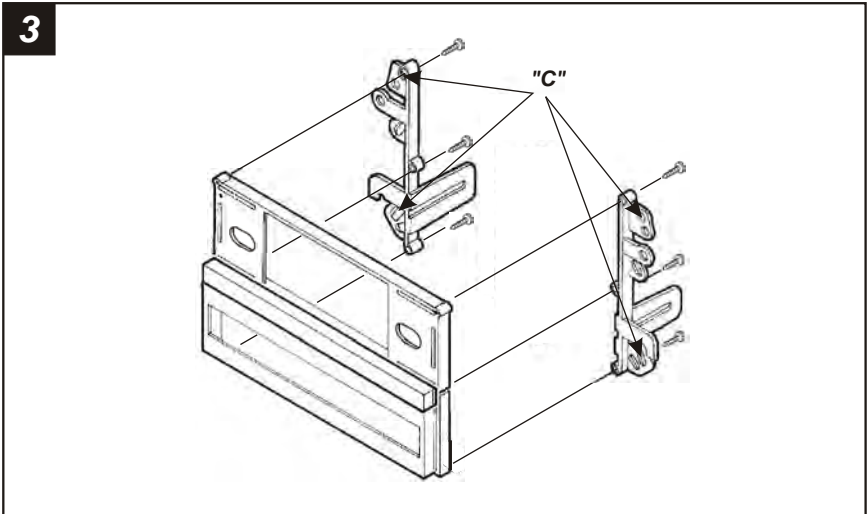

3  
Cut and remove all mounting tabs on **Bracket Set #1** EXCEPT tabs "C". The mounting tabs can be identified by the stamped letter on the back of each tab. Mount the converted Brackets to the back of the assembly with (6) #8 x 3/4" **Hex-head Screws** supplied. Skip to the *Installation Instructions for ALL VEHICLES* on Page #10.

## ALL VEHICLES

4

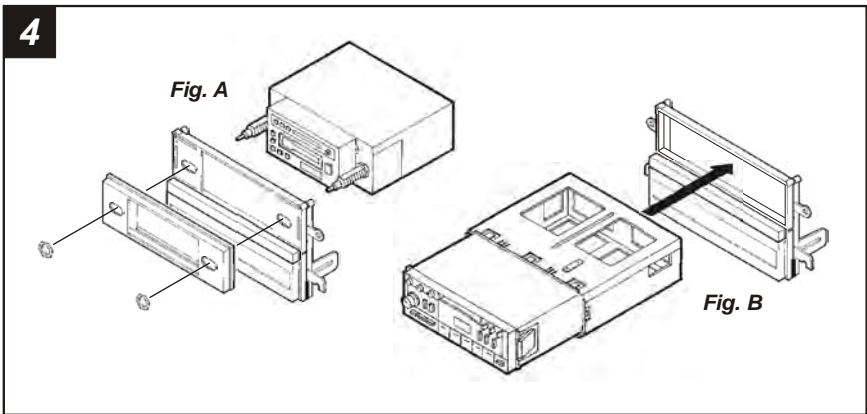

**2-SHAFT HEAD UNITS:** Attach the **Faceplate** to the **Radio Housing**. Slide the aftermarket head unit into the kit and secure with shaft nuts. (see Fig. A)

**DIN HEAD UNITS:** Cut and remove the shaft supports from the **Radio Housing**. Slide the DIN cage into the kit and secure by bending the metal locking tabs down. Slide the aftermarket head unit into the cage until secure. (see Fig. B)

(If an equalizer will be included, slide the unit into the back of the **Radio Housing** and secure. If an equalizer will NOT be included, snap the **Equalizer Dummy Plate** into the opening).

5

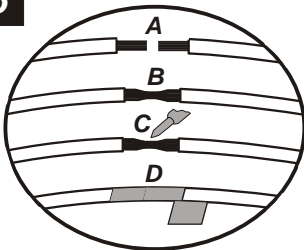

- A) Strip wire ends back  $\frac{1}{2}$ "
- B) Twist ends together
- C) Solder
- D) Tape

Locate the factory wiring harness in the dash. Metra recommends using the proper mating adaptor and making connections as shown. (Isolate and individually tape off the ends of any unused wires to prevent electrical short circuit).

6

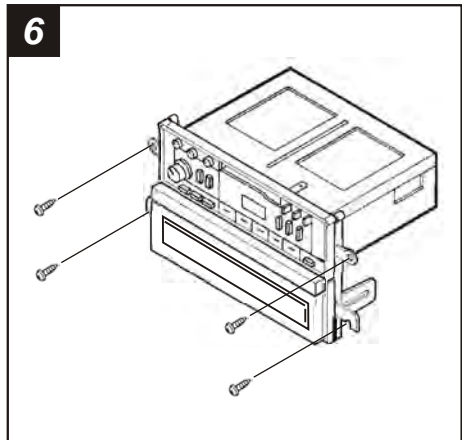

Re-connect the battery terminal and test the unit for proper operation. Mount the head unit/kit assembly to the sub-dash with those screws previously removed in step #1.