



INSTALLATION INSTRUCTIONS FOR PART 99-7869

APPLICATIONS

Honda Odyssey 2005-2009

99-7869



KIT FEATURES

- DIN Radio Provision with Pocket
- ISO Mount Radio Provision with Pocket
- Double DIN Radio provision
- Stacked ISO Mount Units Provision

KIT COMPONENTS

- A) Radio Housing • B) ISO Brackets • C) Trim Plate • D) Double DIN Trim Plate • E) Double DIN Brackets • F) Pocket
- G) Panel Clips - (2) Panel Clips supplied - user assembly onto rear of Radio Housing required

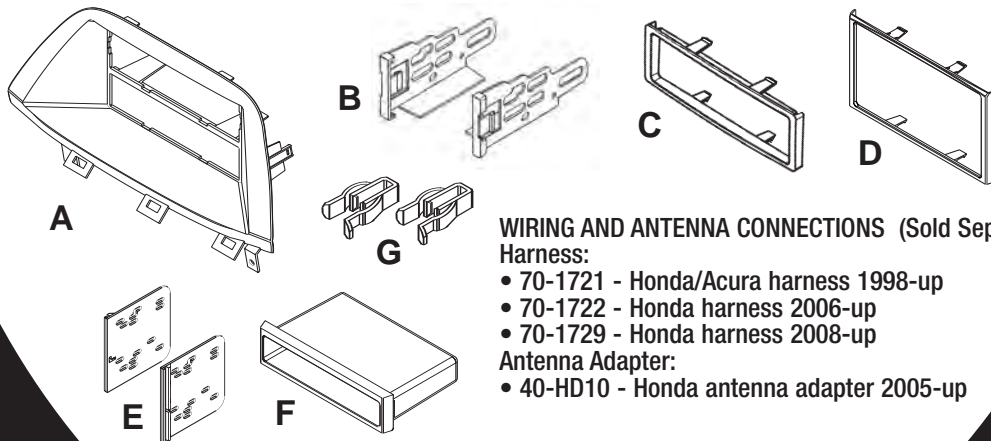

TOOLS REQUIRED:

- Phillips Screwdriver • Small Flat Blade Screwdriver • Socket Wrench

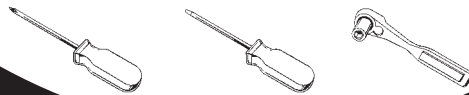

1-800-221-0932



www.metraonline.com

© COPYRIGHT 2004-2009 METRA ELECTRONICS CORPORATION

TABLE OF CONTENTS

Dash Disassembly

***Honda Odyssey 2005-2009*1**

Kit Assembly

***Din Radio Provision with Pocket*2**

***ISO Mount Radio Provision with Pocket*3**

***Double Din Radio Provision*4**

***Stacked ISO Mount Units Provision.*5**

Final Assembly 6



KNOWLEDGE IS POWER

Enhance your installation and fabrication skills by enrolling in the most recognized and respected mobile electronics school in our industry. Log onto www.installerinstitute.com or call 800-354-6782 for more information and take steps toward a better tomorrow.

HONDA ODYSSEY 2005-2009

- 1 Disconnect the negative battery terminal to prevent an accidental short circuit.
- 2 Unclip and remove climate control panel below radio. (Figure A)
- 3 Remove (3) Phillips-7 MM screws securing the radio to remove. (Figure B)

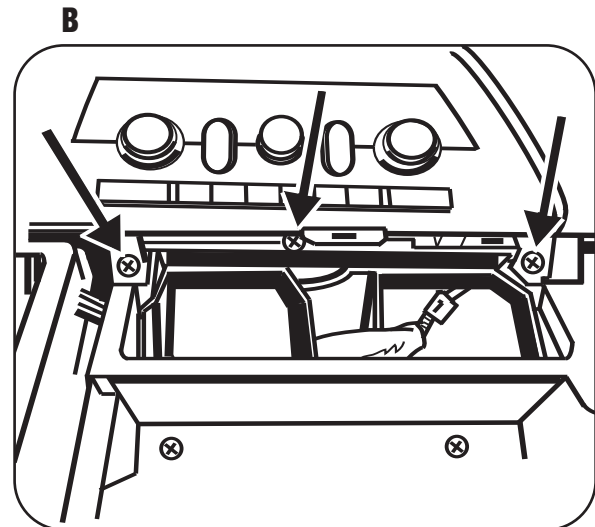
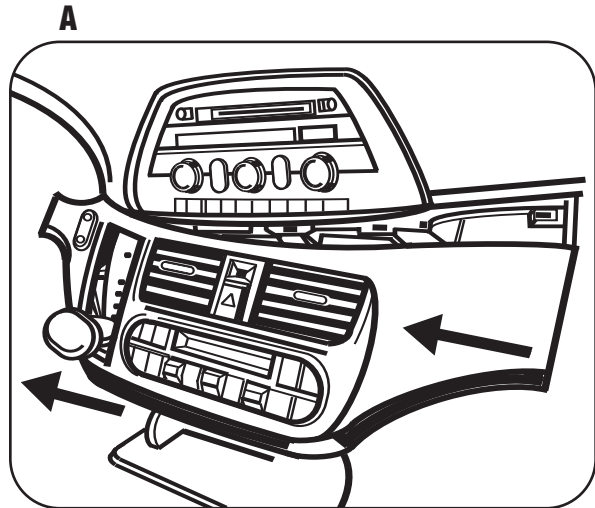

DIN RADIO PROVISION WITH POCKET

- 1** Attach (2) Panel Clips to Radio Housing rear connectors. (Figure A)
- 2** Slide the DIN cage into the Radio Housing and secure by bending the metal locking tabs down. (Figure B)
- 3** Slide the aftermarket radio into the cage and secure. (Figure C)
- 4** Snap the pocket into the housing. (Figure D)

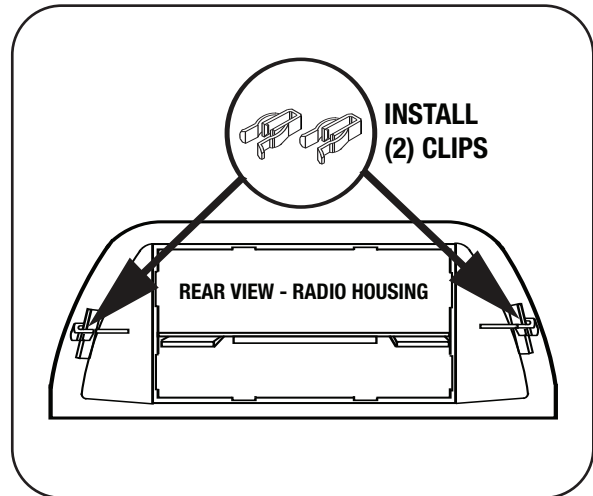
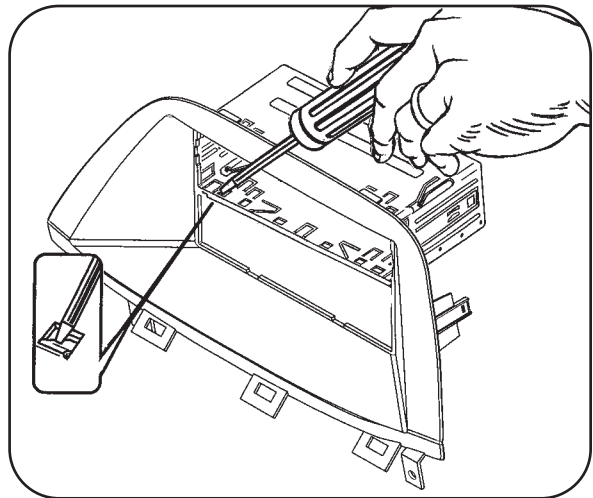
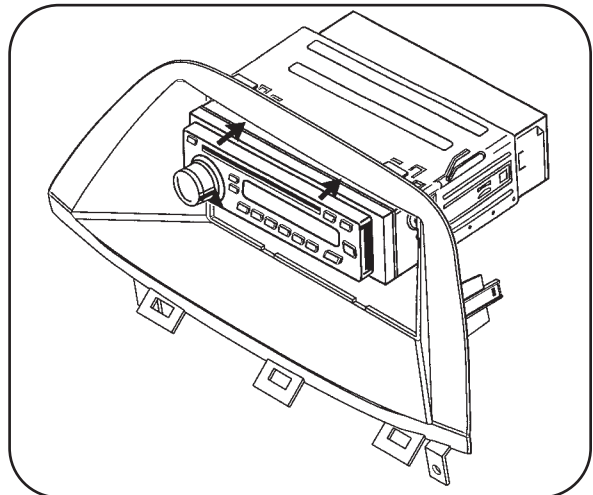
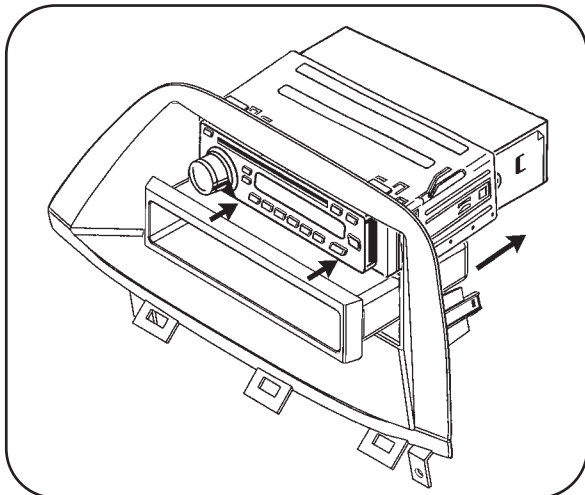
A**B****C****D**

ISO MOUNT RADIO PROVISION WITH POCKET

- 1** Attach (2) Panel Clips to Radio Housing rear connectors. (Figure A)
- 2** Mount the ISO Brackets to the head unit with the screws supplied with the unit. (Figure B)
- 3** Slide the head unit into the radio opening until the side clips engage. (Figure C)
- 4** Snap the Trim plate into the Radio Housing. (Figure C)
- 5** Snap the Pocket into the Housing. (Figure D)

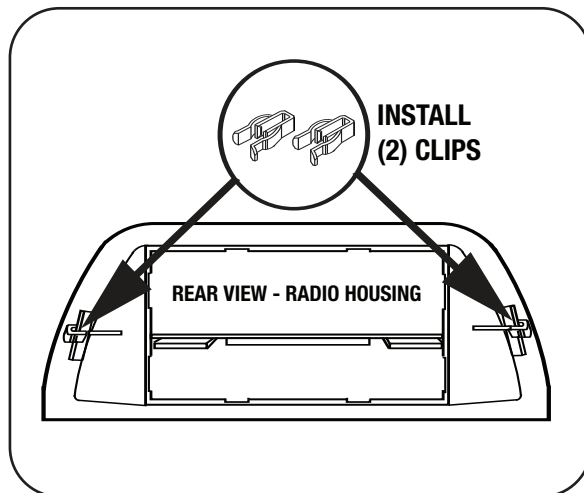
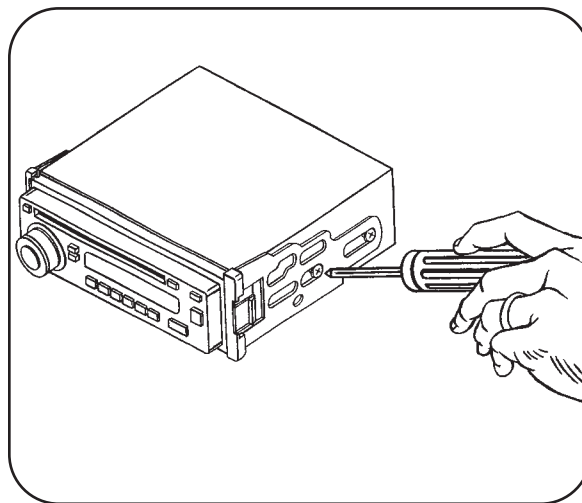
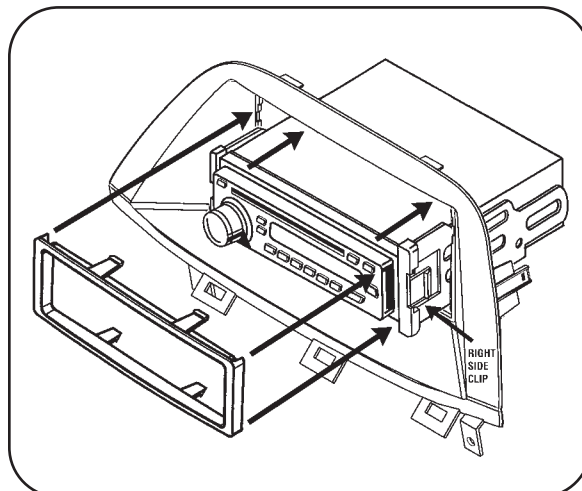
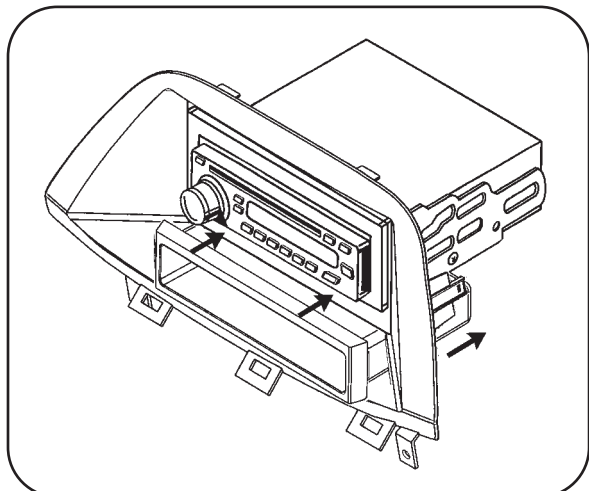
A

B

C

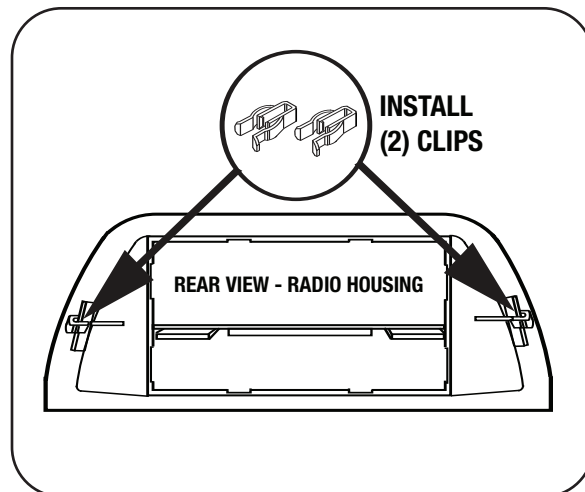
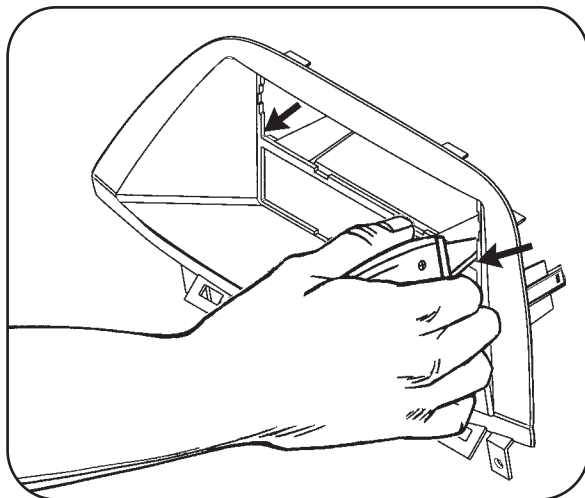
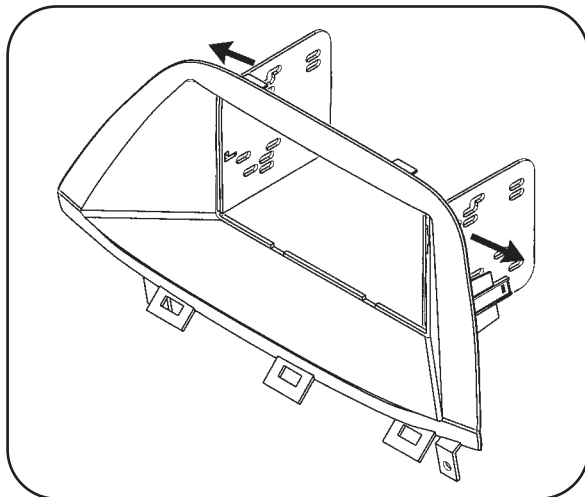
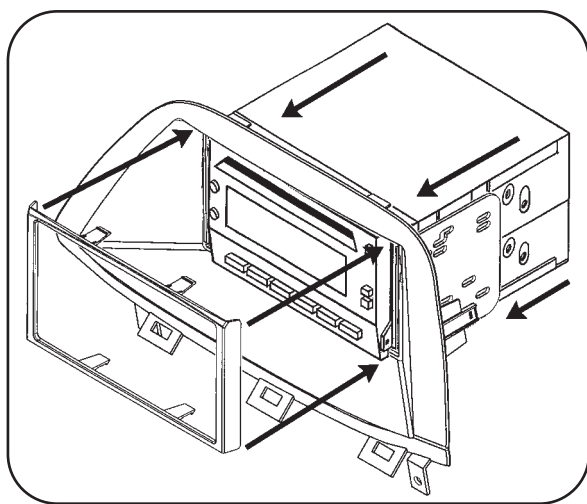
D

DOUBLE DIN RADIO PROVISION

- 1 Attach (2) Panel Clips to Radio Housing rear connectors. (Figure A)
- 2 Cut and remove the center bar from the 99-7869 radio housing. (Figure B)
- 3 Snap the Double DIN brackets to the inside edge of the 99-7869 radio housing. (Figure C)
- 4 Slide the Double DIN radio into the bracket/trim plate assembly and secure the radio to the assembly using the screws supplied with the radio. (Figure D)
- 5 Snap the Double DIN trim plate into the radio housing. (Figure D)

A**B****C****D**

STACKED ISO MOUNT UNITS PROVISION

- 1** Attach (2) Panel Clips to Radio Housing rear connectors. (Figure A)
- 2** Cut and remove the center bar from the 99-7869 radio housing. (Figure B)
- 3** Snap the Double DIN brackets to the inside edge of the 99-7869 radio housing. (Figure C)
- 4** Slide the Stacked ISO units into the bracket/trim plate assembly and secure the units to the assembly using the screws supplied with the radio. (Figure D)
- 5** Snap the Double DIN trim plate into the radio housing. (Figure D)

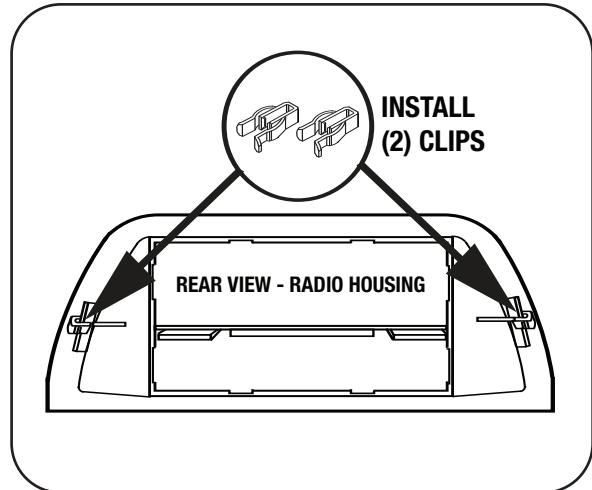
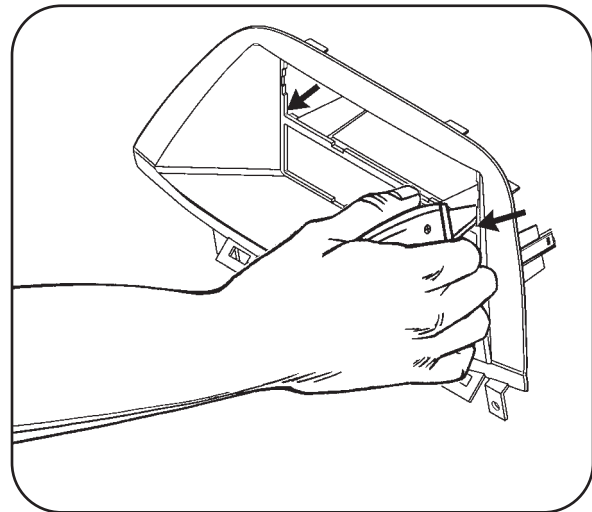
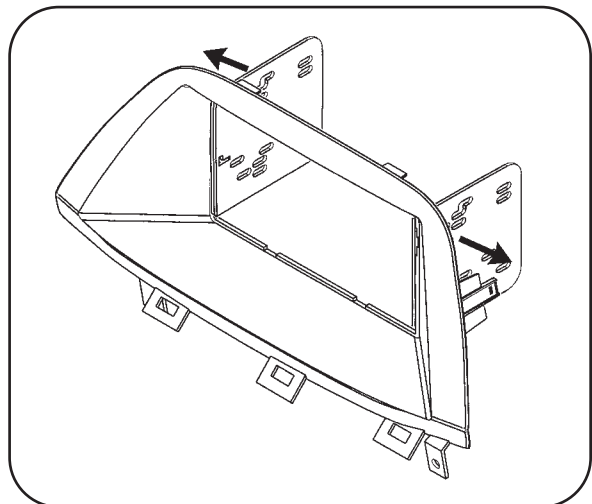
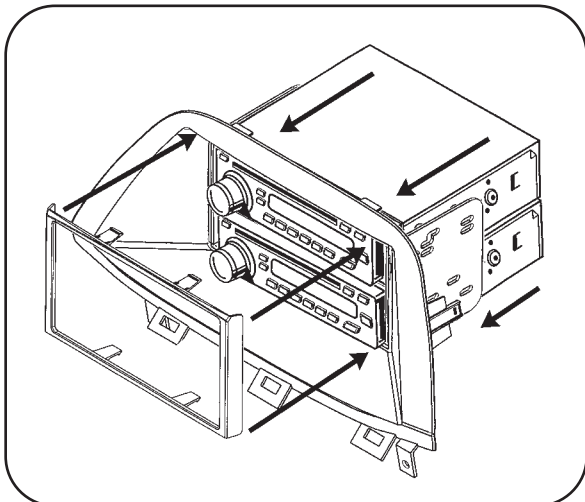
A

B

C

D

FINAL ASSEMBLY

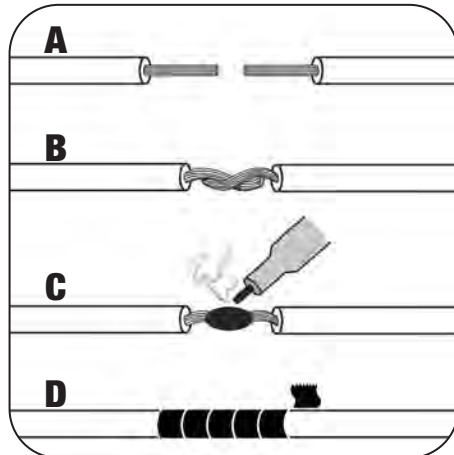
- 1** Locate the factory wiring harness in the dash and make the connection as shown. Metra recommends using the proper mating adapter and making the connections as shown. (Isolate and individually tape off the ends of any unused wires to prevent electrical short circuit.)
- 2** Re-connect the negative battery terminal and test the unit for proper operation.
- 3** Reassemble radio and dash assemblies in reverse order of disassembly.

FINAL WIRING CONNECTIONS

Make wiring connections using the EIA color code chart shown below and the instructions included with the head unit. Metra recommends making connections as shown below; Strip, Splice, Solder, Tape. Isolate and individually tape off ends of any unused wires to prevent electrical short circuit.



- A) Strip wire ends back 1/2"**
- B) Twist ends together**
- C) Solder**
- D) Tape**

METRA / EIA WIRING CODE

12V Ignition / Acc . . . Red	Right Front (+) Gray
12V Batt / Memory . . Yellow	Right Front (-) Gray / Black
Ground Black*	Left Front (+) White
Power Antenna Blue	Left Front (-) White / Black
Amp Turn-On Blue / White	Right Rear (+) Violet
Amp Ground Black / White	Right Rear (-) Violet / Black
Illumination Orange	Left Rear (+) Green
Dimmer Orange / White	Left Rear (-) Green / Black

***NOTE:** When Black a wire is not present, ground radio to vehicle chassis.
All colors may not be present on all leads due to manufacturer's specifications.



1-800-221-0932



www.metraonline.com