



INSTALLATION INSTRUCTIONS FOR PART 99-8216

APPLICATIONS

Toyota Yaris 2007-2009

(Excludes models equipped with power package)

99-8216



KIT FEATURES

- DIN Radio Provision with pocket
- ISO Radio Provision with pocket

KIT COMPONENTS

A) Radio Housing B) Housing Brackets-3 Door C) Housing Brackets-4 Door D) ISO Snap In Brackets E) Trim Plate

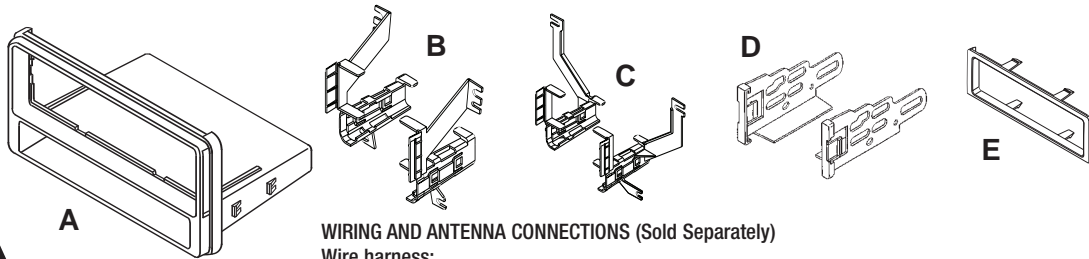

WIRING AND ANTENNA CONNECTIONS (Sold Separately)

Wire harness:

- 70-1761 Toyota 1987-up
- TYTO-01 Toyota amp interface harness 2003-up

Antenna adapter:

- Not required

TOOLS REQUIRED:

- Phillips Screwdriver • Socket Wrench • Small Flat Blade Screwdriver or Panel Removal Tool

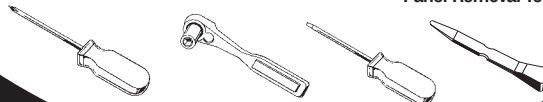

1-800-221-0932



www.metraonline.com

© COPYRIGHT 2004-2009 METRA ELECTRONICS CORPORATION

TABLE OF CONTENTS

Dash Disassembly

***Yaris 2007-2009*1**

Kit Assembly

***Din Mount Radio Provision with pocket* 2**

***ISO Mount Radio Provision with pocket* 3**

Final Assembly 4



KNOWLEDGE IS POWER

Enhance your installation and fabrication skills by enrolling in the most recognized and respected mobile electronics school in our industry.

Log onto www.installerinstitute.com or call 800-354-6782 for more information and take steps toward a better tomorrow.

YARIS 2007-2009

- 1** Disconnect the negative battery terminal to prevent an accidental short circuit.
- 2** Unclip the bottom trim panel located underneath the A/C Controls. (Figure A)
- 3** Unclip the two side trim panels that surround the A/C Controls and Radio. (Figure A)

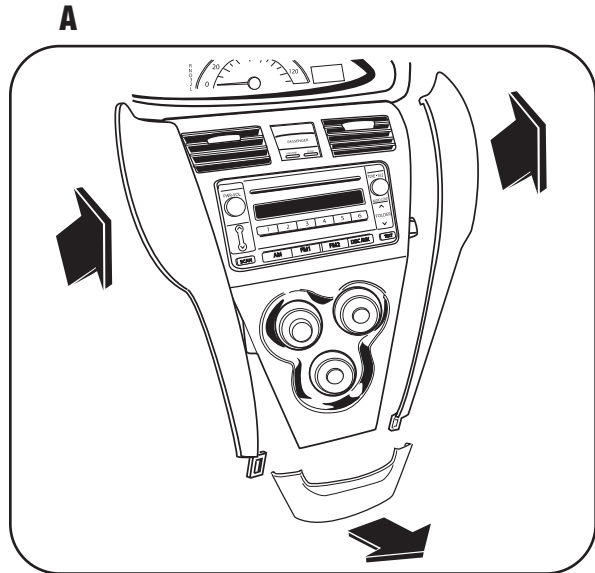

- 4** Unclip the Instrument trim Panel surrounding the Speedometer and gauges. (Figure B)
- 5** Unclip the Radio/AC Vents trim Panel. (Figure B)
- 6** Remove (4) Phillips screws securing radio. (Figure C)

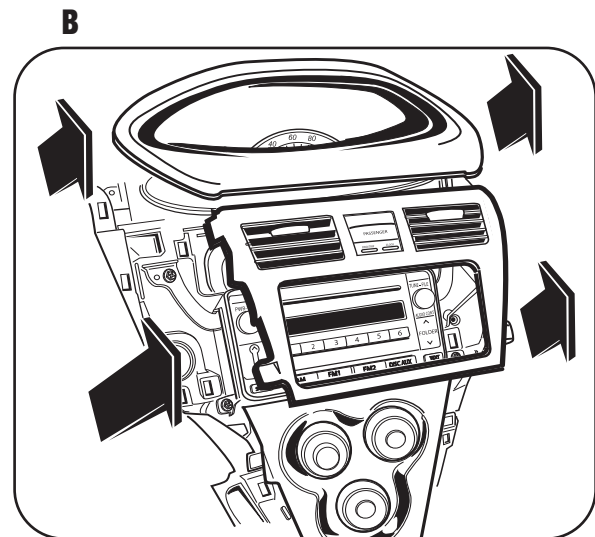

- 7** Unplug and remove radio.

Continue to kit assembly.

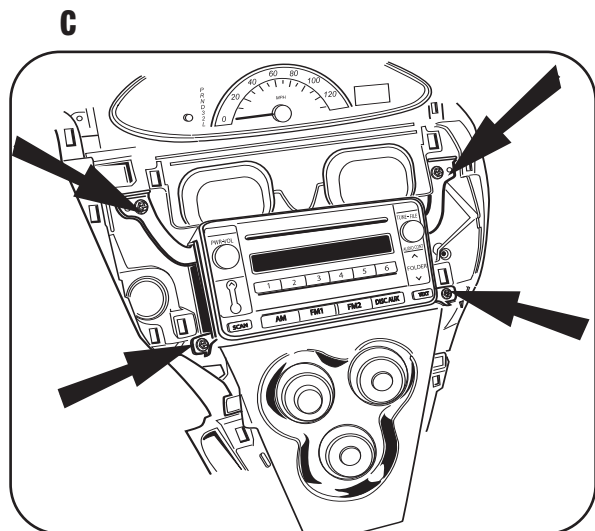

DIN MOUNT RADIO PROVISION

NOTE: Refer also to the instructions included with the aftermarket radio.

- 1 Slide the Mounting Brackets onto the sides of the Radio Housing until the side clips engage. **Note:** Tabs are marked 8216-3L and R for the 3 door Yaris and 8216-4L and R for the 4 door Yaris. (Figure A)

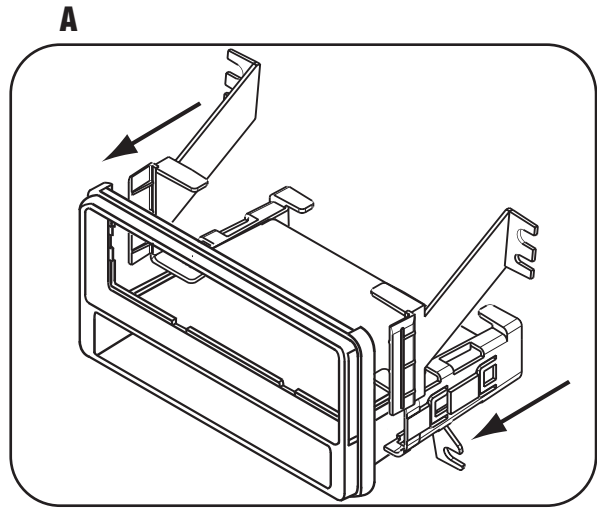

- 2 Slide the DIN cage into the Radio Housing and secure by bending the metal locking tabs outward. (Figure B)

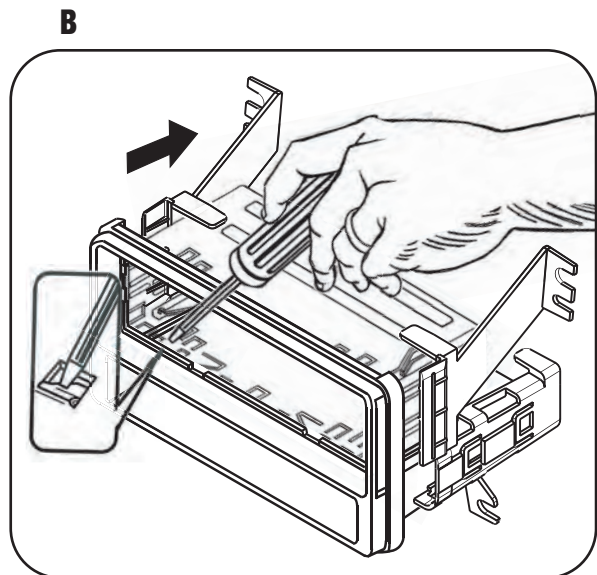

- 3 Slide the aftermarket radio into the cage until it snaps into place. (Figure C)

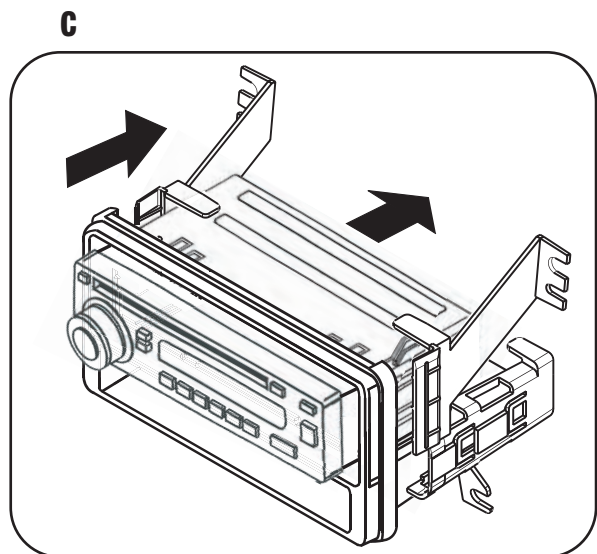

Continue to final assembly.

ISO MOUNT RADIO PROVISION

NOTE: Refer also to the instructions included with the aftermarket radio.

- 1 Slide the Mounting Brackets onto the sides of the Radio Housing until the side clips engage. Note: Tabs are marked 8216-3L and R for the 3 door Yaris and 8216-4L and R for the 4 door Yaris. (Figure A)

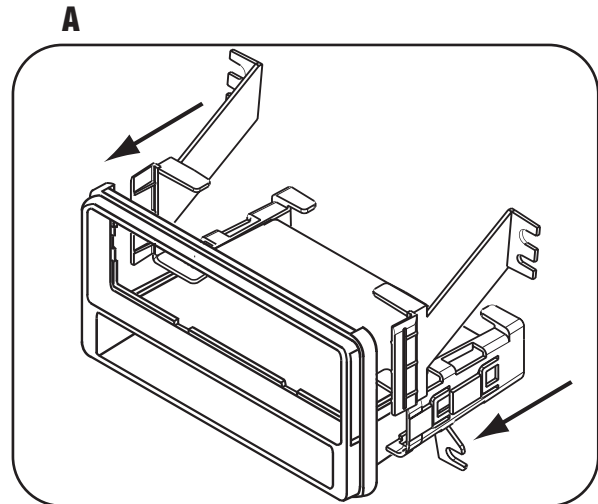

- 2 Mount the ISO Brackets to the aftermarket radio using the screws supplied with the radio. (Figure B)

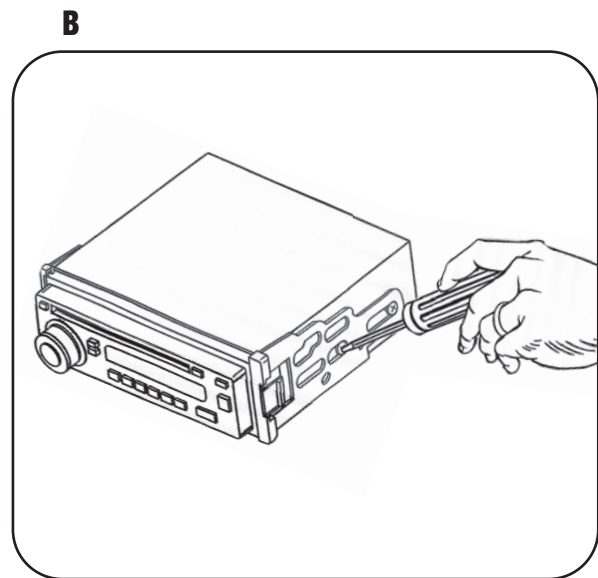

- 3 Slide the radio into the radio opening until the side clips snap into place. (Figure C)

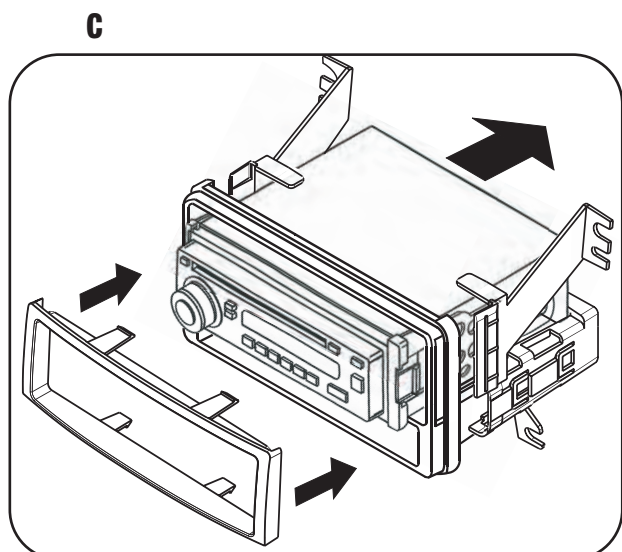

- 4 Snap the Trim plate onto the front the Radio Housing assembly. (Figure C)

Continue to final assembly.

FINAL ASSEMBLY

- 1 Locate the factory wiring harness in the dash and make the connection as shown. Metra recommends using the proper mating adapter and making the connections as shown. (Isolate and individually tape off the ends of any unused wires to prevent electrical short circuit.)
- 2 Re-connect the negative battery terminal and test the unit for proper operation.
- 3 Reassemble radio and dash assemblies in reverse order of disassembly.

FINAL WIRING CONNECTIONS

Make wiring connections using the EIA color code chart shown below and the instructions included with the head unit. Metra recommends making connections as shown below; Strip, Splice, Solder, Tape. Isolate and individually tape off ends of any unused wires to prevent electrical short circuit.

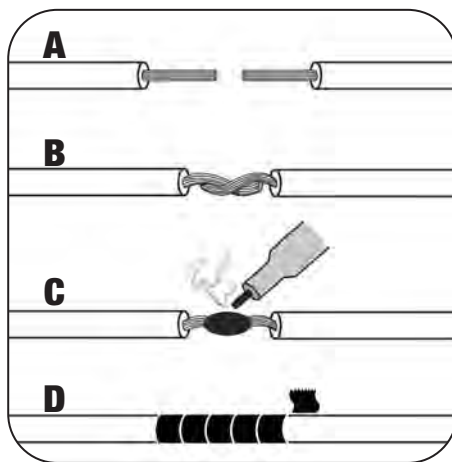

- A) Strip wire ends back 1/2"**
- B) Twist ends together**
- C) Solder**
- D) Tape**

METRA / EIA WIRING CODE

12V Ignition / Acc . . . Red	Right Front (+) Gray
12V Batt / Memory . . Yellow	Right Front (-) Gray / Black
Ground Black*	Left Front (+) White
Power Antenna Blue	Left Front (-) White / Black
Amp Turn-On Blue / White	Right Rear (+) Violet
Amp Ground Black / White	Right Rear (-) Violet / Black
Illumination Orange	Left Rear (+) Green
Dimmer Orange / White	Left Rear (-) Green / Black

***NOTE:** When a Black wire is not present, ground radio to vehicle chassis.

All colors may not be present on all leads due to manufacturer's specifications.

99-8216 INSTRUCTIONS



1-800-221-0932



www.metraonline.com

REV. 05/14/09

© COPYRIGHT 2004-2009 METRA ELECTRONICS CORPORATION

INST99-8216