



## INSTALLATION INSTRUCTIONS FOR PART 99-8225G

### APPLICATIONS

# Toyota Venza 2009

## 99-8225G

### KIT FEATURES

- DIN Head Unit Provision With Pocket
- ISO DIN Head Unit Provision With Pocket
- *Painted to match factory dash - G=Gray*



### KIT COMPONENTS

- A) Single DIN Radio Housing
- B) ISO Brackets
- C) Trim Plate

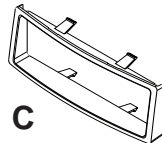
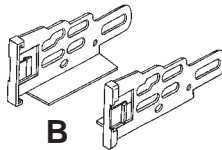
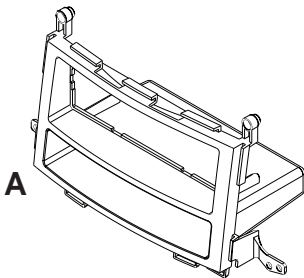

### WIRING AND ANTENNA CONNECTIONS

**(Sold Separately)**

- 70-1761 - 1987-up Toyota harness
- TYTO-01 - 2003-up Toyota JBL amp interface

### TOOLS REQUIRED:

- Small Flat Blade Screwdriver/ Panel Removal Tool
- Phillips Screwdriver
- Socket Set
- Magnetized Universal Swivel Head Socket Adapter

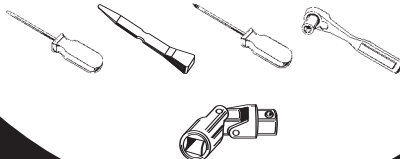

1-800-221-0932



www.metraonline.com

© COPYRIGHT 2009 METRA ELECTRONICS CORPORATION

## **TABLE OF CONTENTS**

### **Dash Disassembly**

**- Toyota Venza 2009 ..... 1**

### **Kit Assembly**

**- DIN Head Unit Provision With Pocket .....2**  
**- ISO Din Head Unit Provision With Pocket .....3**

**\*Note:**

**Refer also to the instructions included with the aftermarket radio.**



### **KNOWLEDGE IS POWER**

Enhance your installation and fabrication skills by enrolling in the most recognized and respected mobile electronics school in our industry. Log onto [www.installerinstitute.com](http://www.installerinstitute.com) or call 800-354-6782 for more information and take steps toward a better tomorrow.

## Toyota Venza 2009

- 1 Disconnect the negative battery terminal to prevent an accidental short circuit.
- 2 Unclip and remove the trim panel to the right of the shifter. (Figure A)
- 3 Remove (1) Phillips screw from the bottom of the climate control then unclip and remove the climate control. (Figure B)
- 4 Remove (4) 10 MM bolts securing the radio. ***Note: You will need a universal swivel head socket adapter to get to the bottom left bolt.*** (Figure C)
- 5 Remove (4) Phillips screws securing the factory radio to the a/c vent panel. (Figure D)

*Continue to kit assembly.*

**A**

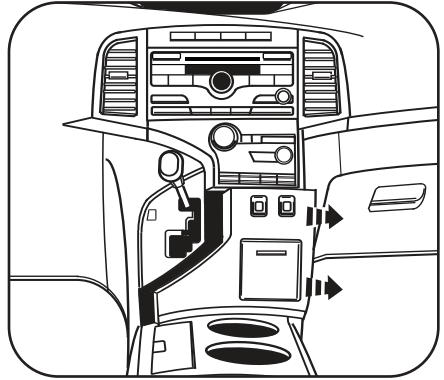

**B**

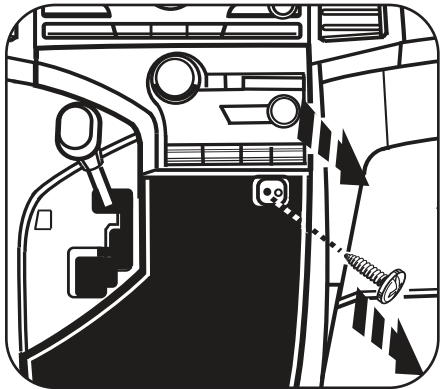

**C**

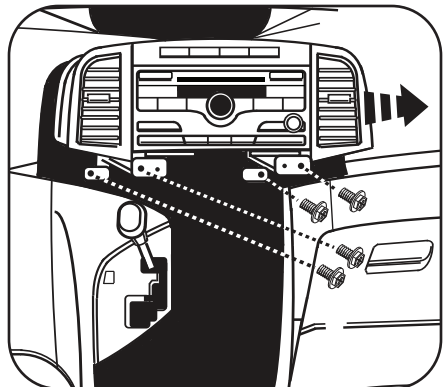

**D**

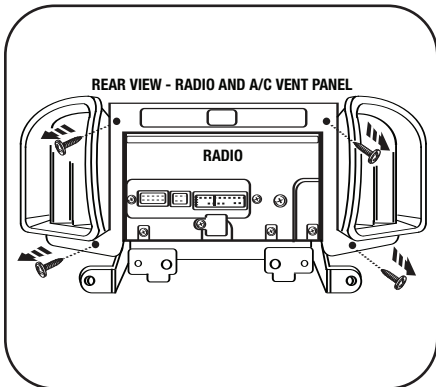

## DIN HEAD UNIT PROVISION WITH POCKET

*\*Note: Refer also to the instructions included with the aftermarket radio.*

- 1 Secure the Radio Housing into the factory a/c vent panel using the factory hardware. (Figure A)
- 2 Locate the factory wiring harness in the dash. Metra recommends using the proper mating adapter from Metra or AXCESS. Re-connect the negative battery terminal and test the unit for proper operation.
- 3 Slide the DIN cage into the Radio Housing and secure by bending the metal locking tabs down. (Figure B)
- 4 Slide the aftermarket head unit into the cage and secure. (Figure C)
- 5 Snap the factory vent panel/Radio Housing over dash cavity. (Figure D)
- 6 Reassemble remaining radio and dash assemblies in reverse order of disassembly.

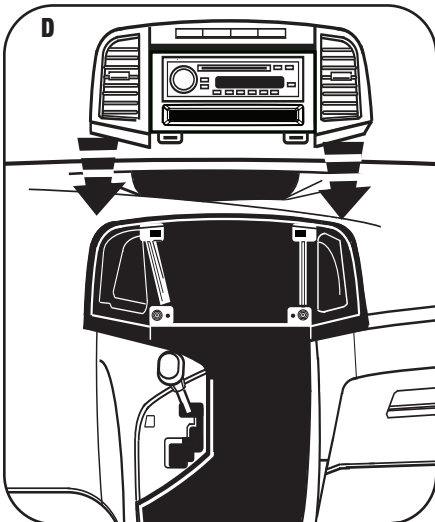
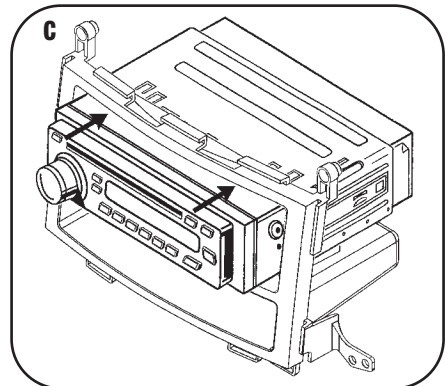
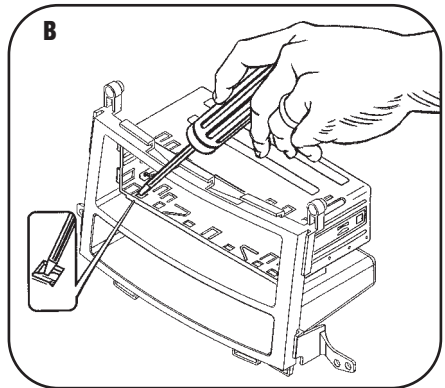
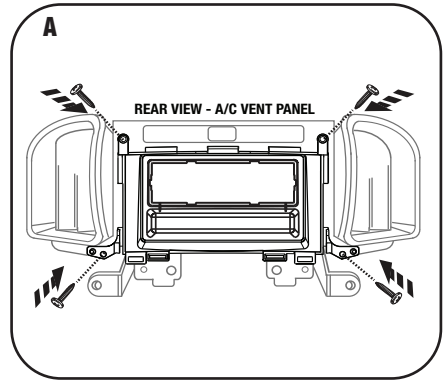

## ISO DIN HEAD UNIT PROVISION WITH POCKET

*\*Note: Refer also to the instructions included with the aftermarket radio.*

- 1 Secure the Radio Housing into the factory a/c vent panel using the factory hardware. (Figure A)
- 2 Mount the ISO Brackets to the head unit with the screws supplied with the unit. (Figure B)
- 3 Slide the head unit into the radio opening until the side clips engage. (Figure C)
- 4 Snap the Trim Plate into the Radio Housing. (Figure C)
- 5 Snap the factory vent panel/Radio Housing over dash cavity. (Figure D)
- 6 Reassemble remaining radio and dash assemblies in reverse order of disassembly.

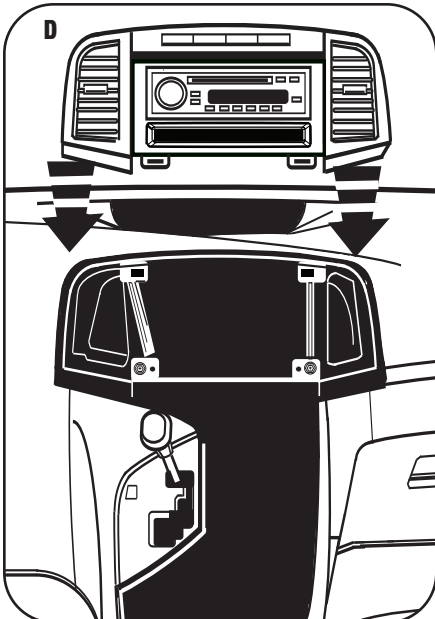
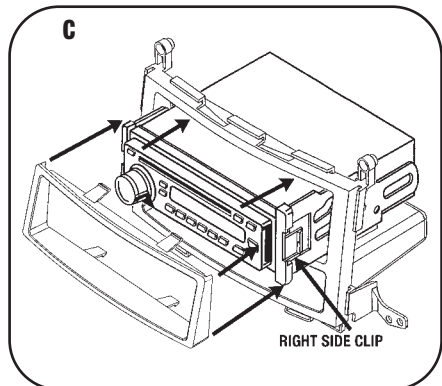
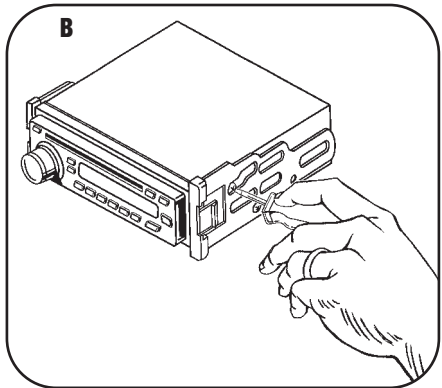
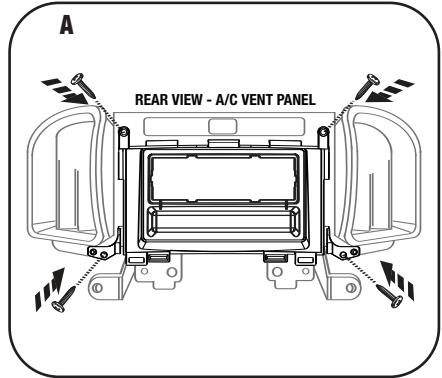





# 99-8225G INSTRUCTIONS



1-800-221-0932



[www.metraonline.com](http://www.metraonline.com)

REV. 05/08/09 © COPYRIGHT 2009 METRA ELECTRONICS CORPORATION INST99-8225G