

1994-1995 FORD MUSTANG - V8 5.0L

Warning: When working on under or around any vehicle exercise caution. Please allow the vehicle's exhaust system to cool before removal, as exhaust system temperatures may cause severe burns. If working without a lift, always consult vehicle manual for correct lifting specifications. Always wear safety glasses and ensure safe work area. Serious injury or death could occur if safety measures are not followed.

NOTE: The MAGNAFLOW "Tru-X" crossover assembly is designed to replicate the exact fitment of the OEM "H-pipe" assembly. Aftermarket exhaust products such as "headers" or "cat-back" exhausts other than MAGNAFLOW products may alter fitment of the MAGNAFLOW "Tru-X" or OEM "H-pipe" assemblies.

Step 1: (Carefully read all instructions before installation)

To remove the OEM H-pipe assembly, you will need to disconnect the two(2) O2 sensors at the connections approximately 6-8 inches from the O2 sensors themselves. The Passenger's side O2 sensor near the exhaust manifold will need to be unthreaded and removed to gain access to the bolts attaching the H-pipe to the manifold. Unbolt the H-pipe assembly from the exhaust manifolds and from the muffler extensions at the rear portion of the H-pipe. Remove the two (2) nuts on the mount bracket near the center of the H-pipe and the Air-Tube connection. Now remove the assembly from the vehicle. Do not discard any of the OEM fasteners, as they will be re-used to mount the new "Tru-X" crossover assembly.

Step 2: Begin installation of the "Tru-X" crossover by installing the O2 sensors from the OEM H-pipe assembly. Except Passenger side O2 sensor(explained in step one)Inspect the O2 sensors for damage or wear, since now would be an easy time to replace them. With the O2 sensors installed, fit the "Tru-X" crossover into place, and loosely bolt it in re-using the OEM fasteners. Using the OEM clip mount the Air Tube to the bracket located on the passenger side inlet pipe. Leave all fasteners loose for adjustment. The OEM Air-Tube may need trimming at 1/2"(0.5") for proper fit.

Step 3: With all components still mounted loosely, adjust the "Tru-X" crossover for a leak-free fit and clearance of the frame & moving parts.

Step 4: Once a final position has been chosen for the "Tru-X" cross-over, evenly tighten all fasteners from front to rear. Inspect all fasteners after 25-50 miles of operation and retighten if necessary.

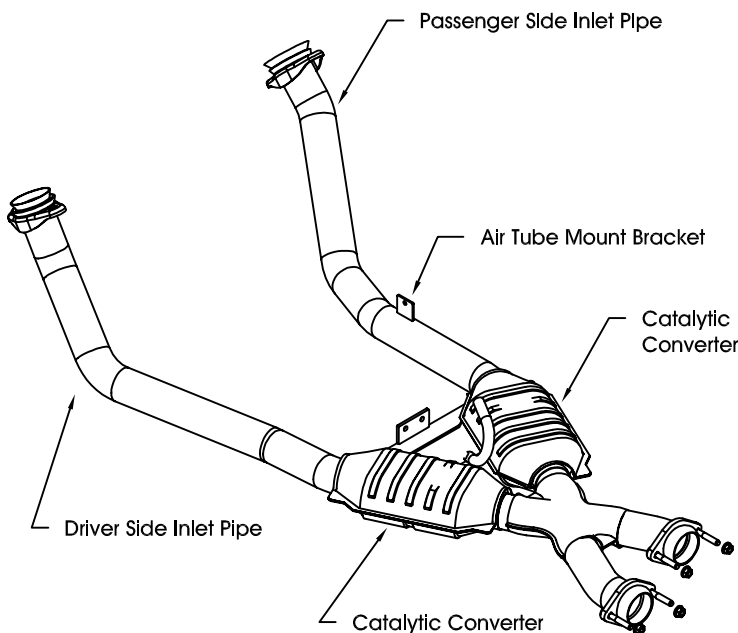

*MAGNAFLOW Performance Exhaust recommends professional installation on all their products

Technical support: 1-800-959-9226 ext. 4500

MAGNAFLOW Performance Exhaust - 22961 Arroyo Vista - Rancho Santa Margarita, CA 92688