

Airaid

INSTALLATION INSTRUCTIONS

514-341 704-462 Airaid Oiled Media Filter

515-341 705-462 SynthaMax Dry Media Filter

2008-15 TOYOTA Land Cruiser

V8-5.7L

NOT LEGAL FOR SALE OR USE ON ANY POLLUTION CONTROLLED MOTOR VEHICLE IN CALIFORNIA OR STATES ADOPTING CALIFORNIA EMISSION PROCEDURES.

See Airaid.com for CARB status on each part for a specific vehicle

COMPONENT IDENTIFICATION

Description	Qty.	Part #
A BOLT; M6 X 1 X 16MM	4	07730
B WASHER; M6 SPLIT LOCK	9	1-3025
C WASHER; 6MM FLAT	11	08269
D LID; CLEAR	1	088095
E AIR FILTER	1	704/705-462
F CLAMP; #104	1	KITHS104
G AIRBOX; (PK)	1	087515
H WEATHERSTRIP; FOAM	1	KITWSTRIP06
I BOLT; M6 X 1 X 20MM	3	07795
J ADAPTOR; \$454	1	27300
K BOLT; M6-1 X 12	4	07794
L HOSE CLAMP; #64 STAINLESS	2	08645
M HOSE HUMP; 4"ID X 3"L	1	KITHUMPHS22
N BOLT; M4-.7 X 8MM	2	07733
O ADAPTOR; MAF SENSOR	1	21515-1
P GASKET; 3/16" PORON	1	09069
Q TUBE; (PJ)	1	087514
R FITTING; VENT 5/8"OD	1	08048
S HOSE; 5/8"ID X 6"L	1	08653
T FITTING; 5/8" TO 3/8"NPT	1	82635
U VENT; 1/8 HOSE, 1/4"NPT	1	08052
V HOSE CLAMP; #56	2	08620
W COUPLER; 3.5"ID X 2"L	1	KITCOUPLER09

TOOLS NEEDED:

Ratchet
Extension
10mm socket
Phillips screw driver
Flathead screw driver
3mm allen
4mm allen
9/16" wrench
3/4" wrench

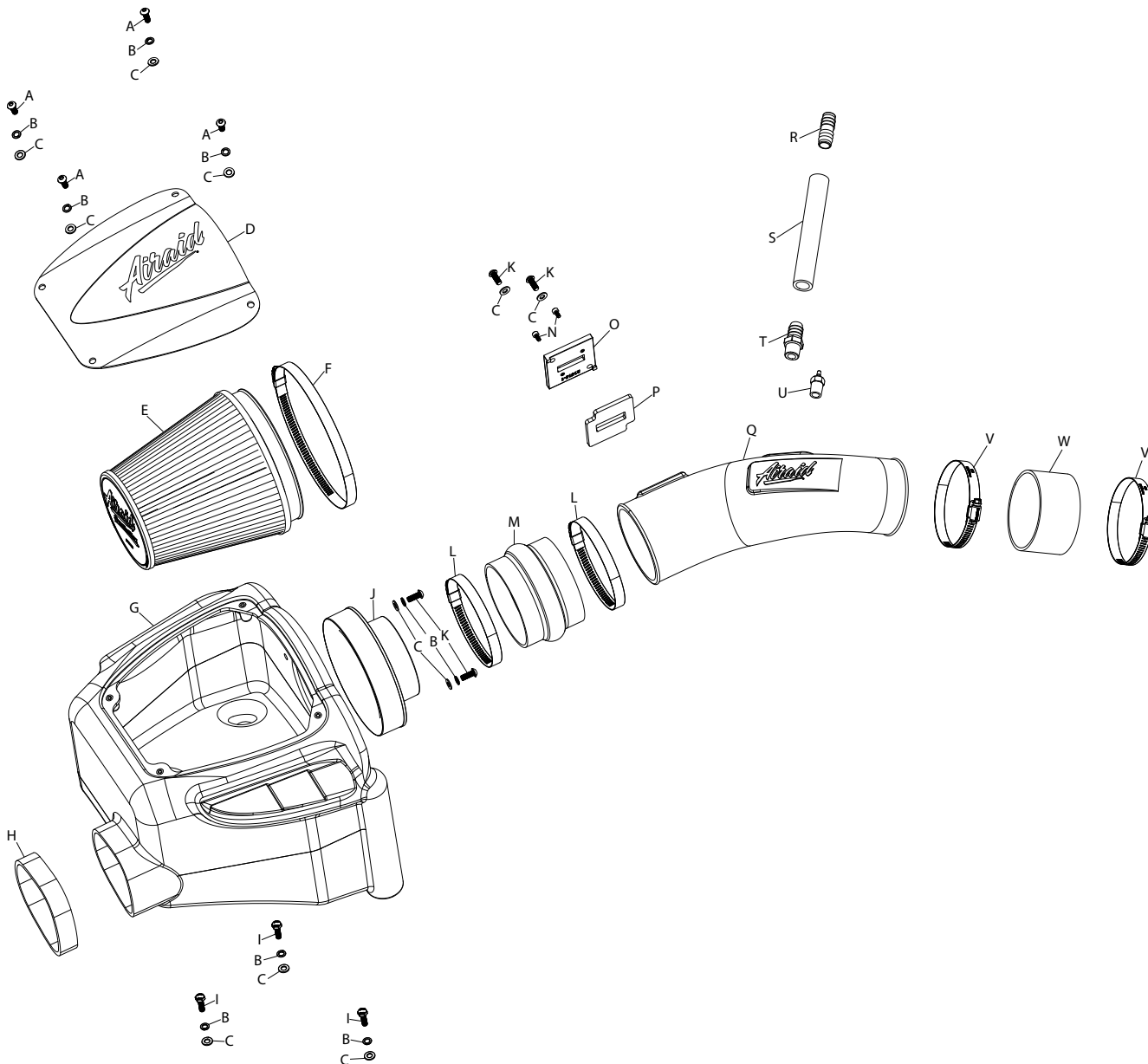

Full color instructions can be viewed on our web site at Airaid.com. If you need any assistance please call 1-800-498-6951 to speak with a representative in our Customer Service Center before returning the product.

TO START:

1. Turn off the ignition and disconnect the negative battery cable.

NOTE: Disconnecting the negative battery cable erases pre-programmed electronic memories. Write down all memory settings before disconnecting the negative battery cable. Some radios will require an anti-theft code to be entered after the battery is reconnected. The anti-theft code is typically supplied with your owner's manual. In the event your vehicles anti-theft code cannot be recovered, contact an authorized dealership to obtain your vehicles anti-theft code.



2. Lift off the engine cover and set aside.



3. Disconnect the CCV vent hose and fuel pressure vent line from the plenum.



4. Disconnect the MAF sensor electrical connection and unhook the wiring from the air filter housing.



5. Loosen the hose clamp that secures the intake tube to the throttle body.



6. Loosen the two front air filter housing mounting bolts.

Continued...



7. Loosen the rear air filter housing mounting bolt.



8. Remove the complete factory intake system from the vehicle.



9. Remove the bolt that secures the engine ground to the inner fender.



10. Install the provided vent fittings into the AIRAID intake tube as shown.



11. Remove the MAF sensor from the factory air filter housing and install it into the provided filter adapter with the hardware provided. Then install the provided gasket onto the bottom of the adapter.



12. Install the MAF sensor assembly into the intake tube and secure with the provided hardware.



13. Install the provided CCV hose and fitting onto the intake tube as shown.



14. Install the filter adapter into the AIRAID filter housing and secure with the provided hardware.



15. Install the foam inlet seal around the AIRAID fresh air inlet.



16. Install the provided couplers onto the AIRAID intake tube using the provided hose clamps.



17. Install the AIRAID air filter housing into the vehicle and secure to the factory filter housing mounting location with the provided hardware. **Note: Be sure that the ground wire is secured back in its original location and secured with the filter housing.**



18. Install the intake tube assembly onto the throttle body and filter adapter, adjust for best fit and then secure with the provided hose clamps.



19. Connect the CCV hose and fuel pressure regulator vent hose.



20. Reconnect the MAF electrical connection.



21. Install the air filter onto the adapter and secure with the provided hose clamp.

Continued...



22. Install the AIRAID air filter housing cover and secure with the provided hardware.



23. Double check your work!
Make sure there is no foreign material in the intake path. Make sure all clamps, hoses, bolts, and screws are tight. Double check the hood clearance!
Reconnect the negative battery cable!

Thank you for purchasing the Airaid Intake System. Contact Airaid @ (800) 498-6951 8:00 AM - 5:00 PM MST weekdays for questions regarding fit or instructions that are not clear to you. Your Airaid Intake System was carefully inspected and packaged. Check that no parts are missing, or were damaged during shipping. If any parts are missing, contact Airaid. The air filter element is protected from direct exposure to water and debris; care should be taken not to drive through deep water. **WATER INGESTION IS THE DRIVERS RESPONSIBILITY!** The air filter is reusable and should be cleaned periodically.

For your Oiled media filter we offer the Airaid Tune Up Kit!



P/N 790-551 Aerosol Spray
P/N 790-550 Squeeze Spray



NOT LEGAL FOR SALE OR USE ON ANY POLLUTION CONTROLLED MOTOR VEHICLE IN CALIFORNIA OR STATES ADOPTING CALIFORNIA EMISSION PROCEDURES.

See Airaid.com for CARB status on each part for a specific vehicle

SynthaMax

Synthamax Air Filters do not require oil. Service air filter as needed by cleaning with common non-petroleum all-purpose household cleaner and water. Simple Green®, Formula 409® or equivalent works great. Apply cleaner to outside of air filter and allow to soak. Then flush filter clean from the inside out with a garden hose and repeat steps if necessary. Do not apply high pressure water or air to clean filter. Allow filter to air dry and reinstall.