

INSTALLATION INSTRUCTIONS

CUSTOMER SERVICE

Phone: 818-365-9000 • MON - FRI 8:30 am - 6:00 pm EST

Email: SUPPORT@BAKINDUSTRIES.COM



ATTENTION!

Ford Ranger Rail installation process:

NOTE: Install supplied Bulkhead Accessory Rail (using supplied instructions) before installing Tonneau Rails.

Rail Bracket installation process:

1. Rear Bracket Installation: Locate the small hole and slot towards the tailgate, underneath the bed rail above the rear tail light post. Gently lift the edge of the plastic bed rail cap and insert the rear bracket under the metal bed rail. The locating tab should go into the hole and the threaded stud should slide into the slot forward of the hole (see diagram, Driver Side shown). Ensure that the thin, flat portion of the bracket is facing forward and is located between the factory metal lip and the factory plastic cap. Once in place tighten the hex nut with a 7/16" wrench. Repeat for other side.

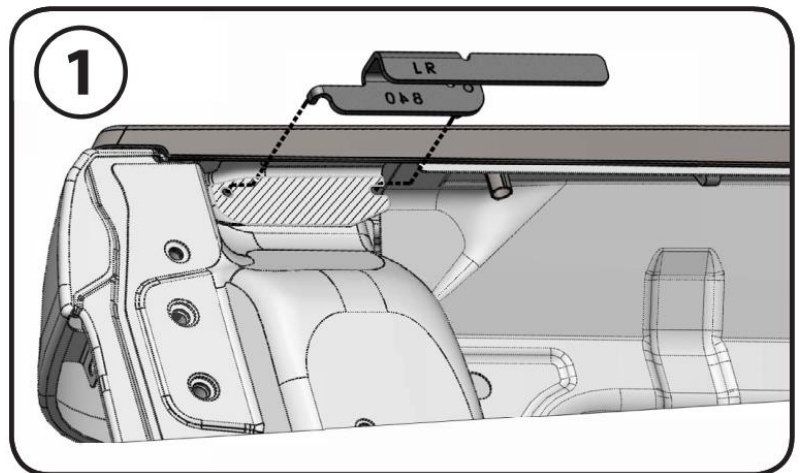

2. Front Bracket Installation: Slide the flat portion of the front bracket in between the plastic bed cap and metal bed rail lip. Move the bracket upward until it bottoms out and the slotted hole lines up with the top threaded hole in the front corner of the bed (see diagram, Driver side shown). Thread the M8x1.25x25 hex bolt in using a 13MM wrench. Repeat process for other side. Note: If truck has a spray in bedliner the threads may need to be cleaned before installation of the hex bolt.

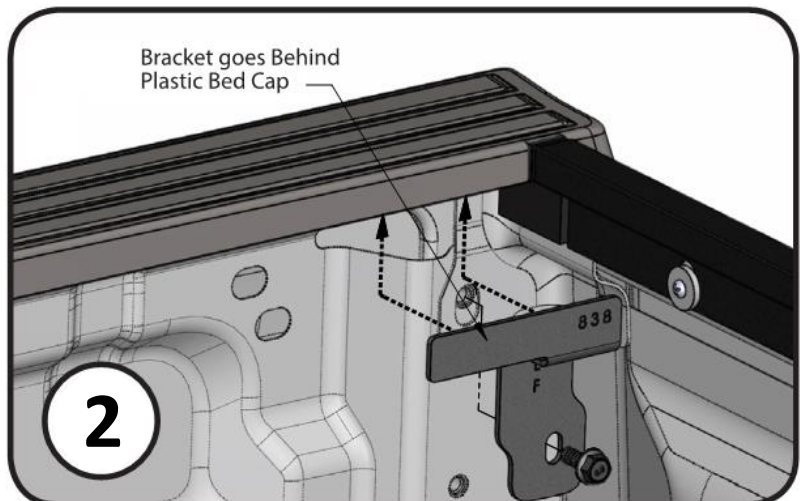

3. Front Bracket Shim Installation: Adhere a ½" x 1/8" x 6" rubber shim to the lower edge of each front bracket (trim as necessary). The shim is required to fill the gap left from the plastic cap to the bracket and will aid in setting the rail correctly.



Rail installation process:

NOTE: 2 person installation recommended

1. Clamps will be placed along each bed rail in 3 places: A- approximately 3.5 inches from the bulkhead, B- approximately centered between the bulkhead and tailgate, and C- approximately 6 inches from the tailgate. A shim (1) is adhered between the truck plastic cap and the truck metal bed rail at **center** clamping point. Peel the backing paper off of each shim and insert up and between the plastic cap and metal rail to fill the void.

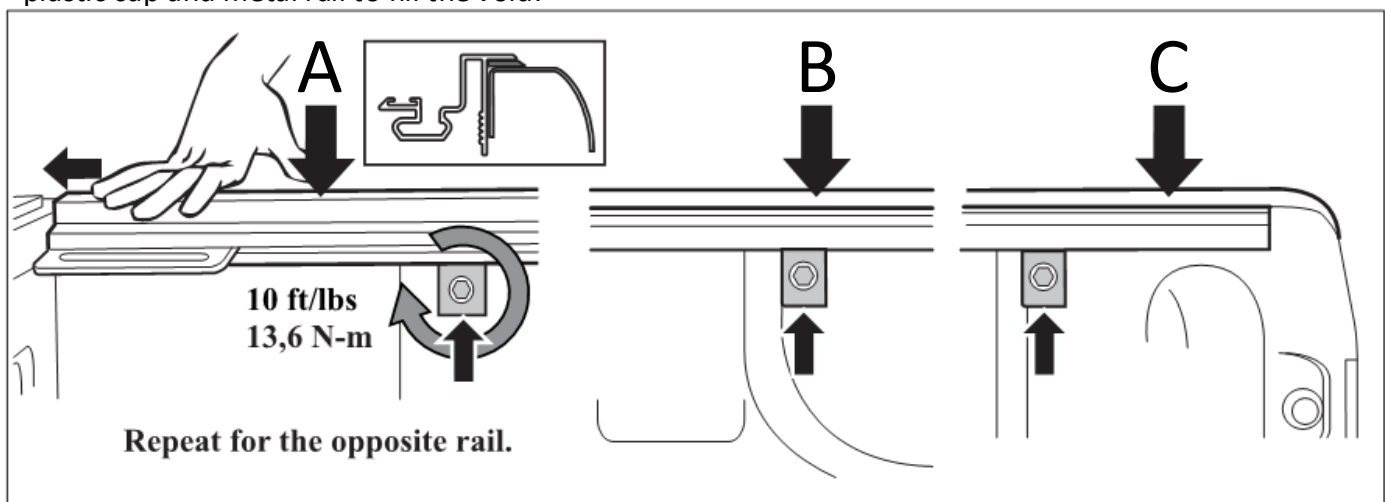

Center Clamp Location:

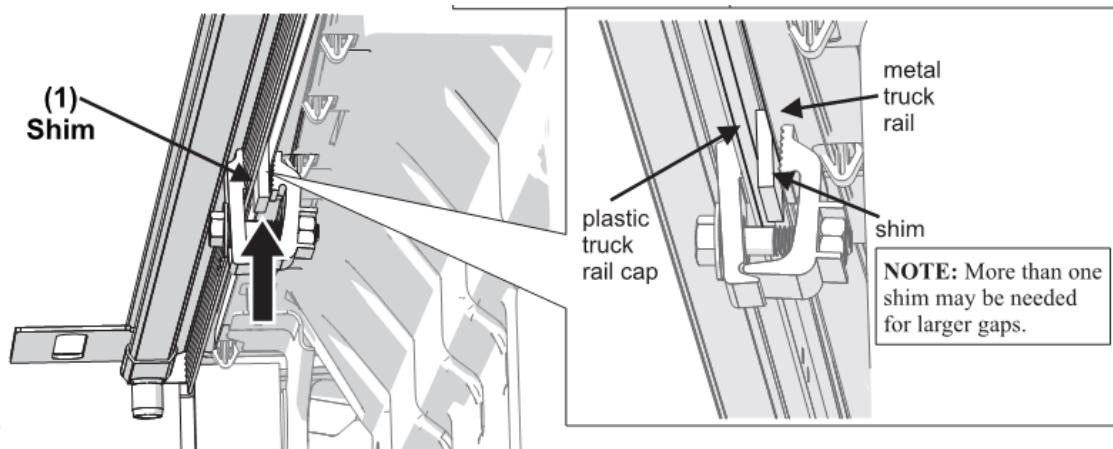

2. Starting with the front clamp, make sure the rail is pushed forward against the bulkhead and square with the bed rail. Apply downward pressure on the rail, insert the clamp as high as possible, ensuring the front bracket is captured, and tighten to 10 ft/lbs.

Repeat with the middle and then rear clamp, making sure the rail is square and flat with the bed rail.

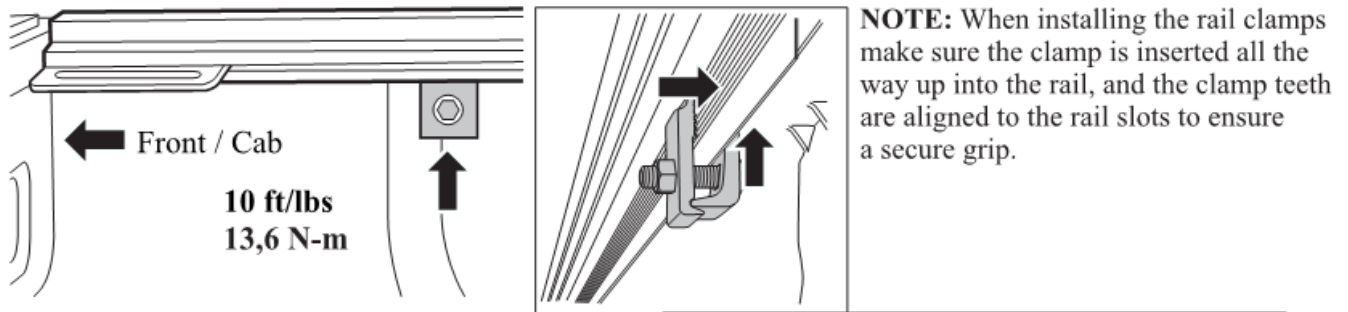

3. Repeat for remaining clamps and center shim. Make sure to apply downward pressure to the rail to allow it to rest securely on the bed rail of the truck.

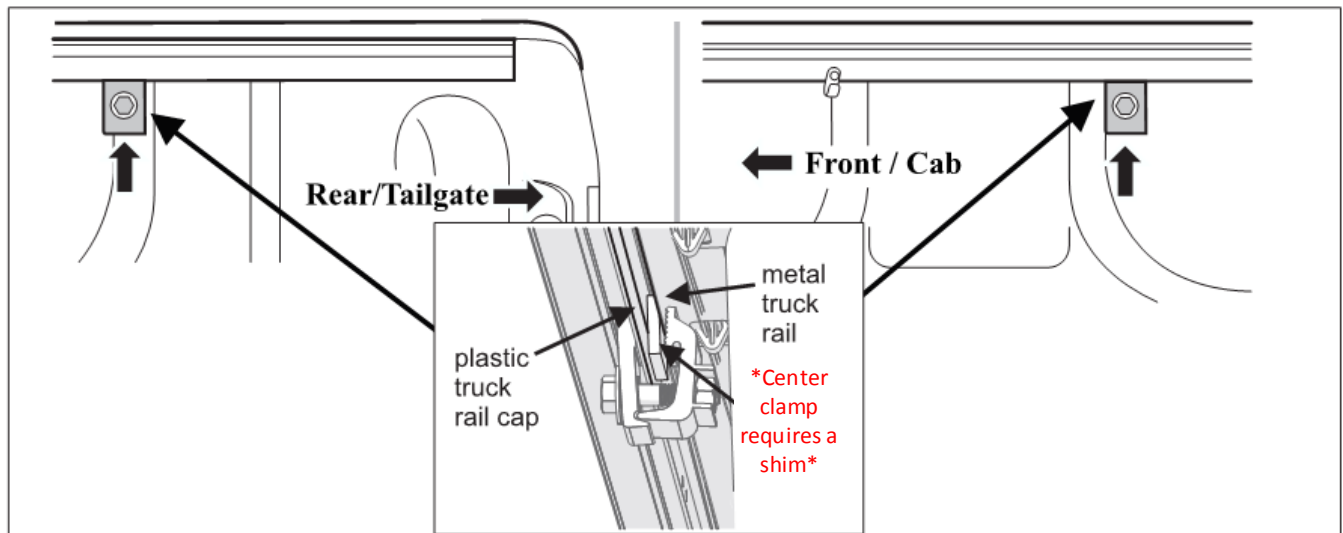

● Return to step 8 of the standard installation instructions