



Installation Instructions Halftop 4-Door

Vehicle Application:
Jeep® Wrangler Unlimited JL 2024-Current
Part Number 53904

Installation Tips

Before you begin installing your new Trek Top Halftop, please read all the instructions thoroughly.

For easier installation, the top should be installed at a temperature above 72° F. Below this temperature, the fabric may contract making it difficult to fit the vehicle.

WARNING Do not rely in any way on the components of this product to protect against injury or death in the event of an accident. Never operate the vehicle in excess of manufacturer’s specifications.

Read and follow, precisely, all installation instructions provided when installing this product. Failure to do so may result in a poor fit and could place occupants of the vehicle in a potentially dangerous situation.



CAUTION Safety glasses should be worn at all times when installing this product.

WEAR SEAT BELTS AT ALL TIMES

Tools



Safety Glasses

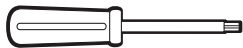

T25, T40 and T45 Torx Drivers



3mm, 4mm and 5mm Hex Keys



Phillips Head Screw Driver



8mm and 13mm Wrenches

- OR -

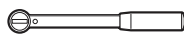

Socket Wrench



8mm - 13mm Sockets



Torque Wrench



4 hours

Skill Level



3 - Moderately Difficult

Support

We're here to help! Go to:
<https://www.bestop.com>
and click on Need Help?



<https://www.bestop.com/video-library>



Installation Instructions Halftop 4-Door

Vehicle Application:
Jeep® Wrangler Unlimited JL 2024-Current
Part Number 53904

Sugerencias de Instalación

Antes de empezar a instalar esta unidad, lea atentamente todas las instrucciones.

Para un buen ajuste:

Para facilitar la instalación, el producto debe instalarse a temperaturas superiores a 72 °F (22 °C).

Por debajo de esta temperatura, la tela puede encogerse una pulgada o más, lo que dificultaría su ajuste al vehículo.

Es normal que la tela se contraiga o arrugue cuando está guardada en la caja de empaque. A los pocos días después de la instalación, la tela se relajará y las arrugas desaparecerán.



ADVERTENCIA

Este producto se diseñó principalmente para mejorar la apariencia del vehículo y proteger a los ocupantes de las condiciones climáticas comunes. De ninguna manera piense que los componentes de este producto pueden servir como medio de contención para los ocupantes del vehículo o que pueden protegerlos contra lesiones o la muerte en caso de accidente. Este producto no protegerá a los ocupantes contra caídas de objetos. Nunca conduzca este vehículo fuera de las especificaciones del fabricante.

USE LOS CINTURONES DE SEGURIDAD EN TODO MOMENTO

Lea y siga con precisión todas las instrucciones de instalación que se proporcionan para instalar este producto. Si no lo hace, podría producirse un mal ajuste que colocaría a los ocupantes del vehículo en una situación potencialmente peligrosa.



PRECAUCIÓN

Debe usar gafas protectoras en todo momento durante la instalación de este producto.

Conseils pour l'installation

Lire toutes les instructions au complet avant de commencer l'installation de cet assemblage.

Pour un ajustement sans problème :

Afin de faciliter l'installation, ce produit doit être installé à des températures au-dessus de 72 °F (22 °C).

Sous cette température, le tissu peut rétrécir d'un pouce (2,5 cm) ou plus, ce qui rendra l'ajustement sur le véhicule difficile.

Il est normal que le tissu rétrécisse et plisse pendant qu'il est dans la boîte d'expédition. En quelques jours après l'installation, le tissu se détendra et les plis disparaîtront.



AVERTISSEMENT

Ce produit est conçu principalement pour améliorer l'apparence du véhicule et pour protéger les occupants des conditions météorologiques usuelles. Ne jamais se fier aux composants de ce produit pour se protéger de blessures ou de la mort en cas d'accident. Ce produit ne protégera pas les occupants des chutes d'objets. Ne jamais utiliser le véhicule au-delà des caractéristiques techniques indiquées par le fabricant.

PORTER UNE CEINTURE DE SÉCURITÉ EN TOUT TEMPS

Lire et suivre, très fidèlement, toutes les instructions d'installation fournies lors de l'installation de ce produit. Ne pas suivre cette consigne peut causer une installation inadéquate et mettre les occupants du véhicule dans une situation potentiellement dangereuse.



MISE EN GARDE

Des lunettes de sécurité doivent être portées en tout temps lors de l'installation de ce produit.



Parts Kit #576.59

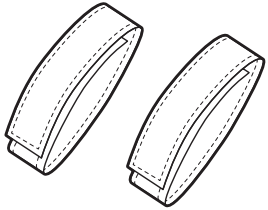

Sunrider Tie-Down Straps
Part #410.42
Qty. 2

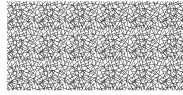

2.5" x 2" Hook-&-Loop Strip
#592.35
Qty. 6



M5x0.8x25mm
Button Head
Socket Cap Screw
#579.60
Qty. 8



M6 x 1x14mm
Button Head
Socket Cap Screw
#517.63
Qty. 18

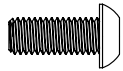

M8x1.25x20mm
Button Head
Socket Cap Screw
#431.59
Qty. 4

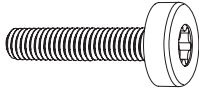

M8x1.25x38mm
Button Head
Socket Cap Screw
#532.17
Qty. 2



M5 Nylon Lock Nut
#526.76
Qty. 8



M8x1.25
Nylon Lock Nut
#434.12
Qty. 4



Strap Clip
#338.24
Qty. 2



M5 Flat Washer
#565.90
Qty. 16



M6 Flat Washer
#515.81
Qty. 12

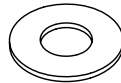

M8 Flat Washer
#515.84
Qty. 4

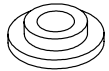

Plastic Bushing
#473.40
Qty. 16



Bestop Sticker
Part #338.32
Qty. 1

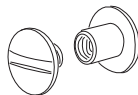

Screw, Binding Barrel
Part #599.01
Qty. 2



Loctite Capsule
Part #309.83
Qty. 1

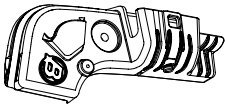

Tailgate Bar Retainer
Part #575.38 - Right
Qty. 1

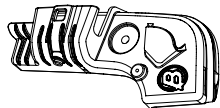

Tailgate Bar Retainer
Part #575.39 - Left
Qty. 1



30 inch Nylon Strap
Part #629.63
Qty. 1

Parts Kit #671.66

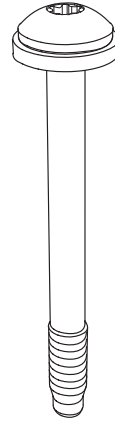

M8x1.25x80
Screw
#532.23
Qty. 8

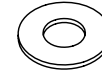

M8 Flat Washer
#515.84
Qty. 2

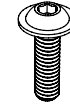

M6x20mm
Flanged Button Head
Cap Screw
#517.48
Qty. 4

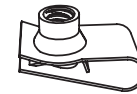

M6 U-Clip
#537.49
Qty. 4

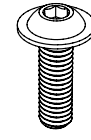

M8x1.25x20mm
Button Head Cap
Screw
#573.09
Qty. 4

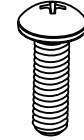

5/16.18 x 1"
Truss Screw Head
#236.20
Qty. 2

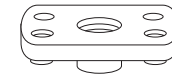

Tapping Plate
#200.50
Qty. 2

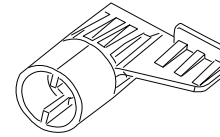

Plastic End Caps - Left
Part # 593.71
Qty. 1

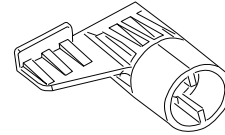

Plastic End Caps - Right
Part # 592.66
Qty. 1

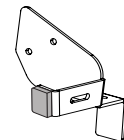

Bow Support Bracket
Rear Right
Part #609.32
Qty. 1 ea

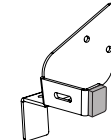

Bow Support Bracket
Rear Left
Part #609.33
Qty. 1 ea

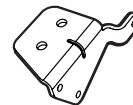

#4 Bow Bracket
Part #576.30 - Right
Qty. 1

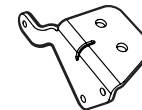

#4 Bow Bracket
Part #576.31 - Left
Qty. 1

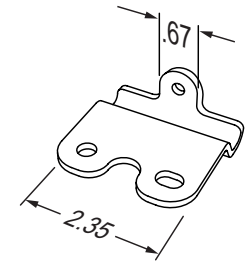

Side Bow Pivot Bracket
Part #579.96
Qty. 2

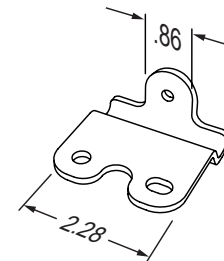

#2 Bow Pivot Bracket
Part #579.95
Qty. 2

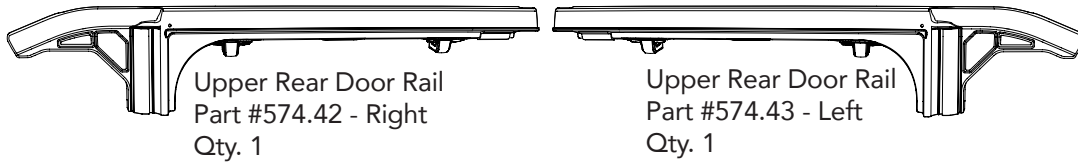

Upper Rear Door Rail
Part #574.42 - Right
Qty. 1

Upper Rear Door Rail
Part #574.43 - Left
Qty. 1

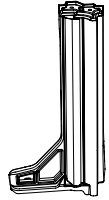

Lower Rear Door Rail
Part #574.46 - Right
Qty. 1

Lower Rear Door Rail
Part #574.47 - Left
Qty. 1

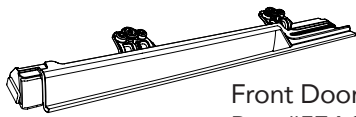
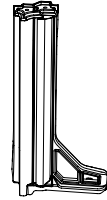

Front Door Rail
Part #574.32 - Right
Qty. 1

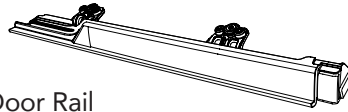

Front Door Rail
Part #574.33 - Left
Qty. 1

#2 Bow Link Assembly
Part #576.16 - Right
Qty. 1

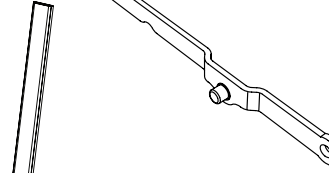

#2 Bow Link Assembly
Part #576.15 - Left
Qty. 1

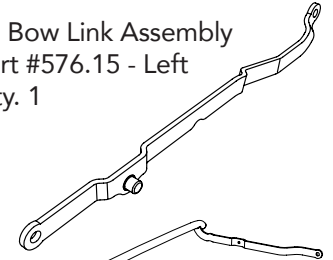

#2 Bow Assembly
Part #576.44
Qty. 1

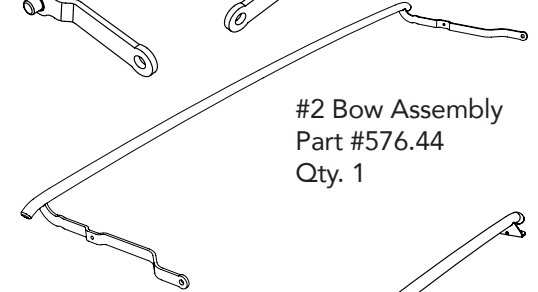

Bow D Pillar
Part #603.93
Qty. 2

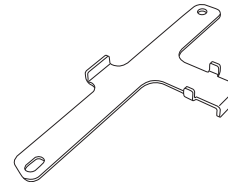
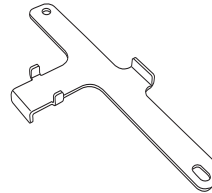

#4 Bow Assembly
Part #576.55
Qty. 1

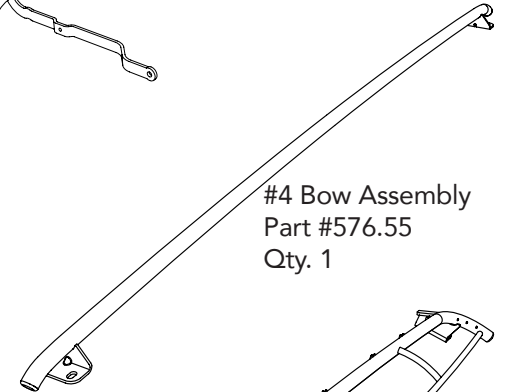

Header Assembly & Fabric Top

Windjammer Assembly

Adapter Bracket
Part #670.93 - Left
Qty. 1

Adapter Bracket
Part #670.92 - Right
Qty. 1

#5 Bow Assembly
Part #576.57
Qty. 1

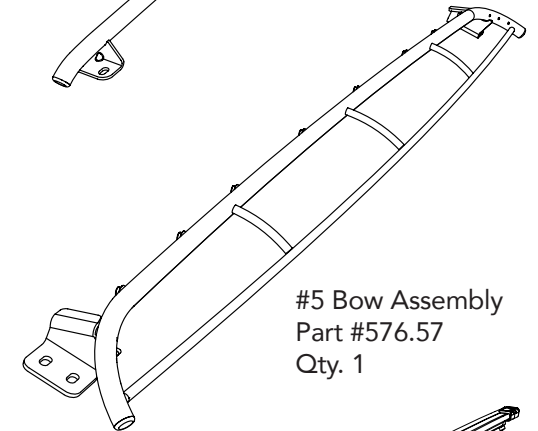

Sportbar Sleeve Right

Sportbar Sleeve Left

Duster Cover



Extruded Aluminum Bow
Qty. 1
Part # 671.23

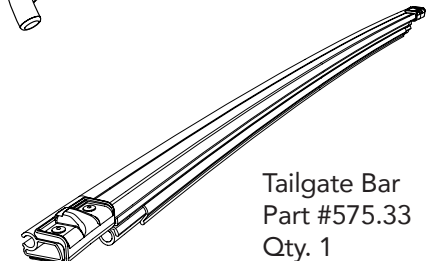

Tailgate Bar
Part #575.33
Qty. 1

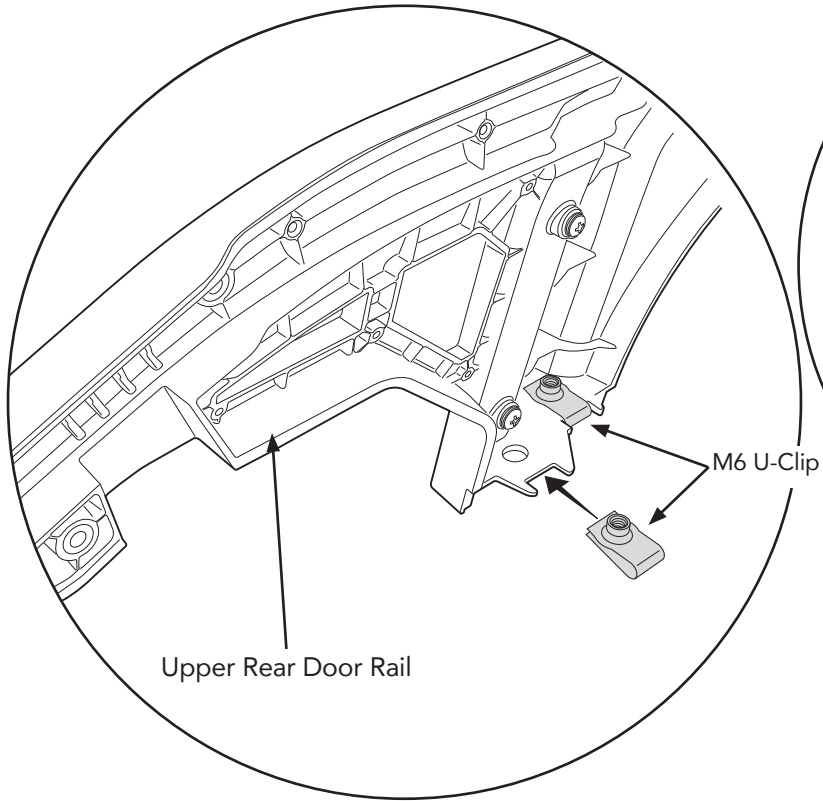

Attach the two (2) U-Clips to the Upper Rear Door Rails in the positions indicated. Make sure to have the threaded barrel of each U-Clip facing up.

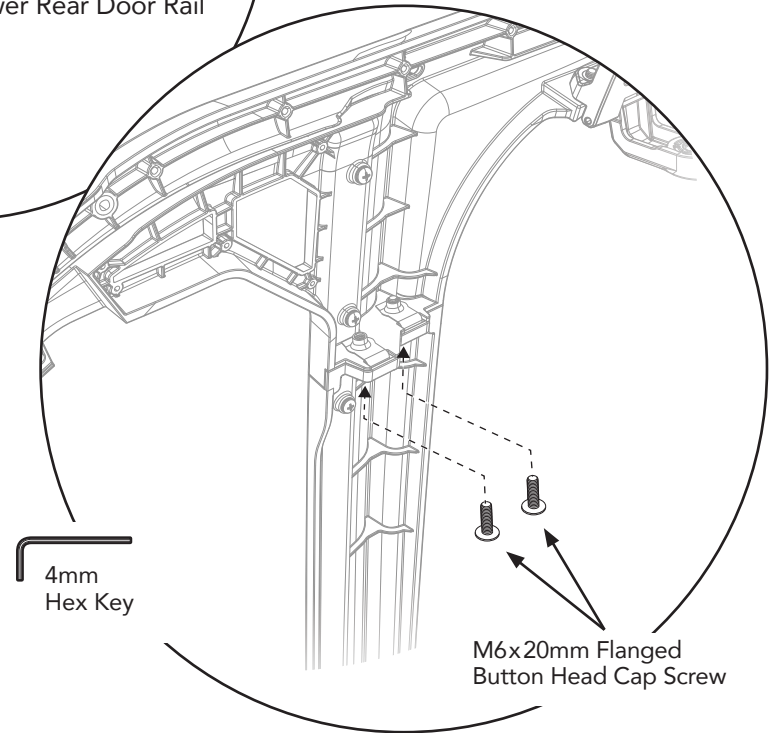
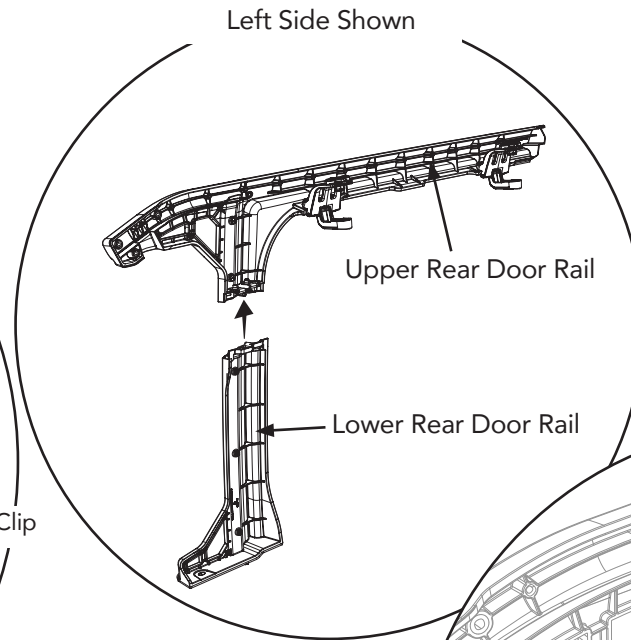

Attach the Upper Rear Door Rails to the Lower Rear Door Rails using two (2) Button Head Cap Screws. thread up from the bottom into the U-Clips.

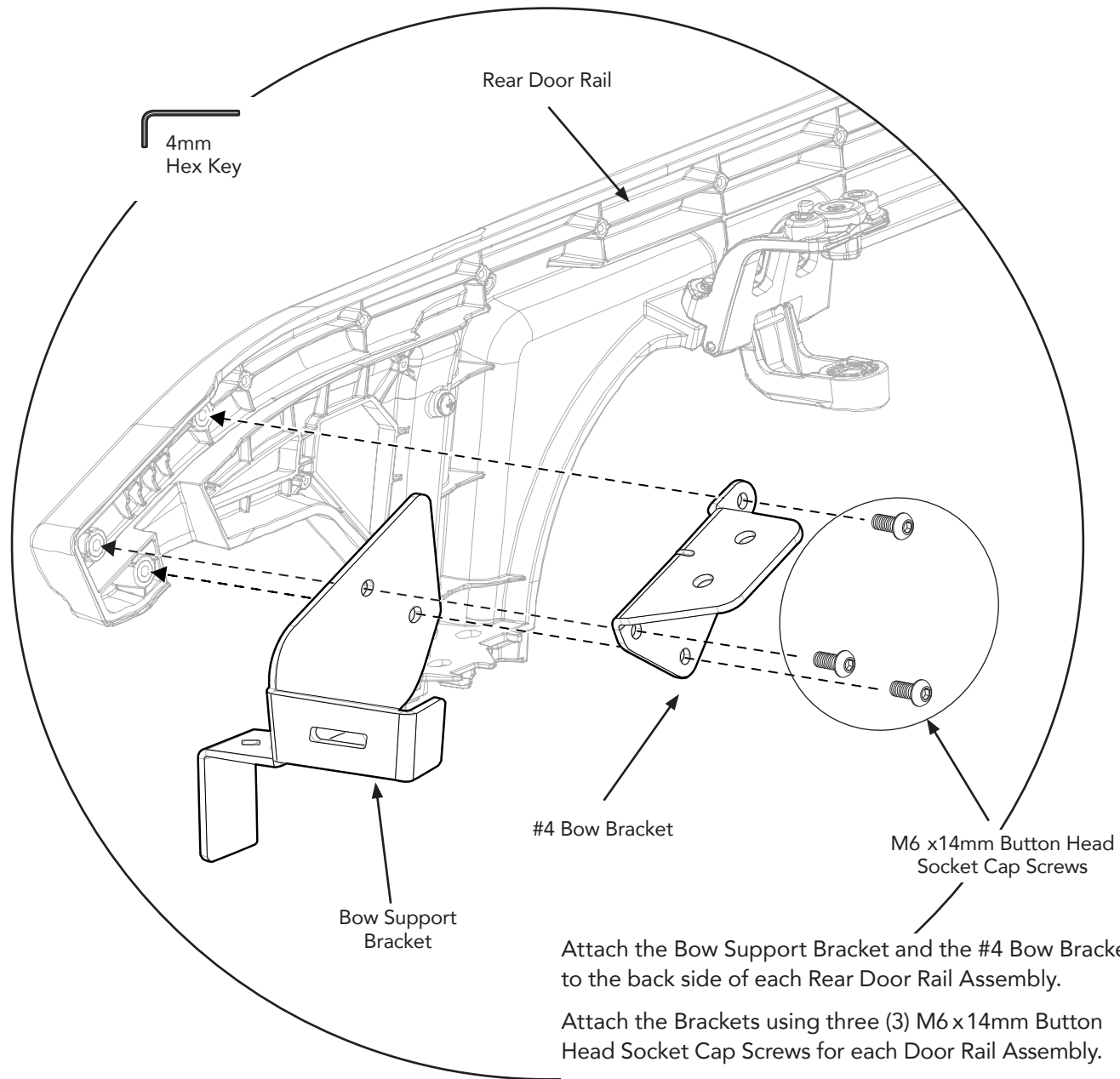

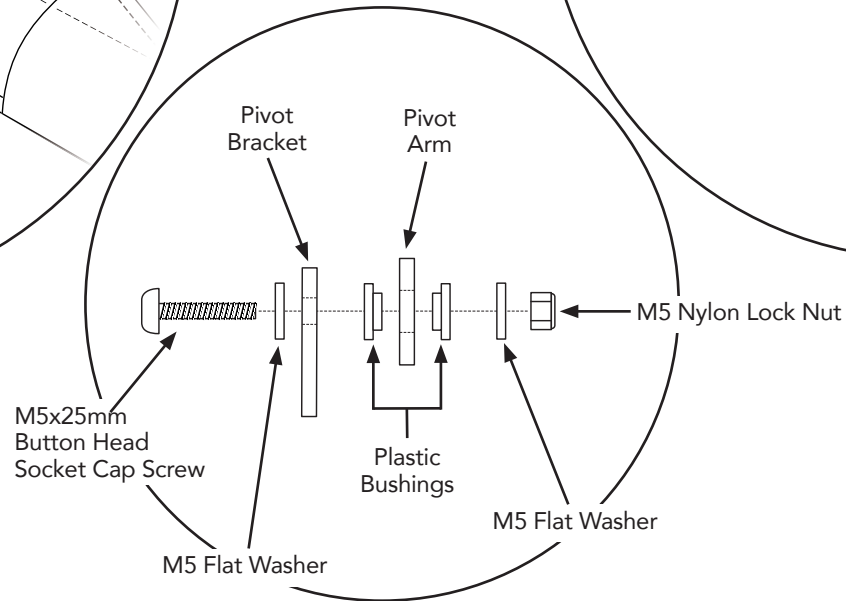
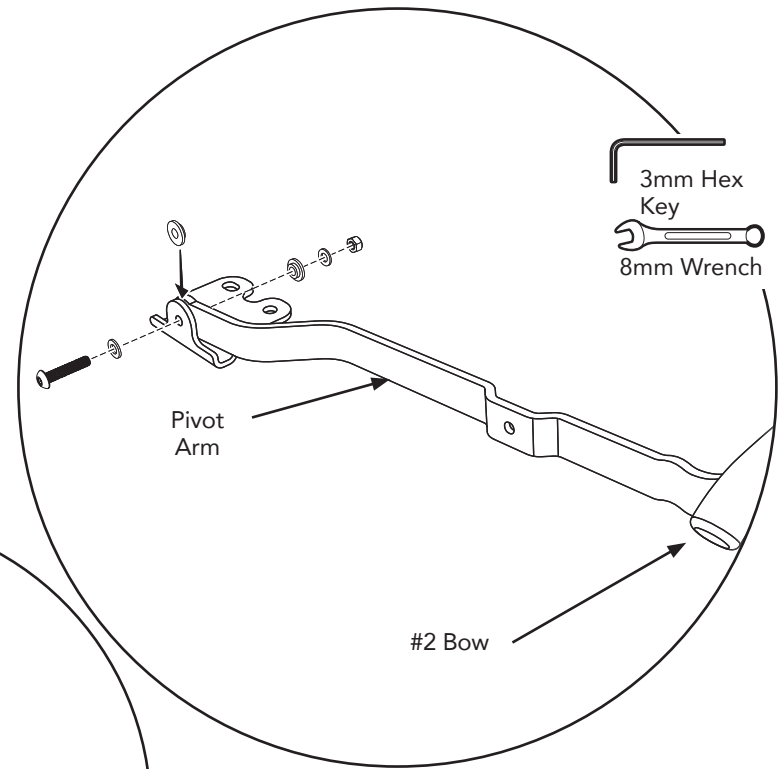
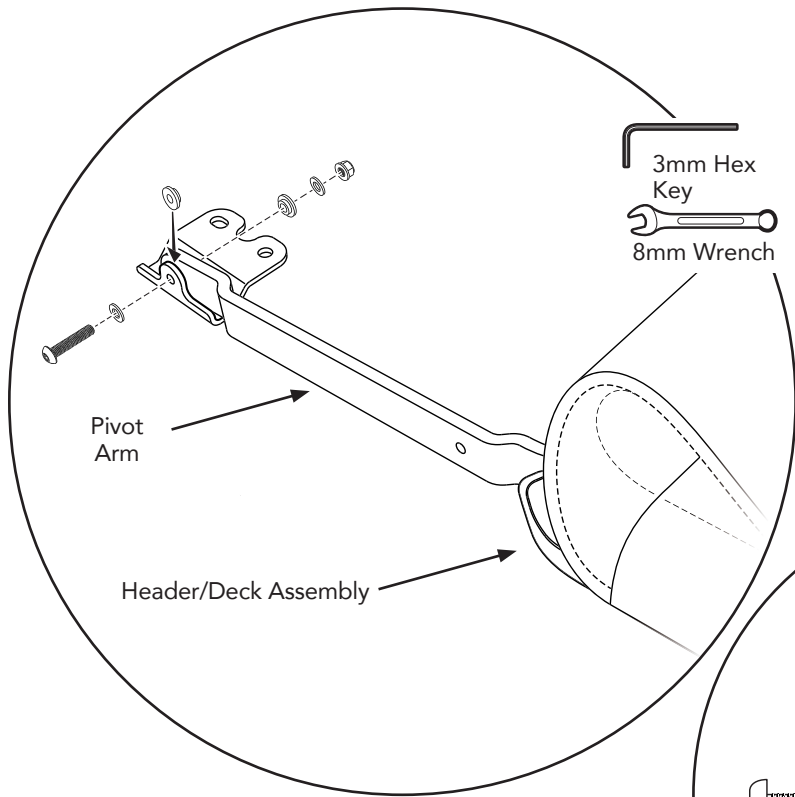

Attach the Side Bow Pivot Brackets to the Side Bows on the Header/Deck Assembly.

The Brackets attach to the end of each Side Bow using one (1) M5x25mm Button Head Socket Cap Screw, two (2) Bushings, two (2) M5 Flat Washers and one (1) M5 Nylon Lock Nut on each Side Bow Leg.

The Plastic Bushings go directly on either side of the Side Bow Pivot arm, with the larger hole.

Attach the #2 Bow Pivot Brackets to the #2 Bow.

The Brackets attach to the end of each #2 Bow leg using one (1) M5x25mm Button Head Socket Cap Screw, two (2) Bushings, two (2) M5 Flat Washers and one (1) M5 Nylon Lock Nut on each Side Bow Leg.

The Plastic Bushings go directly on either side of the Side Bow Pivot Arm, with the larger hole.

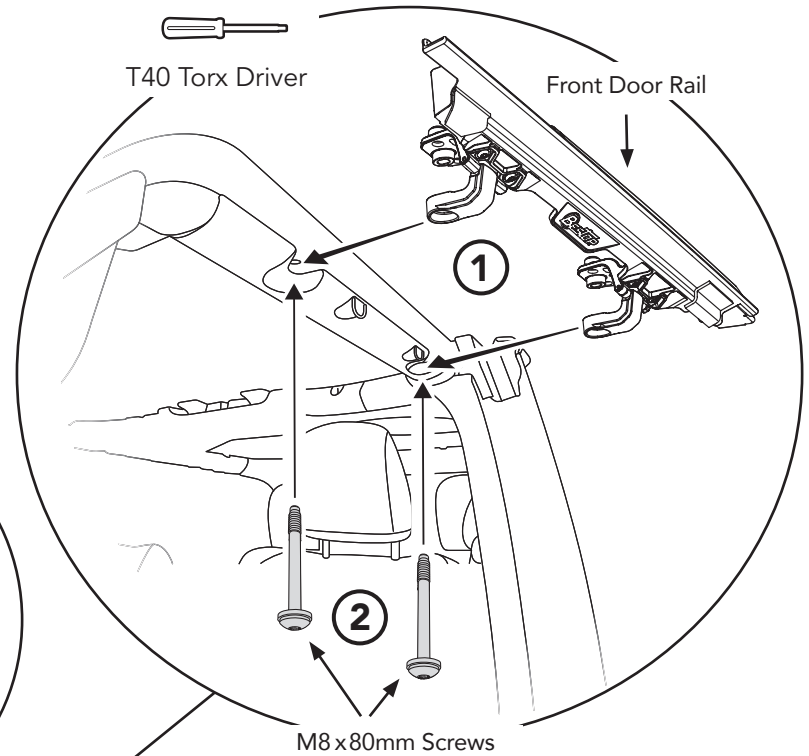
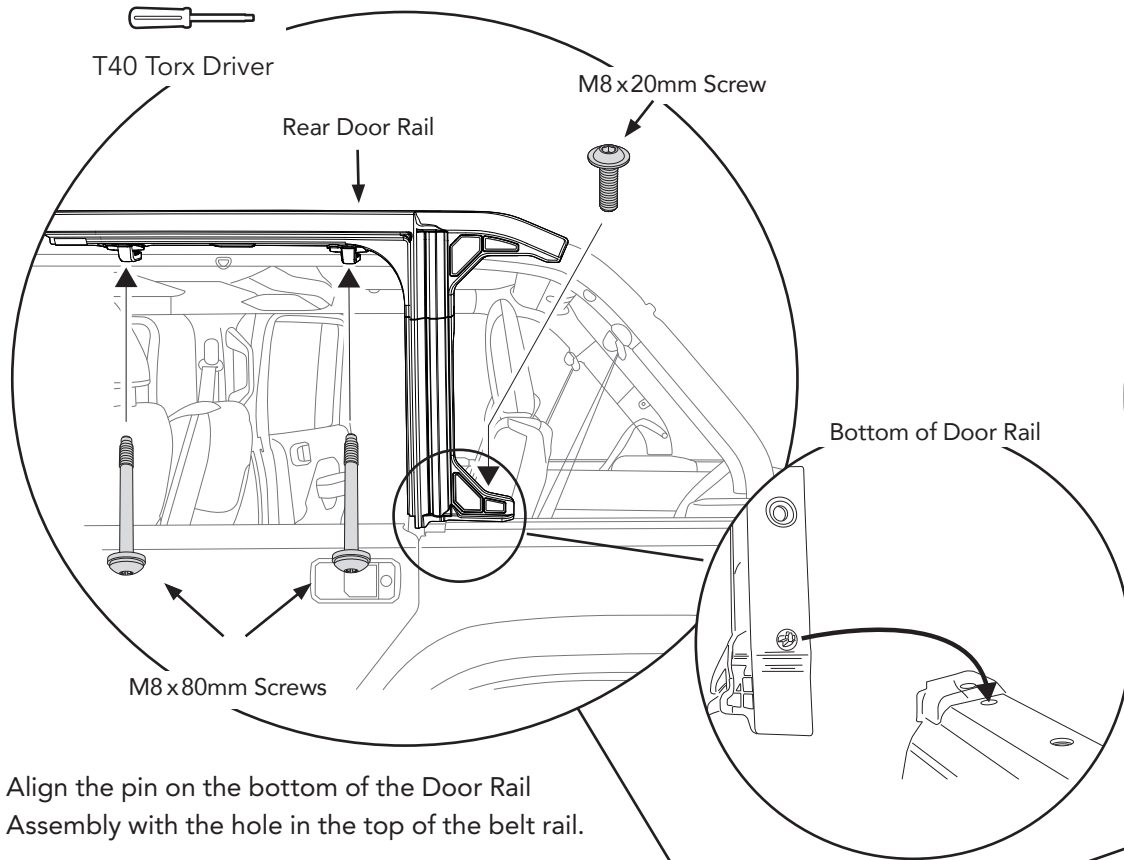

Align the pin on the bottom of the Door Rail Assembly with the hole in the top of the belt rail. Align the rail brackets with the through-holes in the Jeep sport bar then Insert two (2) M8 x 80mm Screws up from the bottom and one (1) M8 x 20mm through the Lower Door Rail into the threaded hole in the belt rail.

1. Place each Front Door Rail on the Jeep, aligning the rail brackets with the through-holes in the Jeep sport bar.

2. Secure each Front Door Rail to the sport bar using two (2) M8 x 80mm Socket Cap Screws.

NOTE: Tighten fasteners to 55 in/lb (4.5 ft/lb).

If a torque wrench is not available, use a Screwdriver type Torx driver to prevent over torquing.

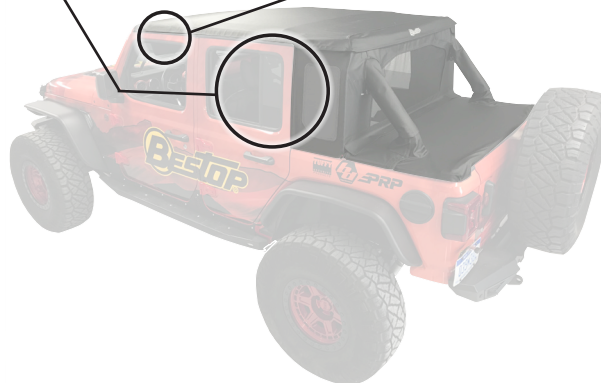

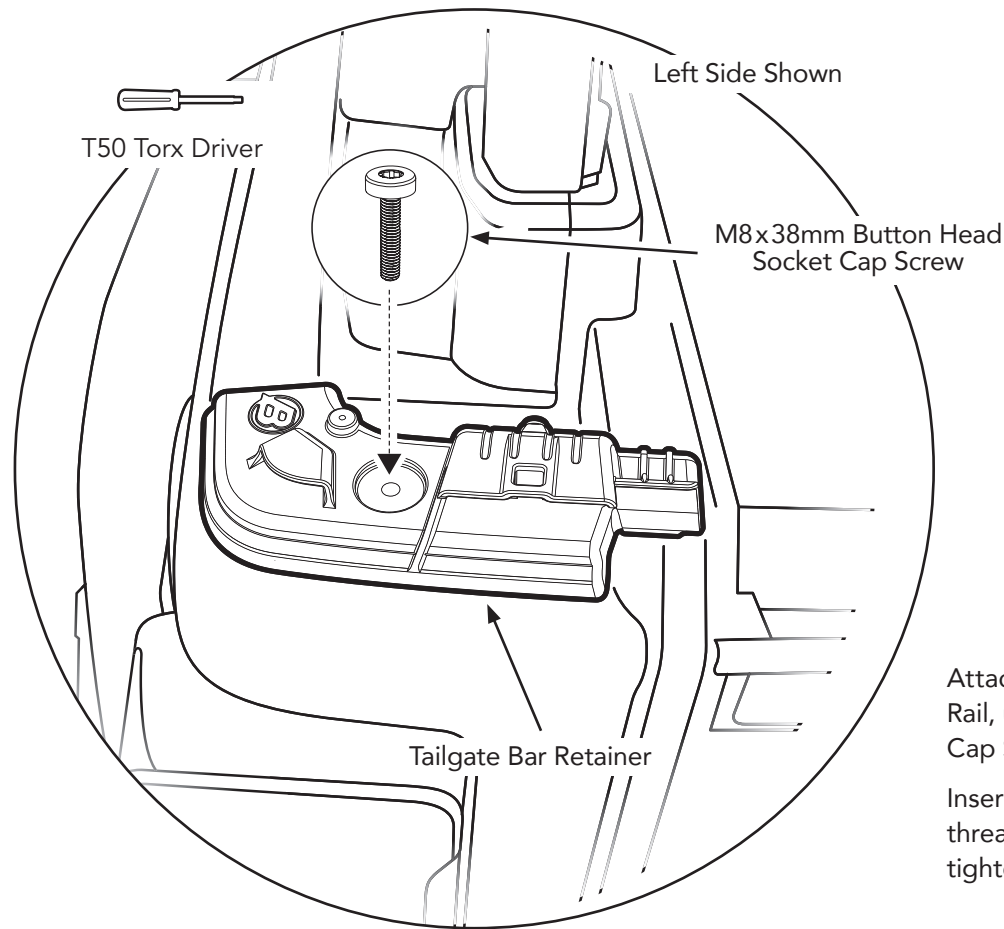

Attach the Tailgate Bar Retainers to the Jeep Belt Rail, using one (1) M8x38mm Button Head Socket Cap Screw per retainer.

Insert the screws through the retainers, and into threaded holes in the top of the Jeep belt rail, and tighten.



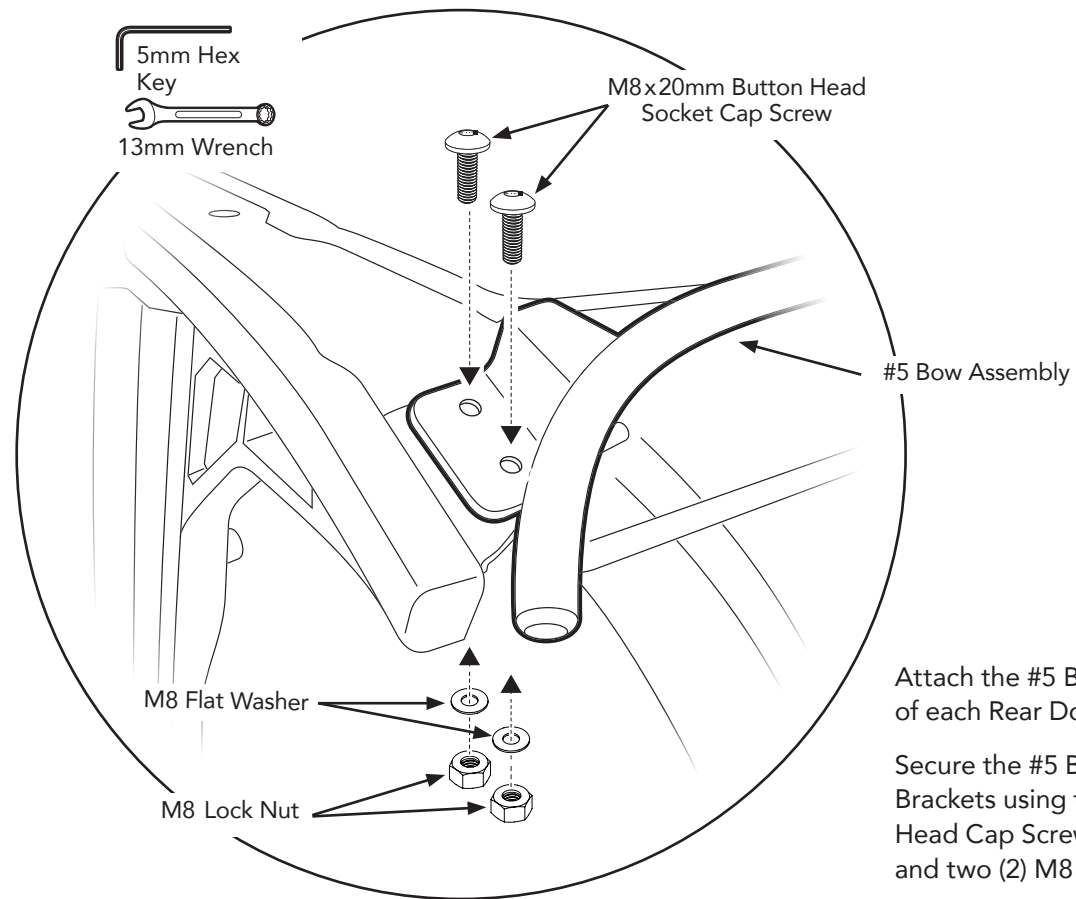

Attach the #5 Bow to the brackets on the rear of each Rear Door Rail.

Secure the #5 Bow to the Rear Door Rail Brackets using two (2) M8 x 20mm Button Head Cap Screws, two (2) M8 Flat Washers and two (2) M8 Nylon Lock Nuts on each side.



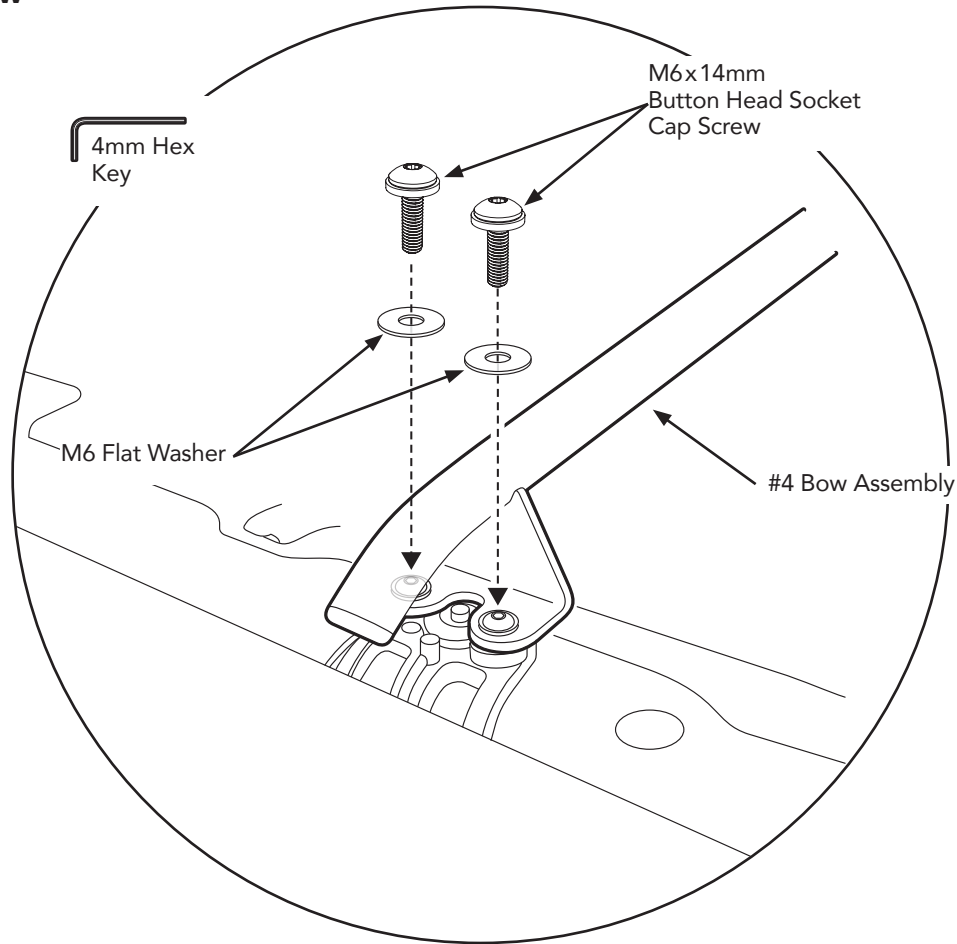

Attach the #4 Bow to the top of the Rear Door Rail rear brackets.

Secure the #4 Bow to the top of the brackets using two (2) M6x14mm Button Head Cap Screws and two (2) M6 Flat Washers on each side of the Jeep.



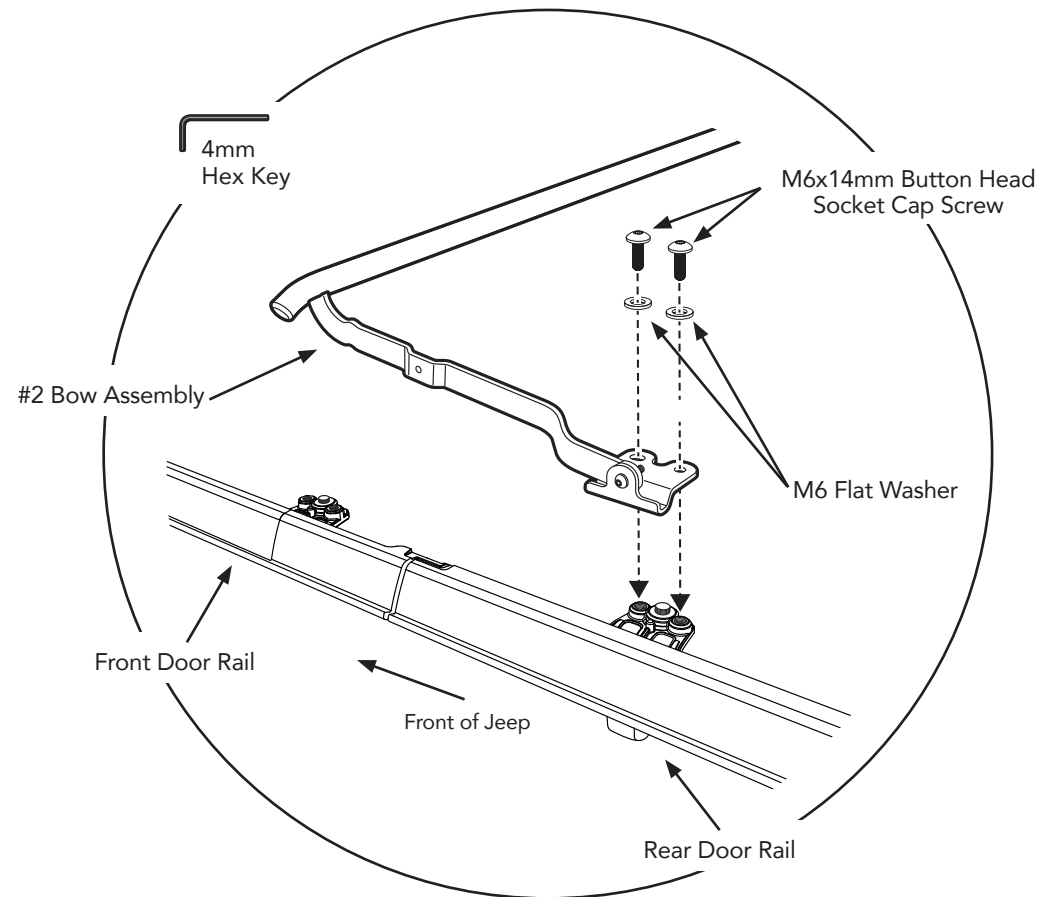

Attach the #2 Bow Assembly to the top of the Rear Door Rail front brackets.

Secure the #2 Bow to the top of the brackets using two (2) M6 x14mm Button Head Cap Screws and two (2) M6 Flat Washers on each side of the Jeep.



Section 9 Attach Bow Link to Side Bow

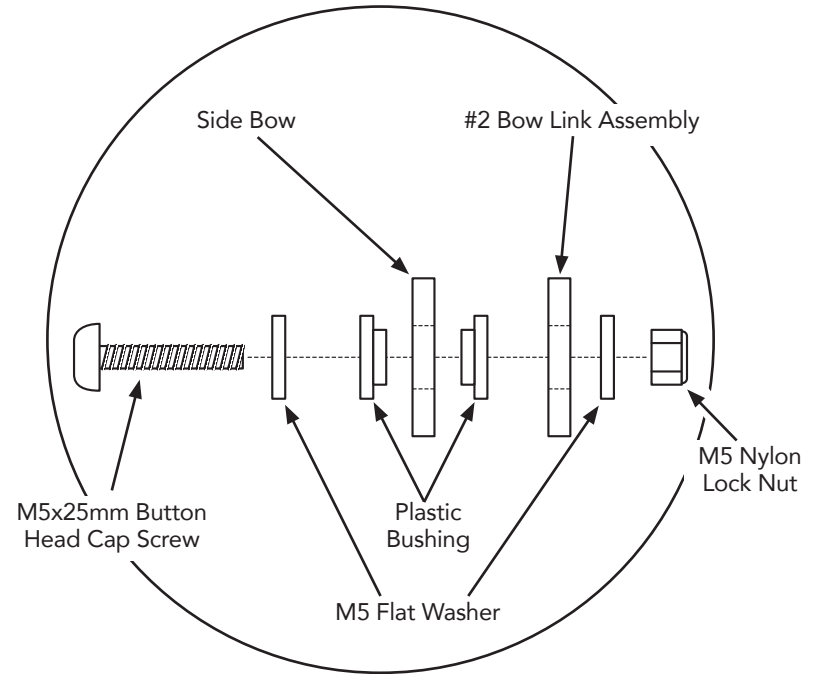
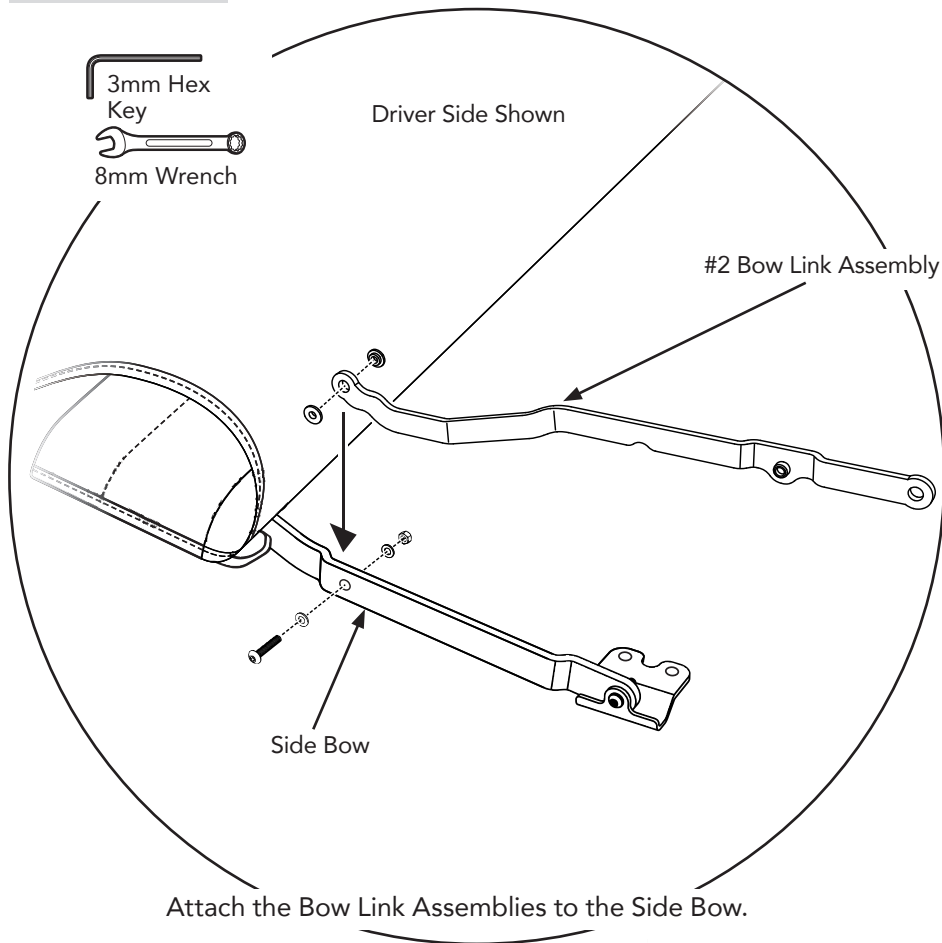

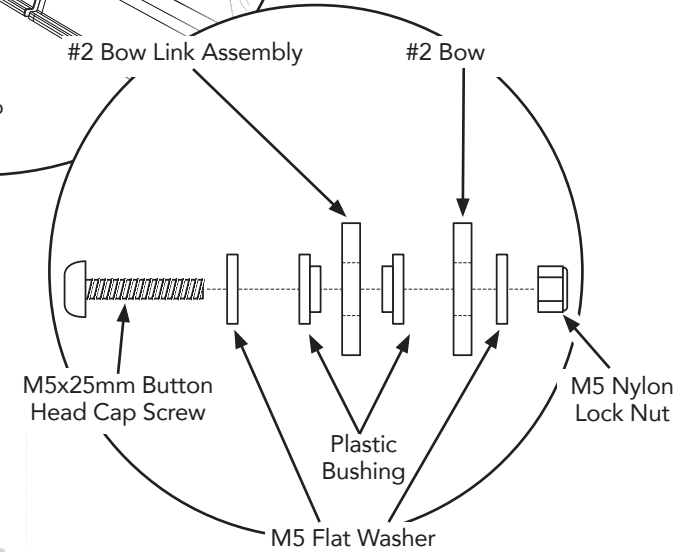
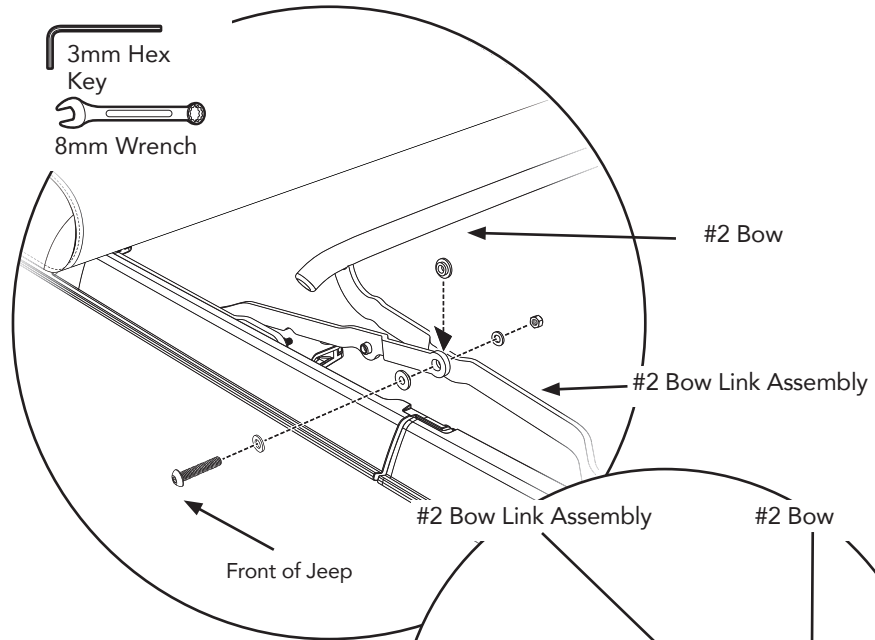
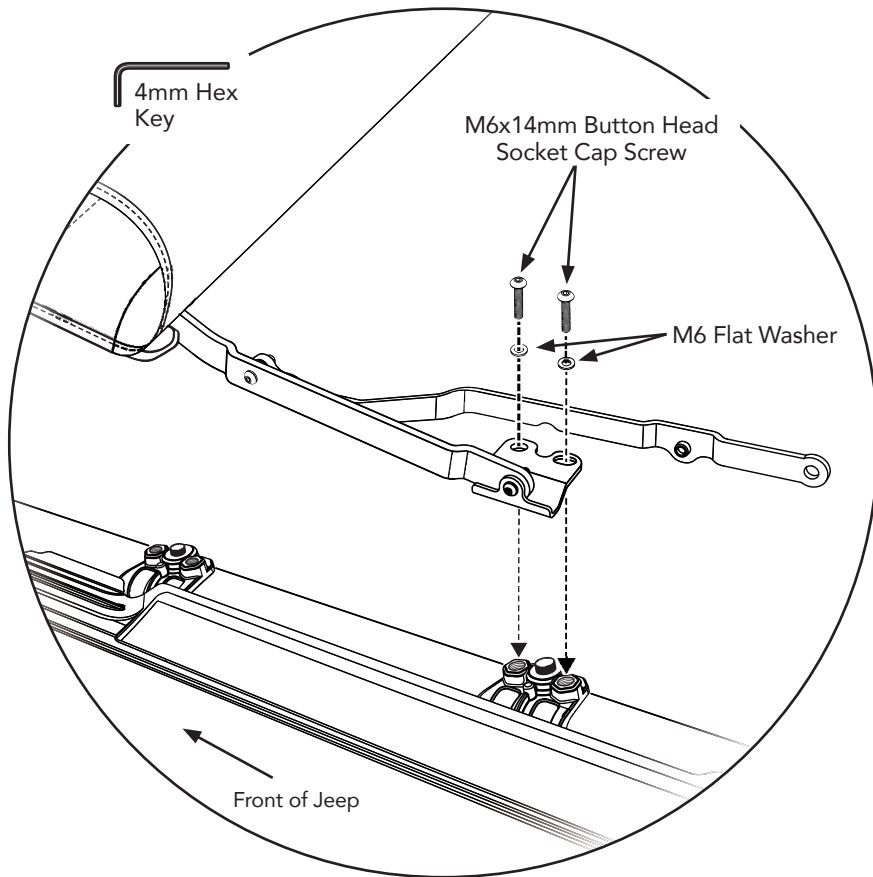

Lift the Header/Deck-Side Bow Assembly onto the top of the Jeep, resting the Header on top of the Jeep windshield header.

Tip This will be much easier with two people.

Attach the #Header/Deck/Side Bow Assembly to the top of the Front Door Rail rear brackets using two (2) M6x14mm Button Head Cap Screws and two (2) M6 Flat Washers on each side of the Jeep.



Attach the Bow Link Assemblies to the #2 Bow.

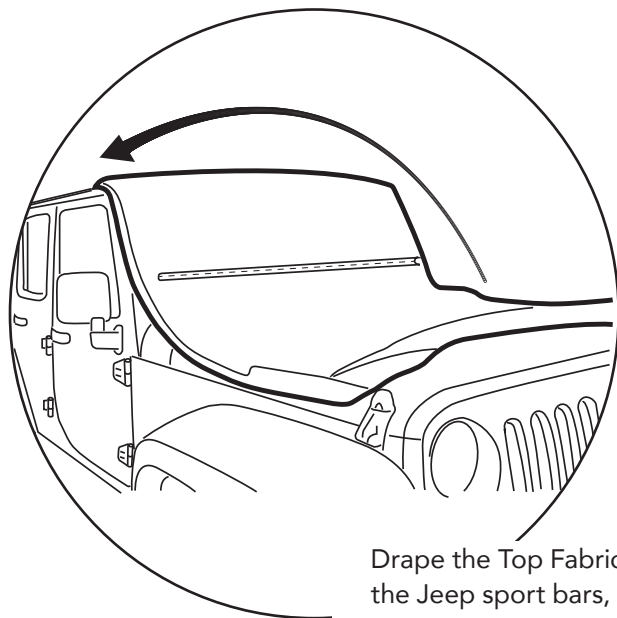

Drape the Top Fabric back across the top of the Jeep sport bars, and the #2, #3, and #4 Bows.

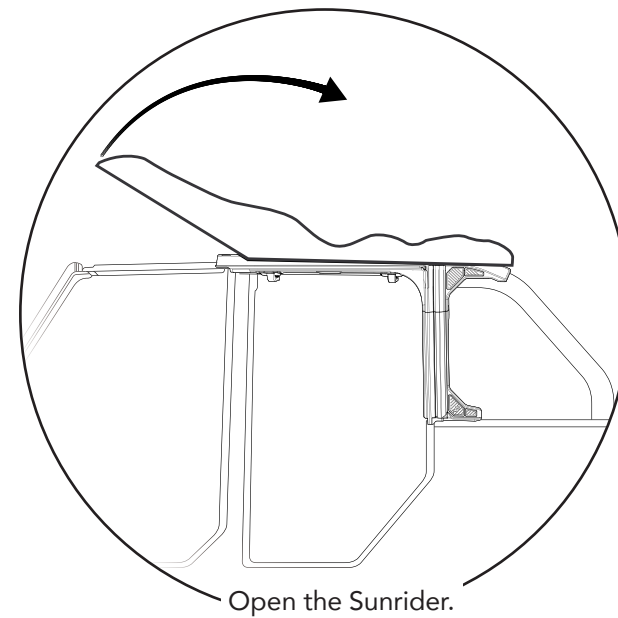
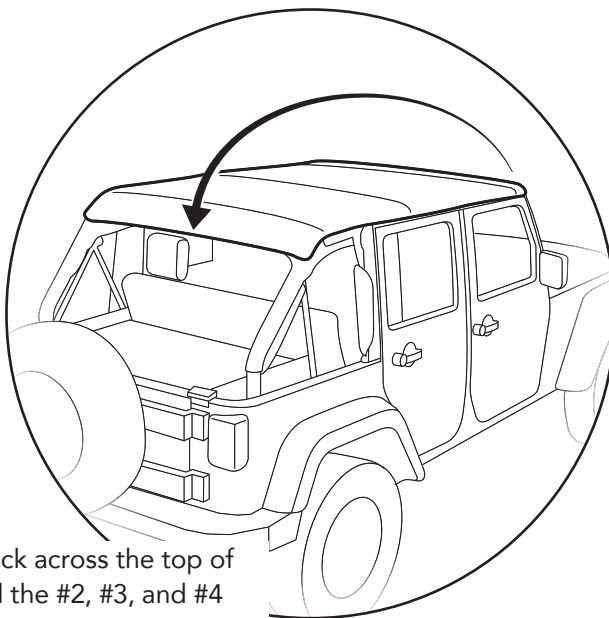

Open the Sunrider.

Tip This will be much easier with two people.



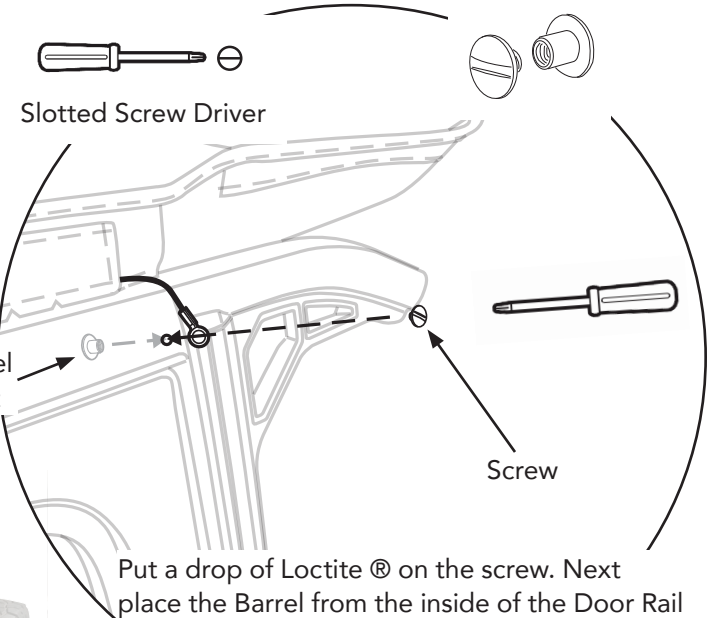
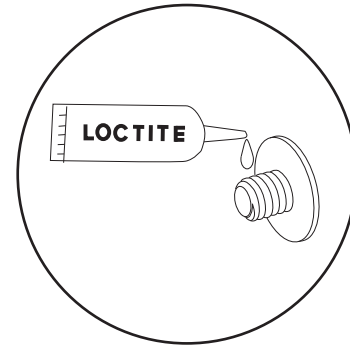
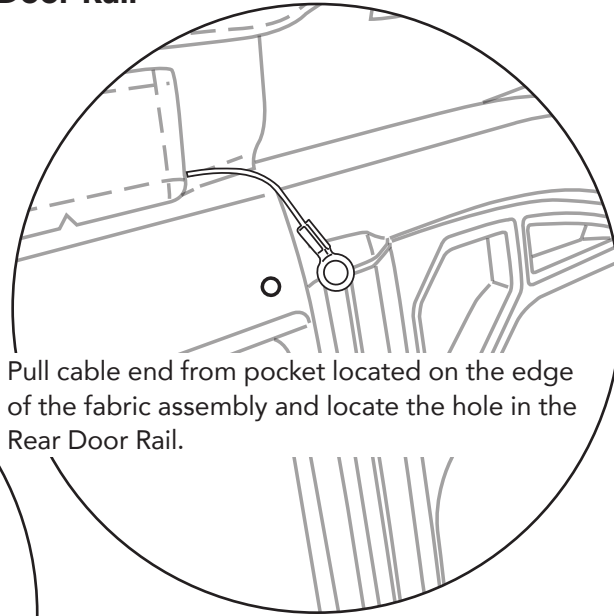
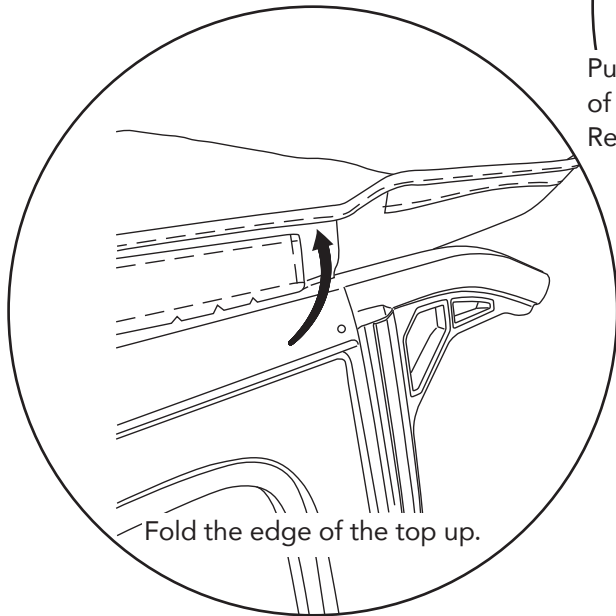

Attach the six (6) Hook-&-Loop Strips to the #5 Bow as shown.

Wrap the Hook-&-Loop Strips around the cross-bars of the #5 Bow attaching one side of each strip to the opposite side. Make sure that the "hook" side ("scratchy side") of each wrapped strip is on the outside, so that it will adhere to the "loop" strip on the underside of the top fabric.

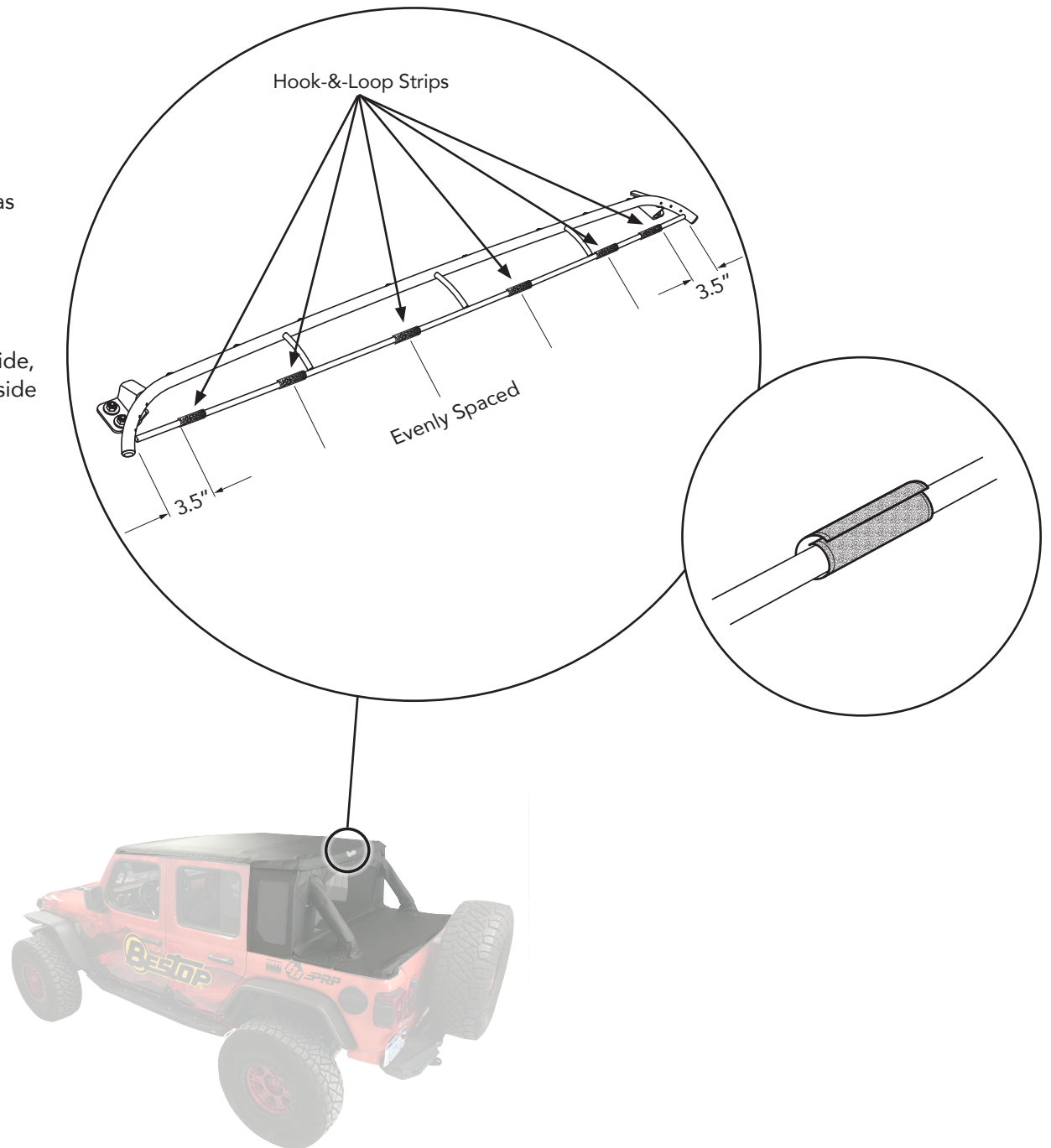

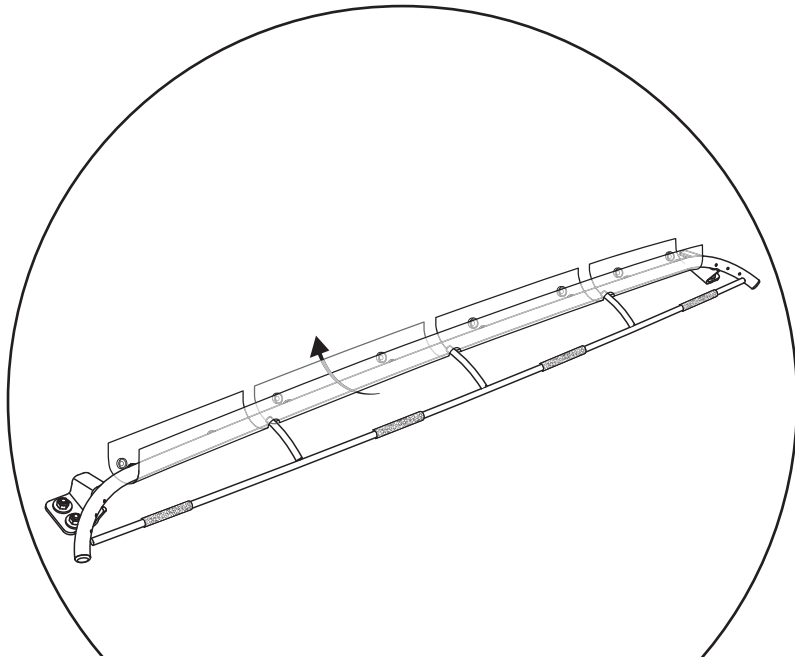

Locate the four flaps sewn to the inside of the fabric top just above the #5 Bow.

Wrap these flaps around the #5 Bow from back-to-front, and snap to the snaps on the front side of the #5 Bow.

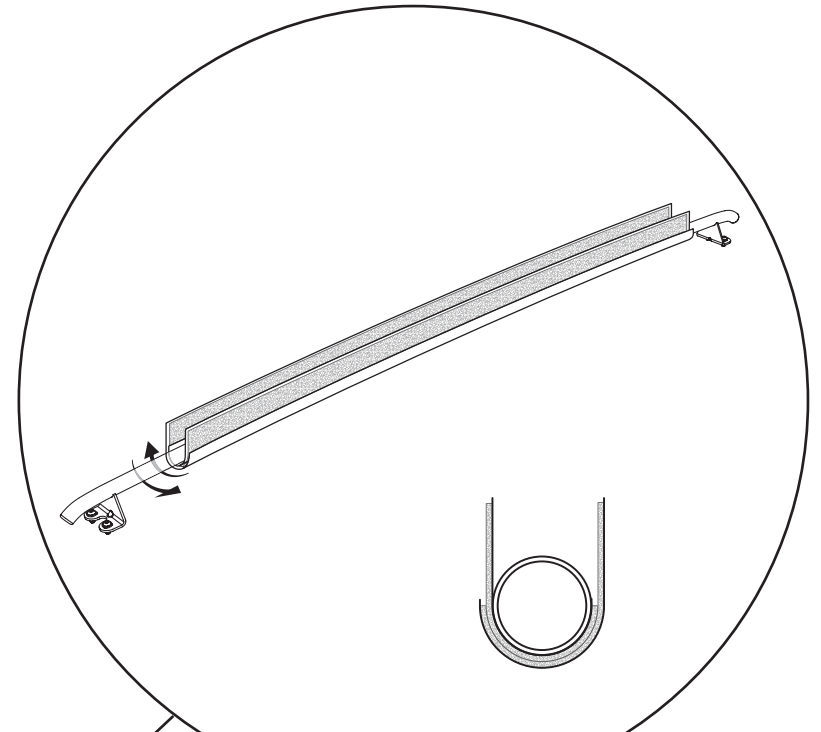

Locate the two fabric flaps sewn to the inside of the fabric top just above the #4 Bow.

Wrap these flaps around the #4 Bow so that the Hook side of one flap attaches to the Loop side of the other flap.



Vehicles with Latch Tabs

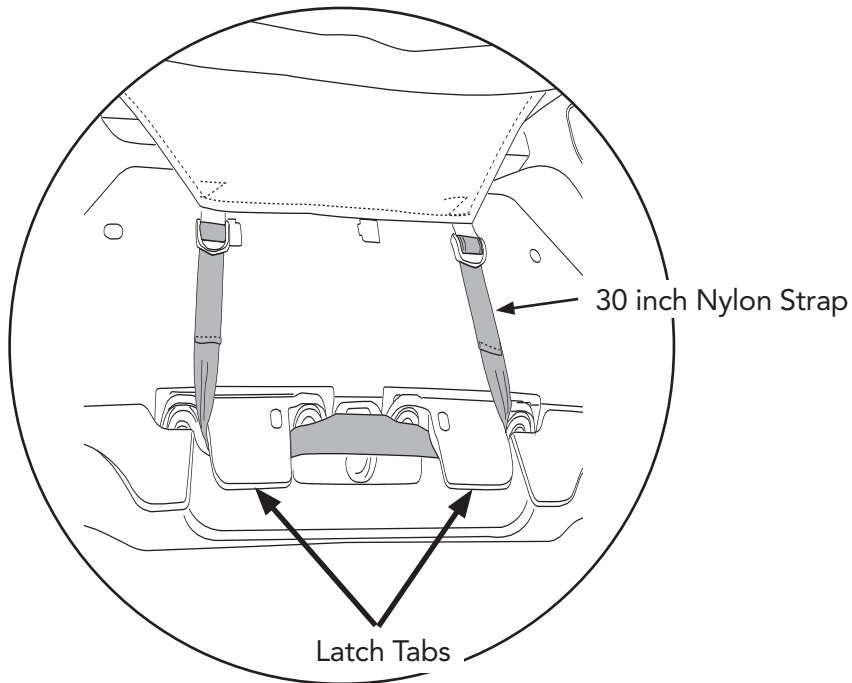

Loosely thread the 30 inch Nylon Strap through the two buckles on the center flap (Located on the inside of the main top)
Locate the two tabs that the rear latches of the Freedom Panels latch to. Wrap the 30 inch Nylon Strap underneath the tabs then pull the strap (at the buckles) until snug.

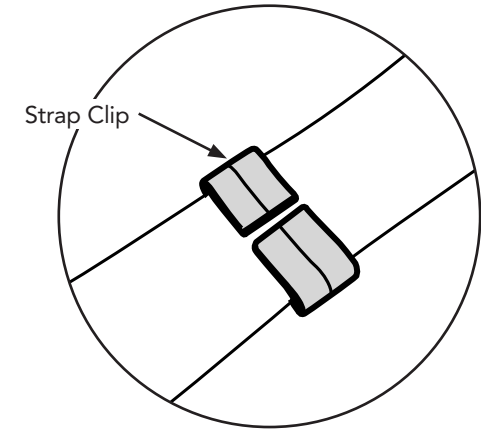

Place the lower strap between the two tabs on the lower side of the clip.

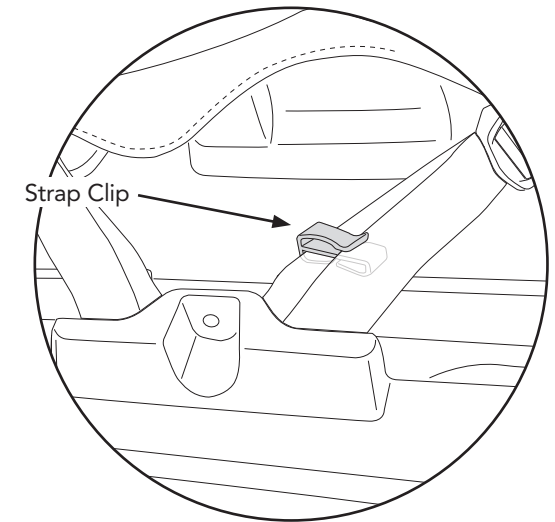

Place the upper strap into the single tab on the top of the clip.

Repeat on the other side of the strap.

Vehicles without Latch Tabs

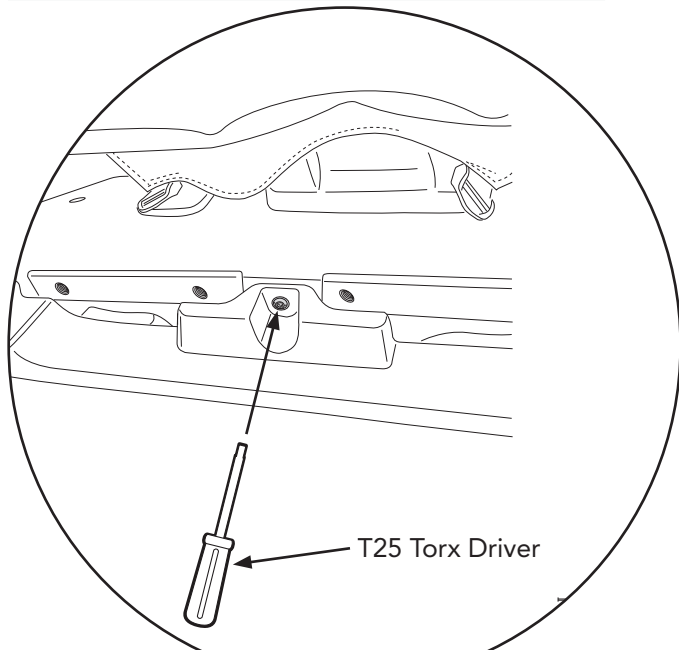

Remove screw from center of plastic trim piece.

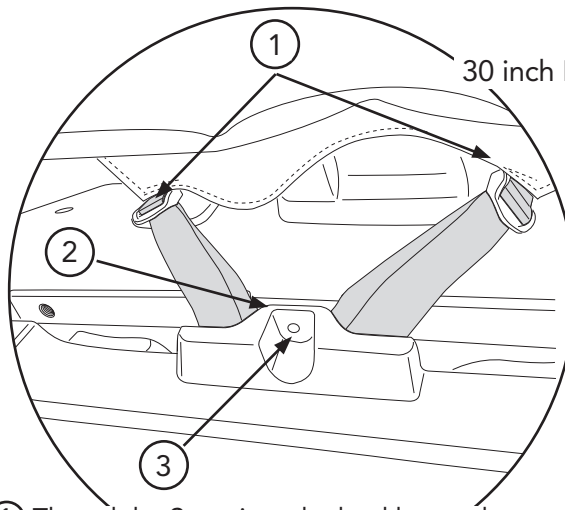

- 1 Thread the Strap into the buckles on the Center Flap.
- 2 Pull back on plastic enough to slide the strap down below the hole for the screw.
- 3 Replace the screw.

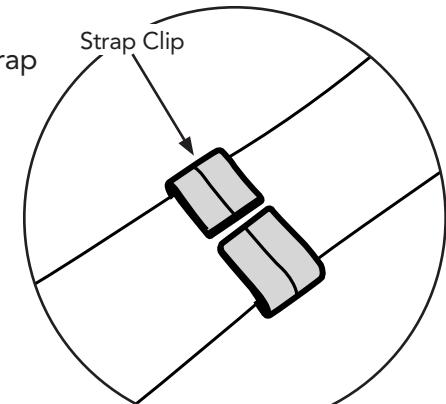

Place the lower strap between the two tabs on the lower side of the clip.

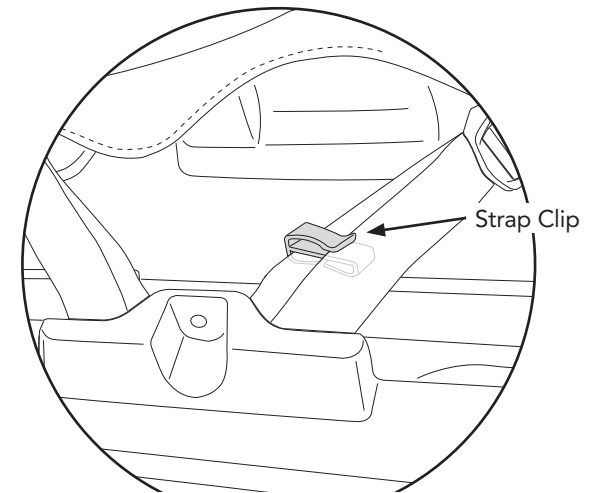

Place the upper strap into the single tab on the top of the clip.

Repeat on the other side of the strap.



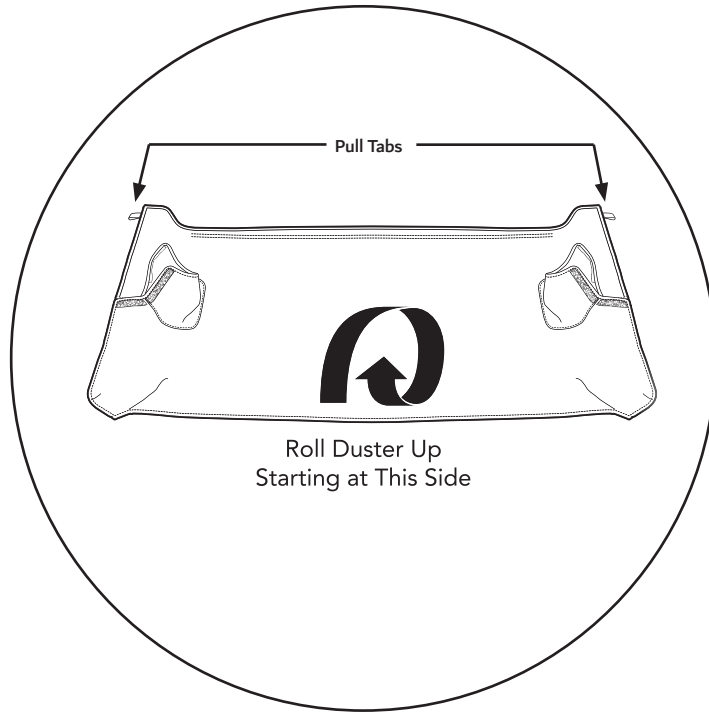

Starting on the side of the Duster without the pull tabs, roll the Duster up loosely. The side of the Duster with the pull tabs is the front edge.

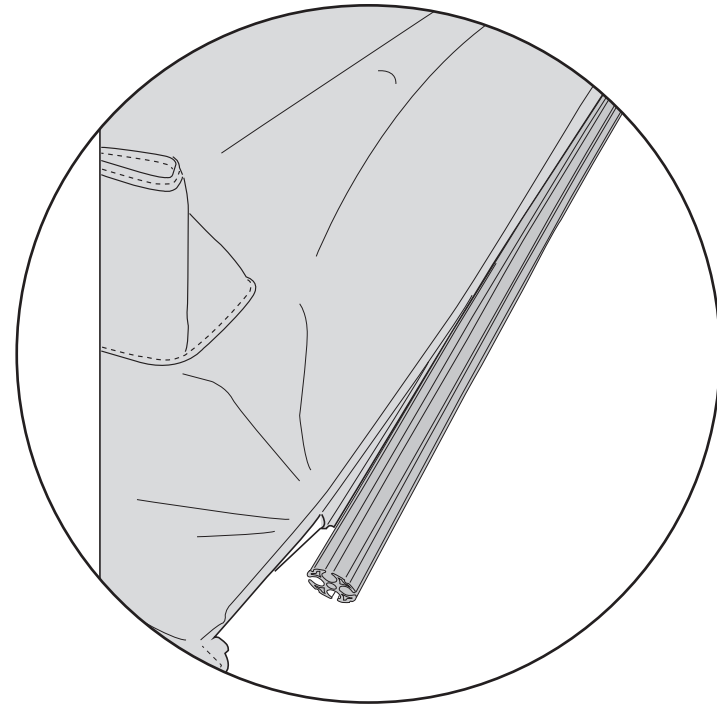

With the Duster loosely rolled up, slide the P-Extrusion along the exposed front edge of the Duster into the top slot of the Extruded Aluminium Bow, using the slot in the Bow that is on top of the arch and facing up.

NOTE: Aluminium Extrusion has an arch. The Duster should be in the top part of the arch.

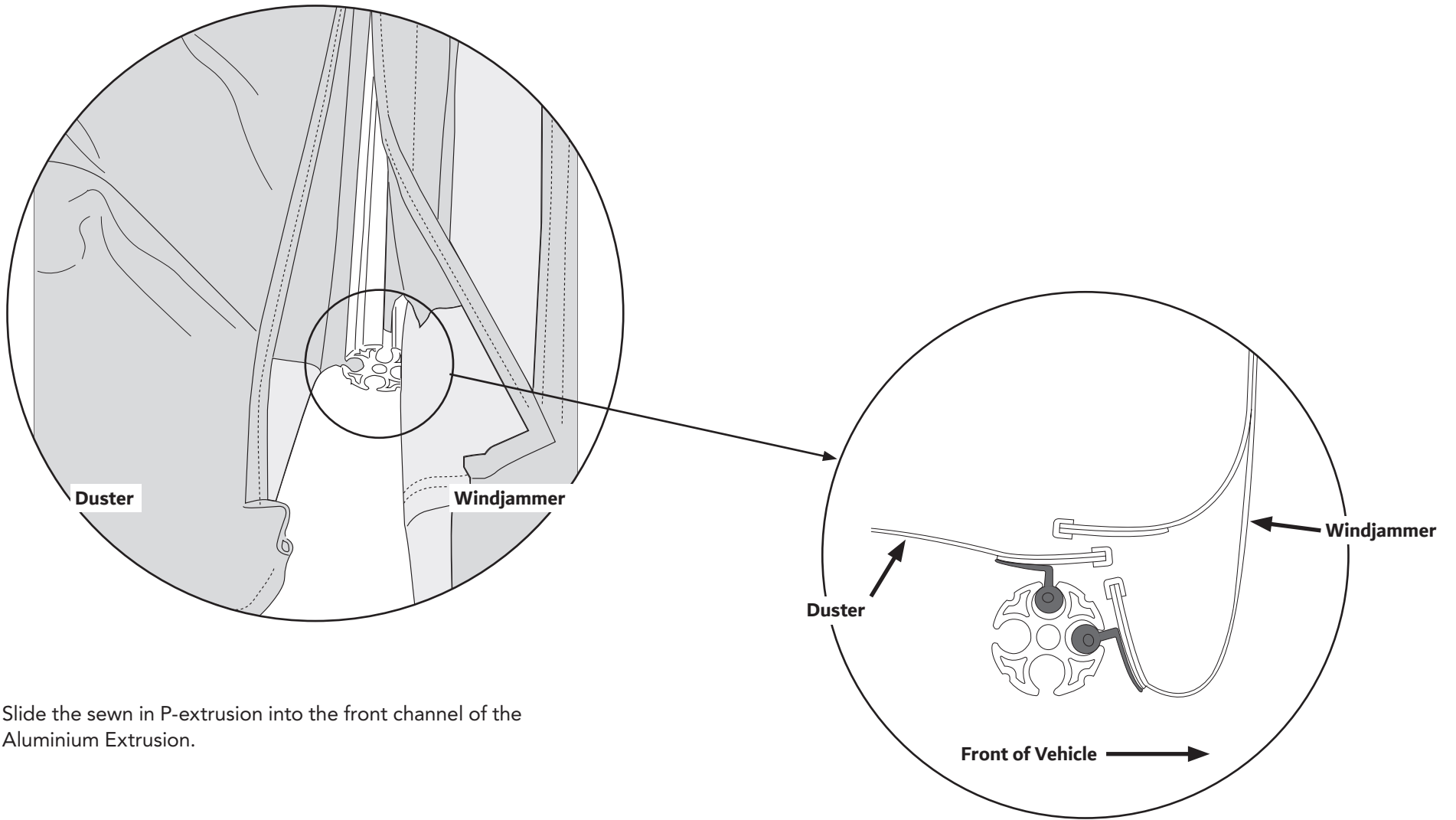

Slide the sewn in P-extrusion into the front channel of the Aluminium Extrusion.

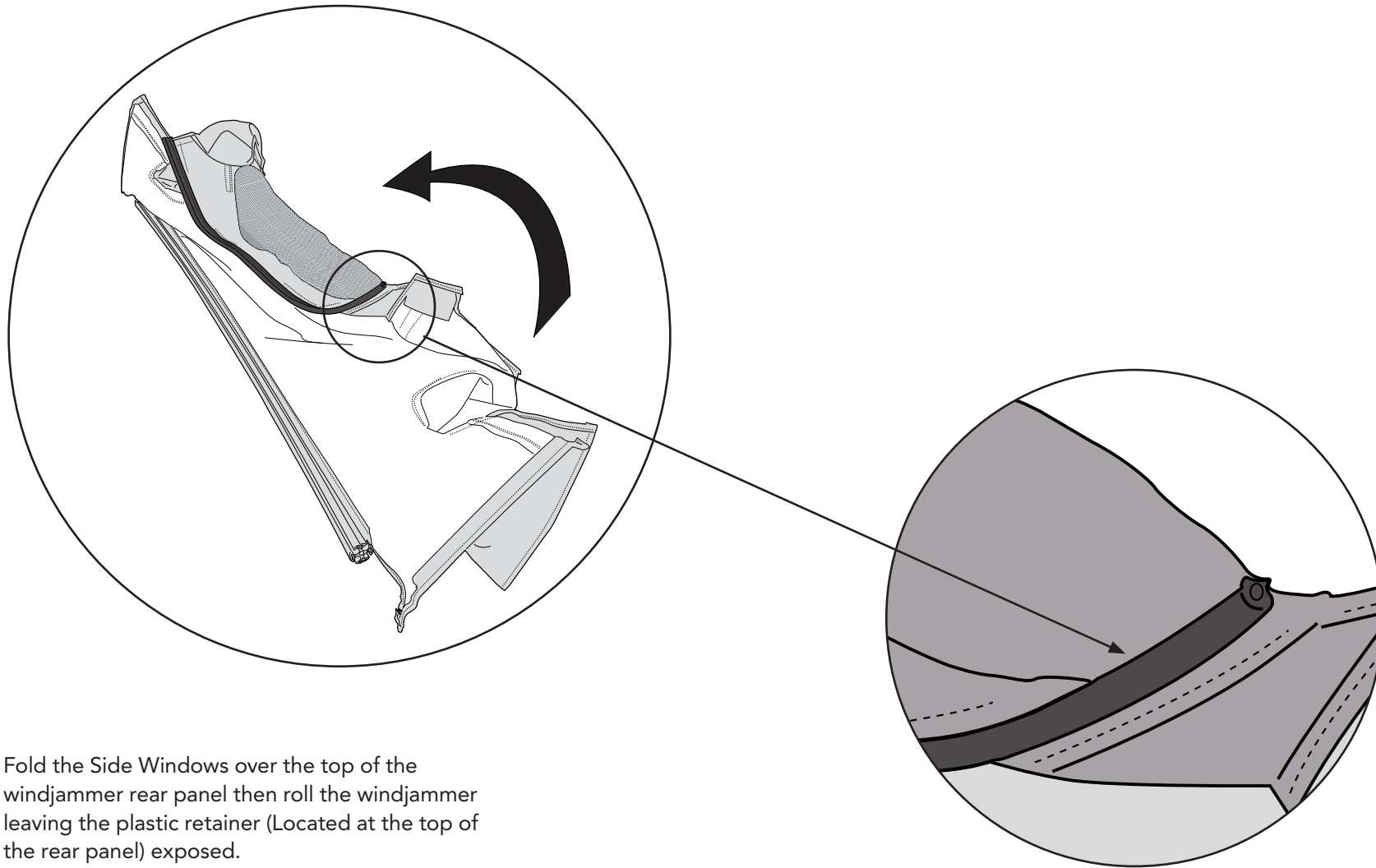

Fold the Side Windows over the top of the windjammer rear panel then roll the windjammer leaving the plastic retainer (Located at the top of the rear panel) exposed.

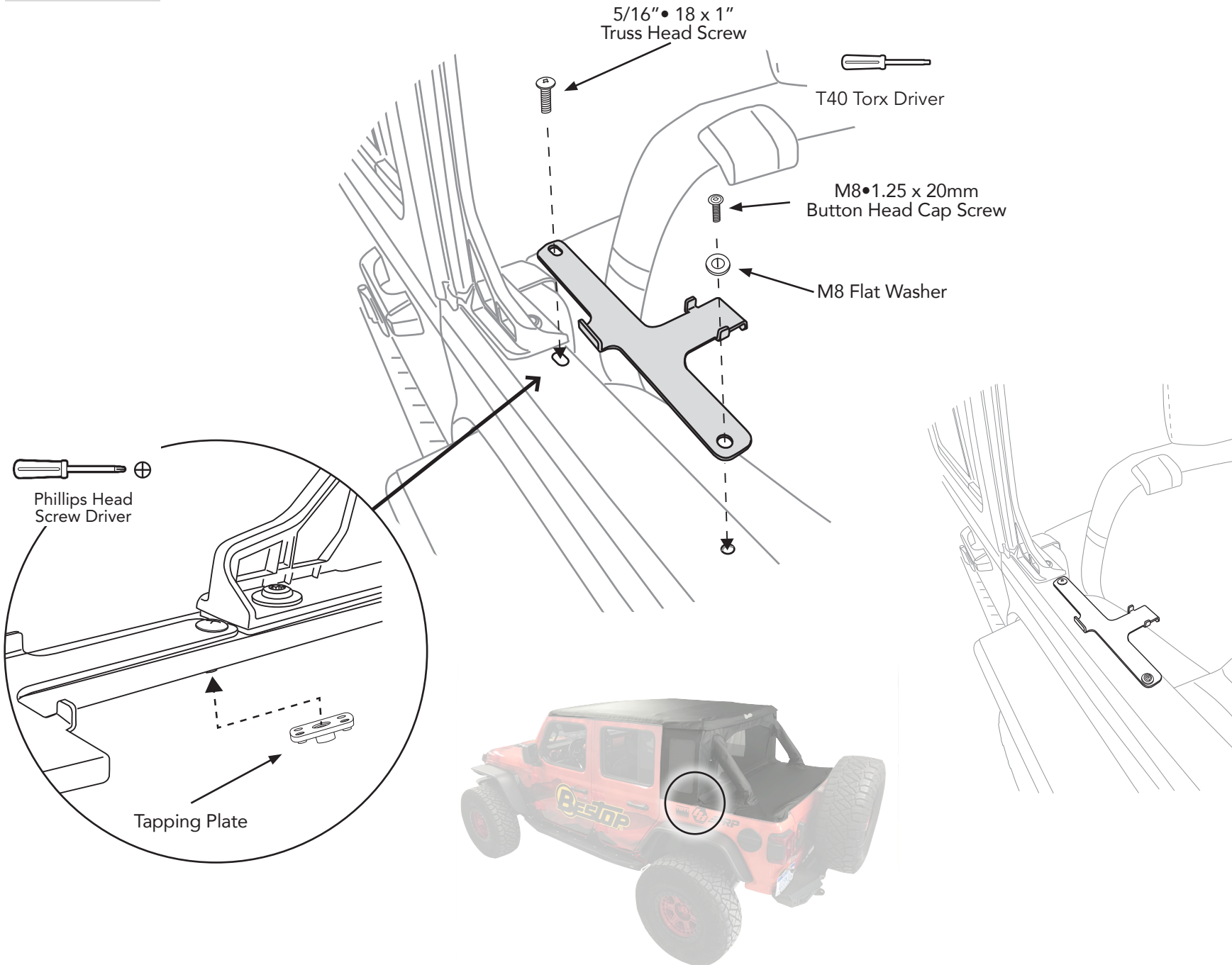

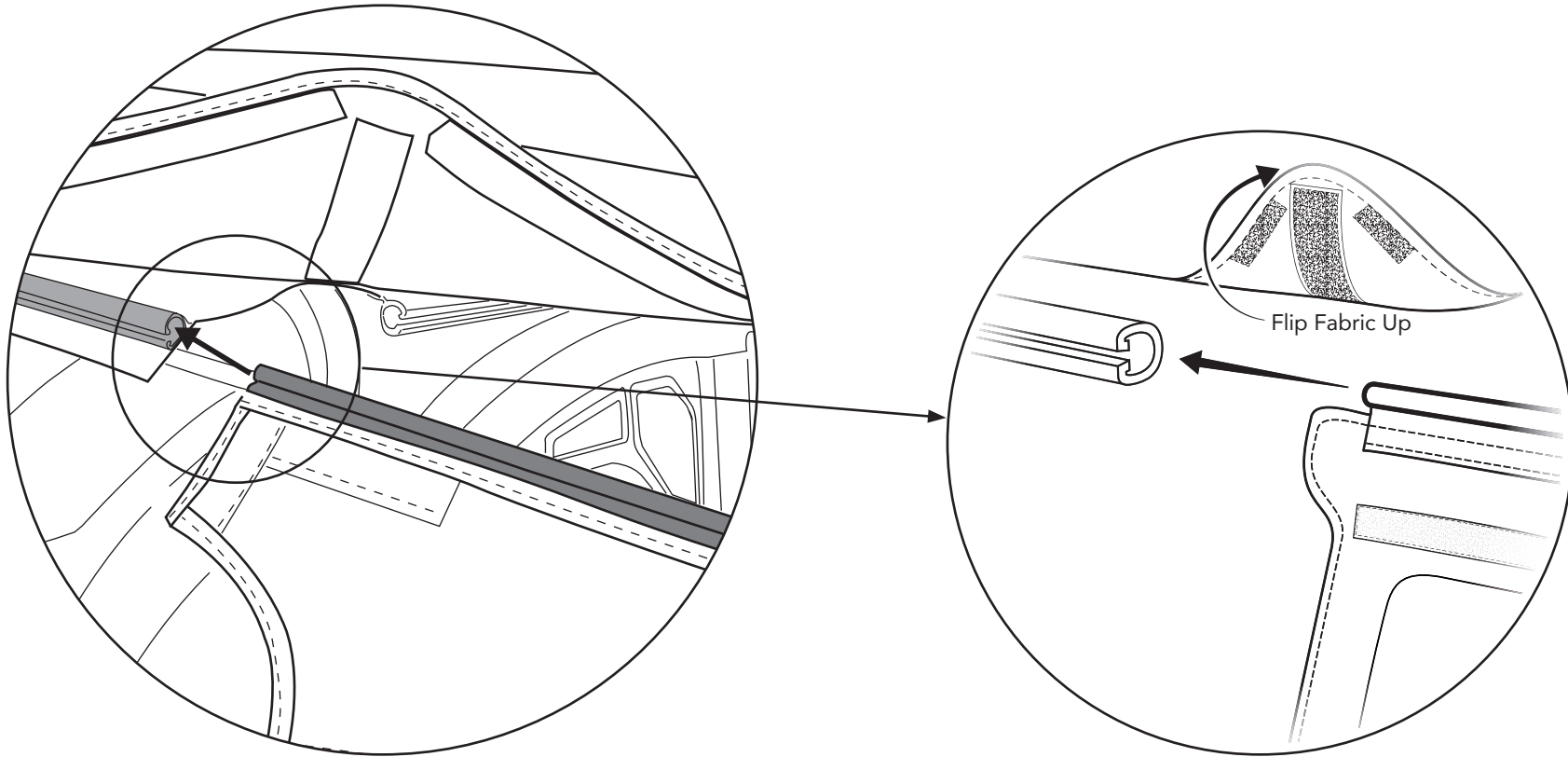

Slide the Rubber Retainer located at the top of the Windjammer into the Plastic "C" channel located at the rear of the Top (Under the rear flap) until the Windjammer is centered on the Top.



Shown without fabric

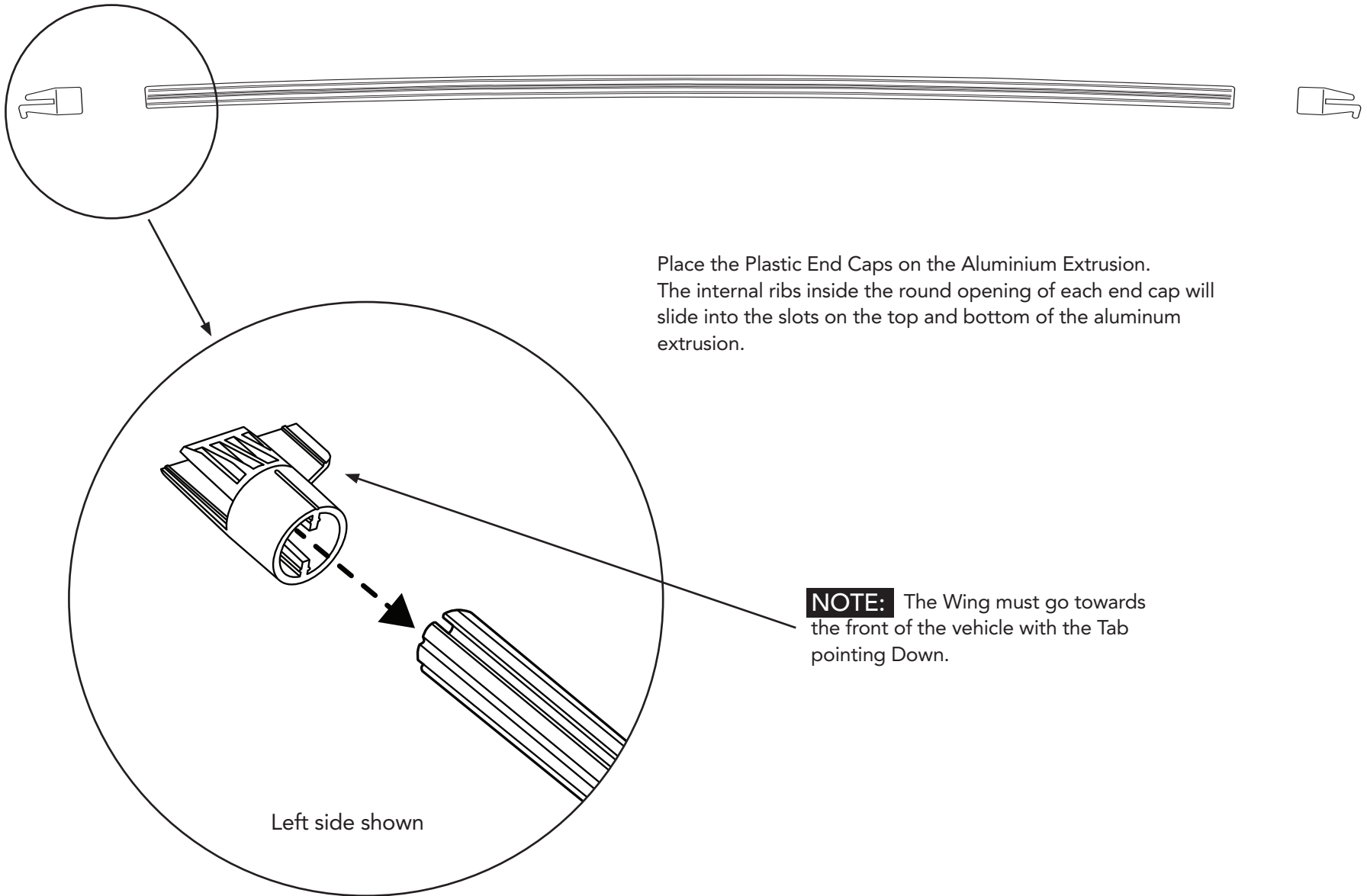

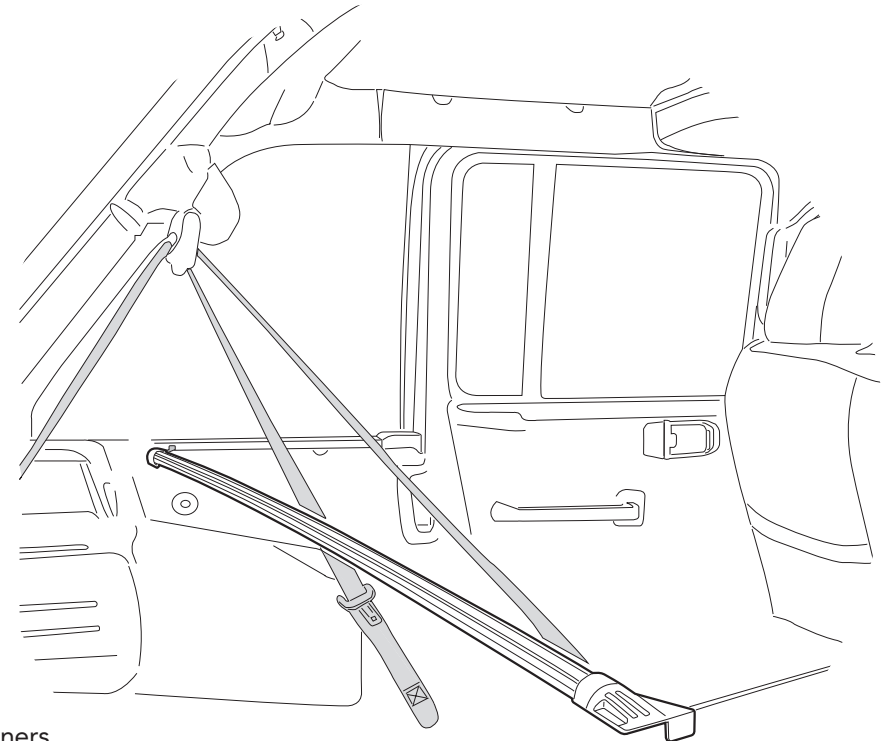
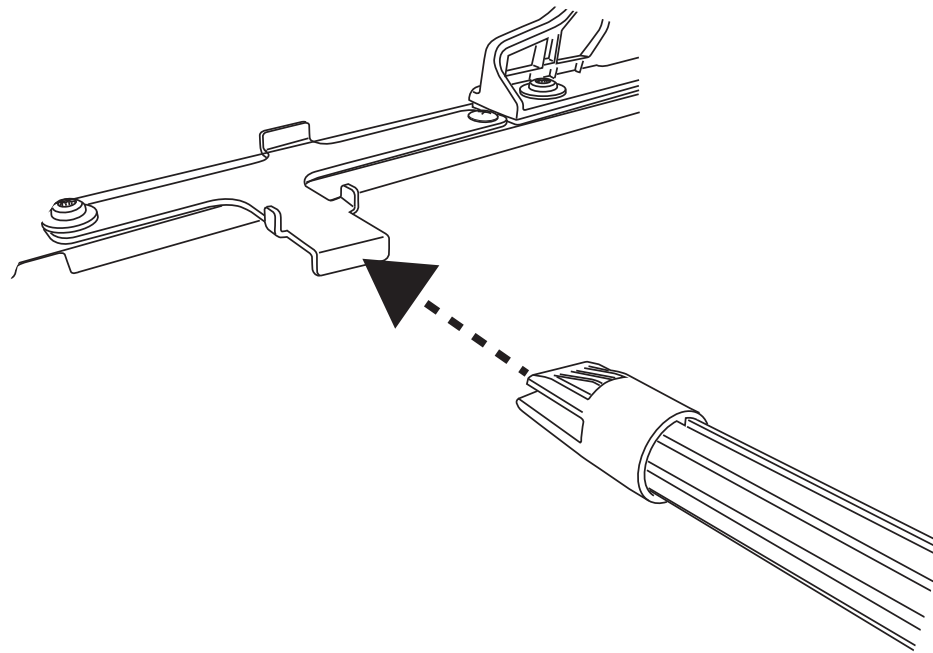

Fold both rear seats forward. (Refer to Owners Manual)
Set End Cap onto the Adapter Bracket on the driver side.

NOTE: You must place the Extrusion and Fabric Assemblies through the Seat Belts to properly install the Duster and the Windjammer.

Fabric not shown for illustration purpose only.

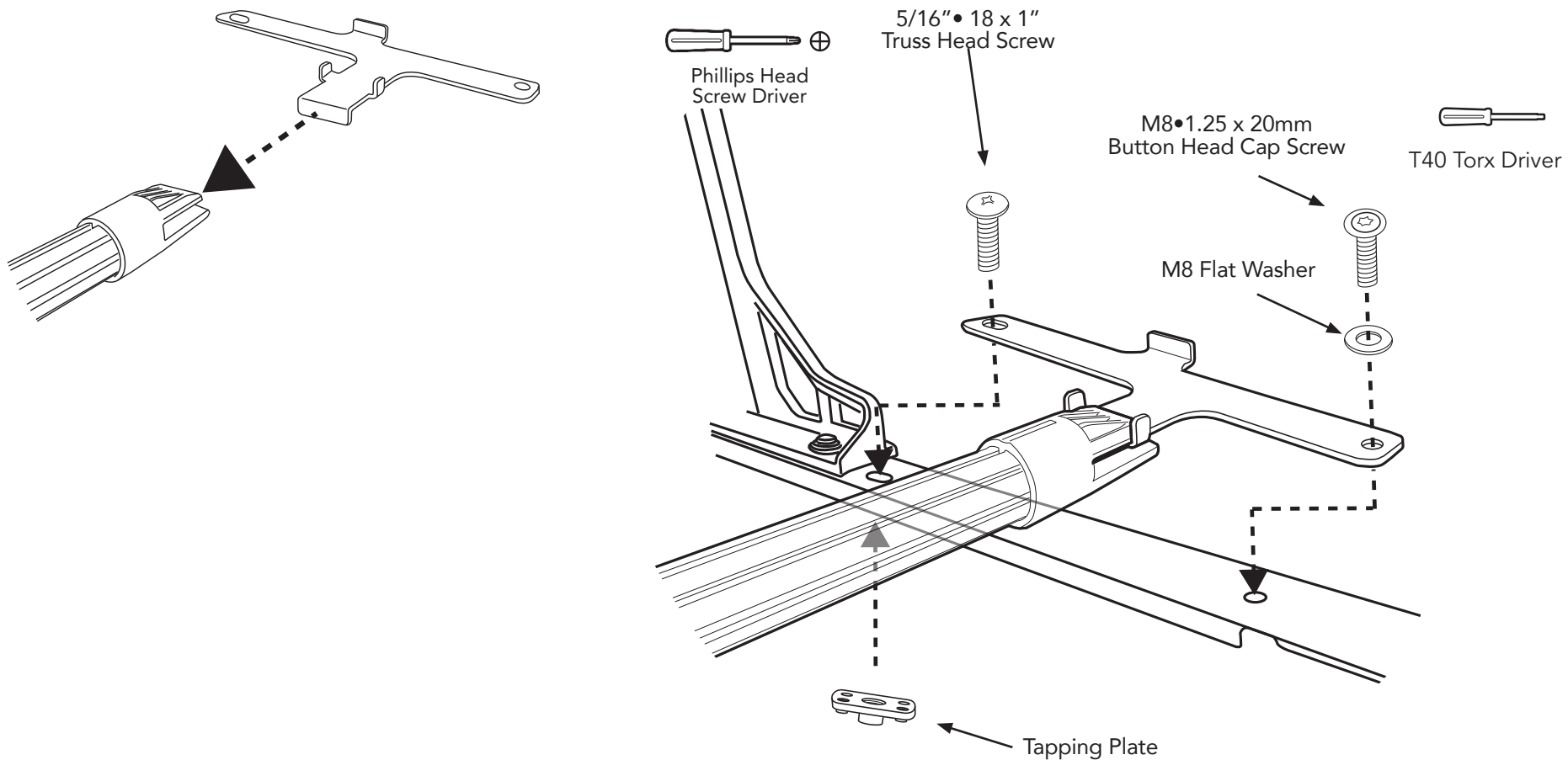

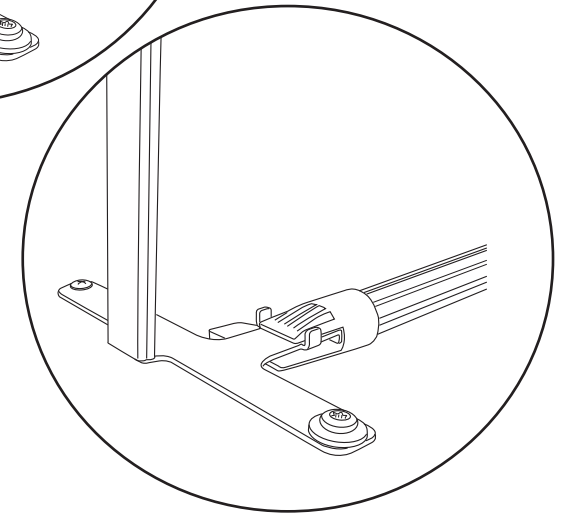
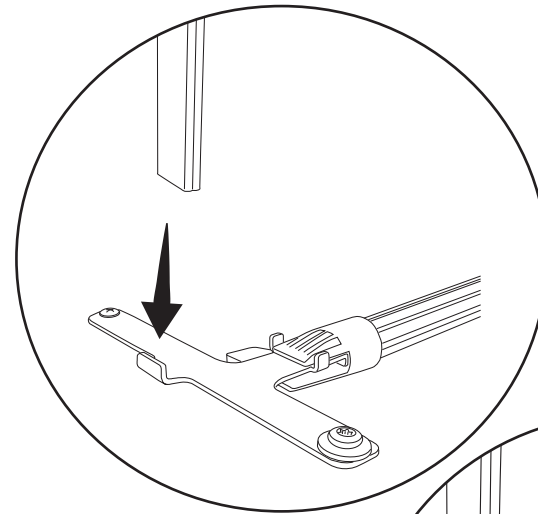
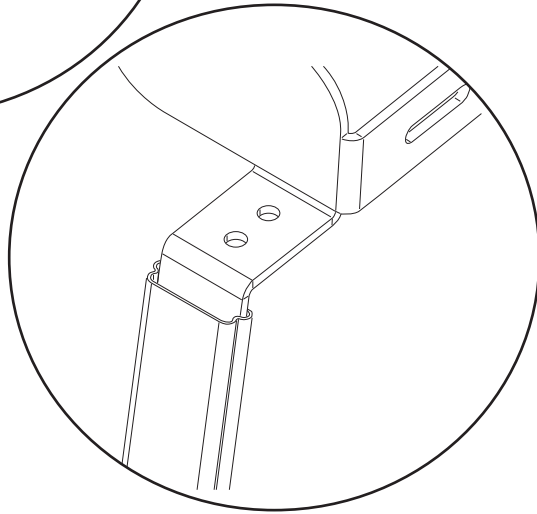
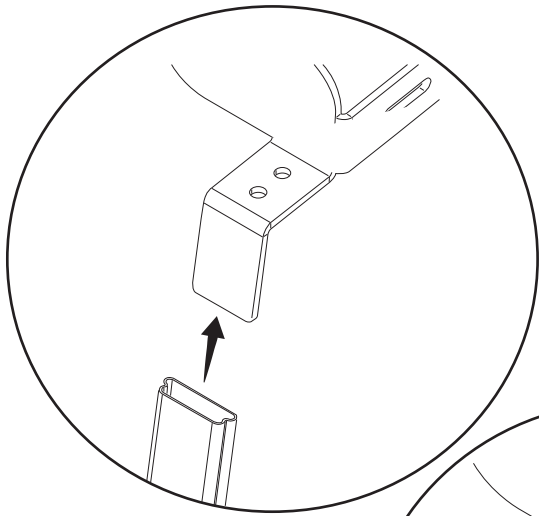

Insert the top of the D Pillar Bow onto the Bow Support Bracket and push it all of the way up.

Align the D Pillar Bow with the tab on the Adapter Bracket then pull the D Pillar bow down onto the tab.

Repeat the steps on the other side of the vehicle.



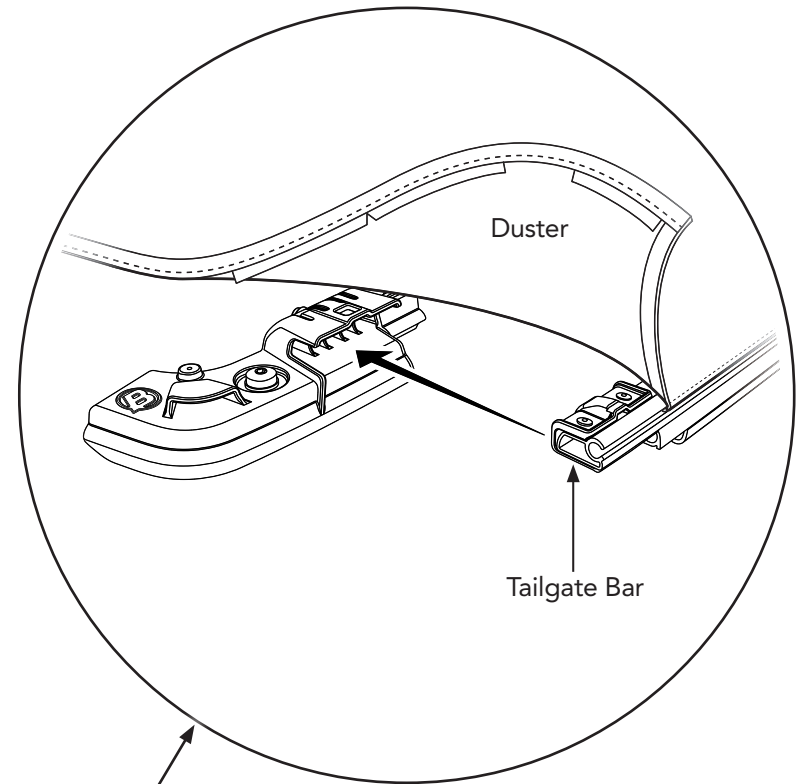
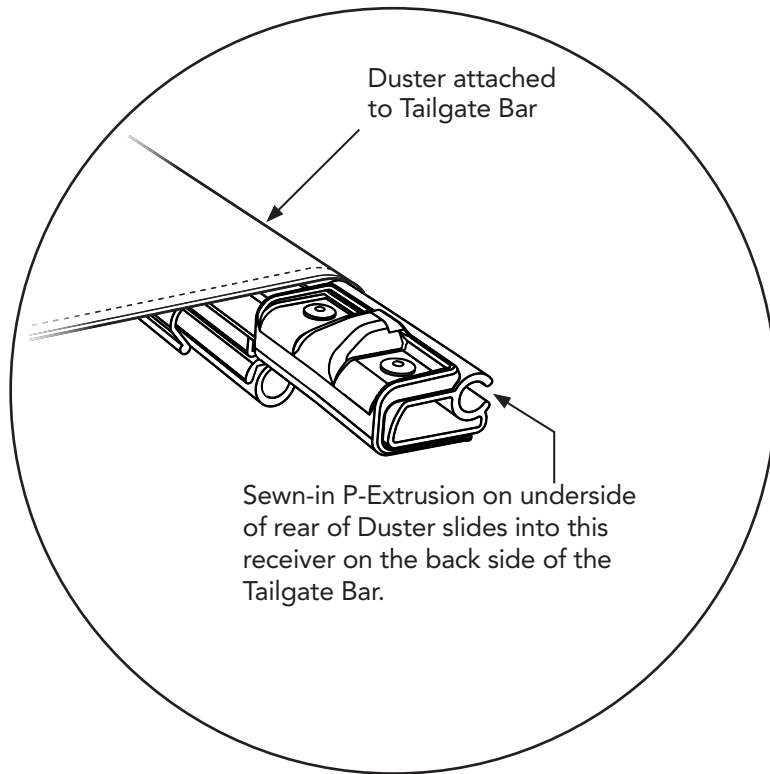

Attach the Tailgate Bar to the sewn-in P-Extrusion rail on the underside of the rear of the Duster.
Slide the Tailgate Bar all the way across.



Secure the Tailgate Bar with attached Duster to the Tailgate Bar Retainers.
Press the Tailgate Bar into the receiver on each Tailgate Bar Retainer.

NOTE: The bulb seal on the Tailgate bar must hang below the bar and face rearward for the tailgate to touch it.

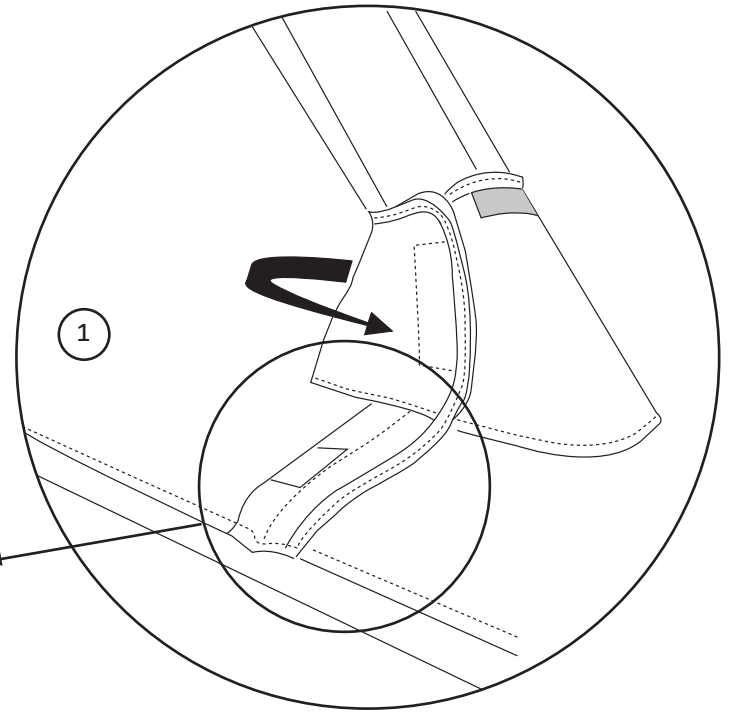
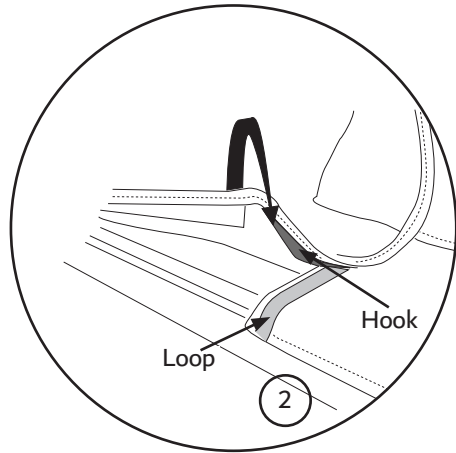
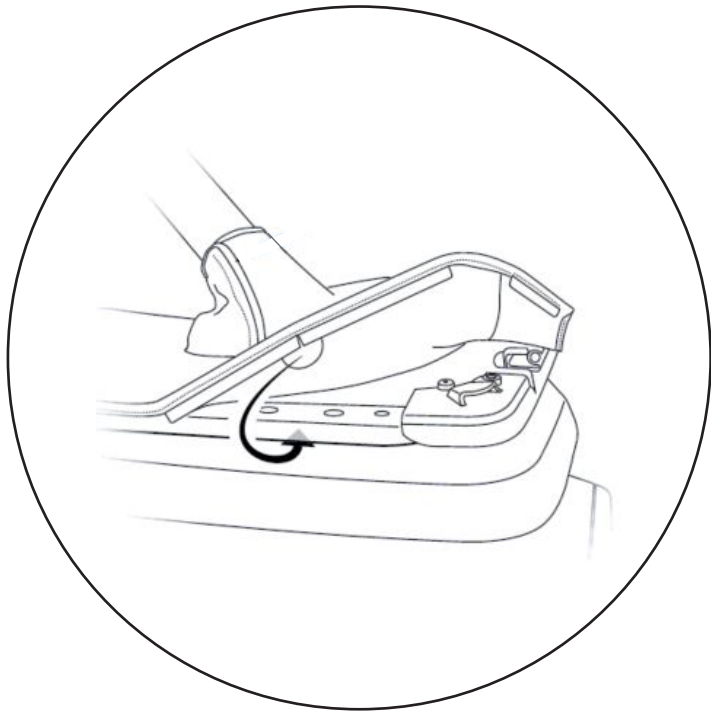

Tuck the plastic tabs along the left and right edges of the Duster underneath the Jeep belt rail, working from back to front.

Make sure to tuck the straight tabs as well as the semi-circular tabs under the belt rail.

Tuck all side plastic tabs under the belt rail, from back to front, and then tuck the plastic tabs at the rear corners under the belt rail.



- 1 Wrap the hook-&-loop sleeves around the sport bar downtubes, and attach hook-&-loop strips together snugly.
- 2 Press the Hook and Loop together along the side of the Duster cover

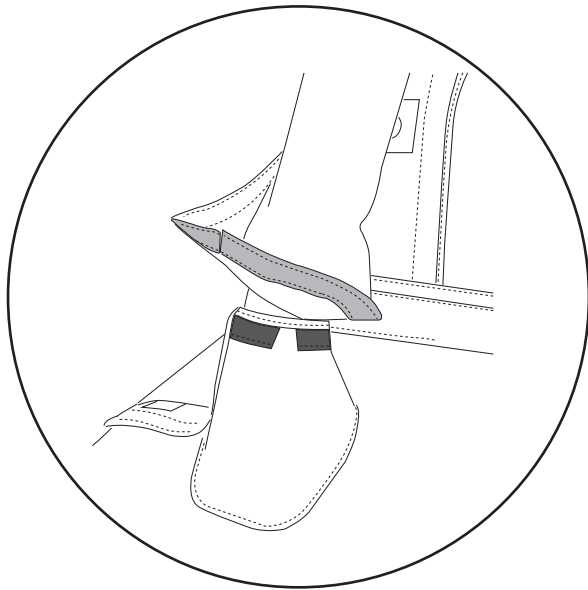

Place the Sport Bar sleeve on the Sport bar Leg then attach the loop on the Sleeve to the Hook on the Duster.

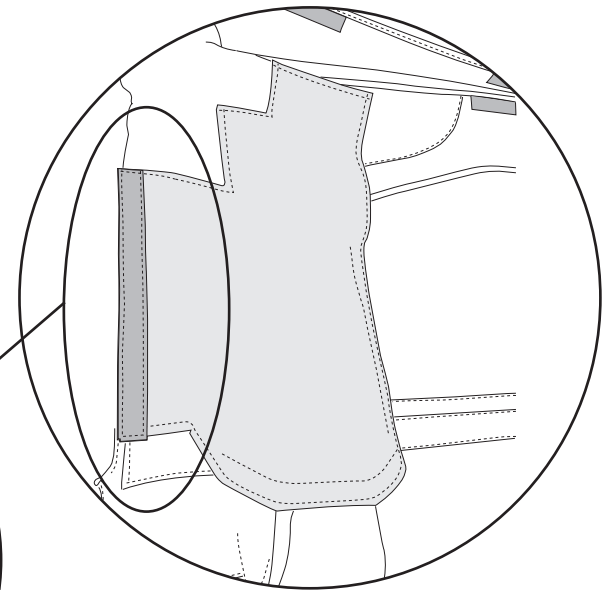
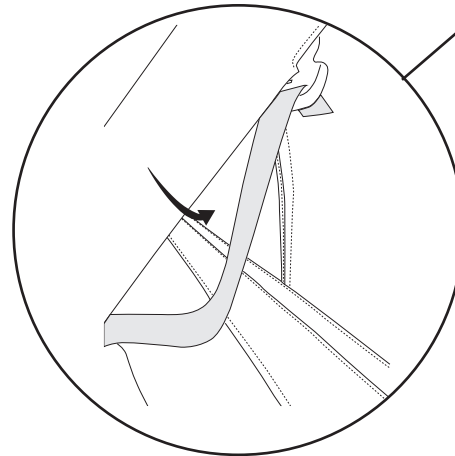

Wrap the flap around the Sport Bar leg between the Sport Bar Leg and the Seat Belt. Repeat this step on the left side of the vehicle.

Caution: Wrapping the flap around the seat belt instead of leaving it loose may cause the seat belt to malfunction and could cause serious injury or Death.



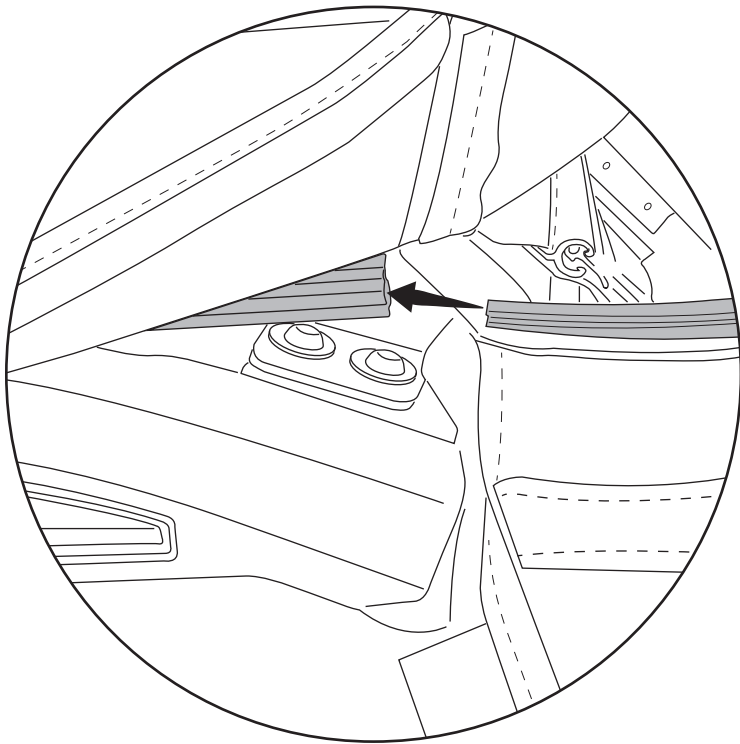

Slide the plastic Retainer located along the top of the side panel into the "C" channel located on the top.

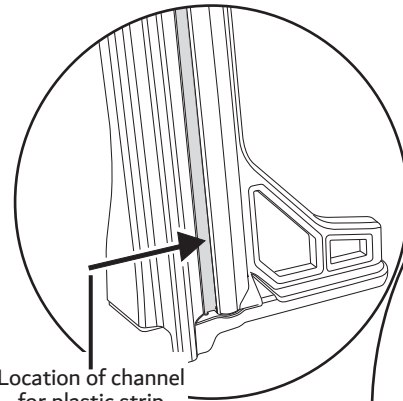

Location of channel for plastic strip

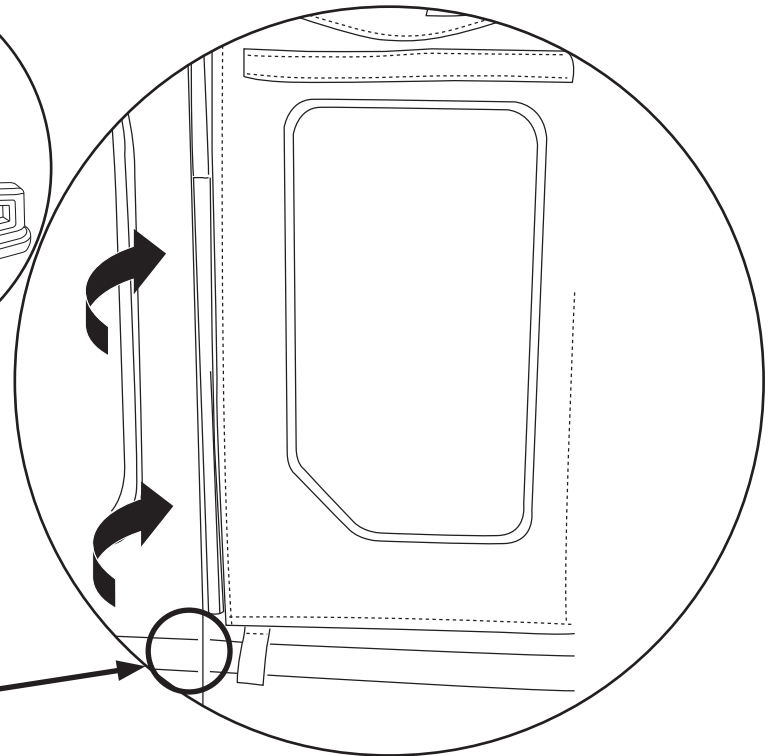

Start at the lower end of the retainer and work your way up.

Locate the sewn-in plastic strip along the front edge of the left side window. Tuck this plastic strip into the vertical channel along the outside face of the left Rear Door Rail. See Detail for location of the correct channel.



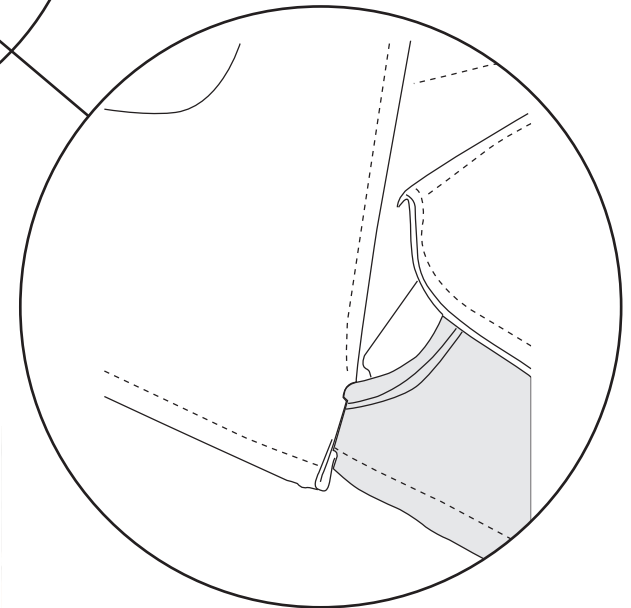
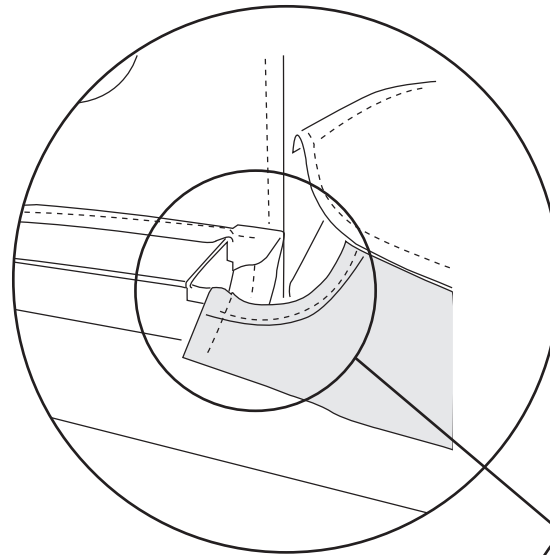
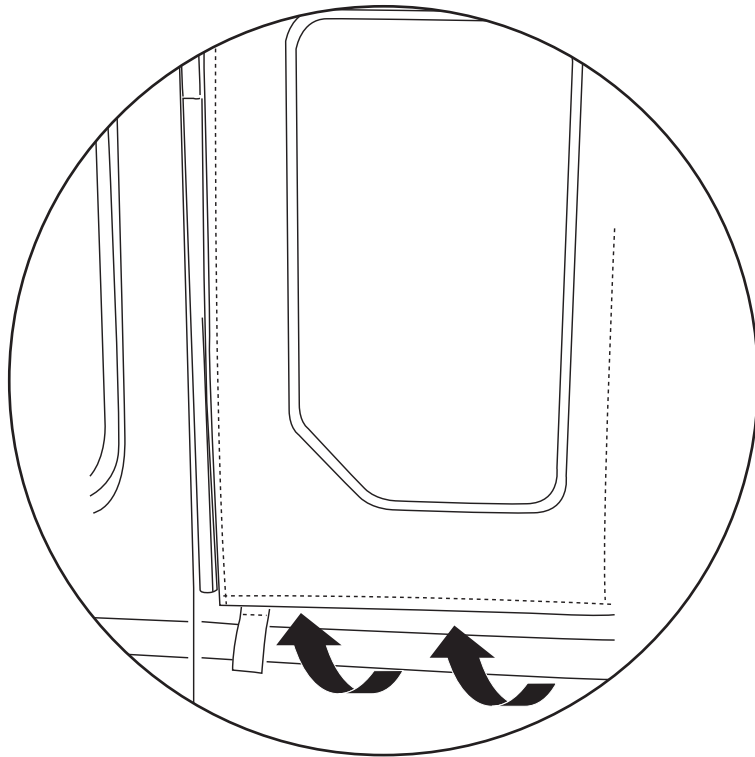

Tuck the plastic strip along the bottom edge of the left rear window under the Jeep belt rail, by rolling it up underneath the belt rail, beginning at the rear, and working your way forward. Make sure you tuck the tab on the front edge of the Duster under the bottom edge of the Side Panel.

Repeat on the right side window.



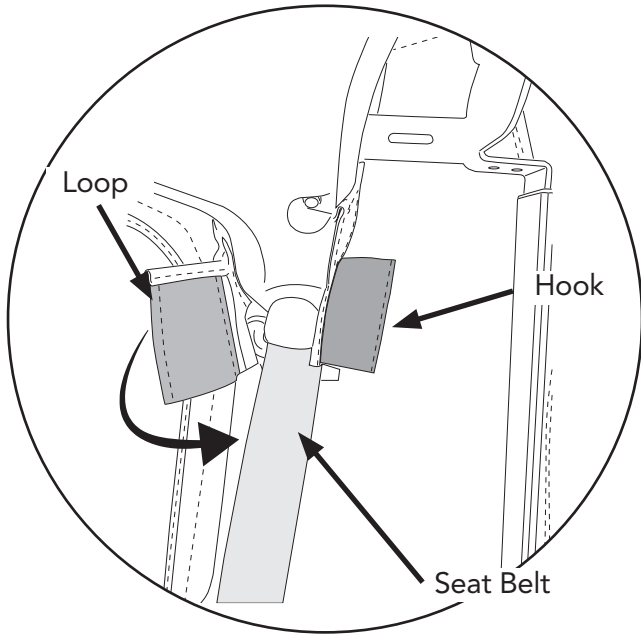

View from inside of the vehicle

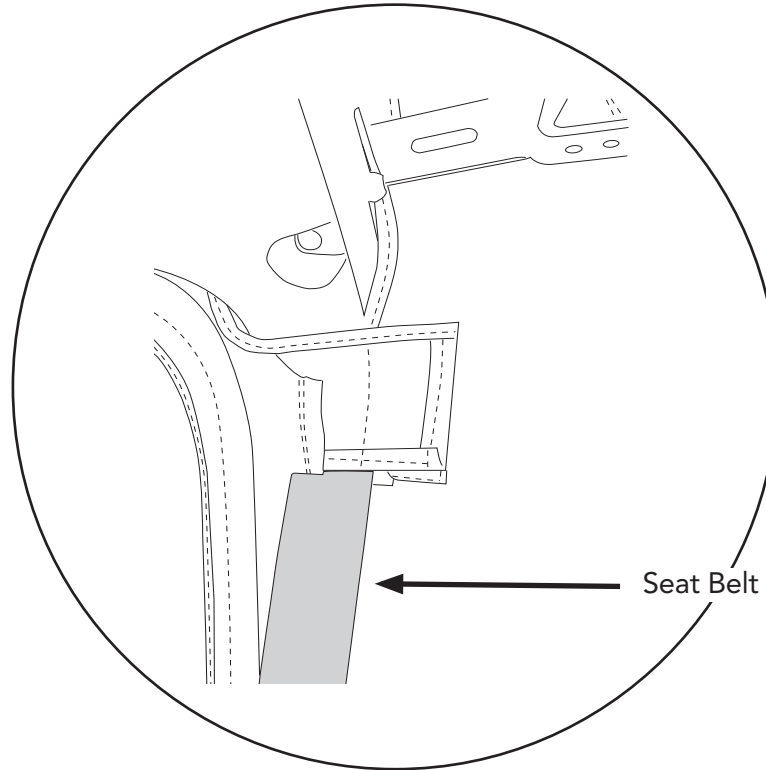

From the inside, Fold the Loop patch over and onto the Hook patch.

Repeat on the left side of the vehicle.



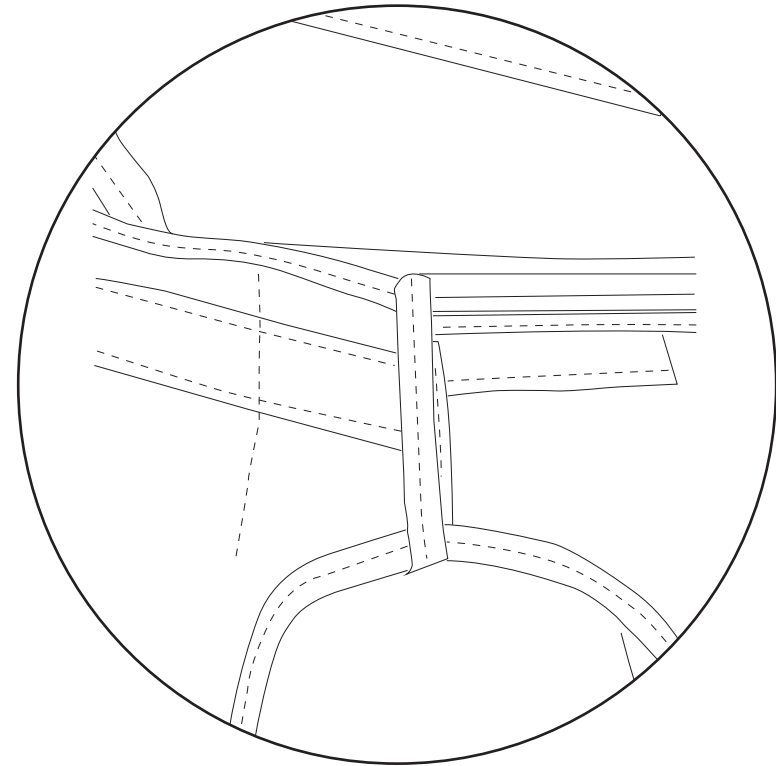
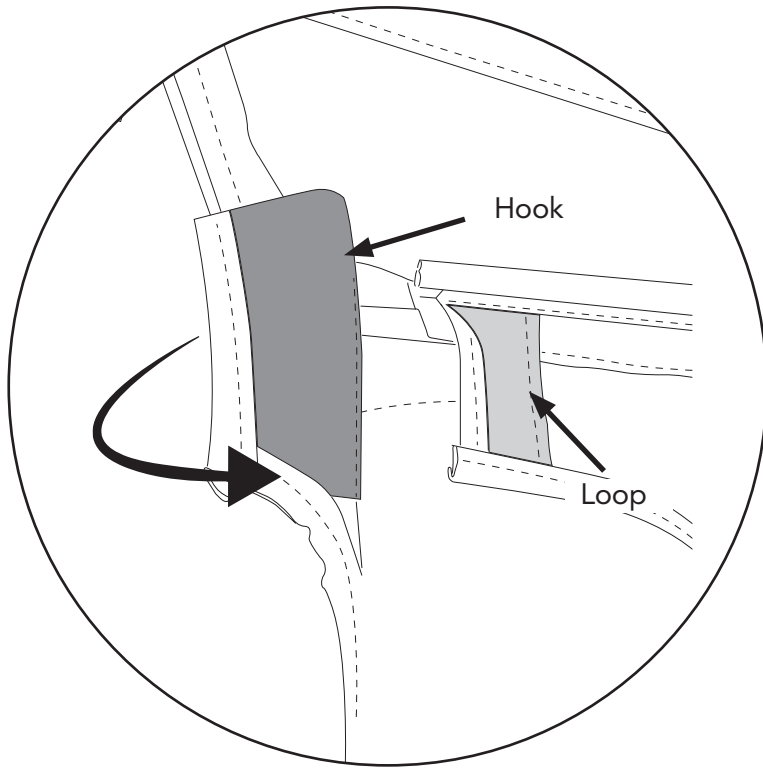

Fold the flap with the Hook over the flap that has the Loop Sewn on.

Note: Make sure you wrap flaps around the Sportbar Sleeves.



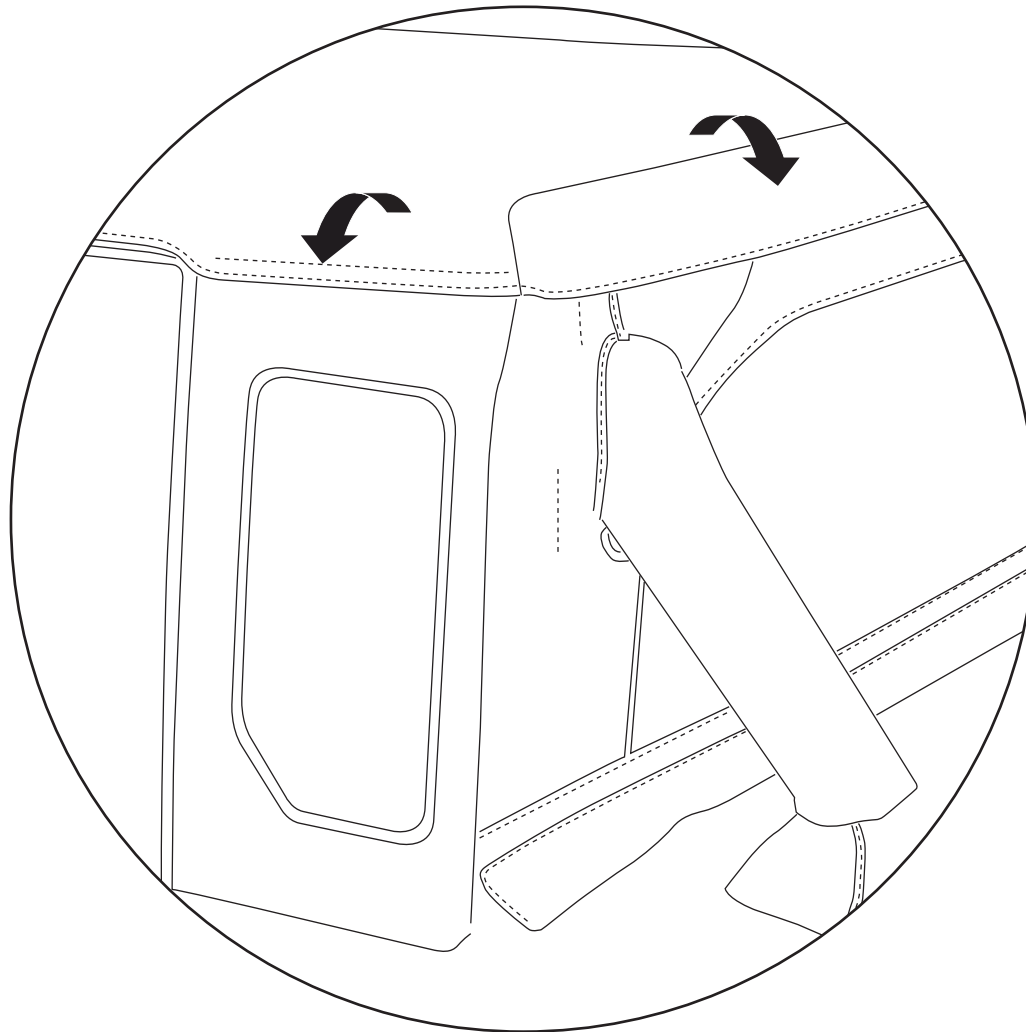

Secure the Hook and Loop along the rear edge of the Top to the top edge of the Windjammer.

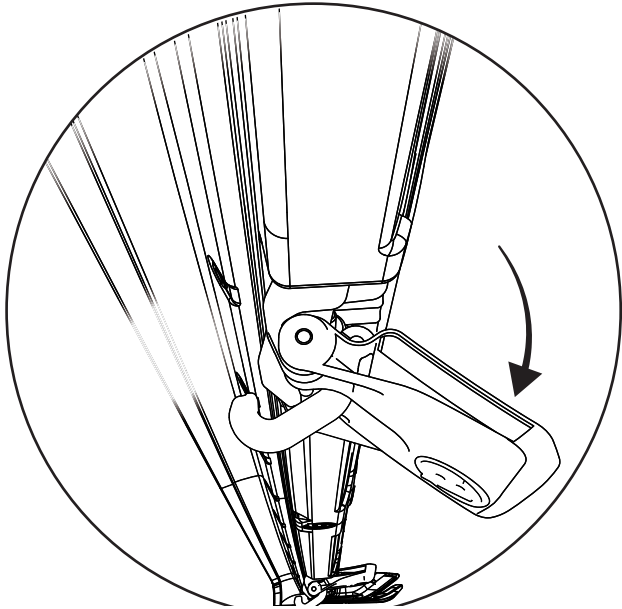

Fold the Sunrider closed and secure both latches to the vehicle's windshield header.

Pivot the latch handle down.

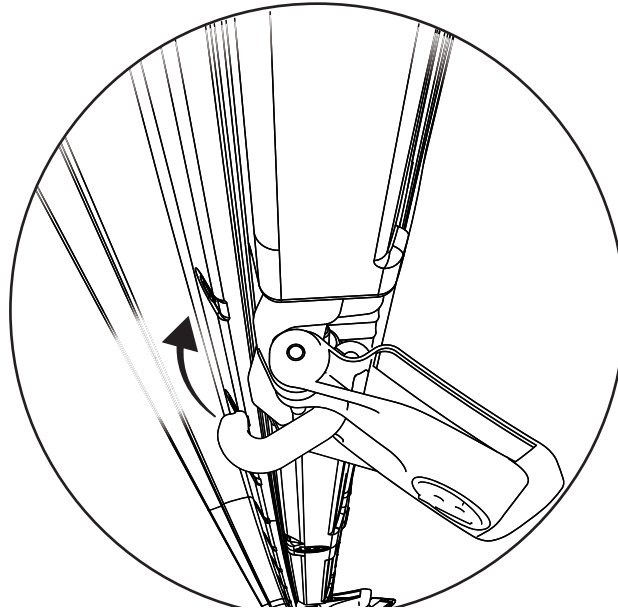

Engage the hook.

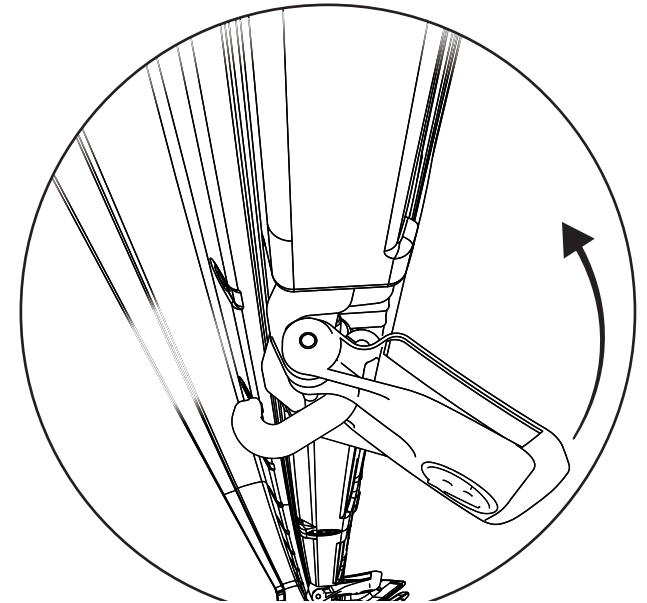

Pivot the latch handle back up.



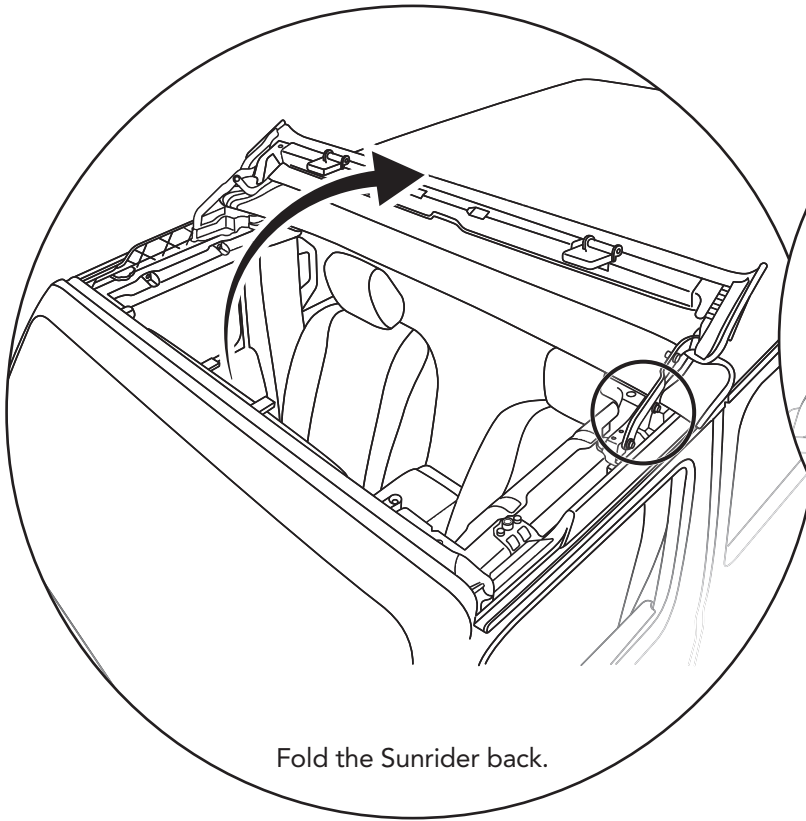

Fold the Sunrider back.

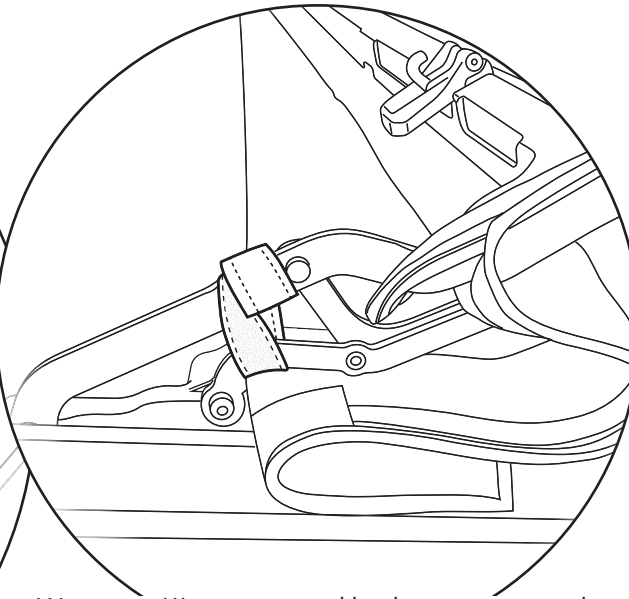

Wrap one (1) strap around both arms once and around the upper arm once, and secure the hook-and-loop strap.

Repeat on the other side of the vehicle.





Care and Maintenance of your Bestop Product

Your Bestop product is made of the finest materials available. To keep it looking new and for the maximum possible wear, it will need periodic cleaning and maintenance.

Fabric: The fabric should be washed often using soap, warm water and a soft bristle brush. Rinse with clear water to remove all traces of soap. Bestop recommends using Bestop Cleaner (part no. 11201-00) and Bestop Protectant (part no. 11202-00) for Vinyl fabric and Bestop Twill Protectant (part no. 11207-00) for Twill fabric. Bestop Cleaner and Bestop protectant are specially formulated to provide a total cleaning and protection system. Bestop Cleaner safely removes the toughest stains, will not harm vehicle finishes, is biodegradable and environmentally friendly. Bestop Protectant protects against UV-fading, cracking and hardening, and repels dust, grease, dirt and mildew.

Windows: Keep windows clean to avoid scratching. DO NOT use a brush on the windows! Wash with a water-soaked cloth or sponge and a mild dishwashing detergent. Bestop recommends Bestop Vinyl Window Cleaner (part no. 11203-00), which safely cleans and protects vinyl windows and helps prevent UV damage. NEVER WIPE THE WINDOWS WHEN THEY ARE DRY. Be careful when cleaning snow or frost from the vinyl windows since they are easily scratched and may crack at low temperatures. DO NOT roll the sides or rear window in cold weather. The windows become stiff and will crack. Cracks caused by misuse in cold temperatures are not covered under warranty.

Water: Seeping through at the seams may be stopped by applying 3-M Scotchgard® on the inside of the seams.

Snaps: Keep snaps cleaned and lubricated with silicone to help prevent snaps from sticking to the studs. If a snap does become stuck to a stud, use a screwdriver and GENTLY pry apart to prevent permanent damage to the snap or the top fabric.

Zippers: Keeping zippers cleaned and lubricated with Bestop's Zipper Cleaner (part no. 11206-00) will help prevent damage and keep the zippers in smooth working condition. If a zipper opens behind the slider, the slider may have been spread apart. This problem can usually be repaired by using an ordinary pair of pliers to bring the sides back into parallel. Return slider to the end of the zipper in the normal Open position. Squeeze lightly at first and test the zipper. If the zipper continues to remain open squeeze more firmly with the pliers and try the zipper again. Repeat this procedure until the zipper operates correctly.

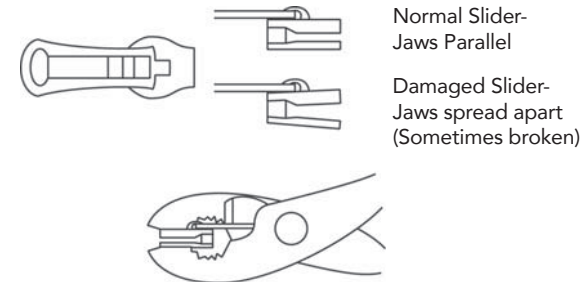

For Bestop Warranty Information, Please go to;
<https://www.bestop.com/help/warranty-information/>

