



Strong As An Ox™

TailGator™



OPERATOR, PARTS AND INSTALLATION MANUAL

SC1200 TailGator™



Strong As An Ox™

PARTS LIST

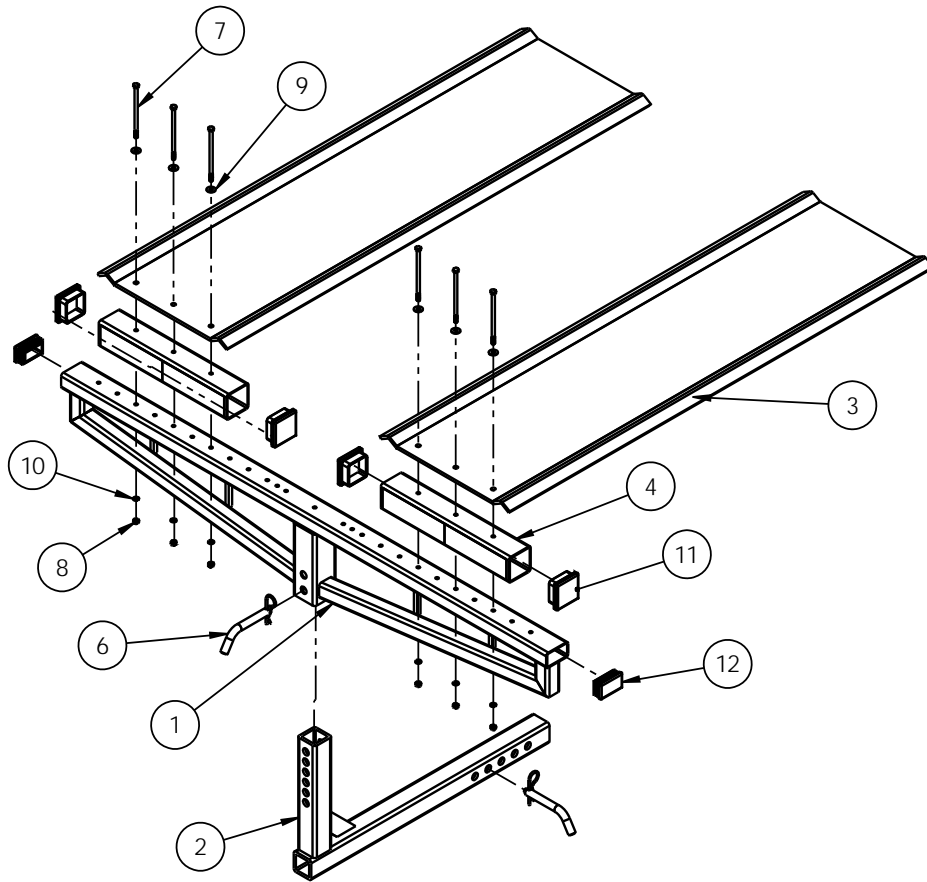

Item No.	Part No.	Description	Qty.
1.....	61-6929.....	SC1200 Support Weldment.....	1
2.....	61-6931.....	SC1200 Receiver Hitch.....	1
3.....	100-1292.....	SC1200 Aluminum Treadplate.....	2
4.....	107-3261.....	17" 2-1/2" x .125 Wall Square Tube.....	2
5.....	192-0035 (not shown).....	7" Red x 7" White Reflective Tape.....	2
6.....	200-1483.....	3" 5/8" Diameter Eff. Pin with Clip.....	2
7.....	201-0896.....	1/4"-20 x 5" Hex Head Bolt, Grade 5, ZP.....	6
8.....	202-0102.....	1/4"-20 Hex Nylon Nut, ZP.....	6
9.....	203-0001.....	1/4" Flat Washer, ZP.....	6
10.....	203-0008.....	1/4" Lock Washer, ZP.....	6
11.....	290-0502.....	2-1/2" Square Black Plastic Cap Plug.....	4
12.....	290-0503.....	Black Plastic Cap Plug.....	2

Important:

Use only genuine factory replacement parts on your TailGator™. Do NOT substitute homemade or non-typical parts. Replacement parts may be ordered through your nearest Blue Ox® Dealer or Distributor, or call our Customer Care Team at 402.385.3051. Failing to follow and/or altering these installation instructions in either installation or required equipment will void the manufacturer's warranty.



Strong As An Ox™

INSTALLATION

DO NOT INSTALL OR USE THIS EQUIPMENT UNTIL THE FOLLOWING OPERATING AND INSTALLATION INSTRUCTIONS HAVE BEEN READ AND UNDERSTOOD.

Congratulations in buying TailGator™ from Blue Ox! TailGator is the ideal product when you want to haul oversized objects in the bed of your truck and need to leave the tailgate down. TailGator is a simple yet durable solution to taking your toys along for the ride without the hassle of hooking up a trailer.



INSTALLING THE CARRIER

1. Remove the TailGator from the box and check the parts with the parts list.
2. Insert the TailGator receiver hitch into the vehicle's receiver, securing it with the 5/8" pin and clip (gray arrow).
3. Slide the TailGator support onto the receiver hitch. Find the appropriate height to make it level with your tailgate and secure with a 5/8" pin and clip (white arrow).
4. Attach tread plates to the TailGator support using 1/4-20 x 5 hex bolts, flat washers, lock washers and hex nylon nut (black arrows).



Strong As An Ox™

LOADING / UNLOADING



NOTE: Ramps sold separately - Model Number SC9023.

LOADING INSTRUCTIONS

1. Park the vehicle on level, hard surface and set the parking brake.
2. Slowly drive the golf cart, ATV or quad up the ramps, making sure the tires are centered on the ramps. Acceleration must be slow and steady, NEVER over accelerate.
3. Secure the cargo with as many tie down straps as needed.

UNLOADING INSTRUCTIONS

1. Park the vehicle on level, hard surface and set the parking brake.
2. To unload, be sure ramps are centered and fastened in place. Then slowly back down the golf cart, ATV or quad using the brake as necessary to control the speed.



Strong As An Ox™

TAILGATOR™ ONE YEAR WARRANTY

Automatic Equipment Manufacturing Company ("Automatic") warrants to the original (first) retail purchaser that this product, manufactured by Automatic, shall be free from defect in material and workmanship under normal use and service for a period of one year from the date of delivery.

During said one-year period, Automatic will repair or replace any parts that have been returned by the original purchaser, to the factory, transportation prepaid, and in Automatic's sole and absolute opinion found to be defective. Limitations on Warranty Coverage:

Coverage under this warranty will be valid only if the customer warranty card is returned by the original purchaser within 30 days of purchase.

Coverage under this warranty will be effective only when a copy of the original invoice, showing date and place of purchase, accompanies any claim for warranty. This warranty is NON TRANSFERABLE.

This limited warranty will not cover, in any way or form, any alleged damages caused by incorrect or improper installation, improper use, modification or neglect of product, failure to properly service and maintain, misuse, act of God, accident or failure of the user to follow guidelines contained in the instructional material provided by Automatic. This warranty does not cover normal wear and tear, paint or rust.

Warrantor assumes no responsibility to the owner for loss of use of product, loss of time, inconvenience or any other damage consequential or otherwise. Including, but not limited to mileage, expense of transporting of product, return shipping expense, mechanics travel time, telephone, road service, towing, and rental during repairs, travel, lodging, loss or damage to personal property or loss of earnings.

REPAIR OR REPLACEMENT AS SET FORTH IN THIS LIMITED WARRANTY IS THE SOLE EXCLUSIVE REMEDY OF THE PURCHASER. AUTOMATIC SHALL NOT BE LIABLE FOR ANY INCIDENTAL OR CONSEQUENTIAL DAMAGES FOR BREACH OF ANY EXPRESS OR IMPLIED WARRANTY ON THIS PRODUCT. EXCEPT TO THE EXTENT PROHIBITED BY APPLICABLE LAW, ANY IMPLIED WARRANTY OF MERCHANTABILITY OR FITNESS FOR A PARTICULAR PURPOSE ON THIS PRODUCT IS LIMITED IN LENGTH TO THE DURATION OF THIS WARRANTY.

Some states do NOT allow the exclusion of incidental or consequential damages, or allow limitations on how long an implied warranty lasts, so previous limitations or exclusions may NOT apply to you. This warranty gives you specific legal rights and you may also have other rights which vary from state to state.

Automatic reserves the right to make changes or add improvements to its product at anytime without any obligation to make such changes to previously manufactured equipment. No liability is assumed for bodily injury that may be inflicted on the purchaser, operator, spectator or general public who is in the general area while this equipment is in use.

IMPORTANT

Coverage and performance under the foregoing limited warranty is conditioned upon the first retail purchase completing and returning the customer registration card to Automatic or registering via visible on the product and unaltered.

Automatic will not honor any warranty claims unless the warranty registration card is on file at Automatic's factory in Pender, Nebraska. Some states do not allow exclusions or limitations of warranty coverage based on the return of the registration card to the manufacturer, so the above limitations and exclusions may not apply to you.

Blue Ox Division
Automatic Equipment Mfg. Co.
P.O. Box 430
Pender, Nebraska 68047
(402) 385-3051
www.blueox.com



Strong As An Ox™

**To find the Blue Ox dealer nearest you,
visit www.blueox.com or call 402-385-3051.**

Serial Number

Customer Service Commitment

Blue Ox is committed to providing you with exceptional customer care throughout your lifetime with our products. Our team is here to assist you with any questions you may have regarding the performance of your product. Simply call (402) 385-3051 and you can speak with our customer care team.

Additionally, please visit our website to see which rallies our Destination America team will be attending. For a nominal fee, our service technician will service your towing system to ensure it's in proper working condition. Also, as a commitment to our customers, should you visit our factory, you can stay at our full service Blue Ox campground at no charge along with enjoying a factory tour.

Again, thank you for being our customer and for the confidence you have shown in the performance of our products. It is because of customers like you we enjoy the success we have today.