

**11106****01-04 FORD ESCAPE, MAZDA TRIBUTE**

11/19/2012

GROSS LOAD CAPACITY WHEN USED AS A WEIGHT CARRYING HITCH: 2000 LBS. TRAILER WEIGHT &amp; 200 LBS. TONGUE WEIGHT.

**\*\*\*DO NOT EXCEED VEHICLE MANUFACTURER'S RECOMMENDED TOWING CAPACITY.\*\*\***

WARNING: ALL NON-TRAILER LOADS APPLIED TO THIS PRODUCT MUST BE SUPPORTED BY 18050 STABILIZING STRAPS.

**\*\* FAILURE TO PROPERLY SUPPORT NON-TRAILER LOADS WILL VOID PRODUCT WARRANTY\*\***

HAVING INSTALLATION QUESTIONS? CALL TECHNICAL SUPPORT AT 1-800-798-0813

Parts List			
ITEM	QTY	PART NUMBER	DESCRIPTION
1	1	3_8 - 16 x 1.00 x 1.88	U-BOLT
2	4	3/8"	WASHER
3	2	3/8-16	HEX FLANGE NUT
4	4	7/16 - 14 x 3"	Hex Bolt
5	4	7/16 WASHER	WASHER
6	4	7/16-14	HEX FLANGE NUT

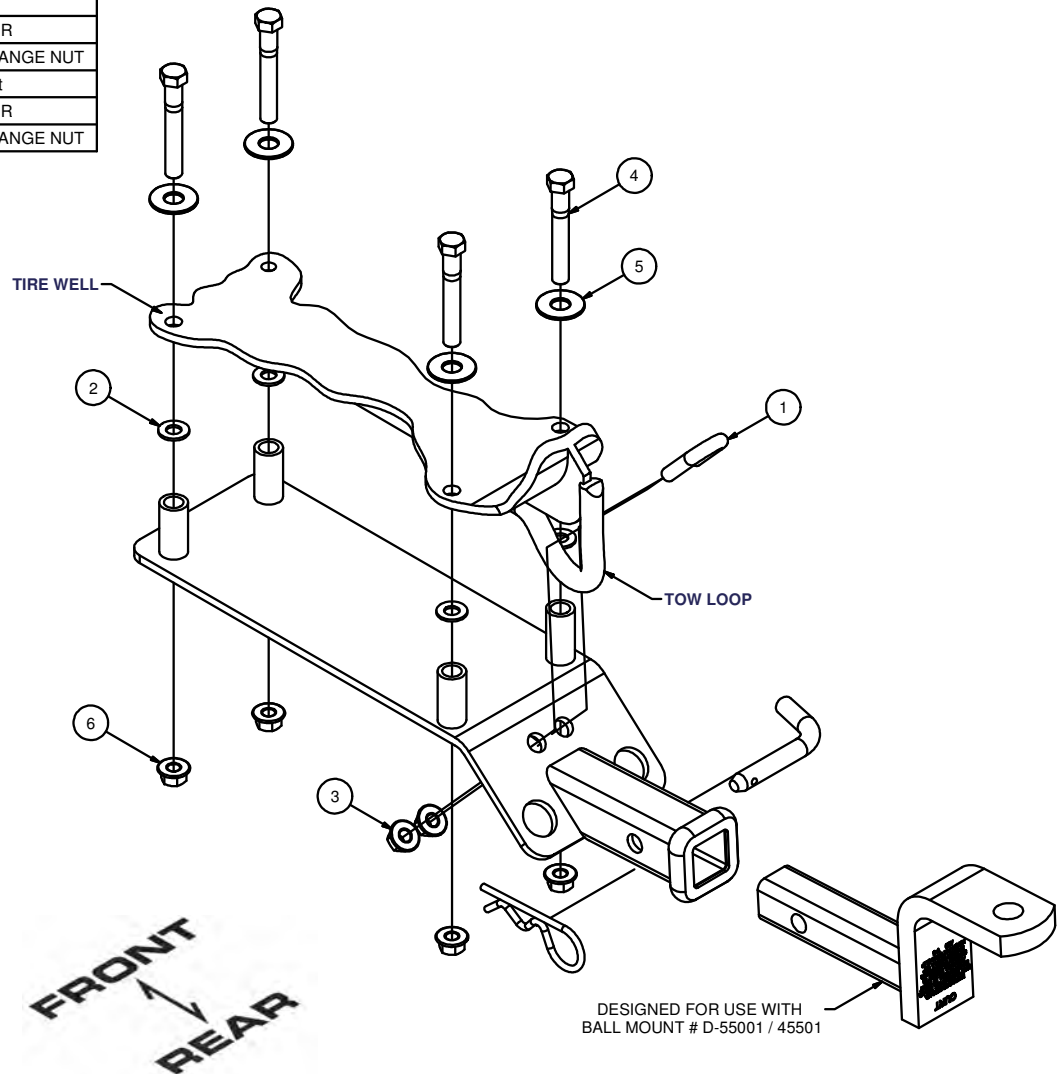

HITCH WEIGHT: .32 LBS.

**INSTALL TIME**

PROFESSIONAL: .30 MINUTES

NOVICE (DIY): .60 MINUTES

**INSTALL NOTES:****DRILLING REQUIRED****INSTALLATION STEPS**

1. Remove spare tire and other equipment from inside of trunk for drilling. Position and support hitch as shown in diagram against forward edge of vehicle tow loop. Install U-bolt through tow loop and hitch. With hitch centered on vehicle rib, drill through the tubular spacers on the hitch into trunk.
2. Install fasteners as shown. Make certain to use flat washers as shown with smaller 3/8" washers between outside of trunk and hitch tubular spacers.
3. Torque 3/8" u-bolt to 45 lb-ft and 7/16" fasteners to 70 lb.-ft. Do not use impact wrench on U-bolt.

**PERIODICALLY CHECK THIS RECEIVER HITCH TO ENSURE THAT ALL FASTENERS ARE TIGHT AND THAT ALL STRUCTURAL COMPONENTS ARE SOUND.**

Curt Manufacturing Inc., warrants this product to be free of defects in material and/or workmanship at the time of retail purchase by the original purchaser. If the product is found to be defective, Curt Manufacturing Inc., may repair or replace the product, at their option, when the product is returned, prepaid, with proof of purchase. Alteration to, misuse of, or improper installation of this product voids the warranty. Curt Manufacturing Inc.'s liability is limited to repair or replacement of products found to be defective, and specifically excludes liability for incidental or consequential loss or damage.