



11364 INSTALLATION INSTRUCTIONS



Safety glasses should be worn at all times while installing this product.

YEARS: 2014

MAKE: FIAT

MODEL: 500L

STYLE: HATCHBACK

WARNING: NEVER EXCEED YOUR VEHICLE MANUFACTURER'S RECOMMENDED TOWING CAPACITY

WEIGHT CARRYING:

TRAILER WEIGHT: 2,000 LBS.
TONGUE WEIGHT: 200 LBS.

WARNING:

WE RECOMMEND THE USE OF 18050 STABILIZING STRAPS FOR ALL NON-TRAILER (WHEEL-LESS) LOADS. PLEASE SEE THE CURT CATALOG OR VISIT US ONLINE AT WWW.CURTMFG.COM FOR FURTHER INFORMATION.

PRO INSTALL TIME: 45 MIN.

NOVICE INSTALL TIME: 90 MIN.

IF YOU ARE HESITANT TO UNDERTAKE THIS TASK ON YOUR OWN, CONTACT AN AUTHORIZED CURT INSTALLER FOR ADDITIONAL ASSISTANCE.

INSTALLATION TIPS:

1. BEFORE YOU BEGIN INSTALLATION, READ ALL INSTRUCTIONS THOROUGHLY.
2. TO EASE INSTALLATION, 2 PEOPLE MAY BE REQUIRED.
3. USING PROPER TOOLS WILL GREATLY IMPROVE THE QUALITY OF THE INSTALL AND REDUCE THE TIME REQUIRED.
4. NEED HELP OR HAVE SOME QUESTIONS? CALL TECHNICAL SUPPORT AT 800.798.0813

LEVEL OF DIFFICULTY: CHALLENGING

EASY

MODERATE

CHALLENGING

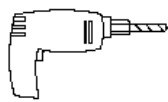

DRILLING REQUIRED

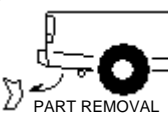

TEMPORARY PART REMOVAL

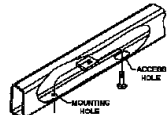

FISHWIRING REQUIRED



FASCIA TRIMMING

VEHICLE PHOTO:



REPRESENTATIVE PHOTO

HITCH ILLUSTRATION:

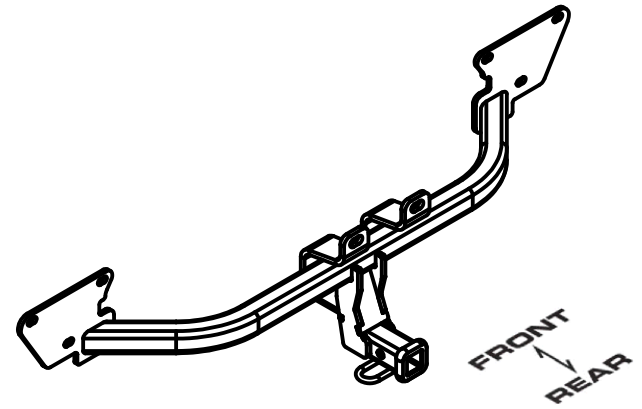

MAKE SURE YOUR HITCH MATCHES

INSTALLATION REQUIRES:



SAFETY GLASSES



SCREW DRIVER



T30 TORXBIT SOCKET



RATCHET



13mm
11mm

SOCKET



9"

SOCKET EXTENSION



POWER DRILL



DRILL BIT
13/64



TAPE MEASURE



MASKING TAPE



AVIATION SHEARS
CUT-OFF WHEEL

PERIODICALLY CHECK THIS RECEIVER HITCH TO ENSURE ALL FASTENERS ARE TIGHT AND ALL STRUCTURAL COMPONENTS ARE SOUND

CURT Manufacturing LLC. warrants this product to be free of defects in material and/or workmanship at the time of retail purchase by the original purchaser. If the product is found to be defective, Curt Manufacturing LLC. may repair or replace the product at their option, when the product is returned, prepaid, with proof of purchase. Alteration to, misuse of, or improper installation of this product voids the warranty. Curt Manufacturing LLC.'s liability is limited to repair or replacement of products found to be defective, and specifically excludes liability for incidental or consequential loss or damage.

For more information log onto www.curtmfg.com, & for helpful towing tips log onto www.hitchinfo.com

6/26/2014

INSTALLATION WALKTHROUGH:

Parts List			
ITEM	QTY	PART NUMBER	DESCRIPTION
1	2	1/2-13 x 1 1/2, GR8	CARRIAGE BOLT
2	2	HFN 1213, GR8	HEX FLANGE NUT
3	2	1_2 FISHWIRE	1/2" FISHWIRE
4	2	11364-SP	.250" PLATE

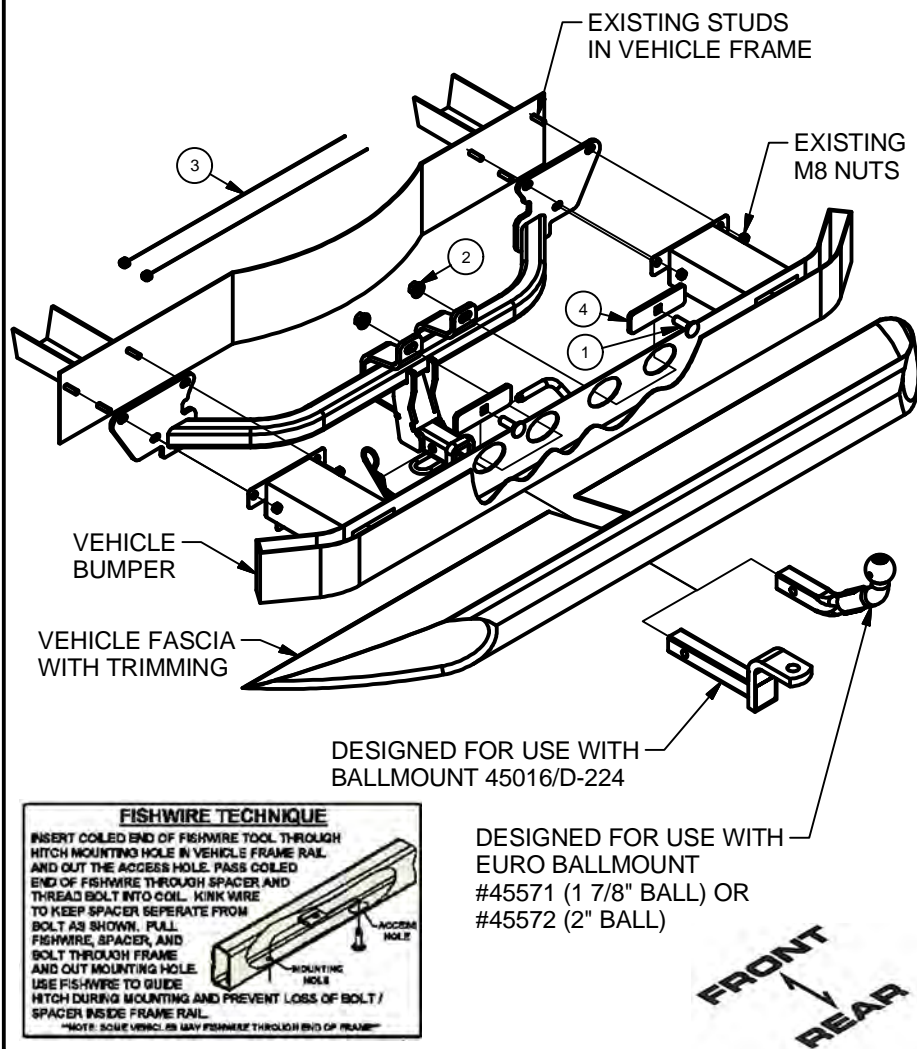

1. Open liftgate to expose rear fascia attachment points. Remove (2) screws and (1) T30 torx bolt from each side under the wheel well. Remove the bottom (3) T30 Torx and (5) phillips screw fascia attachment points. Save hardware for reassembly.

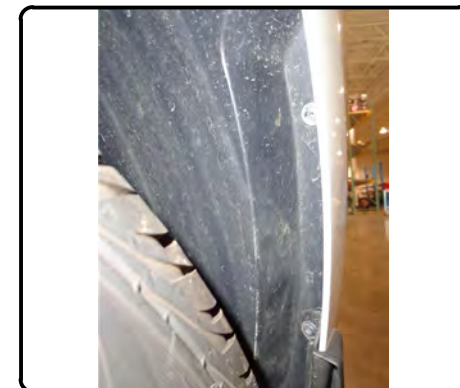

2. Disconnect fascia clips from under taillights to remove fascia. Gently pull fascia away from vehicle, making sure to carefully disconnect electrical connectors during removal. Set aside parts for reassembly.

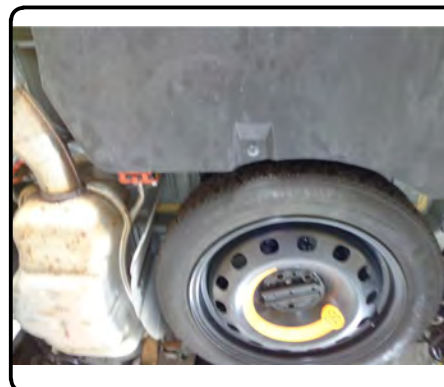

INSTALLATION WALKTHROUGH:

3. Once bumper beam is exposed, remove by loosening (3) M8 nuts from the frame studs on each side of the vehicle. Carefully pull the bumper beam away from the vehicle and disconnect harness attachments, set aside for reassembly.



4. Drill out outboard passenger side rivet with 13/64" bit and trim 2 1/2" x 6" plastic area with shears or a rotary tool as shown. This will allow passenger side plate to sit flush when mounted.



5. Raise hitch into position onto the (6) vehicle frame studs. Reposition the vehicle bumper beam onto the hitch, sandwiching the hitch between the frame and the bumper. Tighten existing M8 vehicle hardware back onto mounting studs.



6. Fishwire 1/2" carriage bolts and spacers through bumper access holes and out center support brackets. Tighten 1/2" nuts to secure center support. Locate front mounting plate to secure electrical housing bracket and secure with T30 torx bit that was removed from vehicle in Step. 1.



INSTALLATION WALKTHROUGH:

7. Torque the M8 hardware to 25 ft-lbs.

Torque the 1/2" hardware to 110 ft-lbs.

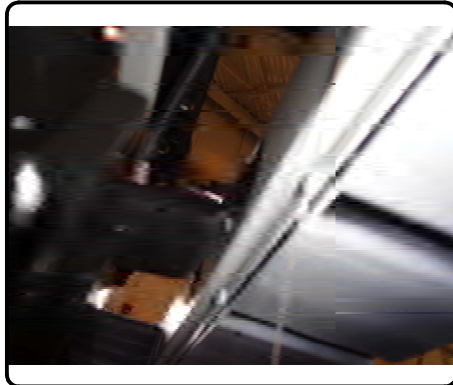

8. Trim approximately 5" x 2 1/2" area at the center of the fascia as shown in the trim diagram. Reassemble the rear fascia by following Steps 1-2 in reverse.
(2 bottom fascia mounting locations will now have been removed due to trim areas)

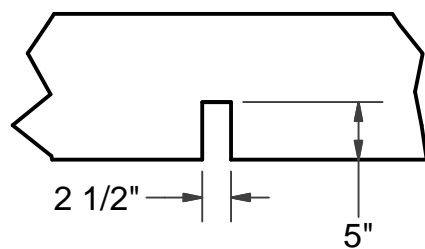

REAR VEHICLE FASCIA TRIM

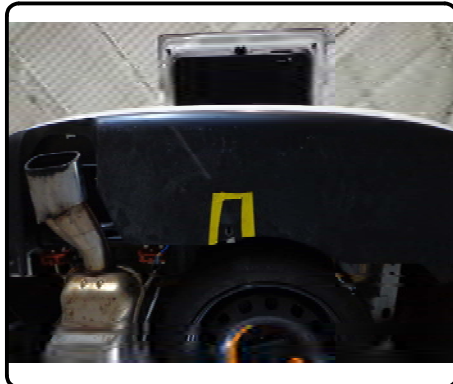

Installation complete



11364

FIAT 500L

6/26/2014

PAGE 1 of 2

GROSS LOAD CAPACITY WHEN USED AS A WEIGHT CARRYING HITCH: 2,000 LBS. TRAILER WEIGHT & 200 LBS. TONGUE WEIGHT.

DO NOT EXCEED VEHICLE MANUFACTURER'S RECOMMENDED TOWING CAPACITY.

WARNING: ALL NON-TRAILER LOADS APPLIED TO THIS PRODUCT MUST BE SUPPORTED BY 18050 STABILIZING STRAPS.

** FAILURE TO PROPERLY SUPPORT NON-TRAILER LOADS WILL VOID PRODUCT WARRANTY**

HAVING INSTALLATION QUESTIONS? CALL TECHNICAL SUPPORT AT 1-800-798-0813

Parts List				
ITEM	QTY	PART NUMBER	DESCRIPTION	
1	2	1/2-13 x 1 1/2, GR8	CARRIAGE BOLT	
2	2	HFN 1213, GR8	HEX FLANGE NUT	
3	2	1_2 FISHWIRE	1/2" FISHWIRE	
4	2	11364-SP	.250" PLATE	

TOOLS REQUIRED

SCREWDRIVER

T30 TORXBIT SOCKET

RATCHET

13mm SCOKET

9" SOCKET EXTENSION

POWER DRILL

13/64" DRILL BIT

TAPE MEASURE

AVIATION SHEARS

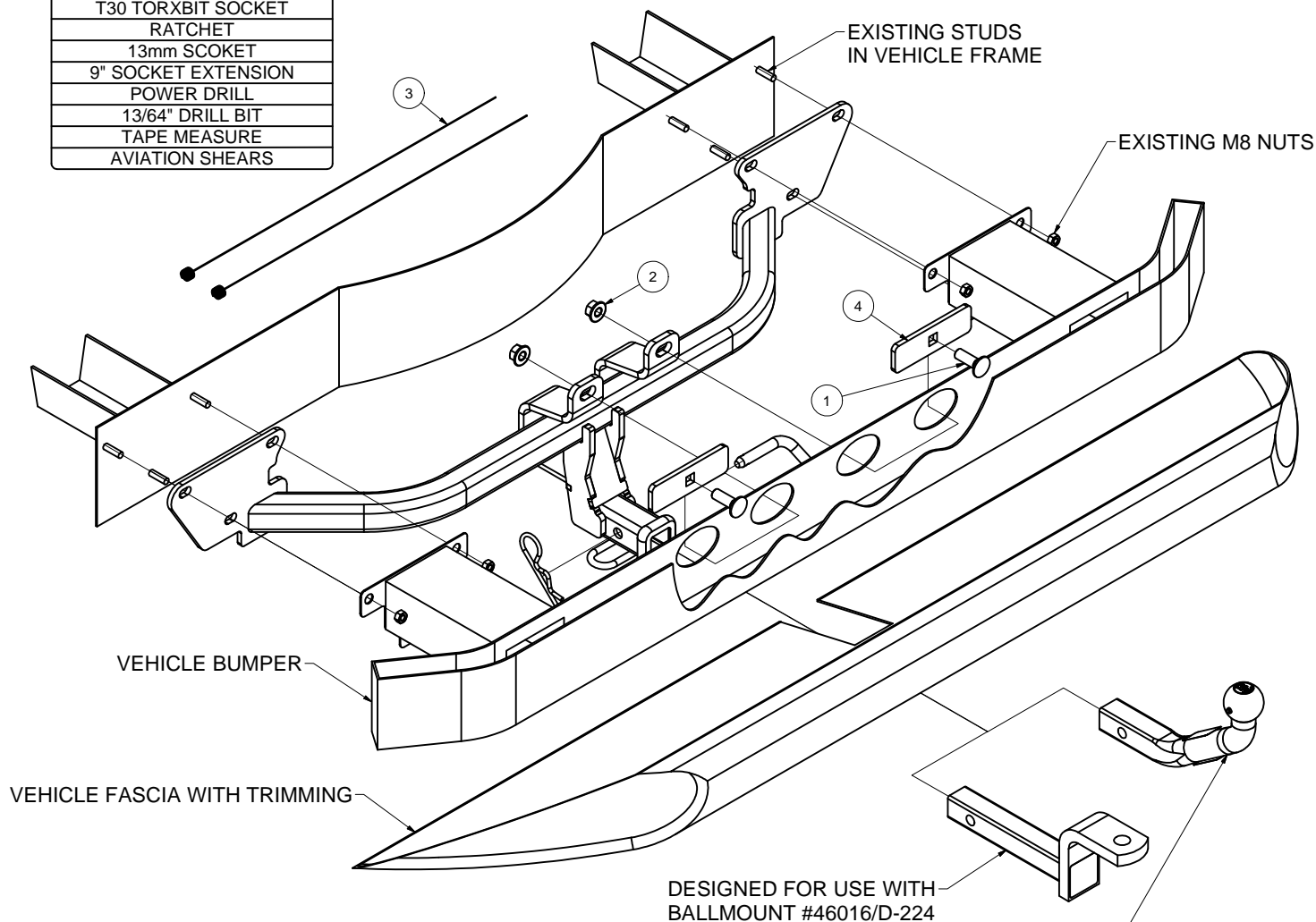
HITCH WEIGHT: 30 LBS.INSTALL TIME

PROFESSIONAL: 45 MINUTES

NOVICE (DIY): 90 MINUTES

INSTALL NOTES:

- DRILLING REQUIRED
- PART REMOVAL
- FASCIA TRIMMING

PERIODICALLY CHECK THIS RECEIVER HITCH TO ENSURE THAT ALL FASTENERS ARE TIGHT AND THAT ALL STRUCTURAL COMPONENTS ARE SOUND.

Curt Manufacturing LLC., warrants this product to be free of defects in material and/or workmanship at the time of retail purchase by the original purchaser. If the product is found to be defective, Curt Manufacturing LLC., may repair or replace the product, at their option, when the product is returned, prepaid, with proof of purchase. Alteration to, misuse of, or improper installation of this product voids the warranty. Curt Manufacturing LLC.'s liability is limited to repair or replacement of products found to be defective, and specifically excludes liability for incidental or consequential loss or damage.

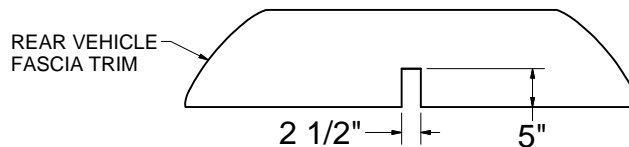
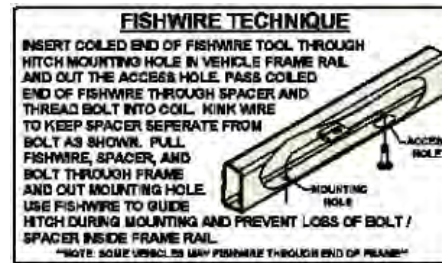
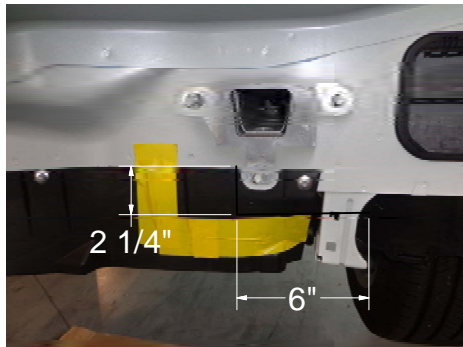

INSTALLATION STEPS

1. Open liftgate to expose rear fascia attachment points. Remove (2) screws and (1) T30 torx bolt from each side under the wheel well. Remove the bottom (3) T30 Torx and (5) phillips screw fascia attachment points. Save hardware for reassembly.
2. Disconnect fascia clips from under taillights to remove fascia. Gently pull fascia away from vehicle, making sure to carefully disconnect electrical connectors during removal. Set aside parts for reassembly.
3. Once bumper beam is exposed, remove by loosening (3) M8 nuts from the frame studs on each side of the vehicle. Carefully pull the bumper beam away from the vehicle and disconnect harness attachments, set aside for reassembly.
4. Drill out outboard passenger side rivet with 13/64" bit and trim 2 1/2" x 6" plastic area with shears or a rotary tool. This will allow passenger side plate to sit flush when mounted.
5. Raise hitch into position onto the (6) vehicle frame studs. Reposition the vehicle bumper beam onto the hitch, sandwiching the hitch between the frame and the bumper. Tighten existing M8 vehicle hardware back onto mounting studs.
6. Fishwire 1/2" carriage bolts and spacers through bumper access holes and out center support brackets. Tighten 1/2" nuts to secure center support. Locate front mounting plate to secure electrical housing bracket and secure with T30 torx bit that was removed from vehicle in Step. 1.
7. Torque the M8 hardware to 25 ft-lbs. Torque the 1/2" hardware to 110 ft-lbs.
8. Trim about a 5" x 2 1/2" cutout at the center of the fascia for receiver tube clearance. Reassemble the rear fascia by following Steps 1-2 in reverse (2 bottom fascia mounting locations will now have been removed due to trim areas)

PERIODICALLY CHECK THIS RECEIVER HITCH TO ENSURE THAT ALL FASTENERS ARE TIGHT AND THAT ALL STRUCTURAL COMPONENTS ARE SOUND.