

Heavy Duty Winch Front Bumper

2017 Ford Superduty

AL-FBM12FDN-RT

08/07/20

RT Light Mount Hardware Kit Includes:

- (1) 4 – Hex Head Bolts (M8-1.25 x 25mm)
- (2) 4 – Flat Washers (M8-24mm O.D.)
- (3) 4 – Serrated Flange Nuts (M8-1.25)

Skid Plate Hardware Kit Includes:

- (4) 8 – Button Head Bolts (M8-1.25 x 25mm)
- (5) 16 – Flat Washers (M8-22mm O.D.)
- (6) 8 – Nylon Lock Nuts (M8-1.25)

Winch Carrier Hardware Kit Includes:

- (7) 8 – Hex Head Bolts (M12 x 50 mm) Grade 8
- (8) 8 – Flat Washers (M12-37mm O.D.)

D-Ring Hardware Kit Includes:

- (9) 4 – Hex Head Bolts (M12 x 170mm) Grade 8
- (10) 20 – Lock Washers (M12)
- (11) 16 – Flat Washers (M12-24mm O.D.)
- (12) 12 – Hex Nuts (M12)
- (13) 8 – Plastic Push Nuts

ACC Bracket Hardware Kit Includes:

- (14) 5 – Hex Head Bolts (M8-1.25 x 20mm)
- (15) 5 – Lock Washers (M8)
- (16) 5 – Hex Head Nuts (M8-1.25)
- (17) 10 – Flat Washers (M8-16mm O.D.)
- (18) 1 – BP5733 Rocker Armor Filler Panel

Components List:

- 1 – Heavy Duty Bumper (FBM12FDN)
- 2 – Mounting Brackets 1 Driver/1 Pass (BP5498)
- 1 – Winch Carrier (BP5497)
- 1 – Skid Plate
- 2 – Skid Plate Supports
- 2 – Nut Plates (BP5510)
- 4 – M12 Double T-Bolts (BP5288)
- 4 – Inside/Outside Bracket Insulator (100428)
- 1 – Adaptive Cruise Control Bracket (BP5707)
- 1 – Center Light/Adaptive Cruise Mount (BP5708)
- 4 – Rubber Plugs for RT Light Mount Holes
- 2 – Foam Gaskets for RT Light Mount
- 2 – Rubber Plugs for License Plate Mounting Holes
- 1 – RT Light Bar Mount
- 2 – RT Light Bar Foam Gaskets
- 4 – RT Light Bar Hole Plugs



ATTN: STATE OF CALIFORNIA CONSUMERS
WARNING: CANCER AND REPRODUCTIVE HARM
 -WWW.P65WARNINGS.CA.GOV

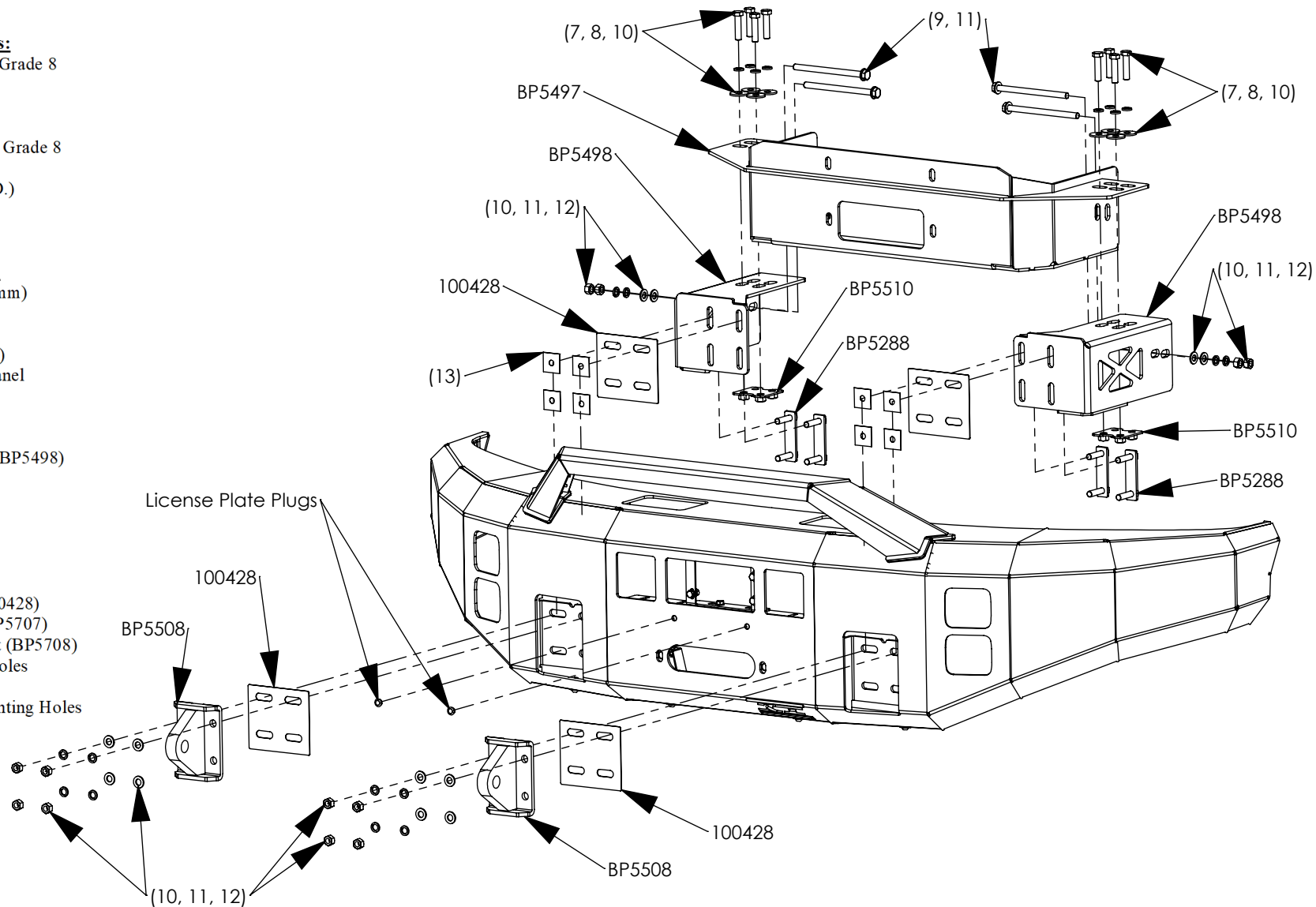

**LOOSE FIT ALL COMPONENTS.
 DO NOT TIGHTEN UNTIL ALL
 COMPONENTS ARE INSTALLED
 AND ADJUSTED.**

Heavy Duty Winch Front Bumper

2017 Ford Superduty

LOOSE FIT ALL COMPONENTS.
DO NOT TIGHTEN UNTIL ALL
COMPONENTS ARE INSTALLED
AND ADJUSTED.

AL-FBM12FDN-RT

08/07/20

Fig. A

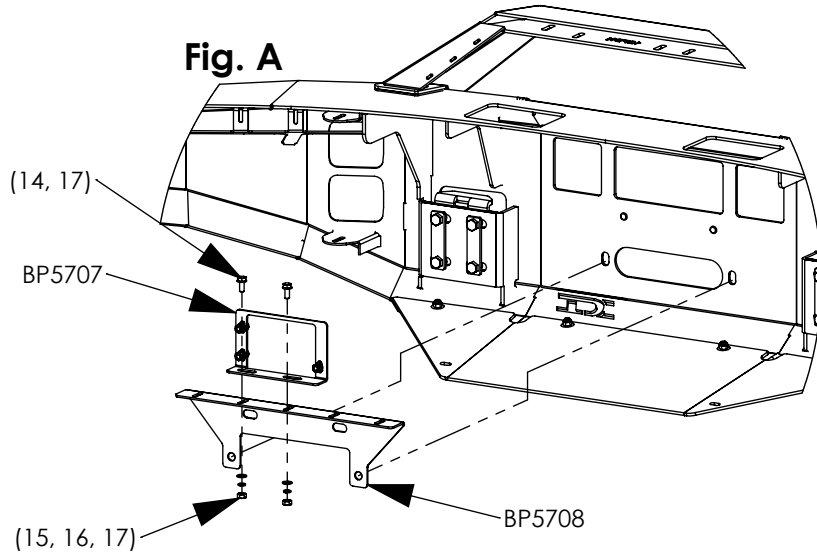

Fig. B

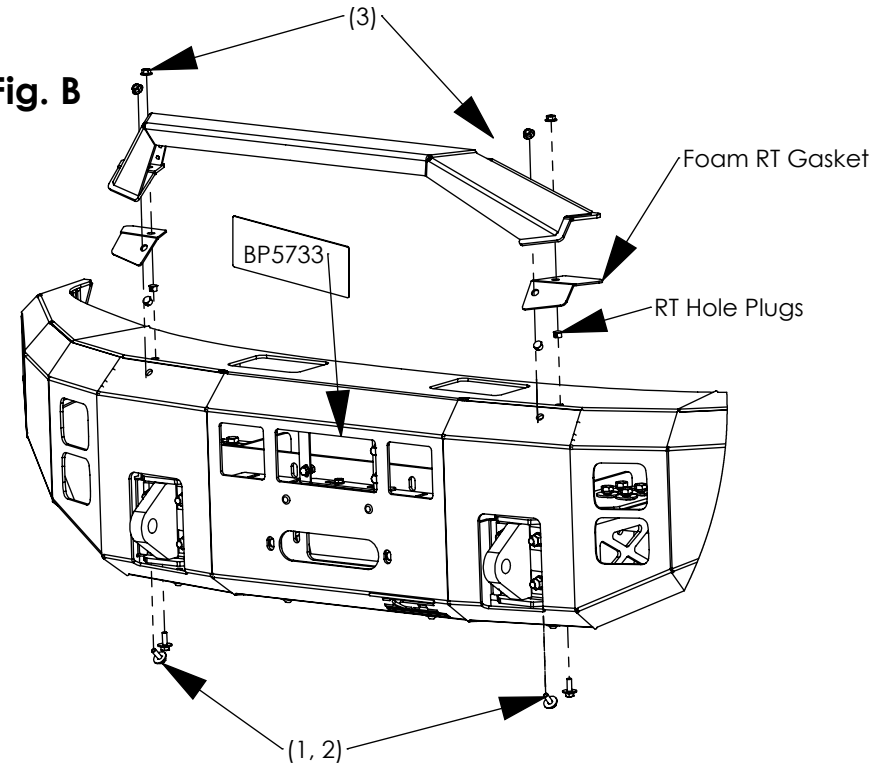
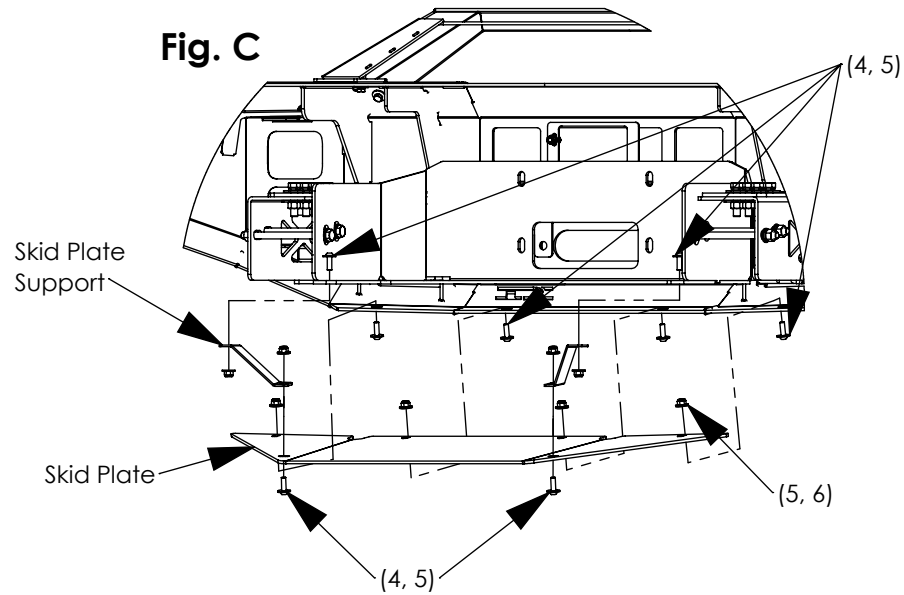

Fig. C



Heavy Duty Winch Front Bumper

2017 Ford Superduty

AL-FBM12FDN-RT

08/07/20

- STEP 1.** Open the hood and disconnect the negative battery terminal
- STEP 2.** Begin by unplugging the front bumper wiring harness located behind the bumper on the driver side and allow to hang clear of the frame.
- STEP 3.** Next, unbolt the two outside mounting brackets located on the outside of the frame and behind the bumper on either side of the frame. Remove the eight bolts attaching the bumper assembly at the front of the frame inside the tow hook pocket. The bumper can now be slid forward and removed from the truck.
- STEP 4.** Now unbolt and remove the inside bumper/tow hook bracket from the frame and put aside, you will not reuse these items with the Alumilite bumper.
- STEP 5.** If the factory bumper came equipped with the two rubber/plastic buffers located on either side of the bumper, remove them along with the plastic retaining push pins and reinstall on the inside outer edges of the new Alumilite bumper. Also, remove the factory fog light wiring harness as this can be reused for one pair of aftermarket lights in the new Alumilite bumper.
- STEP 6.** Next, place the supplied BP5498 outside bumper brackets to the factory frame and align with the stock frame holes. Next install the two inner most T-bolts BP5288 into the outside brackets BP5498 and secure using four of the supplied plastic push nuts. Now place the supplied winch mount BP5497 over the top of the BP5498 brackets, align and attach using the supplied M12 mounting hardware starting with the 6 ½" long side mounting bolts first, leave slightly loose. Next place supplied four nut-plate BP5510 on the inside of the frame and align with the corresponding top frame holes, attach using four per side of the M12x50mm hex head bolts, flat and lock washers, again leave slightly loose. Align the winch carrier and mounting brackets and leave loose until after the bumper is properly aligned.
- STEP 7.** Prior to bumper installation, install Center Light/Adaptive Cruise Mount (BP5708) to the bumper using the two bolts that hold the winch fairlead to the bumper (if equipped). Attach the adaptive cruise control module to the front of the bracket using M8 hardware. Use the six 16mm O.D. flat washers (17) to mount the module to the Adaptive Cruise Control bracket. Attach the bracket BP5707 to BP5708 (if equipped) as shown in **Fig. A**. If attaching the RT Light Mount, it should also be attached to the bumper at this time. Use the provided M8 hardware and the foam gasket as shown in **Fig. B**. The foam gasket will prevent scratching powder coat where the two parts are attached. If the RT Light Mount is not being installed, plug the RT Light Mount holes with the Rubber plugs. ICI recommends installing driving/fog lights (not included) prior to front bumper installation.
- STEP 8.** Next, with help, lift the Alumilite bumper FBM12FDN up and onto the vehicle. Align the two inner T-bolts (BP5288) with the corresponding inner bumper mounting brackets and attach using four of the supplied hex head nuts and flat washers. Align the bumper with the inner fender of the truck (inward and outward). Once you have set the proper depth alignment, tighten the two per side outer 6 ½" long through bolts to the frame. After tightening the two outer bolts securing the brackets to the frame, remove the bumper from the truck and tighten all the remaining M12 bracket mounting hardware. Next, proceed with winch installation (follow manufactures instructions for proper hookup). Winch fairlead will mount to the FBM12FDN Bumper face. **Relocation of solenoid pack or re-clocking gear box may be necessary (contact winch manufacturer for proper procedure).**
- STEP 9.** Now finish bumper installation by installing the remaining (outside) t-bolts BP5288 into the BP5498 outside mounting brackets and secure with remaining plastic push nuts. A plastic isolator (100428) should be placed over the T-Bolts so that it is between the bumper and the frame when the bumper is installed. This will prevent contact between steel and aluminum parts. With help lift bumper up into place and center mounting holes with t-bolts previously installed. Align the supplied bolt on D-ring shackle mounts with the t-bolts and secure using the M12 hex head nuts, lock washers, and flat washers. Be sure to place another plastic isolator between the bumper and the D-Ring Shackle Mounts. Feed the winch cable through fairlead opening in the bumper and align bumper to desired location leaving a minimum ¼" reveal the truck body and bumper then fully tighten all mounting hardware.
- STEP 10.** Attach the Skid Plate Supports to the hole at the back of the winch carrier using the provided M8 Button Head bolts flat washers, and lock washers. Leave hardware loose. Align the skid plate with the four holes on the bottom edge of the bumper and the support straps. The skid plate should sit on the inside of the bumper face. Use the remaining M8 hardware to attach the skid plate to the bumper and support brackets. Refer to **Fig. C**. After all hardware is in place, align and tighten the skid plate hardware. Finalize installation by wiring lights (to manufactures specs), spool in winch cable and secure the recovery hook. Attach the BP5733 Rocker Armor filler panel to the front opening of the bumper to protect the adaptive cruise module if equipped. Your installation is complete.