



AIRCHARGER®

HIGH-FLOW INTAKE KITS

NOT LEGAL FOR SALE OR USE ON ANY POLLUTION CONTROLLED MOTOR VEHICLE IN CALIFORNIA OR STATES ADOPTING CALIFORNIA EMISSION PROCEDURES.
See knfilters.com for CARB status on each part for a specific vehicle

INSTALLATION INSTRUCTIONS

63-1595

JEEP

2022-24

GRAND CHEROKEE 4XE

L4-2.0L TURBO

TOOLS NEEDED:

- 1/4" Ratchet
- Extension
- Flathead screwdriver
- 10mm wrench
- 4mm allen key
- 3mm allen key
- 10mm socket

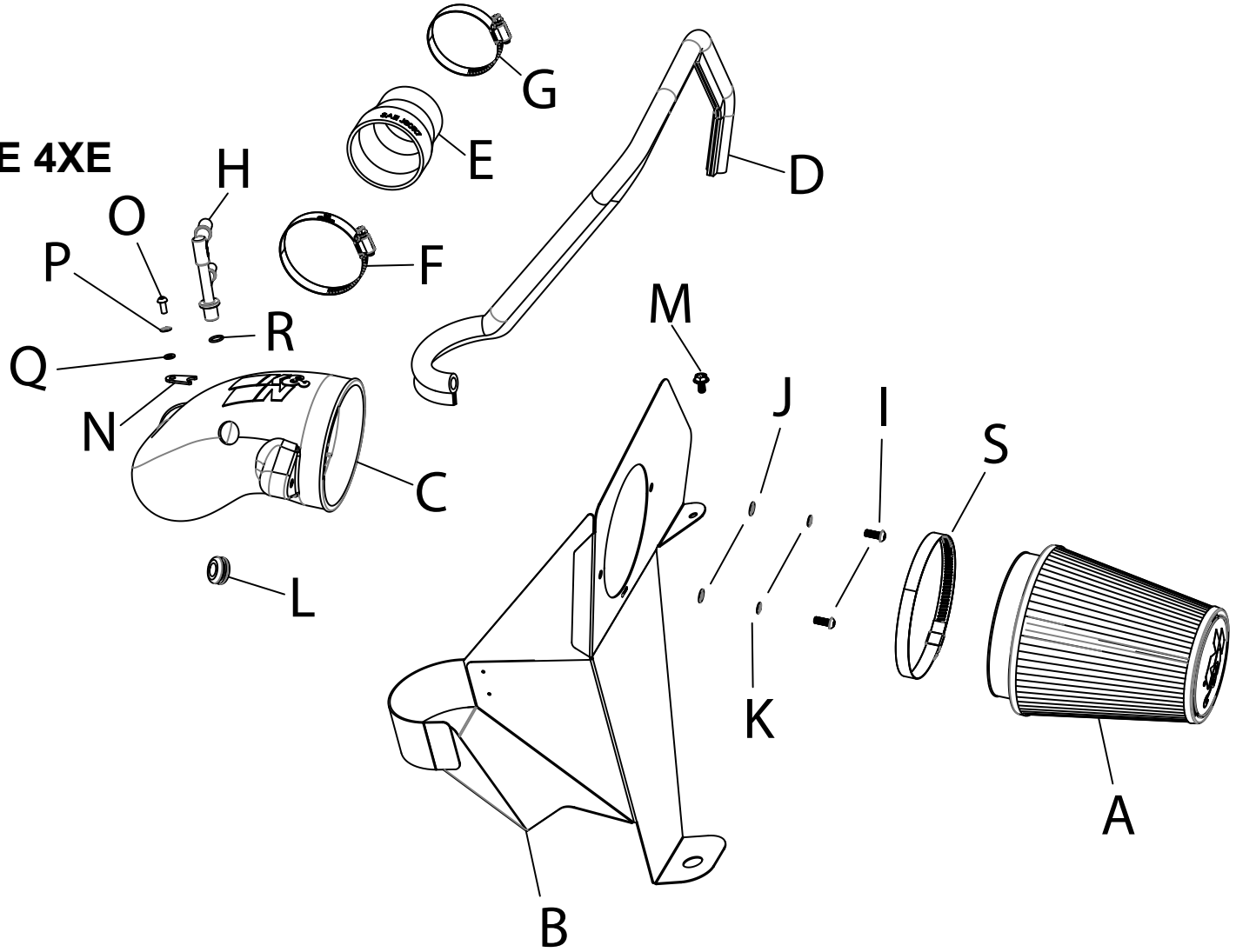

PARTS LIST:

Description	Qty.	Part #	Description	Qty.	Part #	Description	Qty.	Part #
A AIR FILTER	1	RU-2800	H VENT; EJECTOR "F"	1	08528	O BOLT; M5, BUTTON HEAD	1	07734
B HEATSHIELD	1	074583	I BOLT; M6-1 X 12 BUTTONHEAD	2	07794	P WASHER; STAR CUT LOCK	1	07724
C TUBE	1	087585	J WASHER; 6MM FLAT, SS	2	08269	Q WASHER; 5MM FLAT, SS	1	08212
D EDGE TRIM; 3/4" BULB, 61"L	1	102492	K WASHER; M6, SPLIT LOCK	2	1-3025	R O-RING; #013	1	KITORING013
E HOSE; STEP 2.25"/2.75" X 3"	1	5-227	L GROMMET	1	KITGRMT02	S HOSE CLAMP; #88	1	KITHS88
F HOSE CLAMP; #44	1	08577	M BOLT; M6-1 X 12, HEX	1	1-2110			
G HOSE CLAMP; #36	1	08530	N BRACKET; VENT HOLD DOWN	1	064360			

If you need any assistance please call 1-800-858-3333 to speak with a representative in our Customer Service Center before returning the product.

NOTE: FAILURE TO FOLLOW INSTALLATION INSTRUCTIONS AND NOT USING THE PROVIDED HARDWARE MAY DAMAGE THE INTAKE TUBE, THROTTLE BODY AND ENGINE.

TO START:

1. Turn off the ignition and disconnect the negative battery cable.

NOTE: Disconnecting the negative battery cable erases pre-programmed electronic memories. Write down all memory settings before disconnecting the negative battery cable. Some radios will require an anti-theft code to be entered after the battery is reconnected. The anti-theft code is typically supplied with your owner's manual. In the event your vehicles anti-theft code cannot be recovered, contact an authorized dealership to obtain your vehicles anti-theft code.

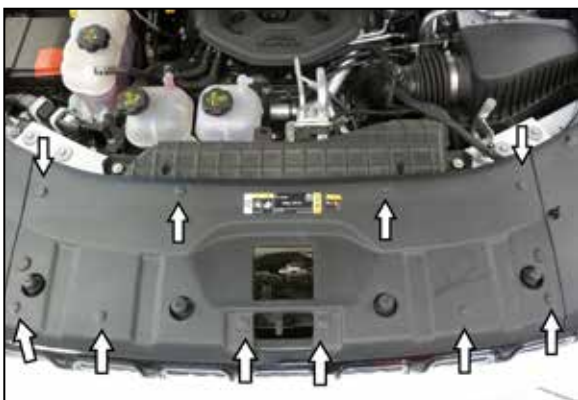

2. Remove the ten push pins that secure the valence and then remove the valence from the vehicle.



3. Unhook the wiring harness from the fresh air duct. Remove the two bolts that secure the fresh air duct then remove the fresh air duct from the vehicle.



4. Disconnect the IAT sensor electrical connection. Loosen the hose clamp that secures the intake hose to the air filter housing.



5. Loosen the hose clamp the secures the intake hose to the turbo inlet and then remove the hose from the vehicle.



6. Push in the locking tabs and then disconnect the Ejector lines from the intake plenum.



7. Remove the four bolts that secure the upper air filter housing and then remove the upper housing from the vehicle.



8. Remove the two bolts that secure the lower air filter housing and then remove the housing from the vehicle.



9. Install the provided edge trim onto the heat shield as shown. Some trimming of the edge trim will be necessary.



10. Remove the factory air filter housing mounting grommet and then install it into the K&N heat shield as shown.

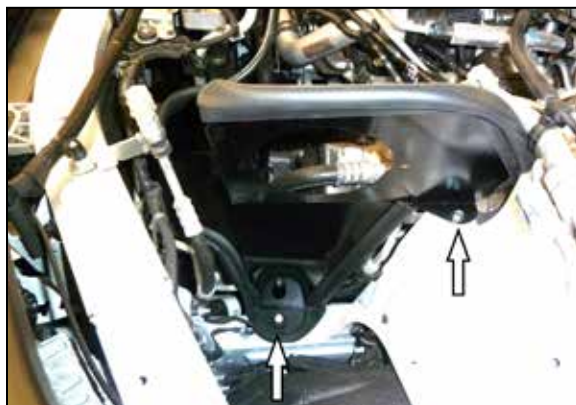

11. Install the heat shield into the vehicle so that the mounting stud inserts into the grommet in the heat shield then secure to the inner fender with the provided bolt.



12. Install the step coupler onto the turbo inlet and secure with the provided hose clamp.



13. Install the provided O-ring onto the K&N Ejector fitting then install the fitting into the K&N intake tube and secure with the provided mounting clip and hardware.



14. Remove the IAT sensor from the factory intake hose and install it into the K&N intake tube with the provided grommet.



15. Install the K&N intake tube into the heat shield and coupler.



16. Secure the tube to the heat shield with the provided hardware and tighten the hose clamp at the coupler.



17. Connect the Ejector vent lines to the K&N Ejector F-fitting.



21. Install the K&N air filter onto the intake tube and secure with the provided hose clamp.



18. Reinstall the fresh air duct and secure with the factory hardware.



22. Reconnect the vehicle's negative battery cable. Double check to make sure everything is tight and properly positioned before starting the vehicle.



19. Reconnect the IAT sensor electrical connection.

23. It will be necessary for all K&N® high flow intake systems to be checked periodically for realignment, clearance and tightening of all connections. Failure to follow the above instructions or proper maintenance may void warranty.



20. Reinstall the valence and secure the factory push pins.

ROAD TESTING:

1. Start the engine with the transmission in neutral or park, and the parking brake engaged. Listen for air leaks or odd noises. For air leaks secure hoses and connections. For odd noises, find cause and repair before proceeding. This kit will function identically to the factory system except for being louder and much more responsive.
2. Test drive the vehicle. Listen for odd noises or rattles and fix as necessary.
3. If road test is fine, you can now enjoy the added power and performance from your kit.
4. K&N Engineering, Inc., requires cleaning the intake system's air filter element every 100,000 miles. When used in dusty or off-road environments, our filters will require cleaning more often. We recommend that you visually inspect your filter once every 25,000 miles to determine if the screen is still visible. When the screen is no longer visible some place on the filter element, it is time to clean it. To clean and re-oil, purchase our filter Recharger® service kit, part number 99-5050 or 99-5000 and follow the easy instructions.

NOT LEGAL FOR SALE OR USE ON ANY POLLUTION CONTROLLED MOTOR VEHICLE IN CALIFORNIA OR STATES ADOPTING CALIFORNIA EMISSION PROCEDURES.

See knfilters.com for CARB status on each part for a specific vehicle