



TYPHOON INTAKE SYSTEMS

NOT LEGAL FOR SALE OR USE ON ANY POLLUTION CONTROLLED MOTOR VEHICLE IN CALIFORNIA OR STATES ADOPTING CALIFORNIA EMISSION PROCEDURES.
See knfilters.com for CARB status on each part for a specific vehicle

INSTALLATION INSTRUCTIONS

69-1508TC
ACURA
2021-24 TLX
L4-2.0L

TOOLS NEEDED:

- Flat Blade Screw Driver
- Phillips Screw driver
- Ratchet
- Extension
- 10mm Socket
- 4mm Allen Key

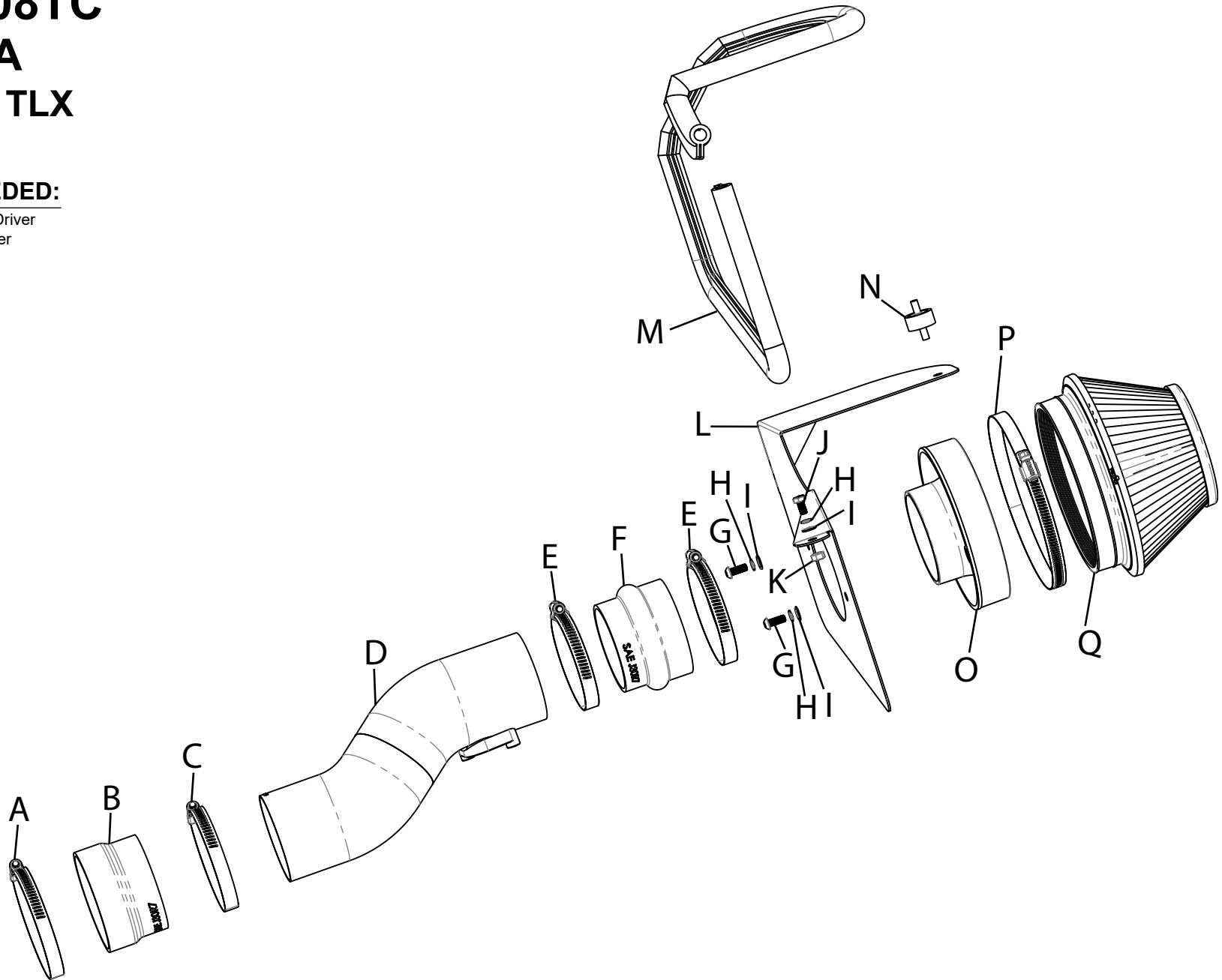

PARTS LIST:

Description	Qty.	Part #	Description	Qty.	Part #	Description	Qty.	Part #
A HOSE CLAMP; #56	1	08620	G BOLT; M6 X 1 X 16MM, BTNHD	2	07730	M EDGE TRIM; (42"L)	1	102499
B HOSE; 3.25"ID TO 3.5"ID X 2.25"L	1	084091	H WASHER; M6 SPLIT LOCK	3	1-3025	N STUD; M6-1.00 RUBBER	1	07027
C HOSE CLAMP; #48	1	08601	I WASHER; 6MM FLAT	3	08269	O ADAPTER; 3.5" COUPLER	1	21512-1
D TUBE; 3.25"OD X 12"L	1	25878C	J BOLT; M6-1 X 16MM, HEX	1	07812	P HOSE CLAMP; #104	1	08697
E HOSE CLAMP; #52	2	08610	K NUT; M6 HEX, SERRATED	1	444.460.04	Q AIR FILTER	1	RU-4600
F HOSE; HUMP, 3"ID TO 3.25"ID	1	084118	L HEAT SHIELD	1	074553			

If you need any assistance please call 1-800-858-3333 to speak with a representative in our Customer Service Center before returning the product.

NOTE: FAILURE TO FOLLOW INSTALLATION INSTRUCTIONS AND NOT USING THE PROVIDED HARDWARE MAY DAMAGE THE INTAKE TUBE, THROTTLE BODY AND ENGINE.

TO START:

1. Turn off the ignition and disconnect the negative battery cable.
NOTE: Disconnecting the negative battery cable erases pre-programmed electronic memories. Write down all memory settings before disconnecting the negative battery cable. Some radios will require an anti-theft code to be entered after the battery is reconnected. The anti-theft code is typically supplied with your owner's manual. In the event your vehicles anti-theft code cannot be recovered, contact an authorized dealership to obtain your vehicles anti-theft code.



2. Remove the pushpin securing the fresh air duct, then lift the radiator close out panel and remove the fresh air intake duct.



3. Disconnect the mass air sensor electrical connection and unhook the wiring harness from the air filter housing.



4. Loosen the clamp that secures the factory intake hose to the turbo inlet manifold.



8. Install the provided edge trim onto the heat shield as shown, some trimming will be necessary.



12. Install the provided hump coupler onto the turbo inlet manifold and secure with the provided hose clamp.



5. Release the two spring clamps that secure the air filter housing lid, remove the lid, intake hose and factory air filter.



9. Install the provided rubber mounted stud onto the factory filter housing bracket as shown.



13. Remove the mass air sensor from the factory housing and install it into the K&N intake tube and secure with the factory mounting bolts.



6. Loosen the three bolts that secure the lower air filter housing to the inner fender and then remove the housing from the vehicle.



10. Install the heat shield into the vehicle and secure with the provided hardware.



7. Install the filter adapter into the heat shield using the provided hardware.



11. Install the provided step coupler onto the filter adapter and secure with the provided hose clamp.



14. Install the K&N intake tube into the couplers, adjust for best fit and then secure with the provided hose clamps.



15. Reconnect the mass air sensor electrical connection.



16. Install the K&N air filter and secure with the provided hose clamp.



17. Install the K&N decal onto the tube.



18. Reconnect the vehicle's negative battery cable. Double check to make sure everything is tight and properly positioned before starting the vehicle.

19. It will be necessary for all K&N® high flow intake systems to be checked periodically for realignment, clearance and tightening of all connections. Failure to follow the above instructions or proper maintenance may void warranty.

ROAD TESTING:

1. Start the engine with the transmission in neutral or park, and the parking brake engaged. Listen for air leaks or odd noises. For air leaks secure hoses and connections. For odd noises, find cause and repair before proceeding. This kit will function identically to the factory system except for being louder and much more responsive.

2. Test drive the vehicle. Listen for odd noises or rattles and fix as necessary.

3. If road test is fine, you can now enjoy the added power and performance from your kit.

4. K&N Engineering, Inc., requires cleaning the intake system's air filter element every 100,000 miles. When used in dusty or off-road environments, our filters will require cleaning more often. We recommend that you visually inspect your filter once every 25,000 miles to determine if the screen is still visible. When the screen is no longer visible some place on the filter element, it is time to clean it. To clean and re-oil, purchase our filter Recharger® service kit, part number 99-5050 or 99-5000 and follow the easy instructions.

NOT LEGAL FOR SALE OR USE ON ANY POLLUTION CONTROLLED MOTOR VEHICLE IN CALIFORNIA OR STATES ADOPTING CALIFORNIA EMISSION PROCEDURES.

See knfilters.com for CARB status on each part for a specific vehicle