

# INSTALLATION INSTRUCTIONS

**69-9900TS**  
**ALFA ROMEO**  
**2017-2022 GIULIA**  
**2017-2022 STELVIO**  
**L4-2.0L TURBO**

**TOOLS NEEDED:**

- Ratchet
- Extension
- 7mm socket
- 8mm socket
- 10mm socket
- 10mm wrench
- Pliers
- Flathead screwdriver

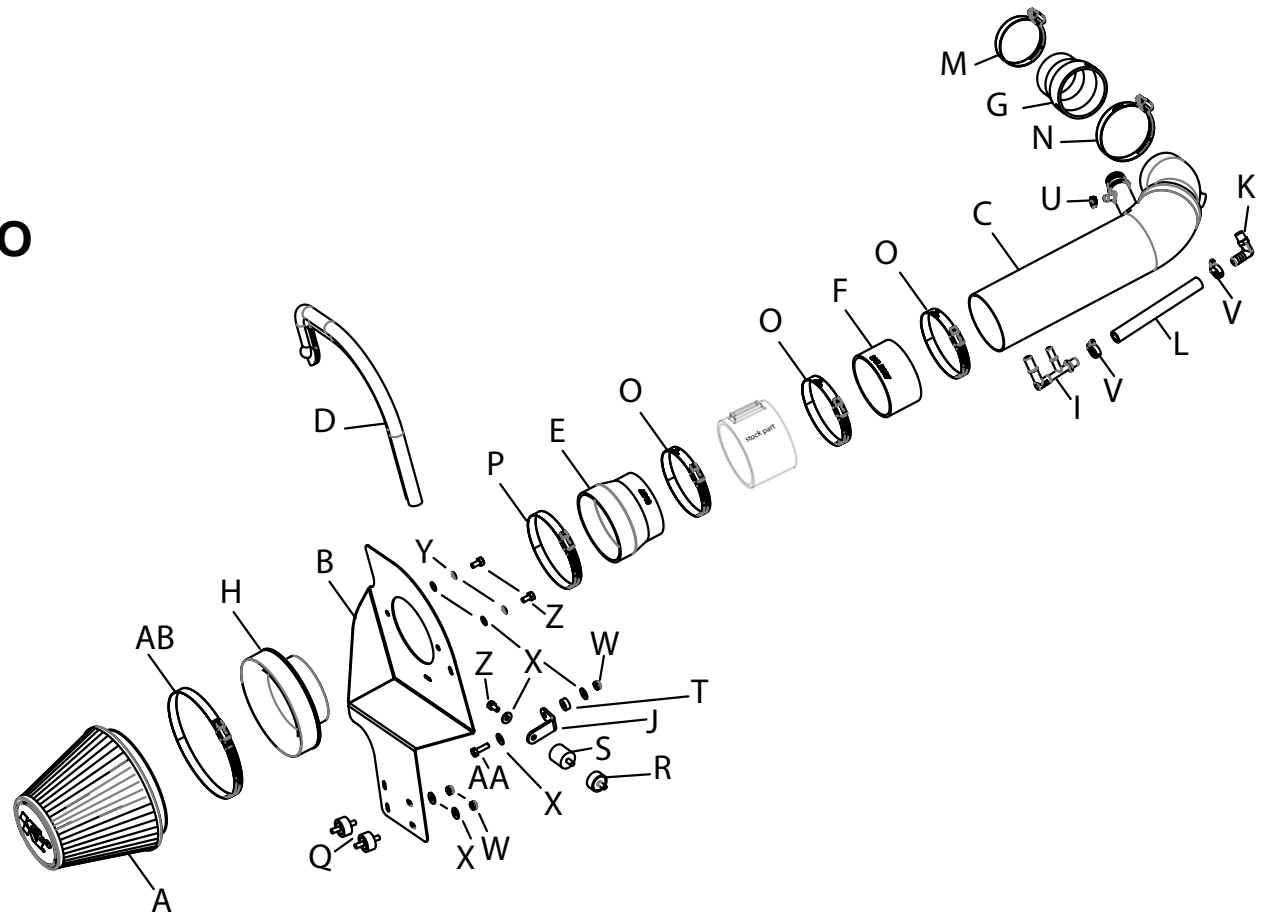

**PARTS LIST:**

Description	Qty.	Part #	Description	Qty.	Part #	Description	Qty.	Part #
A AIR FILTER	1	RU-1048	K VENT; 90 DEG, 1/2"HOSE	1	08110FK	U HOSE CLAMP; #004 MINI	1	21850
B HEATSHIELD	1	074571	L HOSE; 1/2"ID X 7"L	1	08159	V HOSE CLAMP; #006 MINI	2	08407
C INTAKE TUBE	1	25921S	M HOSE CLAMP; #36	1	08530	W NUT; 6MM NYLOCK	3	07512
D EDGE TRIM; 3/4" BULB, 26"L	1	102488	N HOSE CLAMP; #44	1	08560	X WASHER; 6MM FLAT, SS	7	08269
E HOSE; 4"ID TO 3.5"ID X 3"L	1	08497	O HOSE CLAMP; #56	3	08620	Y WASHER; M6, SPLIT LOCK	2	1-3025
F HOSE; 3.5 X 2" BLACK	1	5-351	P HOSE CLAMP; #64	1	08645	Z BOLT; M6 X 1 X 12MM	3	07727
G HOSE; 2.25"/2.75" X 3" BLK	1	5-227	Q STUD; M6-1.00 M/M	2	07027	AA BOLT; M6 X 1 X 20MM HEX	1	07795
H ADAPTOR; FILTER	1	27300	R STUD; RUBBER MNT, M/F, 1/2"L	1	070228	AB HOSE CLAMP; #104	1	08697
I VENT; EJECTOR "F", CCV	1	08528	S STUD; RUBBER MNT, M6 X 1"	1	02033			
J BRACKET; "L"	1	08025A	T SPACER; .625" OD	1	06555			

**If you need any assistance please call 1-800-858-3333 to speak with a representative in our Customer Service Center before returning the product.**

**NOTE: FAILURE TO FOLLOW INSTALLATION INSTRUCTIONS AND NOT USING THE PROVIDED HARDWARE MAY DAMAGE THE INTAKE TUBE, THROTTLE BODY AND ENGINE.**

**TO START:**

1. Turn off the ignition and disconnect the negative battery cable.  
**NOTE: Disconnecting the negative battery cable erases pre-programmed electronic memories. Write down all memory settings before disconnecting the negative battery cable. Some radios will require an anti-theft code to be entered after the battery is reconnected. The anti-theft code is typically supplied with your owner's manual. In the event your vehicles anti-theft code cannot be recovered, contact an authorized dealership to obtain your vehicles anti-theft code.**



2. Disconnect Mass air sensor electrical connection.



3. Remove the two bolts that secure the engine cover and then remove the engine cover from the vehicle.



4. Release the CCV tube quick connect fitting and disconnect the CCV tube. Release the pinch clamp that secures the vacuum line and disconnect the vacuum line from the intake tube.



5. Release the locking tabs that secure the vent lines to the ejector fittings on the bottom of the intake tube, then disconnect the vent lines.



6. Release the pinch clamp that secures the intake tube to the turbo inlet and then disconnect the intake tube from the turbo.





7. Remove the bolt that secures the air filter housing.



11. Install the provided edge trim onto the heat shield as shown.



16. Using the provided hardware and spacer, secure the "L" bracket to the heat shield and rubber mounted stud.



8. Remove the complete stock intake system from the vehicle.



12. Install the two M/M rubber mounted stud into the frame rail as shown.



17. Adjust the wiring harness to sit on the top of the bracket to allow for air filter clearance.



9. Remove the three bolts that secure the air filter mounting bracket and then remove the bracket from the vehicle.



13. On Stelvio models, install the provided 1" M/F rubber mounted stud into the core support.



18. Assemble the provided Ejector fitting, vent hose and 90-degree npt fitting as shown.



14. On Giulia models, install the provided 1/2" M/F rubber mounted stud into the core support.



19. Install the Ejector assembly onto the K&N intake tube as shown.

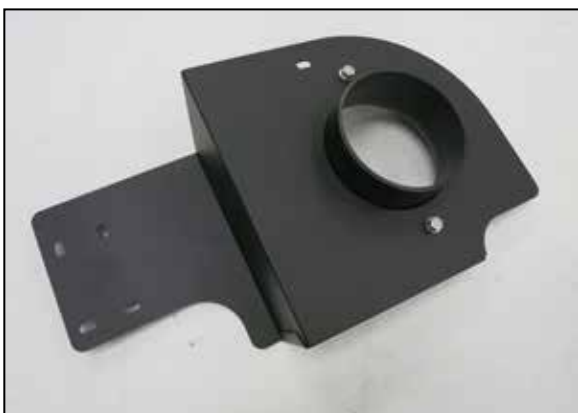

10. Install the radius filter adapter into the heat shield and secure with the provided hardware.



15. Install the heat shield onto the rubber mounted studs using the holes as noted in the photo.



20. Install the provided step coupler onto the turbo inlet as shown and secure with the provided hose clamp.





21. Remove the two bolts that secure the mass air sensor to the factory filter housing and then remove the sensor from the housing.



22. Install the provided step coupler onto the inlet side of the mass air sensor and secure with the provided hose clamp.



23. Install the mass air assembly onto the filter adapter and secure with the provided hose clamp. Reconnect the mass air sensor electrical connection.



24. Install the remaining straight coupler onto the mass air sensor and secure with the provided hose clamp.



25. Install the K&N intake tube into the couplers at the throttle body and filter adapter, adjust for best fit and then secure all the hose clamps.



26. Connect the factory Ejector lines to the K&N Ejector fitting.



27. Connect the factory CCV tube to the fitting on the K&N intake tube, then connect the vent line and secure with the provided hose clamp.



28. Install the K&N air filter onto the adapter and secure with the provided hose clamp.



29. Apply the K&N decal to the intake tube.



30. Reconnect the vehicle's negative battery cable. Double check to make sure everything is tight and properly positioned before starting the vehicle.

31. It will be necessary for all K&N® high flow intake systems to be checked periodically for realignment, clearance and tightening of all connections. Failure to follow the above instructions or proper maintenance may void warranty.

#### ROAD TESTING:

1. Start the engine with the transmission in neutral or park, and the parking brake engaged. Listen for air leaks or odd noises. For air leaks secure hoses and connections. For odd noises, find cause and repair before proceeding. This kit will function identically to the factory system except for being louder and much more responsive.

2. Test drive the vehicle. Listen for odd noises or rattles and fix as necessary.

3. If road test is fine, you can now enjoy the added power and performance from your kit.

4. K&N Engineering, Inc., requires cleaning the intake system's air filter element every 100,000 miles. When used in dusty or off-road environments, our filters will require cleaning more often. We recommend that you visually inspect your filter once every 25,000 miles to determine if the screen is still visible. When the screen is no longer visible some place on the filter element, it is time to clean it. To clean and re-oil, purchase our filter Recharger® service kit, part number 99-5050 or 99-5000 and follow the easy instructions.

**NOT LEGAL FOR SALE OR USE ON ANY POLLUTION CONTROLLED MOTOR VEHICLE IN CALIFORNIA OR STATES ADOPTING CALIFORNIA EMISSION PROCEDURES.**

See [knfilters.com](http://knfilters.com) for CARB status on each part for a specific vehicle