



NOT LEGAL FOR SALE OR USE ON ANY POLLUTION CONTROLLED MOTOR VEHICLE IN CALIFORNIA OR STATES ADOPTING CALIFORNIA EMISSION PROCEDURES.
See knfilters.com for CARB status on each part for a specific vehicle

INSTALLATION INSTRUCTIONS

77-2619KC
FORD
2018-2024 F150
V6-3.3L

TOOLS NEEDED:

Flathead screwdriver
Adjustable wrench

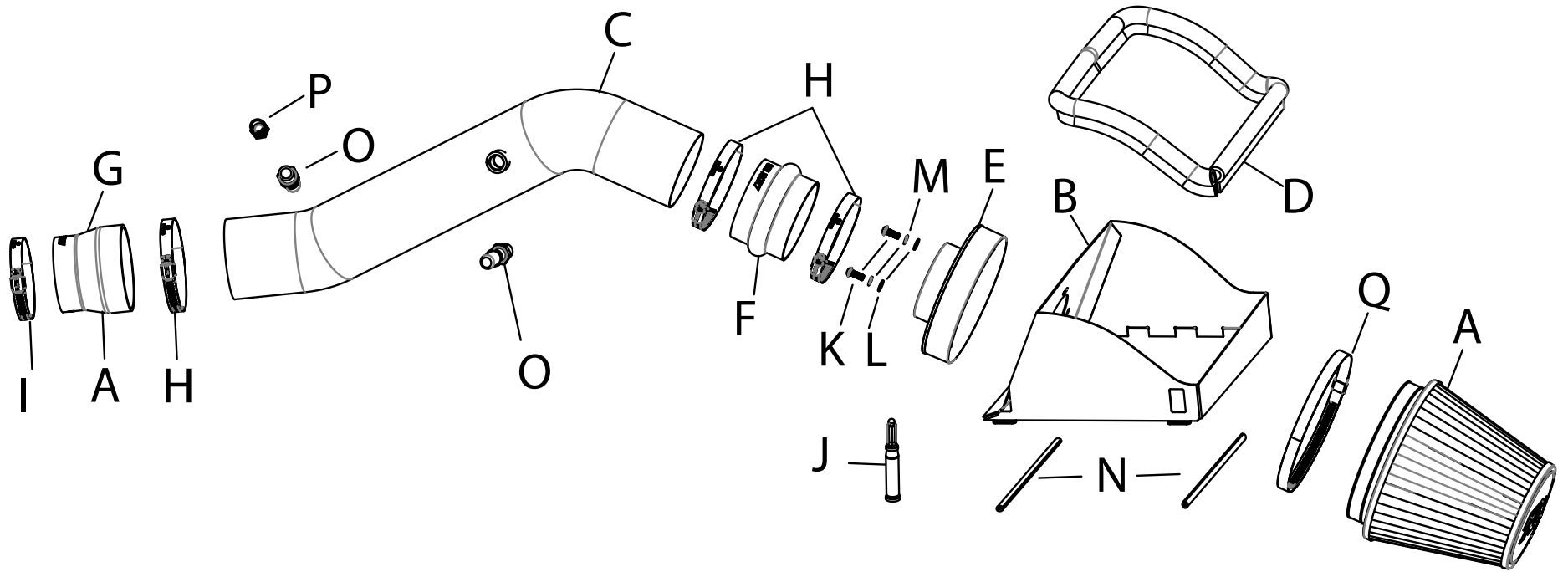

PARTS LIST:

Description	Qty.	Part #	Description	Qty.	Part #	Description	Qty.	Part #
A AIR FILTER	1	RU-1042	G HOSE; ADAPTER 3/3.5 X 3	1	5-353	M WASHER; M6, SPLIT LOCK	2	1-3025
B HEAT SHIELD	1	073182A	H HOSE CLAMP; #52	3	08620	N EDGE TRIM; 1/16"	1	102451
C INTAKE TUBE	1	25936C	I HOSE CLAMP; #48	1	08601	O FITTING; QUICK CONNECT	2	82637-1
D EDGE TRIM; 39"L	1	102496	J SUPER GLUE	1	409	P PLUG; 3/8 NPT	1	08350
E ADAPTER; FILTER	1	21512-1	K BOLT; M6 X 1 X 16MM	2	07730	Q HOSE CLAMP; #104	1	08697
F HOSE; HUMP 3.5"ID X 2.5"L	1	08699	L WASHER; 6MM FLAT, SS	2	08269			

If you need any assistance please call 1-800-858-3333 to speak with a representative in our Customer Service Center before returning the product.

NOTE: FAILURE TO FOLLOW INSTALLATION INSTRUCTIONS AND NOT USING THE PROVIDED HARDWARE MAY DAMAGE THE INTAKE TUBE, THROTTLE BODY AND ENGINE.

TO START:

1. Turn off the ignition and disconnect the negative battery cable.
NOTE: Disconnecting the negative battery cable erases pre-programmed electronic memories. Write down all memory settings before disconnecting the negative battery cable. Some radios will require an anti-theft code to be entered after the battery is reconnected. The anti-theft code is typically supplied with your owner's manual. In the event your vehicles anti-theft code cannot be recovered, contact an authorized dealership to obtain your vehicles anti-theft code.



2. Loosen the hose clamp that secures the factory intake tube to the throttle body and then release the vent line quick connector and separate the vent line from the intake tube.



3. Unhook the coolant hose from the intake tube and separate the hose hanger. On models equipped with the vent hose, release the quick connect fitting and separate the vent hose from the intake tube.



4. Release the two clips that secure the upper filter housing and then remove the upper housing, intake tube and factory air filter.



5. Install the bulb edge trim onto the top of the heat shield as shown.



6. Cut the provided small edge trim in half, then use the provided super glue to secure it to the bottom of the heat shield as shown.



7. Install the provided filter adapter into the heat shield as shown using the provided hardware.



8. Install the K&N air filter onto the adapter and secure with the provided hose clamp.



9. Install the heat shield/filter assembly onto the lower air filter housing and secure with the factory retaining clips.



10. Install the provided hump coupler onto the adapter and secure with the provided hose clamp.



11. Install the provided step coupler onto the throttle body and secure with the provided hose clamp.



12. Install the provided quick connect vent fittings into the K&N intake tube. On models that are equipped with one vent line, install the provided 3/8npt plug into the unused vent port.



13. Install the K&N intake tube into the couplers and adjust for best fit. Then secure the provided hose clamps.



14. Connect the factory vent line(s) to the fitting(S) installed into the K&N intake tube.



15. Apply the K&N decal onto the intake tube as shown.



16. Reconnect the vehicle's negative battery cable. Double check to make sure everything is tight and properly positioned before starting the vehicle.

17. It will be necessary for all K&N® high flow intake systems to be checked periodically for realignment, clearance and tightening of all connections. Failure to follow the above instructions or proper maintenance may void warranty.

ROAD TESTING:

1. Start the engine with the transmission in neutral or park, and the parking brake engaged. Listen for air leaks or odd noises. For air leaks secure hoses and connections. For odd noises, find cause and repair before proceeding. This kit will function identically to the factory system except for being louder and much more responsive.

2. Test drive the vehicle. Listen for odd noises or rattles and fix as necessary.

3. If road test is fine, you can now enjoy the added power and performance from your kit.

4. K&N Engineering, Inc., requires cleaning the intake system's air filter element every 100,000 miles. When used in dusty or off-road environments, our filters will require cleaning more often. We recommend that you visually inspect your filter once every 25,000 miles to determine if the screen is still visible. When the screen is no longer visible some place on the filter element, it is time to clean it. To clean and re-oil, purchase our filter Recharger® service kit, part number 99-5050 or 99-5000 and follow the easy instructions.

NOT LEGAL FOR SALE OR USE ON ANY POLLUTION CONTROLLED MOTOR VEHICLE IN CALIFORNIA OR STATES ADOPTING CALIFORNIA EMISSION PROCEDURES.

See knfilters.com for CARB status on each part for a specific vehicle