

INSTALLATION INSTRUCTIONS AND PARTS LIST
MODEL# 430711 BLACK HOOP STEP NERF BARS:
1999 AND NEWER CHEVROLET/GMC REGULAR CAB PICKUPS



1. READ INSTRUCTIONS COMPLETELY AND CHECK TO MAKE SURE THAT ALL REQUIRED PARTS (LISTED ON SERVICE PARTS LIST) ARE ON HAND BEFORE STARTING THE INSTALLATION.
2. ASSEMBLE THE NERF BAR TUBES AND MOUNTING BRACKETS AS FOLLOWS.
 NOTE: THE 1" X 3" SERIAL NUMBER DECAL IS LOCATED ON THE FRONT LEG OF THE LEFT (DRIVERS SIDE) NERF BAR ASSEMBLY.
 - 2.1 LAY THE NERF BAR ASSEMBLIES (ITEM #1) ON A FLAT SURFACE. (LEFT & RIGHT HAND ASSEMBLIES SHOULD BE MIRROR IMAGES OF ONE ANOTHER).
 - 2.2 ATTACH THE FRONT NOTCHED BRACKET (ITEM #2) AND REAR BRACKET (ITEM #3) TO THE NERF BAR AS SHOWN. USE 1/2-13 X 2" LONG HEX HEAD BOLTS (ITEM #8). TORQUE THESE BOLTS TO 65 LB. FT.

NOTE:

DUE TO EXCESSIVE THREAD LOCKER IN THE BODY MOUNT BOLT AREA ON THE 2010+ GM SILVERADO/SIERRA, PLEASE USE CAUTION WHEN REMOVING THESE BODY MOUNT BOLTS IN ORDER TO REDUCE THE RISK OF CAUSING DAMAGE TO THE THREADED INSERTS INSIDE THE VEHICLE.

3. REMOVE THE FOUR (4) APPLICABLE FACTORY BODY MOUNT BOLTS FROM THE VEHICLE.
 - 3.1. THESE FOUR (4) BOLTS ARE REUSED IN THIS INSTALLATION.
 - 3.2 THE BODY MOUNT STEEL WASHER PLATES WITH RUBBER CUSHIONS ARE REUSED BETWEEN THE BODY MOUNT AND THE NERF BAR MOUNTING BRACKET.
4. POSITION THE NERF BAR ASSEMBLY UP UNDER THE VEHICLE AND ATTACH THE FRONT AND REAR BRACKETS TO THE BODY MOUNTS WITH FACTORY BODY MOUNT BOLTS AS SHOWN.
 - 4.1. TORQUE ALL BODY MOUNT BOLTS TO 65 LB. FT.

SERVICE PARTS LIST

ITEM	PART NO.	QTY	DESCRIPTION
1	552218	2	NERF BAR WLDMT-LH/RH,SST, BLK, 430711
2	552032	2	BRKT MTG NERF BAR- RH/LH FRONT
3	552217	2	BRKT MTG NERF BAR- RH/LH REAR
4	104249	4	BOLT-HEX HD CAP, SERRFLG, 1/2 X 2.00"LG,ZP



(A LUVERNE Company)

1200 E. Birch St.

Brandon, SD 57005

552216 SHEET 1 21DEC12

SERVICE PARTS LIST

MODEL NO.430711

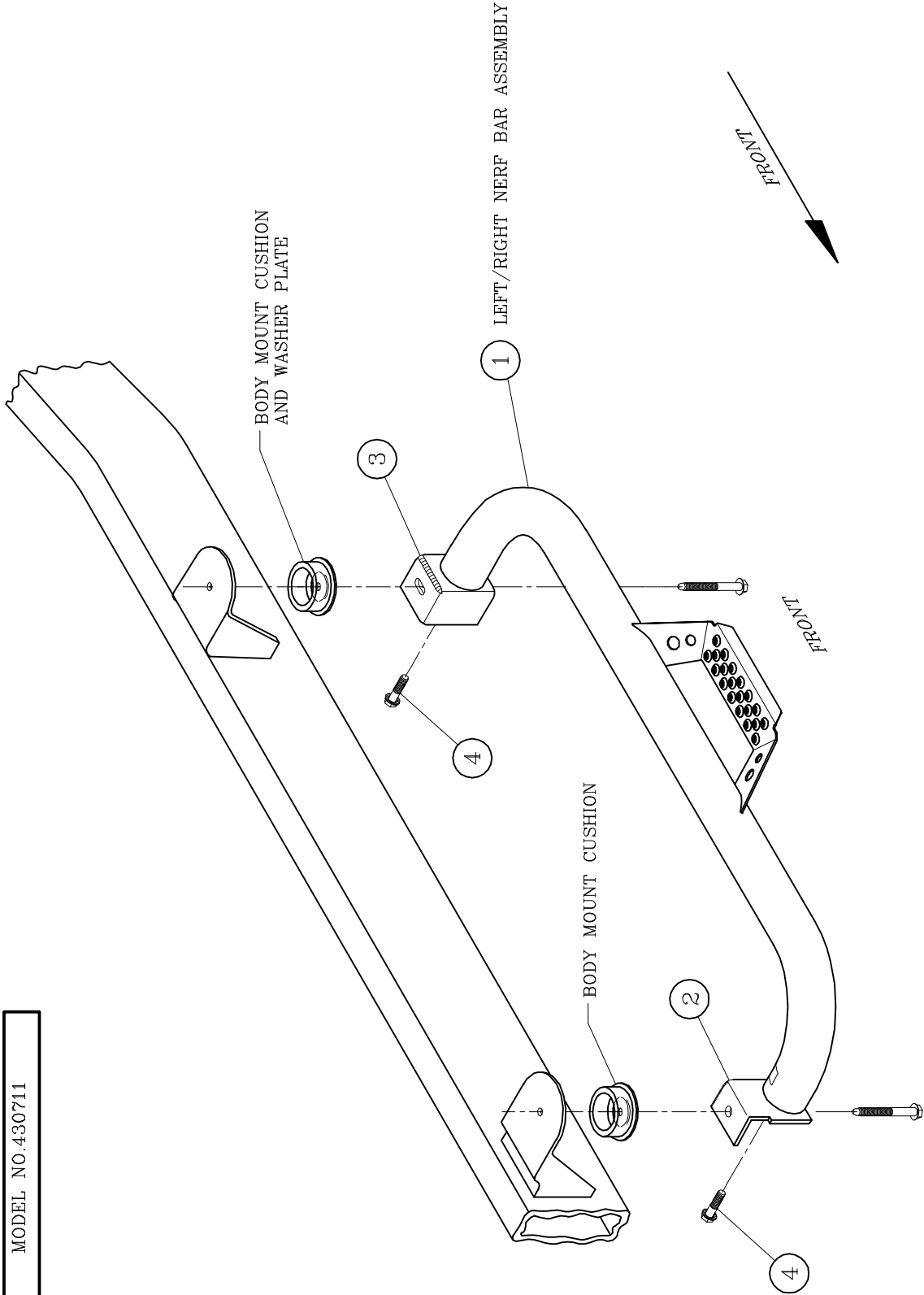

LEFT (DRIVER) SIDE SHOWN
- RIGHT (PASSENGER) SIDE OPPOSITE -