

AC-9212-01

2016-UP CAN-AM DEFENDER SPEAKER BAR

MBRP®

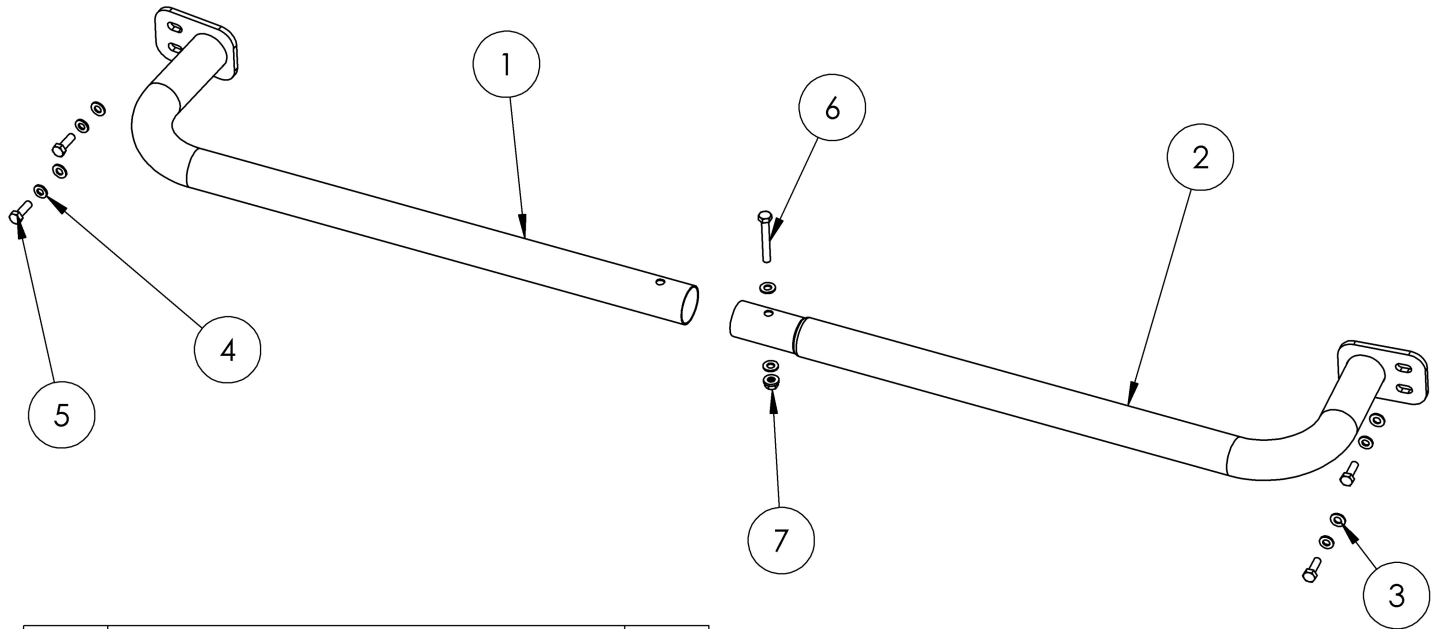

ITEM	DESCRIPTION	QTY
1	DRIVER-SIDE SPEAKER BAR	1
2	PASSENGER-SIDE SPEAKER BAR	1
3	M8 WASHER	6
4	M8 LOCK WASHER	4
5	M8 X 25 MM HEX BOLT	4
6	M8 X 60 MM HEX BOLT	1
7	M8 FLANGE NUT	1

Refer to this LOT NUMBER when contacting customer service: _____

PLEASE READ BEFORE STARTING INSTALLATION

While MBRP has made every effort to ensure that all components of this system are of superior quality and properly packaged, it is the installer's responsibility to ensure the following before removal of the factory exhaust:

- that ALL components shown above are present.
- that ALL mating components fit together.
- that there are no damaged components.
- that the system you have purchased is appropriate for your vehicle year, model and configuration.
- that the system will not interfere with any modifications previously installed or planned.
- that you have read and understand these instructions.

If you have any questions or are uncertain about any aspect of the installation of this system to your vehicle please contact your dealer before commencing installation.

MBRP

Removal of stock hardware



Figure 1

1. Remove the four (4) Torx-head bolts from the top corner mounting tabs (if equipped).
Refer to Figure 1.

Installation of MBRP Speaker-Bar



Figure 2

1. Insert the **Passenger-Side Speaker Bar** into the **Driver-Side Speaker Bar** and line up the center bolt holes.
2. Attach the **Passenger-Side** and **Driver-Side Speaker Bar** together using the **M8 X 60 MM Hex Bolt** and the **M8 Flange Nut** with one (1) **M8 Washer** on each side.
3. Using an **M8 X 25 MM Hex Bolt** with an **M8 Lock Washer** and an **M8 Washer**, in each bolt hole, attach the assembled **Speaker Bar** onto the vehicle mounting tabs.
Refer to Figure 2
4. Tighten down the four (4) **M8 X 25 MM Hex Bolts**, and the center **M8 X 60 MM Hex Bolt**. Once this is done, the **Speaker Bar** installation is complete. You can attach the speakers of your choice! Just ensure the speakers accept a 1.75" mounting bar. Periodically check that all fasteners and accessories are tight to prevent damage or loss.

Congratulations! You are ready to begin experiencing your **MBRP** Ltd. ATV accessory. We know you will enjoy your purchase.

