

## AT-6501SP

99-00 DIESEL 455 4X4  
99 INTERNATIONAL DIESEL  
99-00 SPORTMAN 355 4X4  
97 SPORTSMAN 400L 4X4  
96-00 SPORTSMAN 500 4X4/500 4X4 ALL MODELS  
99 WORKER 355 4X4/500 4X4 EBS  
97 XPLOER 500 4X4

# MBRP

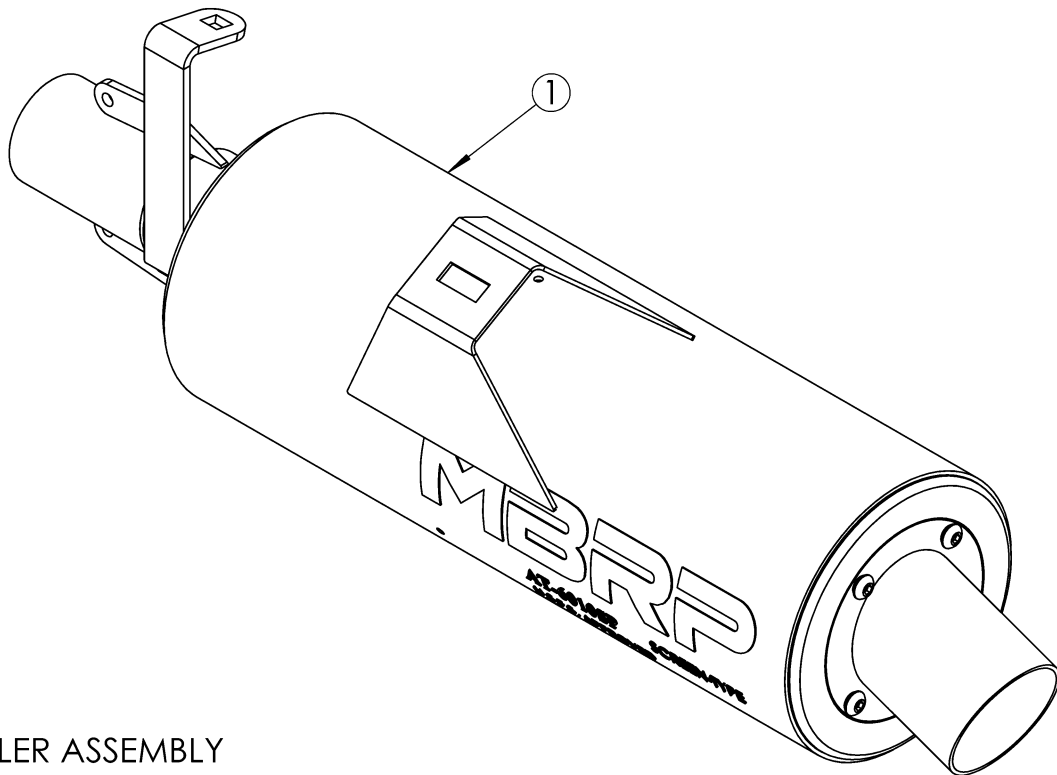

### 1. MUFFLER ASSEMBLY

## PLEASE READ BEFORE STARTING INSTALLATION

While MBRP Inc. has made every effort to ensure that all components of this system are of superior quality and properly packaged, it is the installer's responsibility to ensure the following before removal of the factory exhaust:

- that ALL components shown above are present.
- that ALL mating components fit together.
- that there are no damaged components.
- that the system you have purchased is appropriate for your vehicle year, model and configuration.
- that the system will not interfere with any modifications previously installed or planned.
- that you have read and understand these instructions.

If you have any questions or are uncertain about any aspect of the installation of this system to your vehicle please contact your dealer before commencing installation.



### Removal of Stock Exhaust

1. Remove the springs securing the main muffler inlet to the exhaust pipe. Do not discard the springs.
2. Remove bolts attaching the muffler to the bike and remove the muffler. Do not discard the bolts.

### Installation of MBRP Exhaust

1. Position the **Muffler** inlet onto the end of the exhaust pipe and secure it using the springs previously removed.
2. Attach the **Muffler** brackets using the previously removed stock bolts.

**Congratulations!** You are ready to begin experiencing the improved performance and driving excitement of your **MBRP** Ltd. ATV Exhaust upgrade. We know you will enjoy your purchase.

# MBRP<sup>®</sup>



**Figure 1**



**Figure 2**



**Figure 3**



**Figure 4**

## Spark Arrester Maintenance

In order to maintain optimal performance, the spark arrester screen should be cleaned every 30-35 hours of use.

### Clean-out Instructions:

Make sure the vehicle is cool before completing the clean-out procedure.

1. Using a 1/8" hex key, remove the 4 screws securing the outlet cap. (Figure 1).
2. Remove the outlet cap to expose the spark arrester screen insert. (Figure 2)
3. Remove the screen insert. (Figure 3)
4. Using a wire brush, thoroughly brush the screen to remove residue. (Figure 4)
5. Replace the screen and cap.
6. Tighten the screws to 23 in-lbs (2.6 Nm).