

S5040

07-08 CHEV/GMC 1500, EXTENDED CAB
(5.5' & 6.5' BOX)/CREW CAB, 4.8L/5.3L/6.0L,
CAT BACK,

MBRP
INC.
PERFORMANCE EXHAUST

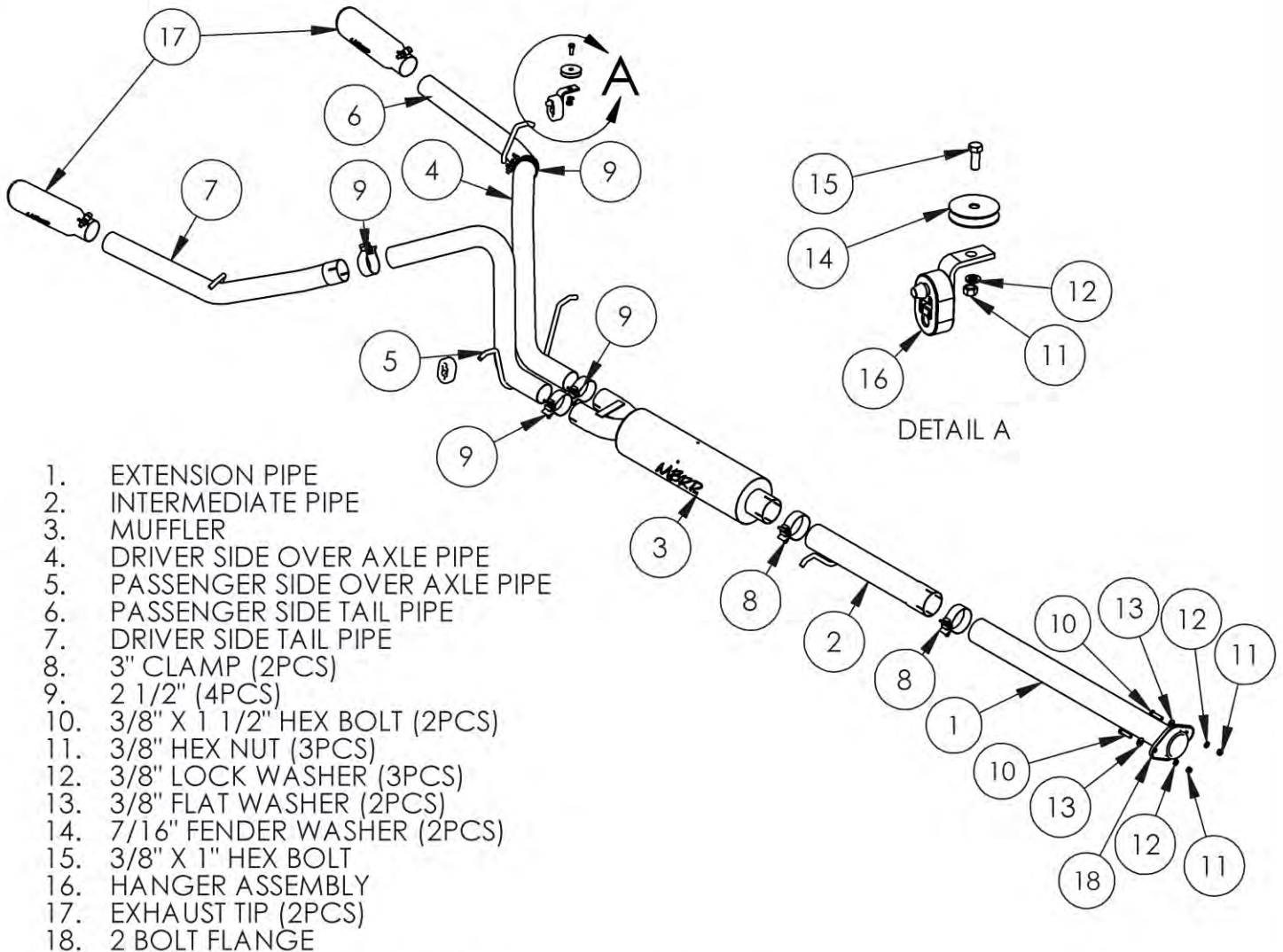

1. EXTENSION PIPE
2. INTERMEDIATE PIPE
3. MUFFLER
4. DRIVER SIDE OVER AXLE PIPE
5. PASSENGER SIDE OVER AXLE PIPE
6. PASSENGER SIDE TAIL PIPE
7. DRIVER SIDE TAIL PIPE
8. 3" CLAMP (2PCS)
9. 2 1/2" (4PCS)
10. 3/8" X 1 1/2" HEX BOLT (2PCS)
11. 3/8" HEX NUT (3PCS)
12. 3/8" LOCK WASHER (3PCS)
13. 3/8" FLAT WASHER (2PCS)
14. 7/16" FENDER WASHER (2PCS)
15. 3/8" X 1" HEX BOLT
16. HANGER ASSEMBLY
17. EXHAUST TIP (2PCS)
18. 2 BOLT FLANGE

NOTE: SADDLE CLAMPS USED IN ALUMINIZED SYSTEMS

PLEASE READ BEFORE STARTING INSTALLATION

While MBRP Inc. has made every effort to ensure that all components of this system are of superior quality and properly packaged, it is the installer's responsibility to ensure the following before removal of the factory exhaust:

- that ALL components shown above are present.
- that ALL mating components fit together.
- that there are no damaged components.
- that the system you have purchased is appropriate for your vehicle year, model and configuration.
- that the system will not interfere with any modifications previously installed or planned.
- that you have read and understand these instructions.

If you have any questions or are uncertain about any aspect of the installation of this system to your vehicle please contact your dealer before commencing installation.

Removal of Stock System



Figure 1

1. Apply a penetrating lubricant liberally to all exhaust fasteners, hangers and rubber insulators.

2. Remove the nuts from the studs holding the front flange and disconnect the exhaust system. **Refer to Figure 1.**



Figure 2

3. Remove the hangers from the rubber insulators and remove the exhaust from the vehicle. The tail pipe will need to be cut to clear the rear axle. **Refer to Figure 2 & 3.**

4. Remove the studs located on the exhaust flange. **Refer to Figure 1.**



Figure 3

Installation of MBRP Inc. Performance Exhaust

1. Slide the **2 Bolt Flange** over the **Extension Pipe** and install the **Extension Pipe** to the existing flange using the fasteners provided. Leave the hardware loose enough for some adjustment. Note that on the extended cab short bed (5'8") the **Extension Pipe** will need to be trimmed 9 1/2". **Refer to Figure 4.**



Figure 4



Figure 5

2. Slide a **3" Clamp** over the **Extension Pipe** and install the **Intermediate Pipe** onto the **Extension Pipe**. Attach the **Intermediate Pipe** to the factory rubber insulator. Refer to **Figure 5**.



Figure 6

3. Slide a **3" Clamp** over the inlet end of the **Muffler** and install to the **Intermediate Pipe**. Leave the **3" Clamp** loose enough for some adjustment. Refer to **Figure 6**.



Figure 7

4. Slide a **2 1/2" Clamp** onto the **Passenger Side Over Axle Pipe** and slide onto the passenger side of the **Muffler**. Attach the hanger to the factory rubber insulator.

5. Slide a **2 1/2" Clamp** onto the **Driver Side Over Axle Pipe** and slide onto the driver side of the **Muffler**. Attach the hanger to the factory rubber insulator. Refer to **Figure 7**.



Figure 8

6. Slide the **Driver Side Tail Pipe** hanger into the rearmost rubber insulator and reattach it to the frame. Slide a **2 1/2" Clamp** onto the **Driver Side Tail Pipe** and then attach it to the **Driver Side Over Axle Pipe**. Refer to **Figure 8**.

7. Slide a **2 1/2" Clamp** onto the **Passenger Side Tail Pipe** and then attach it to the **Passenger Side Over Axle Pipe**. Using the fasteners provided attach the **Hanger Assembly** to the bottom of the frame. Refer to **Figure 9**.



Figure 9



Figure 10

8. Install and adjust the **Exhaust Tips** to suit. Using a 17mm wrench tighten the lock bolt located on each **Exhaust Tip**. Refer to **Figure 10**.

9. Align the exhaust as required. Starting at the front of the exhaust, tighten all clamps and connections.

10. Check along the whole length of the exhaust system to ensure that there is adequate clearance around the spare tire, fuel and brake lines or any wiring. If any interference is detected relocate or adjust.



Congratulations! You are ready to begin experiencing the improved power, sound and driving experience of your MBRP Inc. performance exhaust system. We hope you enjoy your purchase.