

S5057

2021-UP CHEV/GMC TAHOE/YUKON, 5.3L/6.2L,
3" CAT-BACK, 2.5" DUAL SPLIT REAR, QUAD TIPS
REPLACES FACTORY DUAL EXHAUST

MBRP®

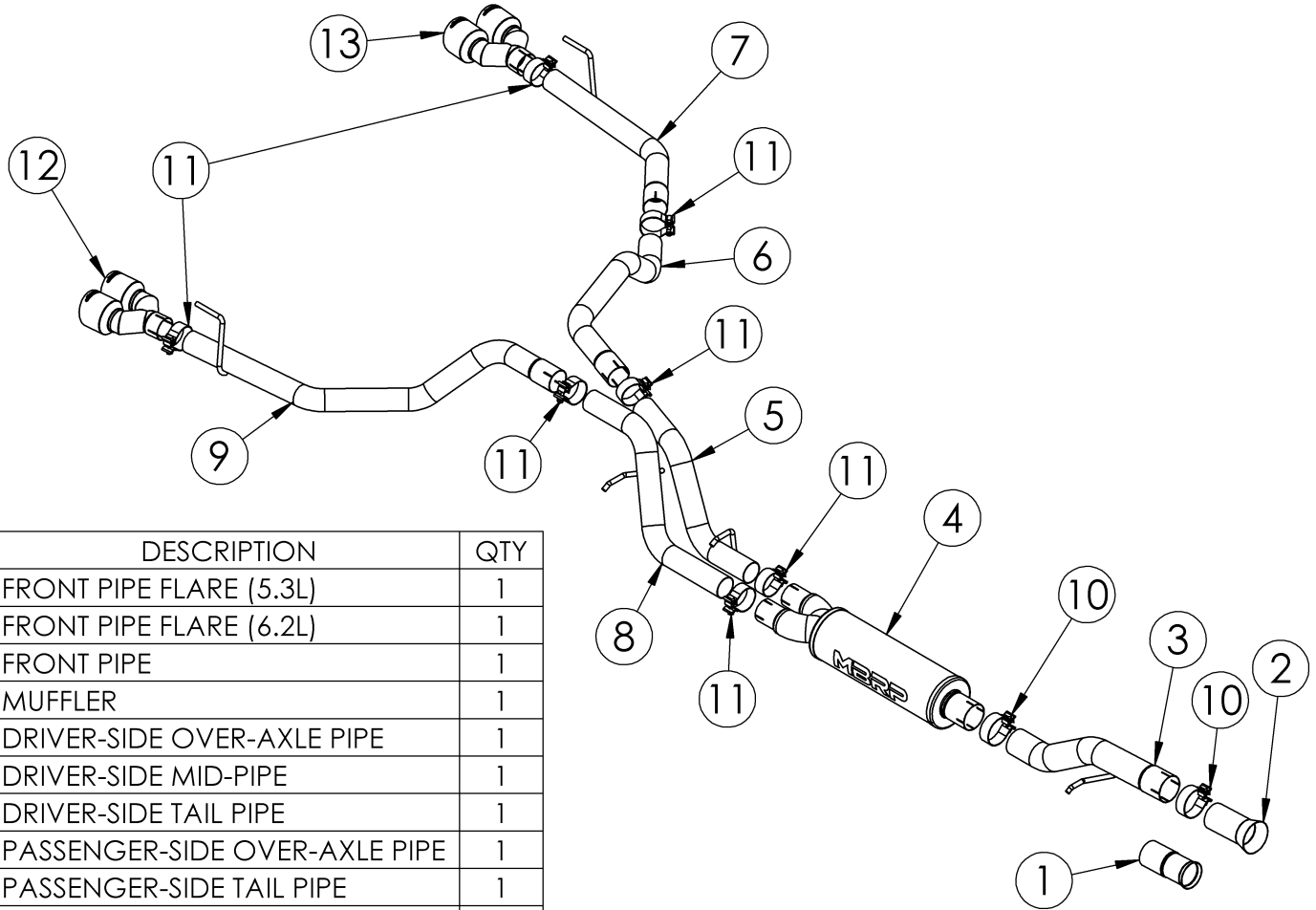

ITEM	DESCRIPTION	QTY
1	FRONT PIPE FLARE (5.3L)	1
2	FRONT PIPE FLARE (6.2L)	1
3	FRONT PIPE	1
4	MUFFLER	1
5	DRIVER-SIDE OVER-AXLE PIPE	1
6	DRIVER-SIDE MID-PIPE	1
7	DRIVER-SIDE TAIL PIPE	1
8	PASSENGER-SIDE OVER-AXLE PIPE	1
9	PASSENGER-SIDE TAIL PIPE	1
10	3.0" CLAMP	2
11	2.5" CLAMP	7
12	PASSENGER-SIDE TIP	1
13	DRIVER-SIDE TIP	1

Refer to this LOT NUMBER when contacting customer service: _____

PLEASE READ BEFORE STARTING INSTALLATION

While MBRP has made every effort to ensure that all components of this system are of superior quality and properly packaged, it is the installer's responsibility to ensure the following before removal of the factory exhaust:

- that ALL components shown above are present.
- that ALL mating components fit together.
- that there are no damaged components.
- that the system you have purchased is appropriate for your vehicle year, model and configuration.
- that the system will not interfere with any modifications previously installed or planned.
- that you have read and understand these instructions.

If you have any questions or are uncertain about any aspect of the installation of this system to your vehicle please contact your dealer before commencing installation.

MBRP

Removal of Stock System



Figure 1



Figure 2



Figure 3



Figure 4



Figure 5

1. Apply penetrating lubricant liberally to all exhaust fasteners, hangers, and rubber isolators. Lower the spare tire and remove all heat shields around the spare tire.

Refer to Figures 1 and 2.

2. Remove the two nuts securing the dual tail pipes. Unbolt the rear isolators and remove the tail pipe section from the vehicle.

Refer to Figure 3.

3. Remove the 4 bolts holding the sway bar to the frame and lower the sway bar.

Refer to Figure 4.

4. Remove the clamp after the catalytic converter and save the clamp for the installation.

Refer to Figure 5.

5. Remove the hangers from the rubber isolators and remove the exhaust from the vehicle. The exhaust must go forward past the connection point, then below the rear end and out towards the back of the vehicle.

Installation of MBRP Performance Exhaust

1. Using the factory clamp removed in Step 4, loosely attach the appropriate **Front Pipe Flare** (5.3L or 6.2L) onto the factory front pipe. Using a **3" Clamp**, loosely install the **Front Pipe** onto the flare and into the factory rubber isolator.

Refer to Figure 6.

2. Using a **3" Clamp**, loosely install the **Muffler** onto the **Front Pipe**.

3. Using a **2.5" Clamp**, loosely install the **Driver-Side Over-Axle Pipe** into the **Muffler** and into the factory isolator.

MBRP



Figure 6



Figure 7



Figure 8



Figure 9



Figure 10

4. Using a **2.5" Clamp**, loosely install the **Passenger-Side Over-Axle Pipe** into the **Muffler** and into the factory isolator.
Refer to Figure 7.

5. Using a **2.5" Clamp**, loosely install the **Driver-Side Mid Pipe** onto the **Driver-Side Over-Axle Pipe**.
Refer to Figure 8.

6. Install the rear rubber isolators onto the respective **Tail Pipes**. Loosely install the **Passenger-Side Tail Pipe** onto the **Passenger-Side Over-Axle Pipe** using a **2.5" Clamp**. Install the rubber isolator back onto the vehicle with the previously removed hardware.
Refer to Figure 9.

7. Using a **2.5" Clamp**, loosely install the **Driver-Side Tail Pipe** onto the **Driver-Side Mid Pipe**. Install the rubber isolator back onto the vehicle with the previously removed hardware.

8. Install the **Exhaust Tips** onto the **Tail Pipes** using the remaining **2.5" Clamps** and align to your liking.
Refer to Figure 10.

9. Ensure the **Front Pipe Hanger** is level where it passes through the rubber insulator. Align the edge of each band clamp with the edge of the joint it is connecting. Tighten all hardware and clamps, starting at the front and working rearward to secure the system. Check along the full length of the exhaust system to ensure there is adequate clearance for fuel lines, vent lines, brake lines, frame, bodywork, suspension, and any wiring, etc. If there is any interference detected, relocate, or adjust to provide adequate clearance. Ensure all clamp connections are secure and components are unable to rotate or slide. Band clamps require approximately 45 lb-ft (60 N-m) of torque. Verify clearances, system security and band clamp torque after 30-60 miles (50-100 km) of driving.

10. Re-install the heat shields and raise the spare tire into position ensuring adequate clearance to exhaust system. Re-install the sway bar and tighten to the manufacturer's specification.

Congratulations! You are ready to begin experiencing the improved power, sound and driving experience of your **MBRP** Performance Exhaust. We know you will enjoy your purchase.