

S5200P

2004-2008 FORD F150 4.6L/5.4L, EXTENDED (NOT 8' BED)/CREW (ALL BEDS) CAB,
CAT BACK, 3" SINGLE SIDE

MBRP

September 11, 2024

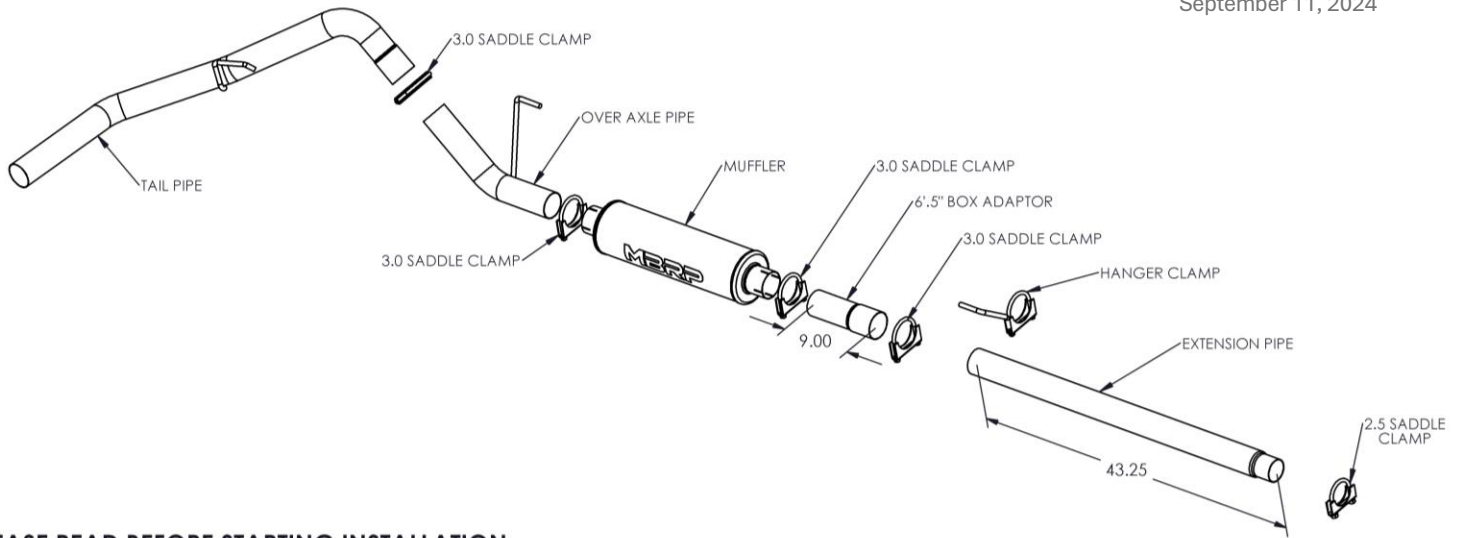

PLEASE READ BEFORE STARTING INSTALLATION

MBRP has made every effort to ensure that all components of this system are of superior quality and properly packaged. It is the installer's responsibility to ensure that all components are present and fit together as shown. Please also ensure that all components are undamaged before removal of the factory exhaust. Finally, check that this system properly matches the make and model of the vehicle and will not interfere with previous or planned modifications.

Removal of stock system:

1. Apply a penetrating lubricant liberally to all exhaust fasteners, hangers, and rubber insulators.
2. Loosen the clamp located behind the "Y" pipe at the slip joint.
3. Remove the hangers from the rubber insulators and remove the exhaust from the vehicle. If a hoist or hydraulic lift is not being used the tail pipe may need to be cut to clear the rear axle.

Installation of MBRP Performance Exhaust:

1. Using the **2.5" Clamp**, install the reduced end of the **Extension Pipe** over the factory exhaust system behind the "Y" pipe and install the muffler onto the **Extension Pipe** using a **3" Clamp**. Cut the **Extension Pipe** as follows: **Super Crew 5.5' box to 37"**, **Super Cab 6.5' box to 43.25"**, **Super Cab 5.5' box to 31"**. For **Super Crew 6.5' box**, connect the **Extension Pipe** and **6.5' Box Adaptor Pipe**, clamp together then cut to give a total length of **49.25"**. **Adaptor is only needed for Super Crew 6.5' box**.
2. Install the **Hanger Clamp** on the pipe in front of the **Muffler** and insert it into the factory rubber insulator located on the frame.
3. Using the **3" Clamps**, install the **Muffler** onto the **Extension Pipe** (or **Adaptor Pipe** if required), and install the **Over Axle Pipe** into the opposite end of the **Muffler**. Install the hanger into the factory rubber insulator located above the rear of the **Muffler**.
4. Feed the **Tail Pipe** over the axle and loosely attach it to the **Over Axle Pipe**. Install the **Tail Pipe** hanger into the factory rubber insulator located directly above the hanger.
5. Align the exhaust as required. Tighten all hardware and clamps, starting at the front and working rearward to secure the system. Check along the full length of the exhaust system to ensure there is adequate clearance for fuel lines, vent lines, brake lines, frame, bodywork, suspension, and any wiring, etc. If there is any interference detected, relocate, or adjust to provide adequate clearance. Ensure all clamp connections are secure and components are unable to rotate or slide. Band clamps require approximately 45 lb-ft (60 N-m) of torque. Verify clearances, system security and band clamp torque after 30-60 miles (50-100 km) of driving.

Congratulations! You are ready to begin enjoying the improved performance and driving experience of your **MBRP Performance Exhaust** system. We hope you enjoy your purchase.