

S5326

05-15 TOYOTA TACOMA, 4.0L,
EXTENDED/CREW CAB, CAT BACK, 2.5" SINGLE
SIDE, EXC. X-RUNNER

MBRP

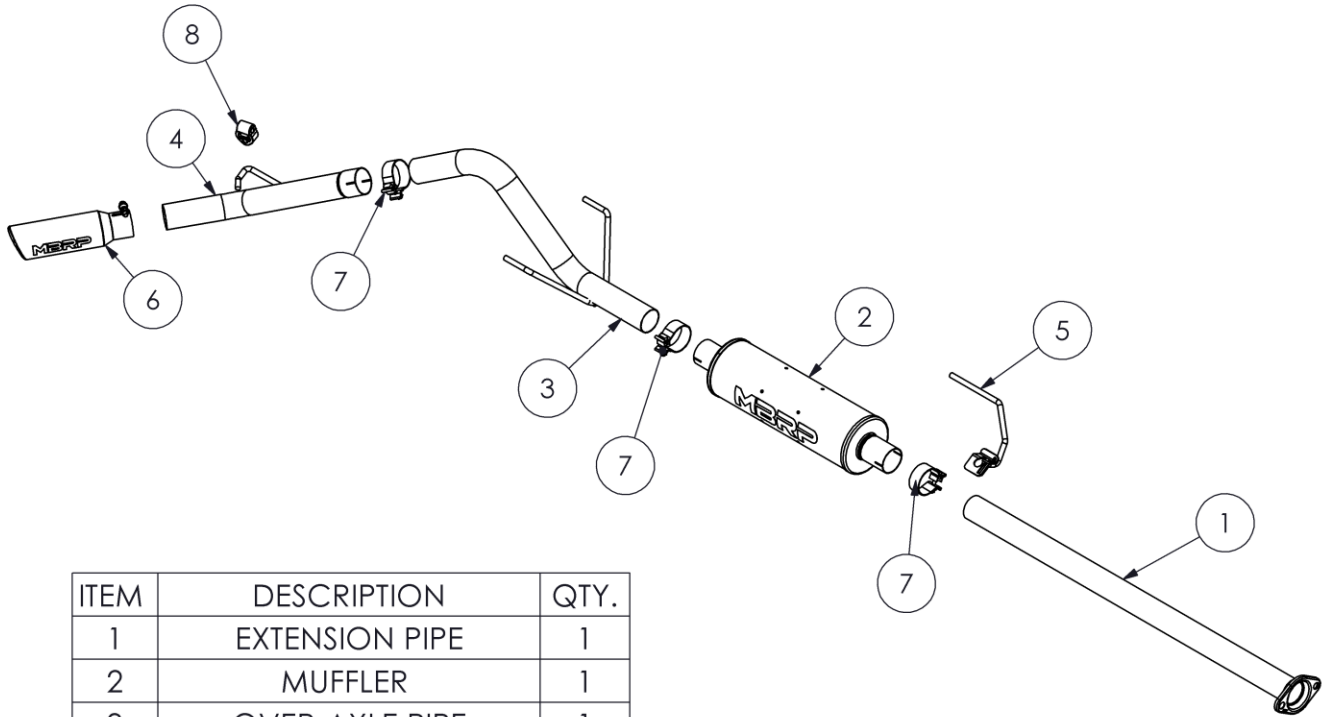

ITEM	DESCRIPTION	QTY.
1	EXTENSION PIPE	1
2	MUFFLER	1
3	OVER-AXLE PIPE	1
4	PASSENGER-SIDE TAIL	1
5	HANGER CLAMP ASSY	1
6	EXHAUST TIP	1
7	2.5" CLAMP	3
8	90° RUBBER INSULATOR	1

PLEASE READ BEFORE STARTING INSTALLATION

While MBRP has made every effort to ensure that all components of this system are of superior quality and properly packaged, it is the installer's responsibility to ensure the following before removal of the factory exhaust:

- that ALL components shown above are present.
- that ALL mating components fit together.
- that there are no damaged components.
- that the system you have purchased is appropriate for your vehicle year, model and configuration.
- that the system will not interfere with any modifications previously installed or planned.
- that you have read and understand these instructions.

If you have any questions or are uncertain about any aspect of the installation of this system to your vehicle please contact your dealer before commencing installation.

MBRP



Figure 1

Removal of Stock System:

1. Apply a penetrating lubricant liberally to all exhaust fasteners, hangers and rubber insulators.

2. Remove the bolts and springs holding the front flange together and disconnect exhaust system. Do not discard this hardware as it is used for the installation. **Refer to Figure 1.**

3. Remove the hangers from the rubber insulators and remove the exhaust from the vehicle. If a hoist or hydraulic lift is not being used the tail pipe may need to be cut to clear the rear axle. **Refer to Figure 2.**



Figure 2

Installation of MBRP Performance Exhaust:

1. Using the bolts previously removed from the flange slide the springs over the bolts and loosely attach the **Extension Pipe** to the flange using the fasteners.

Refer to Figure 3.

Note: The **Extension Pipe** will need to be trimmed on some models. Refer to the illustration below.



Figure 3

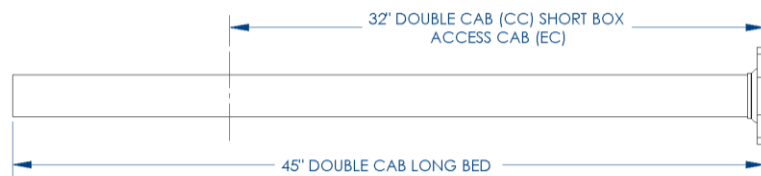

2. Install the **Hang Tight™** Hanger onto a **2.5" Band Clamp** using the procedure shown below. (Hang Tight™ Hanger not exactly as shown)



Figure 4

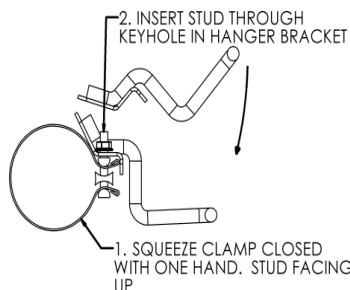

3. ROTATE HANGER BRACKET TO SEAT THREADED STUD IN SLOT. BE SURE THE NUT IS ABOVE THE BRACKET

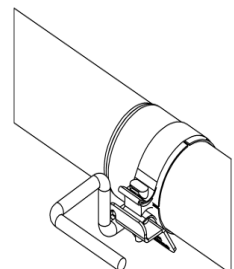
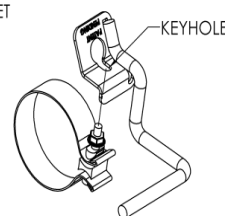

AS INSTALLED ON VEHICLE

MBRP



Figure 5



Figure 6



Figure 7



3. Install the **Hang Tight™ Hanger** assembly over the **Extension Pipe** and into the OEM rubber isolator located on the frame near the end of the **Extension Pipe**. Refer to **Figure 4**.

4. Install the **Muffler** over the **Extension Pipe** using the **Hang Tight™ Hanger** assembly to secure the **Muffler** and the **Extension Pipe**.

5. Slide **2.5\"** **Band Clamp** over the outlet side of the **Muffler**. Install the **Over-Axle Pipe** into the **Muffler** and position it using the two **OEM** rubber isolators located on the frame. Slide the **2.5\"** **Band Clamp** to secure the **Over-Axle Pipe**.

6. Slide the **2.5\"** **Band Clamp** over the **Tail Pipe's** expanded side and Install onto the **Over Axle Pipe**. Position the **Tail Pipe** by installing the hanger onto OEM rubber insulator. Slide the **2.5\"** **Band Clamp** to secure the **Tail Pipe** and the **Over-Axle Pipe**. Refer to **Figure 5**.

NOTE: 2013 and newer models require the removal of the factory rubber insulator and the installation of the 90° Rubber Insulator to the outside frame mount
Refer to **Figure 6**.

7. Install and adjust the **Exhaust Tip** to suit. Tighten the lock bolt located on the **Exhaust Tip**. Refer to **Figure 7**.

8. Align the exhaust as required. Check along the whole length of the exhaust system all hardware and clamps, starting at the front and working rearward to secure the system. Check along the full length of the exhaust system to ensure there is adequate clearance for fuel lines, vent lines, brake lines, frame, bodywork, suspension, and any wiring, etc. If there is any interference detected, relocate, or adjust to provide adequate clearance.

9. Ensure all clamp connections are secure and components are unable to rotate or slide. Band clamps require approximately 45 lb-ft (60 Nm) of torque. Verify clearances, system security and band clamp torque after 30-60 miles (50-100 km) of driving.

Congratulations! You are ready to begin experiencing the improved power, sound and driving excitement of your **MBRP** performance exhaust system. We know you will enjoy your purchase.