

S5340

2016-2023 TOYOTA TACOMA, 3.5L,
CAT BACK, 3.0" DUAL SPLIT SIDE

MBRP®

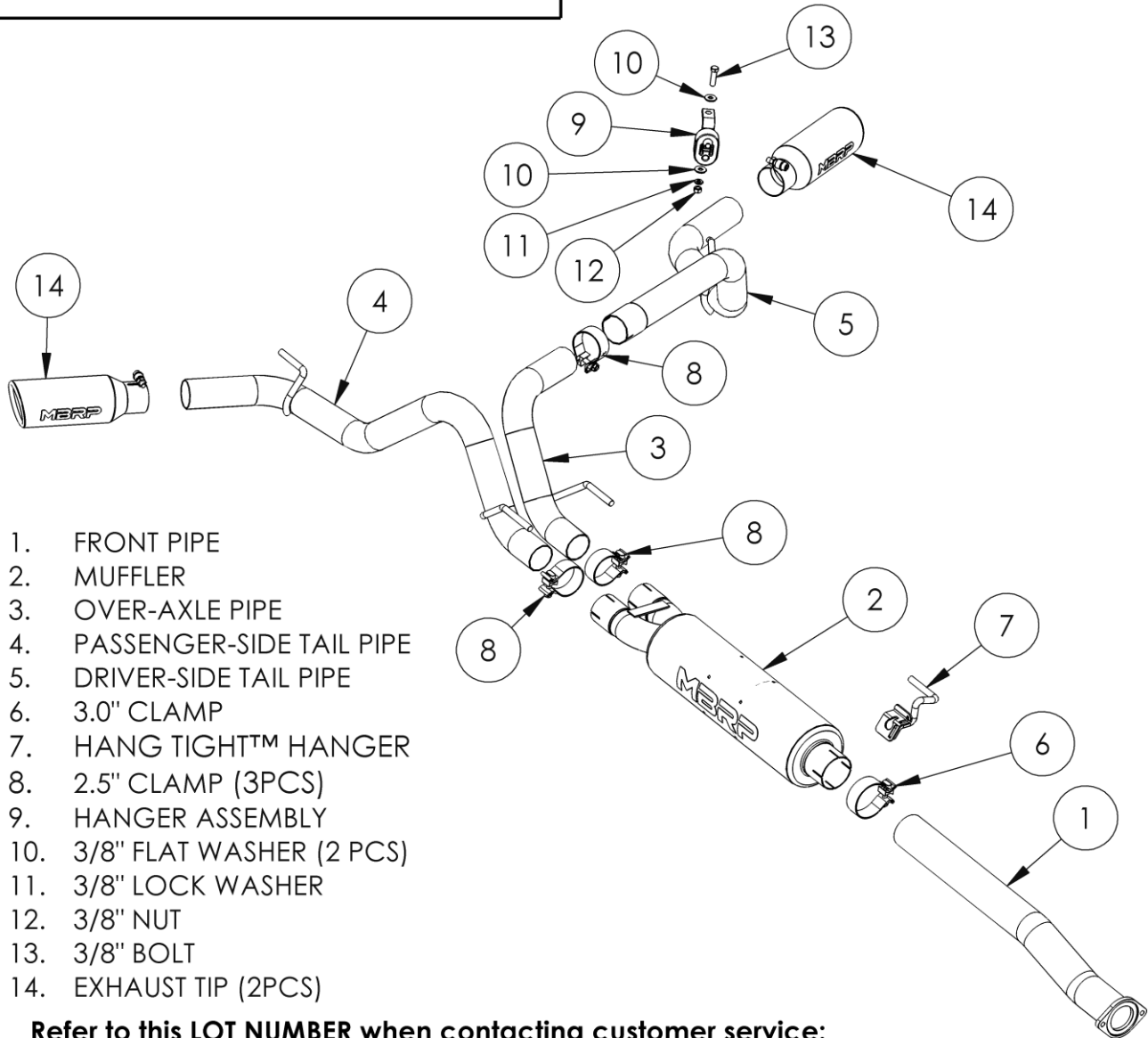

1. FRONT PIPE
2. MUFFLER
3. OVER-AXLE PIPE
4. PASSENGER-SIDE TAIL PIPE
5. DRIVER-SIDE TAIL PIPE
6. 3.0" CLAMP
7. HANG TIGHT™ HANGER
8. 2.5" CLAMP (3PCS)
9. HANGER ASSEMBLY
10. 3/8" FLAT WASHER (2 PCS)
11. 3/8" LOCK WASHER
12. 3/8" NUT
13. 3/8" BOLT
14. EXHAUST TIP (2PCS)

Refer to this LOT NUMBER when contacting customer service: _____

PLEASE READ BEFORE STARTING INSTALLATION

While MBRP has made every effort to ensure that all components of this system are of superior quality and properly packaged, it is the installer's responsibility to ensure the following before removal of the factory exhaust:

- that ALL components shown above are present.
- that ALL mating components fit together.
- that there are no damaged components.
- that the system you have purchased is appropriate for your vehicle year, model and configuration.
- that the system will not interfere with any modifications previously installed or planned.
- that you have read and understand these instructions.

If you have any questions or are uncertain about any aspect of the installation of this system to your vehicle please contact your dealer before commencing installation.

MBRP

Removal of Stock System:



Figure 1

1. Apply a penetrating lubricant liberally to all exhaust fasteners, hangers and rubber insulators.

2. Support the factory Y-pipe and remove the bolts holding the front flange together and disconnect exhaust system. Do not discard this hardware as it is used for the installation. Ensure the factory gasket remains in place.

Refer to Figures 1 & 2.

3. Remove the hangers from the rubber insulators and remove the exhaust from the vehicle. If a hoist or hydraulic lift is not being used the tail pipe may need to be cut to clear the rear axle.

Installation of MBRP Performance Exhaust:



Figure 2

1. Attach the **Front Pipe** to the flange using the factory fasteners. **Refer to Figure 3.**

Note: The **Front Pipe** will need to be trimmed on some models. Refer to the illustration below.



Figure 3

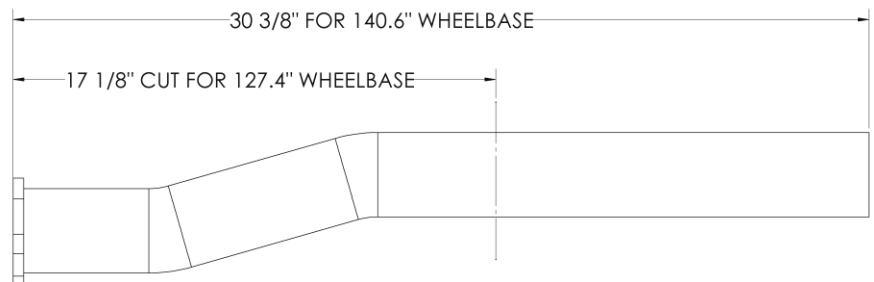
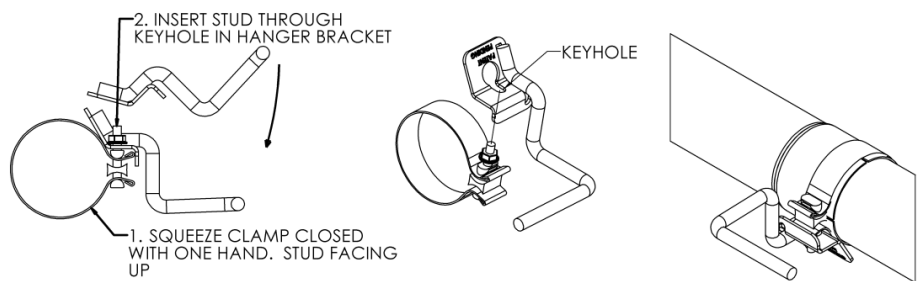

Figure 4

2. Install the **Hang Tight™ Hanger** onto a **3.0\"**



3. ROTATE HANGER BRACKET TO SEAT THREADED STUD IN SLOT. BE SURE THE NUT IS ABOVE THE BRACKET

3. Install the **Muffler** onto the **Front Pipe** using the **Hang Tight™ Hanger Clamp Assembly**. Then install the hanger into the factory rubber insulator. Do not tighten the **Clamp** at this time.

Refer to Figure 4.

MBRP



Figure 5

4. Loosely install the **Over-Axle Pipe**, connecting it to the **Muffler** driver-side outlet with a **2 .5” Clamp**. Install the hanger into the rubber insulator located above the **Over-Axle Pipe**.
Refer to Figure 5.



Figure 6

5. Place the **Hanger Assembly** onto the **Driver-Side Tail Pipe** hanger.
Refer to Figure 6.



Figure 7

6. Using a **2.5” Clamp**, connect the expanded end of the **Driver-Side Tail Pipe** to the **Over-Axle Pipe**, keeping brake flex lines in front of the pipe.
Refer to Figure 7.

Note: You will need to tie the flex lines back from the pipe for adequate clearance. Ensure the flex lines will not be stressed during suspension movement.



Figure 8

7. Move the **Driver-Side Tail Pipe** into approximate position. Using the factory hole provided in the frame located directly above the tail pipe hanger, attach the **Hanger Assembly** using the **supplied hardware**.
Refer to Figure 8.

MBRP



Figure 9

8. Loosely install the **Passenger-Side Tail Pipe** into the passenger-side muffler outlet using a **2.5" Clamp**.

Refer to Figure 9.



Figure 10

9. Install the **Passenger-Side Tail Pipe** hangers into the insulators located above them.

Refer to Figures 9 and 10.



Figure 11

10. Install and adjust the **Exhaust Tips** to suit. Tighten the lock bolt located on each **Exhaust Tip**.

Refer to Figures 11 and 12.



Figure 12

11. Carefully align the system and tips. Align the edge of each band clamp with the edge of the joint it is connecting. Tighten all hardware and clamps, starting at the front and working rearward to secure the system. Check along the full length of the exhaust system to ensure there is adequate clearance for fuel lines, vent lines, brake lines, frame, bodywork, suspension and any wiring, etc. If there is any interference detected, relocate or adjust to provide adequate clearance.

Ensure all clamp connections are secure and components are unable to rotate or slide. Band clamps require approximately 45 lb-ft (60 N-m) of torque. Verify clearances, system security and band clamp torque after 30-60 miles (50-100 km) of driving.

Congratulations! You are ready to begin experiencing the improved power, sound and driving excitement of your **MBRP** performance exhaust system. We know you will enjoy your purchase.