

# S6000

2001-2005 CHEV/GMC 2500/3500,  
EXTENDED CAB/CREW CAB, 6.6L DURAMAX,  
Cat-Back, 4.0" Single Side, ,

# MBRP®

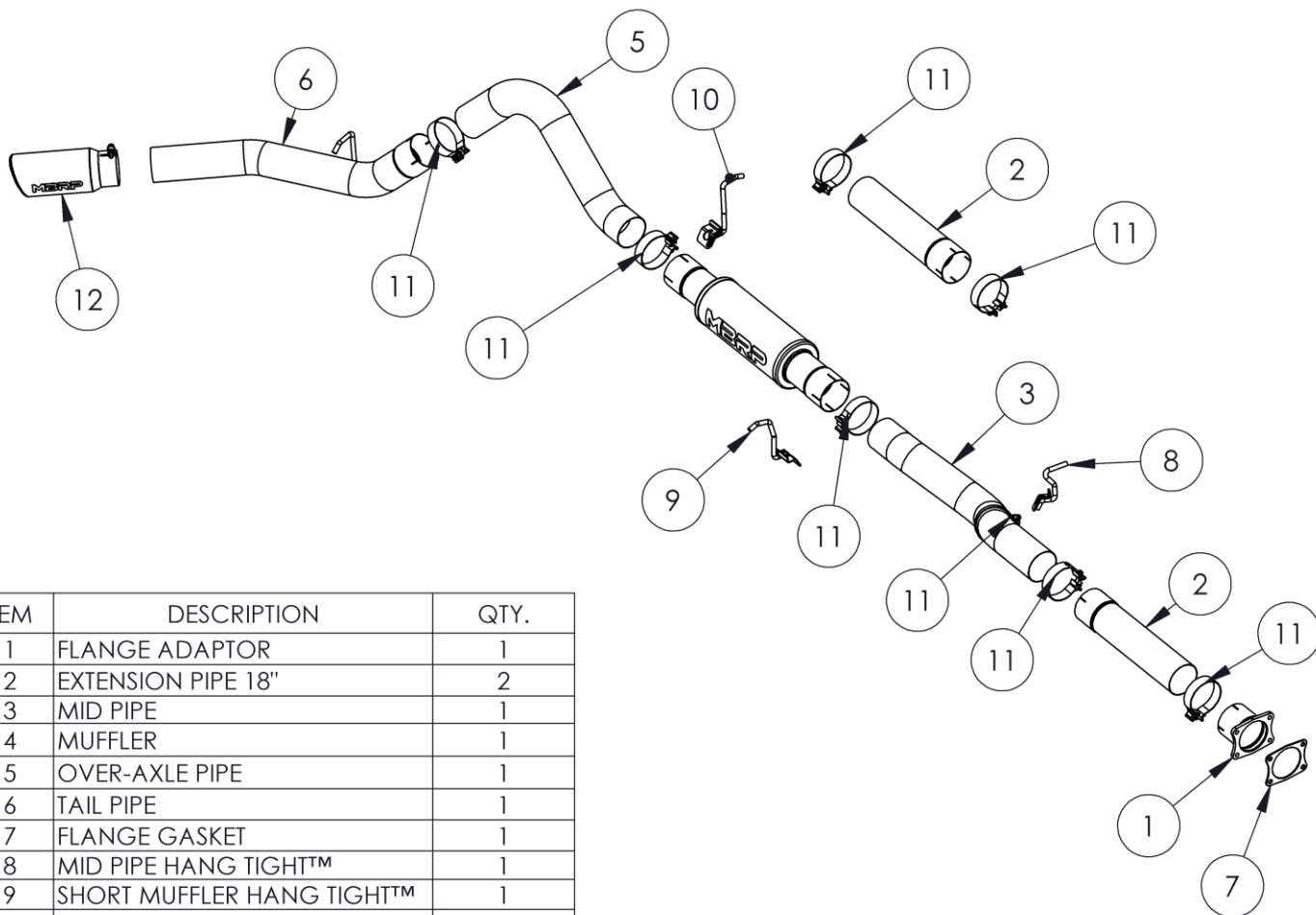

ITEM	DESCRIPTION	QTY.
1	FLANGE ADAPTOR	1
2	EXTENSION PIPE 18"	2
3	MID PIPE	1
4	MUFFLER	1
5	OVER-AXLE PIPE	1
6	TAIL PIPE	1
7	FLANGE GASKET	1
8	MID PIPE HANG TIGHT™	1
9	SHORT MUFFLER HANG TIGHT™	1
10	LONG MUFFLER HANG TIGHT™	1
11	4" BAND CLAMP	8
12	EXHAUST TIP	1

Refer to this LOT NUMBER when contacting customer service: \_\_\_\_\_

## PLEASE READ BEFORE STARTING INSTALLATION

While MBRP has made every effort to ensure that all components of this system are of superior quality and properly packaged, it is the installer's responsibility to ensure the following before removal of the factory exhaust:

- that ALL components shown above are present.
- that ALL mating components fit together.
- that there are no damaged components.
- that the system you have purchased is appropriate for your vehicle year, model and configuration.
- that the system will not interfere with any modifications previously installed or planned.
- that you have read and understand these instructions.

If you have any questions or are uncertain about any aspect of the installation of this system to your vehicle please contact your dealer before commencing installation.

# MBRP®

## Installation Instructions

### Removal of Stock System:



Figure 1



Figure 2



Figure 3



Figure 4

(Hanger may not be as shown)

1. Apply a penetrating lubricant liberally to all exhaust fasteners, hangers and rubber insulators.
2. Using a 15mm socket or wrench, disconnect the factory exhaust system at the four-bolt flange located behind the catalytic converter. If the vehicle is not equipped with a catalytic converter disconnect the four-bolt flange located approximately under the passenger side seat. Refer to Figure 1. **Do not discard these nuts as they are required for the installation.**
3. Remove the exhaust system from the rubber insulators and remove from under the vehicle. If a hoist is not available for use, it may be necessary to cut the tail pipe behind the muffler for removal of the system.

### Installation of MBRP Ltd. Performance Exhaust:

1. Place the **Gasket** provided over the studs located on the factory four bolt flange. Attach the **Flange Adaptor** to the four-bolt flange using the existing hardware. Refer to Figure 2.
2. Install the **Extension Pipe** into the **Flange Adaptor** and loosely install a **4" Band Clamp**. The **Extension Pipe** does not require cutting to fit Crew Cab trucks. For extended cab trucks, approximately 9½" needs to be cut off the straight section of pipe. (**Installation tip:** Temporarily hang the **Mid Pipe** and **Muffler** in place and measure to the **Flange Adaptor** to verify the length required).
3. Install the **Mid Pipe** into the **Extension Pipe** placing the bend around, under the cross member. Rotate the pipe to position the bend towards the driveshaft. Refer to Figure 3.
4. Position **Mid Pipe** as shown and loosely install the **Mid Pipe Hang Tight™** (See Figure 9 for Hang Tight instructions and Figure 8 for Hanger clarification). Refer to Figure 4.

# MBRP®



**Figure 5**



**Figure 6**

(Hanger may not be as shown)



**Figure 7**

5. Crew cab & extended cab long bed trucks require the use of the **18" Extension Pipe** provided. This is to be positioned between the **Muffler** and the **Mid Pipe**. The **18" Extension Pipe** is not required with short box trucks.
6. Install the **Short Muffler Hang Tight™** and **Muffler** onto the **Extension Pipe** or **Mid Pipe**. Refer to Figure 5.
7. Install the **Long Muffler Hang Tight™** at the connection between the **Muffler** and the **Over Axle Pipe** and into the OEM rubber hanger at this position. Do not install over Axle pipe yet. Refer to Figure 6.
8. Slide the **Tail Pipe** and **4" Band Clamp** onto the **Over Axle Pipe**. Install the assembly from the rear of the truck, over the axle and attach to the **Muffler Outlet**. Install the tail pipe hanger into the OEM hanger, adjust for best axle clearance and **Tail Pipe** exit location to complete. Refer to Figure 7.
9. Carefully align the system and tip. Align the edge of each band clamp with the edge of the joint it is connecting. Tighten all hardware and clamps, starting at the front and working rearward to secure the system. Check along the full length of the exhaust system to ensure there is adequate clearance for fuel lines, vent lines, brake lines, frame, bodywork, suspension and any wiring, etc. If there is any interference detected, relocate or adjust to provide adequate clearance.
10. Ensure all clamp connections are secure and components are unable to rotate or slide. Band clamps require approximately 45 lb-ft (60 Nm) of torque. Verify clearances, system security and band clamp torque after 30-60 miles (50-100 km) of driving.
11. Install and adjust **Tip** to suit. Tighten bolt located on **Tip**.

# MBRP®

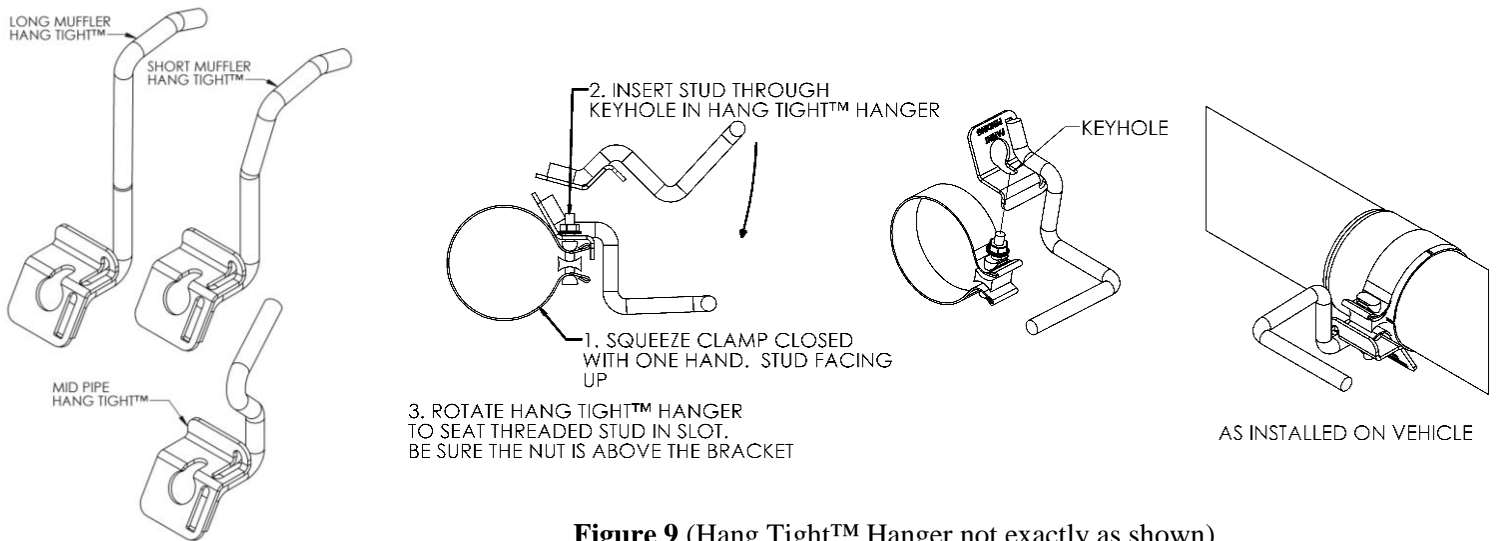

**Figure 8**

**Figure 9** (Hang Tight™ Hanger not exactly as shown)



"PRO SERIES" exhaust shown.

**Congratulations!** You are ready to begin enjoying the improved performance and driving experience of your **MBRP** Ltd. performance exhaust system. We know you will enjoy your purchase.