

S6006

2001-2004 2500/3500,
EXTENDED CAB /CREW CAB, 6.6L DURAMAX,
DOWN-PIPE BACK, 4.0" DUAL SPLIT SIDE
(EXCLUDES 2002-2004 CALIFORNIA MODELS)

MBRP®

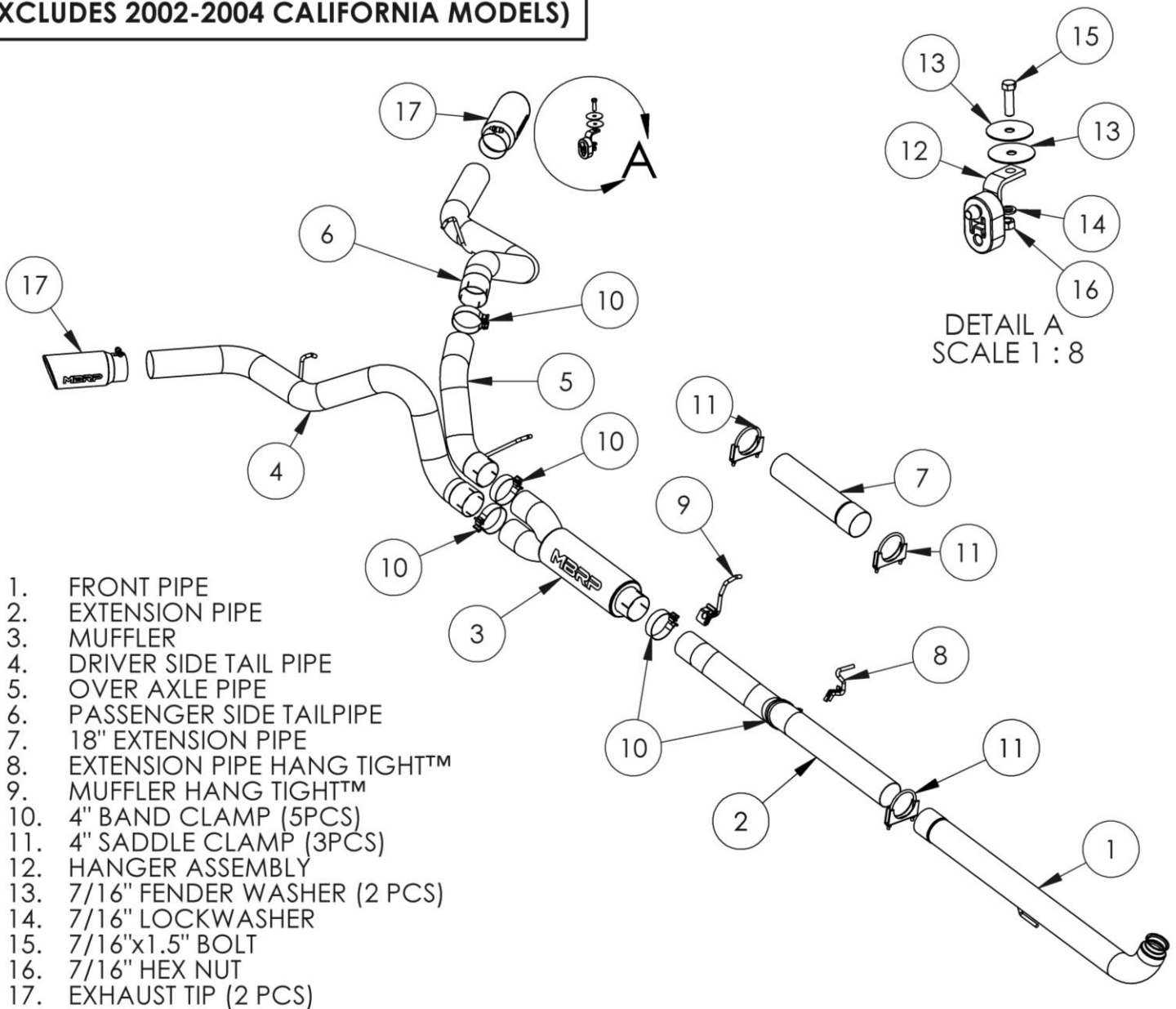

1. FRONT PIPE
2. EXTENSION PIPE
3. MUFFLER
4. DRIVER SIDE TAIL PIPE
5. OVER AXLE PIPE
6. PASSENGER SIDE TAILPIPE
7. 18" EXTENSION PIPE
8. EXTENSION PIPE HANG TIGHT™
9. MUFFLER HANG TIGHT™
10. 4" BAND CLAMP (5PCS)
11. 4" SADDLE CLAMP (3PCS)
12. HANGER ASSEMBLY
13. 7/16" FENDER WASHER (2 PCS)
14. 7/16" LOCKWASHER
15. 7/16"x1.5" BOLT
16. 7/16" HEX NUT
17. EXHAUST TIP (2 PCS)

PLEASE READ BEFORE STARTING INSTALLATION

While MBRP has made every effort to ensure that all components of this system are of superior quality and properly packaged, it is the installer's responsibility to ensure the following before removal of the factory exhaust:

- that ALL components shown above are present.
- that ALL mating components fit together.
- that there are no damaged components.
- that the system you have purchased is appropriate for your vehicle year, model and configuration.
- that the system will not interfere with any modifications previously installed or planned.
- that you have read and understand these instructions.

If you have any questions or are uncertain about any aspect of the installation of this system to your vehicle please contact your dealer before commencing installation.



Figure 1



Figure 2



Figure 3

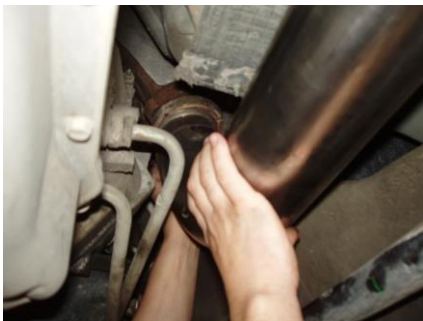

Figure 4

Removal of Stock System:

1. Apply penetrating lubricant liberally to all exhaust fasteners, hangers and rubber insulators.
2. Disconnect four bolt flange located approximately under the passenger seat. **See Figure 1.**
3. Remove the exhaust system from the rubber insulators and remove from under the vehicle. If a hoist is not available for use it may be necessary to cut the tail pipe behind the muffler for removal of the system.
4. Unbolt the OEM hanger from the transmission and remove. **Do not discard the hanger as it is required for the installation. See Figure 2.**
5. Loosen the factory band clamp and remove the stock front pipe. **See Figure 3. Do not discard the band clamp as it is required for the installation.**

MBRP®

Installation of MBRP Performance Exhaust:

Note: Vehicles originally equipped with a catalytic converter must retain the factory catalytic converter. Removal of the catalytic converter may be a violation of federal or local regulations.



Figure 5



Figure 6



Figure 7

(Hanger may not be as shown)



Figure 8

1. Install the **Front Pipe** onto the factory down pipe using the band clamp removed previously. Do not fully tighten to allow for adjustment. **See Figure 4.**
2. Install the hanger removed previously by sliding the outside hole in the rubber insulator over the hanger on the **Front Pipe** and re-connect to the transmission. **See Figure 5.**
3. Connect the **Extension Pipe** to the **Front Pipe** at the slip joint placing the bend around and under the cross member. Rotate the **Extension Pipe** to position the bend towards the driveshaft. **See Figure 6.** The **Extension Pipe** does not require cutting to fit Crew Cab trucks. For Extended Cab trucks, approximately 9 ½" needs to be cut off the end with the shortest straight section of pipe. (**Installation tip:** Temporarily hang the **Muffler** and **Passenger Side Tail Pipe** in place and measure to the **Front pipe** from the **Muffler** to verify the length required).
4. Position the **Extension Pipe** as shown and loosely install the **Extension Pipe Hang Tight™** (see Hang Tight instruction in Figure 9). **See Figure 7.** This will support the **Extension Pipe** during the **Muffler** installation.

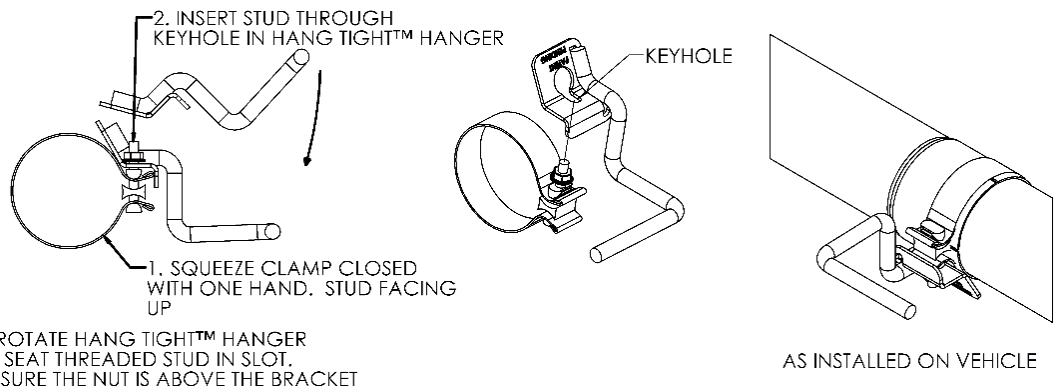

Figure 9

5. Crew Cab & Extended Cab long box trucks require the use of the **18" Extension Pipe** provided. This is to be positioned between the **Muffler** and the **Extension Pipe**. The **18" Extension Pipe** is not required with short box trucks.

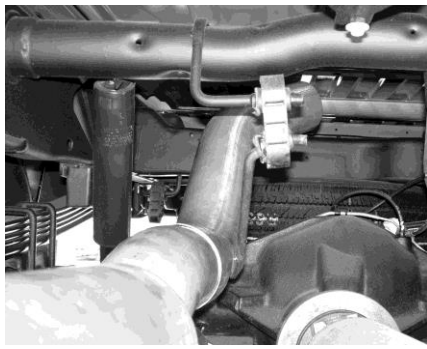

Figure 10



Figure 11



Figure 12



Figure 13

6. Install the **Muffler** on the **Extension Pipe** with the **Muffler Hang Tight™** and slide the hanger into the factory hanger. The **Muffler** outlets will be positioned vertically when installed. **See Figure 8.**
7. Install the **Over Axle Pipe** onto the top outlet of the **Muffler** and install the hanger into the OEM rubber hanger located above the **Muffler**. Adjust for maximum axle clearance. **See Figure 10.**
8. Install the **Driver Side Tailpipe** by feeding it around the outside of the shock absorber and connecting it to the **Over Axle Pipe**. Adjust for maximum clearance around shock absorber. **See Figure 11.**
9. Using the factory hole located in the frame, found directly above the tail pipe hanger, attach the **Hanger Assembly** provided using the supplied hardware. **See Figure 12.** Hang the **Driver's Side Tailpipe** from the installed **Hanger Assembly**.
10. Install the **Passenger Side Tail Pipe** from the rear of the truck, over the axle and attach to the lower outlet of the **Muffler**. Install the tail pipe hanger into the OEM hanger and adjust for maximum axle clearance to complete. **See Figure 13.**
11. Install remaining **Clamps** around pipes as shown in the opening diagram. Adjust **Tail Pipe** and Check along the whole length of the exhaust system all hardware and clamps, starting at the front and working rearward to secure the system. Check along the full length of the exhaust system to ensure there is adequate clearance for fuel lines, vent lines, brake lines, frame, bodywork, suspension, and any wiring, etc. If there is any interference detected, relocate, or adjust to provide adequate clearance.
12. Ensure all clamp connections are secure and components are unable to rotate or slide. Band clamps require approximately 45 lb-ft (60 Nm) of torque. Verify clearances, system security and band clamp torque after 30-60 miles (50-100 km) of driving.
13. Install and adjust the **Exhaust Tip** to suit.

Congratulations! You are ready to begin experiencing the improved power, sound and driving excitement of your **MBRP** performance exhaust system. We know you will enjoy your purchase.