

S60300

2007-2010 CHEV/GMC 2500/3500,
6.6L DURAMAX, FILTER BACK, 5.0" SINGLE
SIDE

MBRP®

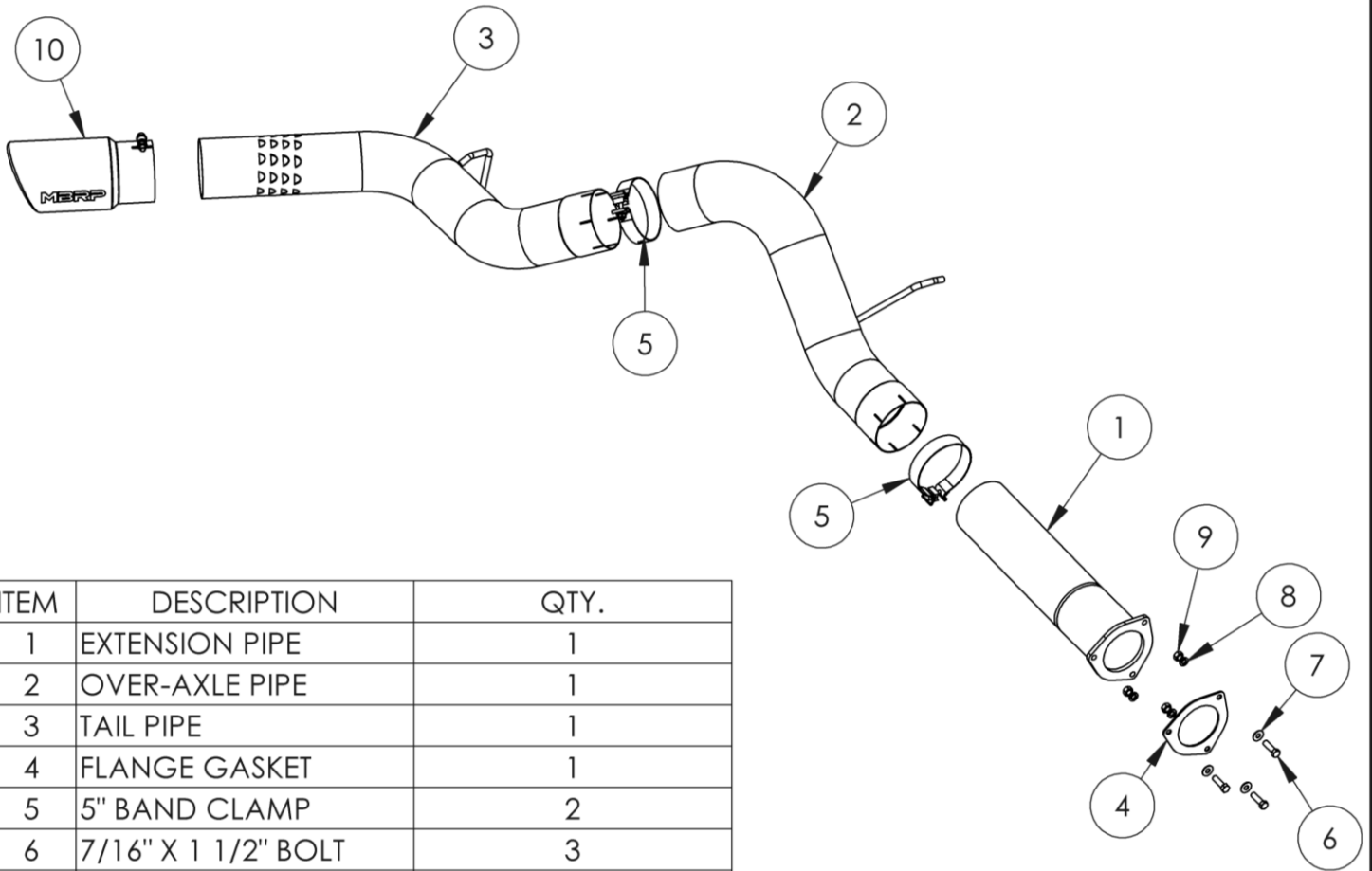

ITEM	DESCRIPTION	QTY.
1	EXTENSION PIPE	1
2	OVER-AXLE PIPE	1
3	TAIL PIPE	1
4	FLANGE GASKET	1
5	5" BAND CLAMP	2
6	7/16" X 1 1/2" BOLT	3
7	7/16" FLAT WASHER	3
8	7/16" LOCK WASHER	3
9	7/16" NUT	3
10	EXHAUST TIP	1

PLEASE READ BEFORE STARTING INSTALLATION

While MBRP has made every effort to ensure that all components of this system are of superior quality and properly packaged, it is the installer's responsibility to ensure the following before removal of the factory exhaust:

- that ALL components shown above are present.
- that ALL mating components fit together.
- that there are no damaged components.
- that the system you have purchased is appropriate for your vehicle year, model and configuration.
- that the system will not interfere with any modifications previously installed or planned.
- that you have read and understand these instructions.

If you have any questions or are uncertain about any aspect of the installation of this system to your vehicle please contact your dealer before commencing installation.

MBRP

Removal of stock system:



Figure 1

1. Apply a penetrating lubricant liberally to all exhaust fasteners, hangers and rubber isolators.

2. Remove the factory tail pipe assembly from the factory rubber isolators. **Refer to Figures 1 and 2.**



Figure 2

3. Cut the factory tail pipe as shown and remove the rear section. **Refer to Figure 3.**

4. Remove the three nuts at the muffler inlet flange and remove the muffler. **Refer to Figure 4.**



Figure 3



Figure 4

MBRP

Installation of MBRP Ltd. Performance Exhaust:



Figure 5



Figure 6



Figure 7



Figure 8

1. Install the three supplied **7/16" Bolts and** in the existing flange and place the supplied **Gasket** over the **7/16" Bolts**. Refer to **Figure 5**.
2. Install the **Extension Pipe** onto the flange. There is a slight bend in the **Extension Pipe**. The inside of this bend must face the driveshaft. If the outlet of the **Extension Pipe** angles slightly towards the driveshaft you have installed it correctly. Failure to install this pipe correctly will result in the **Tail Pipe** not fitting properly. Secure with the three supplied **7/16" Flat Washers**, three **7/16" Lock Washers** and three **7/16" Nuts**. Refer to **Figure 6**.
3. Slide a **5" Band Clamp** over the **Tail Pipe** and slide onto the **Over-Axle Pipe** and loosely tighten the clamp.
4. Slide the **5" Clamp** over the outlet of the **Extension Pipe**. Install the **Over-Axle Pipe/Tail Pipe** from the rear of the truck over the axle and slide on to the **Extension Pipe**. Install the **Tail Pipe** hangers into the factory rubber isolators. Refer to **Figure 7/8**.
5. Align the exhaust as required. Tighten all hardware and clamps, starting at the front and working rearward to secure the system. Check along the full length of the exhaust system to ensure there is adequate clearance for fuel lines, vent lines, brake lines, frame, bodywork, suspension, and any wiring, etc. If there is any interference detected, relocate, or adjust to provide adequate clearance. Ensure all clamp connections are secure and components are unable to rotate or slide. Band clamps require approximately 45 lb-ft (60 N-m) of torque. Verify clearances, system security and band clamp torque after 30-60 miles (50-100 km) of driving.
6. Install and adjust the **Exhaust Tip** to suit. Tighten the lock bolt located on **Exhaust Tip**



Congratulations! You are ready to begin experiencing the improved power, sound and driving experience of your MBRP Inc. performance exhaust system. We are certain that you will enjoy your purchase.