

Rugged Ridge Off-Road Jack Mount Tailgate, JL/JK

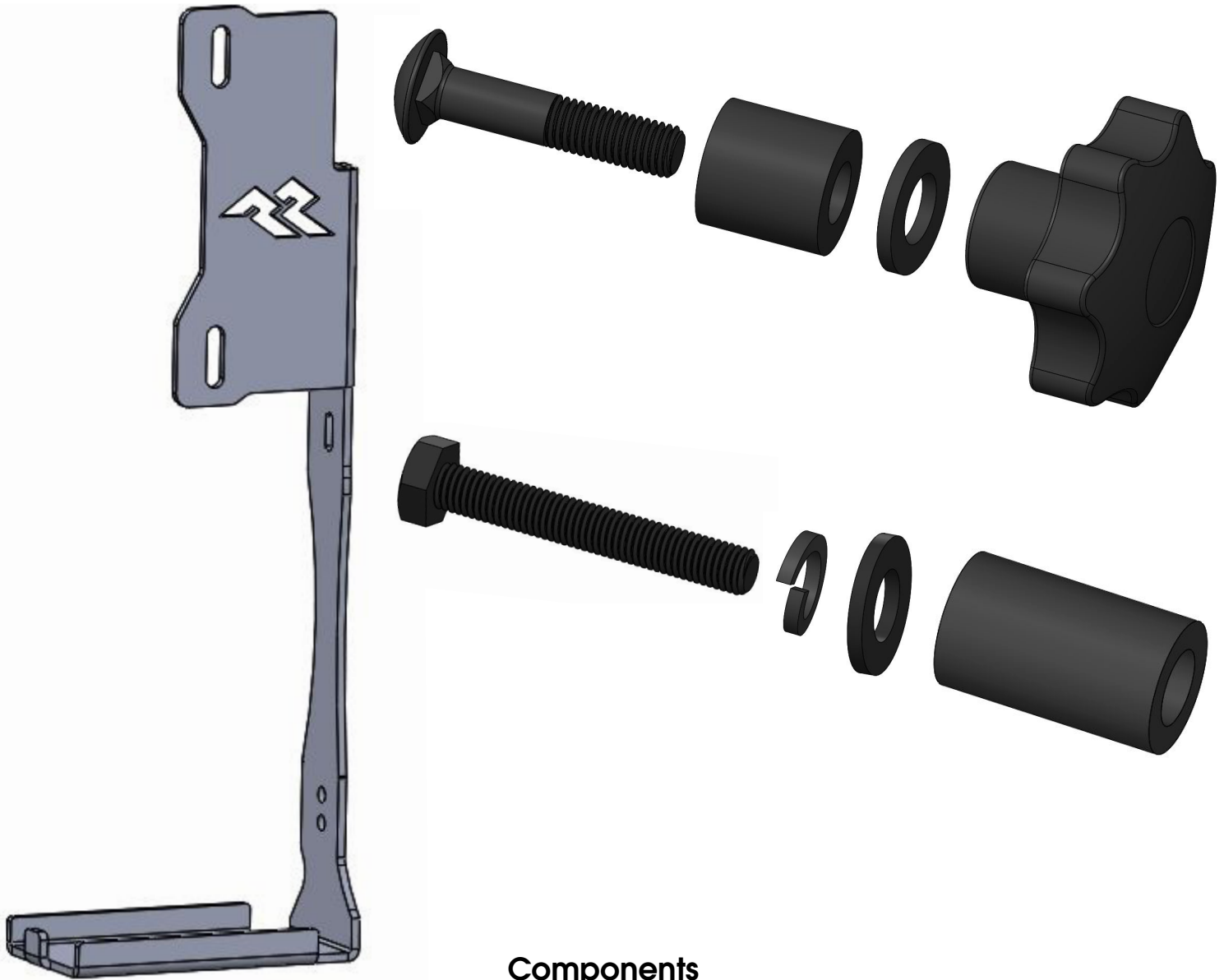

Components

- 1 - Off-Road Jack Mount
- 2 - Hand Knob
- 2 - Rubber Mounts
- 2 - Aluminum Spacers

- 2 - M10 X 70mm Hex Bolts
- 2 - M10 Lock Washer
- 2 - M10 Flat Washer
- 2 - M12 X 60mm Carriage Bolts
- 8 - M12 Flat Washer

OMIX-ADA® TECHNICAL SUPPORT

PHONE: M-F 8am - 5pm EST 1-800-449-6649

FOR WARRANTY OR TECH CONCERNS EMAIL: webmaster@omixsupport.com

ATTN: STATE OF CALIFORNIA CONSUMERS

⚠ WARNING: Cancer and Reproductive Harm - www.P65Warnings.ca.gov.

Rugged Ridge Off-Road Jack Mount Tailgate, JL/JK

STEP 1:

Close tailgate. Remove the two closest button head bolts to the tailgate hinge. These bolts are painted over in most cases. It's suggested to use a razor to cut the paint and clearcoat around the head of the bolt to minimize the paint from chipping or flaking.

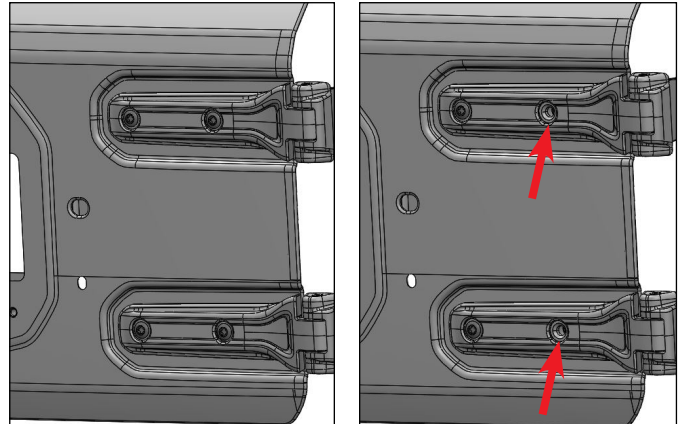

STEP 2:

Bolt on the jack mount using the aluminum spacer, which fits into the divot of the hinge. Then feed the M10 bolt through the M10 lock, flat washer, and in the mount. Thread by hand securing good thread interaction before tightening. Avoid using power or air tools to fully tighten. This is an OE threaded hole, take all means not to strip the threads. Tighten both bolts using hand tools.

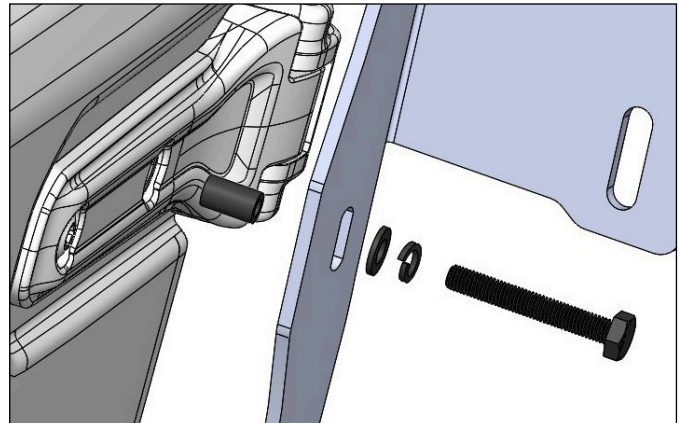

STEP 3:

Place Off-road jack into the mount. Feed the carriage bolt through the hole of the jack that aligns with the slot of the mount. Have the bolt pass through the jack, rubber mount, mount, flat washer and thread into the hand knob.

If the carriage bolt spins in the hole of your off-road jack, spin it around and have the hand knob tighten against the jack instead.

