



## INSTALLATION INSTRUCTIONS

# 2018 JEEP® WRANGLER JL® COWL MOUNT



PRODUCT INCLUDES:

(2) Mount #41656

\* LIGHTS SOLD SEPARATELY

**\*THIS MOUNT FITS THE FOLLOWING LIGHTS:**

**(2) D-Series PRO®, (2) D-SS Series PRO®, (2) IGNITE®, (2)D-XL PRO®**

### **IMPORTANT**

**THANK YOU FOR PURCHASING RIGID PRODUCTS FOR YOUR VEHICLE.**

Please read through all of these Instructions and tips before proceeding with the installation.

We do our best to provide a simple installation process for all applications however a professional installation is always recommended.

**Always disconnect any power sources connected to your vehicle  
before servicing fuses or electrical systems.**

## NOTE:

The system includes 2 cowl mounting plates, 2 short light stands, and all necessary hardware. These mounts are designed to be configured in numerous ways and configurations, including adding a 2nd or 3rd pairs of lights. These will accept any D-Series, D-SS, Ignite, or DXL's.

## STEP 1

Begin by removing the 3 factory Torx bolts from the cowl side piece as shown in Figure 1. Set aside if desired, as they will not be required for this install.

See Figure 1

FIGURE 1

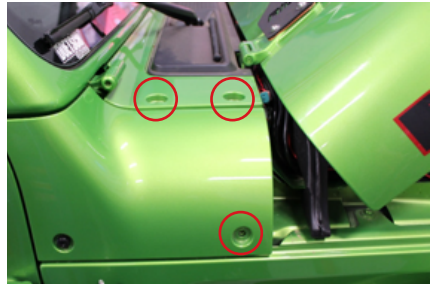

## STEP 2

Continue by attaching the light stands onto the plates as shown in Figure 2. This needs to be done while the plates are off the vehicle. Use the 5/16-18" button head screw and external lock washers. Configuration is up to the user. There are notches cut into the adjustment slots to assist with ensuring the side-to-side alignment is consistent while installing the lights off the vehicle. With the lights positioned outboard, utilization of the folding windshield can be kept. Install with flat face of stands towards the front of the vehicle (See Figure 1).

See Figures 2 & 2.1

FIGURE 2



FIGURE 2.1



### STEP 3

Install the mount plates onto the vehicle using the (2) extra-long M6 button head screws and washers on the top, and (1) long M8 button head screw on the side. Be sure to install the rubber misalignment washers under the washers to account for the slight variation in angle between the bolt and plate. The spacers are cut at a best fit angle to accommodate the various angles found on the 3 mounting surfaces of the cowl. The flat cut interfaces with the cowl, while the angle cut face mounts against the plate.

See Figure 3

FIGURE 3

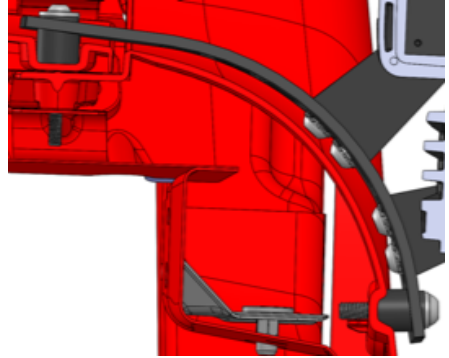

### STEP 4

Complete installation by installing the lights onto the stands as shown in Figure 4. Use the 5/16" hex bolts and washers to mount the light brackets to stands. Your installation is now complete!

See Figure 4

FIGURE 4



You may further customize your new JL Cowl mounts by installing either of our Tall or Short Standoff kits (41657 & 41658) available separately.

**Wiring: Wire your lights according to the instructions included with the light.  
Take care to avoid any heat sources and sharp or abrasive surfaces.**

**Your installation is now complete.  
Welcome to the Rigid Nation!**

---

---

## **WARRANTY INFORMATION**

For warranty information, visit [www.rigidindustries.com/about/warranty](http://www.rigidindustries.com/about/warranty)

779 N Colorado St, Gilbert, AZ 85233 • 855-760-5337  
[www.rigidindustries.com](http://www.rigidindustries.com)

D-Series PRO, D-SS Series PRO, IGNITE, D-XL PRO, RIGID, and Rigid Industries are registered and/or common law marks owned by JST Performance, LLC, a Delaware limited liability company d/b/a Rigid Industries.

11-12918-A