

ROUGH COUNTRY

SUSPENSION SYSTEMS®

FORD 2021 Bronco Rear Tire Carrier Relocation

Thank you for choosing Rough Country for all your vehicle needs.

Please read instructions before beginning installation. Check the kit hardware against the kit contents shown below. Be sure you have all needed parts and know where they go.

If question exist, please call us @1-800-222-7023. We will be happy to answer any questions concerning this product. Check all fasteners for proper torque. Check to ensure for adequate clearance between all components. Periodically check all hardware for tightness.

Kit Contents:

Spare Tire Relocation Bracket x1

Tools Needed:

13mm Socket/Wrench
1/2" Socket/Wrench

Hardware Included:

5/16" x 1.25" Bolts x8
5/16" Flat Washers x8
5/16" Lock Nuts x8



Torque Specs:

Size	Grade 5	Grade 8	Size	Class 8.8	Class 10.9
5/16"	15 ft/lbs	20ft/lbs	6MM	5ft/lbs	9ft/lbs
3/8"	30 ft/lbs	35ft/lbs	8MM	18ft/lbs	23ft/lbs
7/16"	45 ft/lbs	60ft/lbs	10MM	32ft/lbs	45ft/lbs
1/2"	65 ft/lbs	90ft/lbs	12MM	55ft/lbs	75ft/lbs
9/16"	95 ft/lbs	130ft/lbs	14MM	85ft/lbs	120ft/lbs
5/8"	135ft/lbs	175ft/lbs	16MM	130ft/lbs	165ft/lbs
3/4"	185ft/lbs	280ft/lbs	18MM	170ft/lbs	240ft/lbs



INSTALLATION INSTRUCTIONS

1. Remove the spare tire from the carrier.
2. Remove the plastic cover from the inside of the gate. **See Photo 1.**
3. Unplug the brake light and camera wires. **See Photo 2.**

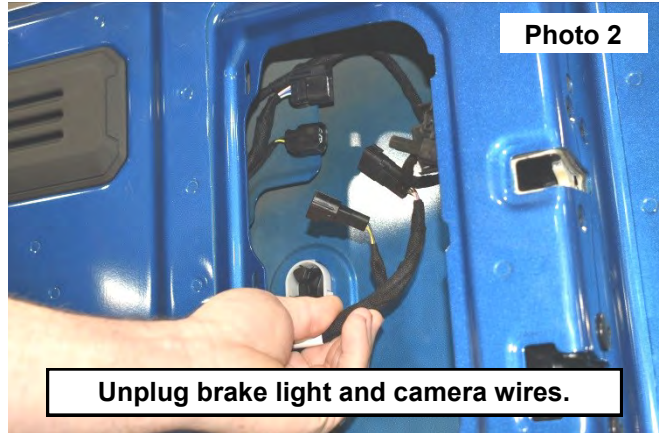

4. Remove the wire grommet from the door by pushing on the tabs. **See Photo 3.**
5. Pull the wires through the door. **See Photo 4.**

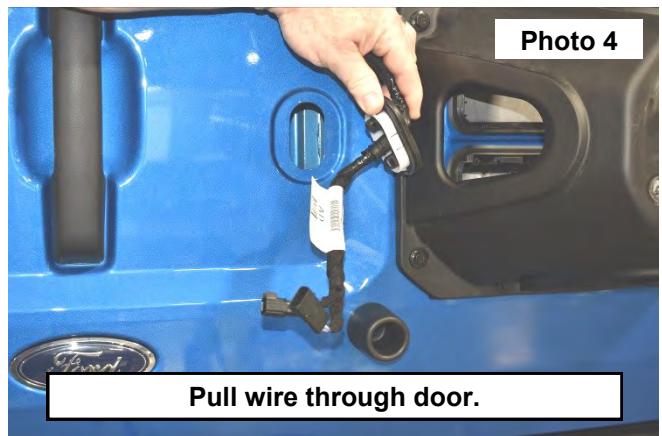
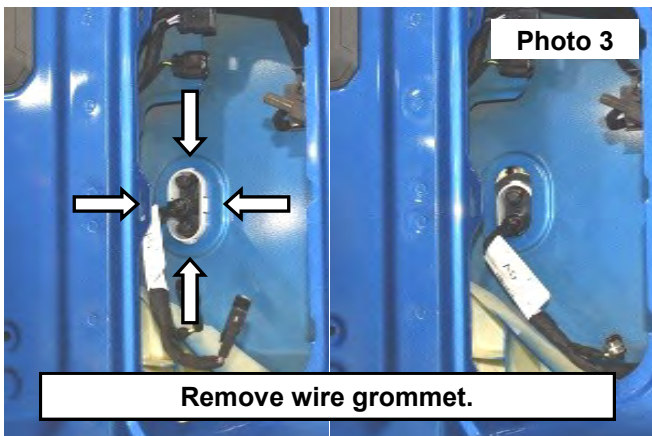

6. Remove the 8 bolts on the spare tire carrier using a 13mm socket/wrench. **See Photo 5.**
7. Install the new spare tire relocation bracket using the stock bolts. **See Photo 6.**

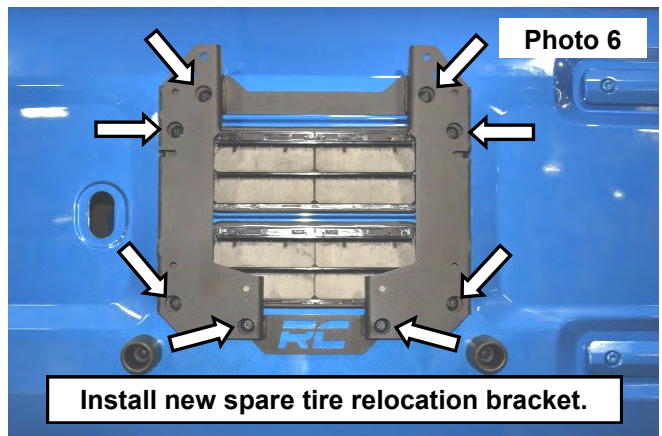
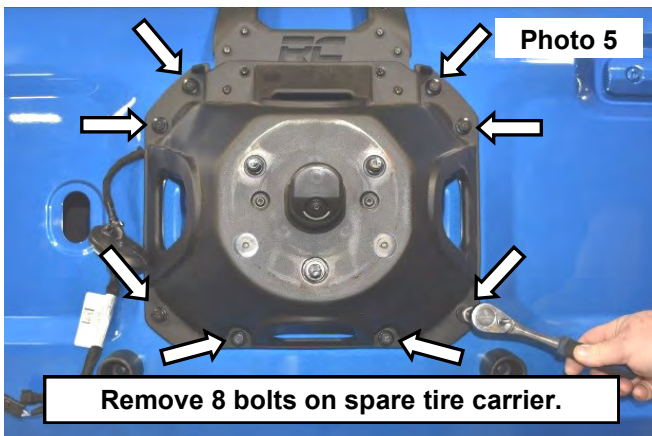

8. Remove the wiring harness from the cutout in the stock carrier and remove one clip for slack. **See Photo 7.**
9. Install the stock carrier on the relocation bracket using the supplied 5/16" hardware using two 1/2" socket/wrenches. **See Photo 8. NOTE: Reinstall wiring harness in the cutout so the wire is not pinched.**

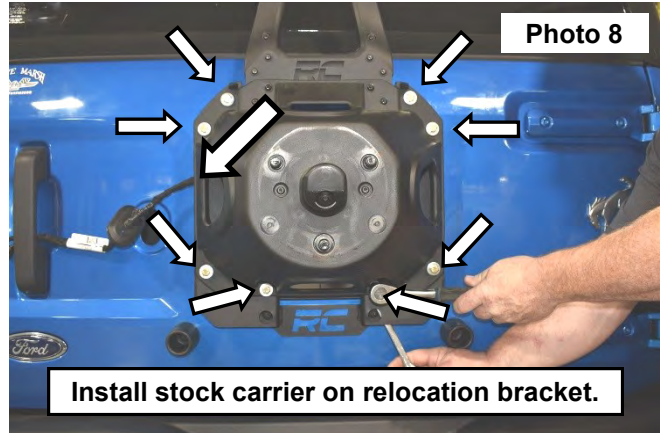
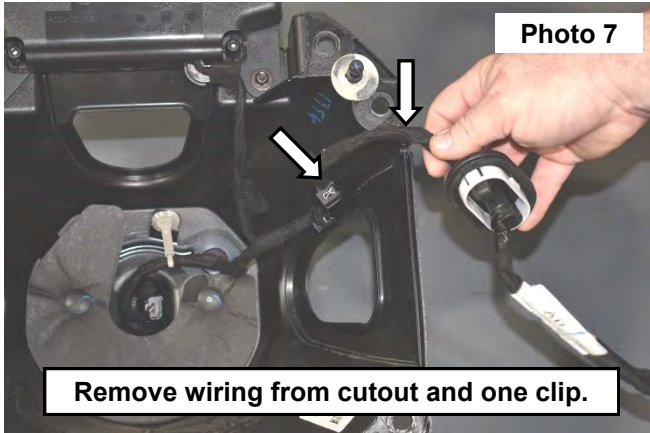

10. Reinstall the wiring grommet in the door and reconnect the brake light and camera wires.
11. Install the spare tire.



By purchasing any item sold by Rough Country, LLC, the buyer expressly warrants that he/she is in compliance with all applicable, State, and Local laws and regulations regarding the purchase, ownership, and use of the item. It shall be the buyers responsibility to comply with all Federal, State and Local laws governing the sales of any items listed, illustrated or sold. The buyer expressly agrees to indemnify and hold harmless Rough Country, LLC for all claims resulting directly or indirectly from the purchase, ownership, or use of the items.

