

ROUGH COUNTRY

SUSPENSION SYSTEMS®

22 - Up Tundra Electric Air Dam Delete

Thank you for choosing Rough Country for all of your suspension needs.

Rough Country recommends that a certified technician install this system. In addition to these instructions, professional knowledge of disassemble/reassembly procedures as well as post installation checks must be known. Attempts to install this system without this knowledge and expertise may jeopardize the integrity and/or operating safety of the vehicle. Please read all the instructions before beginning the installation. Check the kit hardware against the "Kit Contents" list below. If question exist, please call us @1-800-222-7023. We will be happy to answer any questions concerning this product. Check all fasteners for proper torque. Check to ensure for adequate clearance between all components. Check and retighten wheels at 50 miles and again at 500 miles. Periodically check all hardware for tightness. Be sure you have all the needed parts and understand where they go. Also, please review the "Tools Needed" list to be certain you have the necessary tools to complete the installation.

NOTICE TO DEALER AND VEHICLE OWNER

⚠ WARNING Any vehicle equipped with any Rough country product must have the "Warning to Driver" decal installed on the sun visor or dash. The decal is to act as a constant reminder for whoever is operating the vehicle of its unique handling characteristics. **INSTALLING DEALER**—It is your responsibility to install the warning decal and to forward these installation instructions on too the vehicle owner for review and to be kept in the vehicle for its service life.



22 - Up Tundra Electric Air Dam Delete

TOOLS NEEDED:
Phillips Head Screwdriver
10mm Wrench/Socket

Gasket Maker
Super Glue

KIT CONTENTS:
Backing Plate Bracket

HARDWARE INCLUDED:
10-24 Bolt (8)
10-24 Nut (8)
1" P-Clamp (1)



Electric Air Dam Delete Installation

1. Photo 1 shows the electric air dam assembly removed from the air dam and bumper. **Photo 1**
2. Remove the 7 Phillips Head screws from the motor cover. **Photo 2**

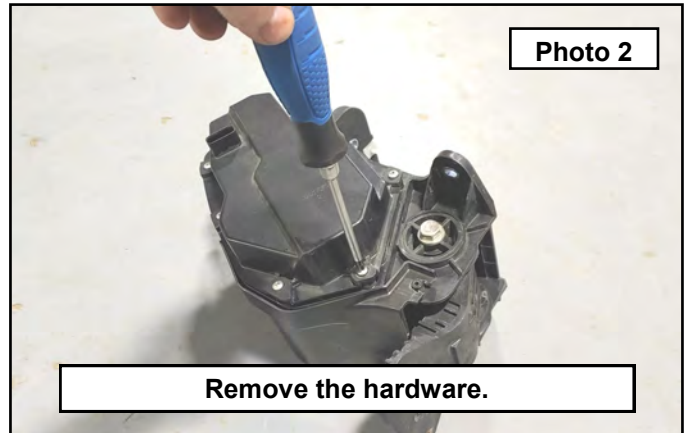
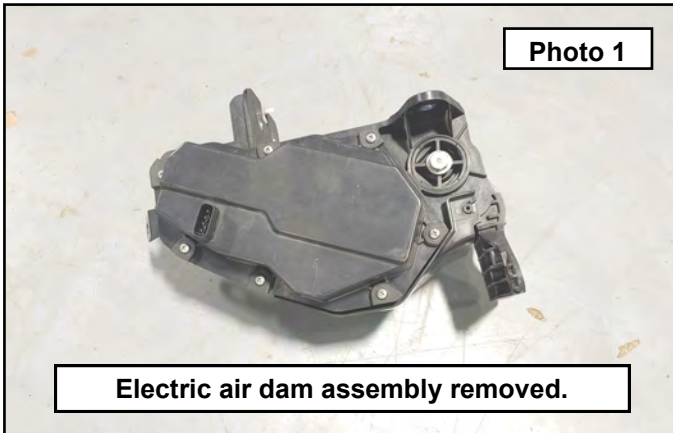

3. Remove the motor cover from unit. **Photo 3**
4. Remove the Phillips Head screw from the electrical connector. Lift electrical connector off housing. **Photo 4**

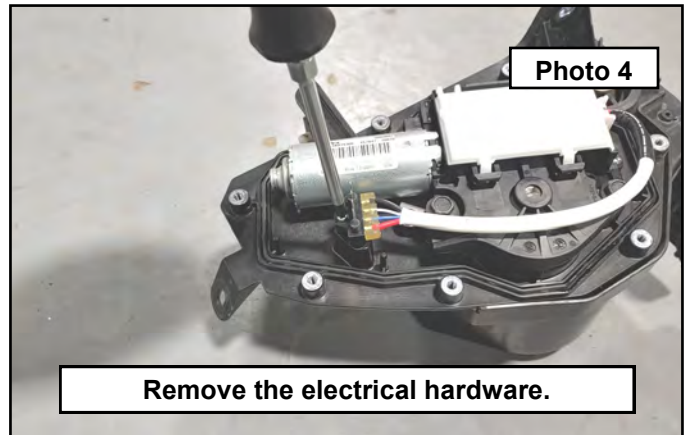
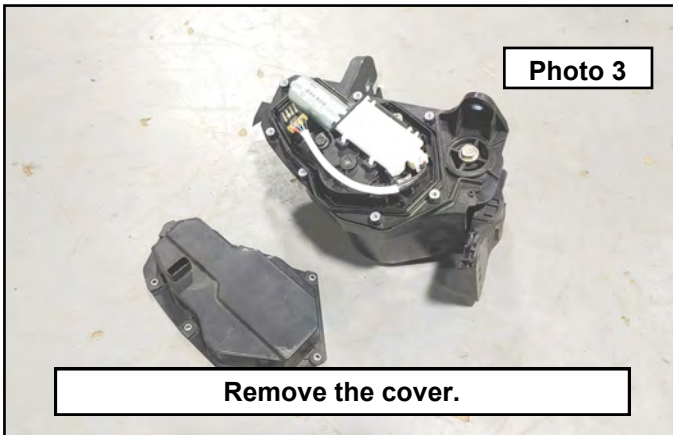

5. Remove the electric motor assembly hardware using a 10mm socket. **Photo 5**
6. Remove the electric motor assembly from the unit. **Photo 6**

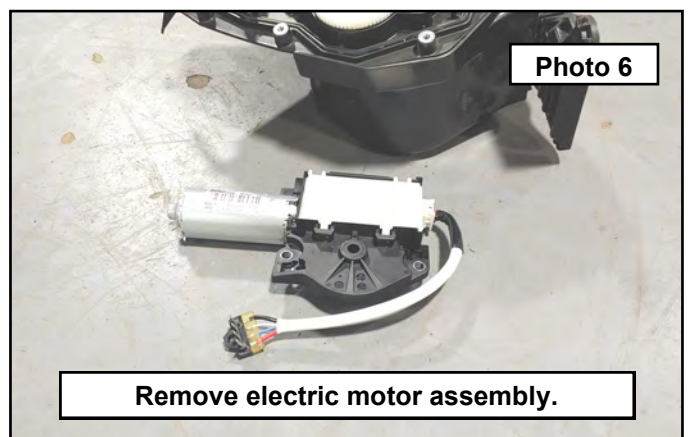
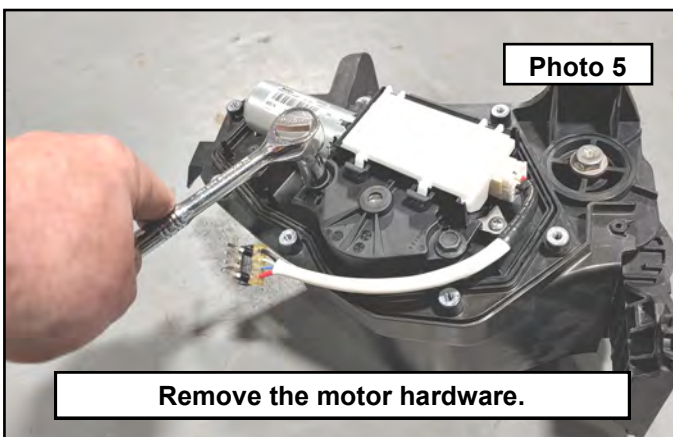

7. Install the electrical connector into the housing and secure using some super glue to keep it in place. **Photo 7**
8. Install the motor assembly into the housing as shown. This will be loose until the new backing plate is installed. **Photo 8**

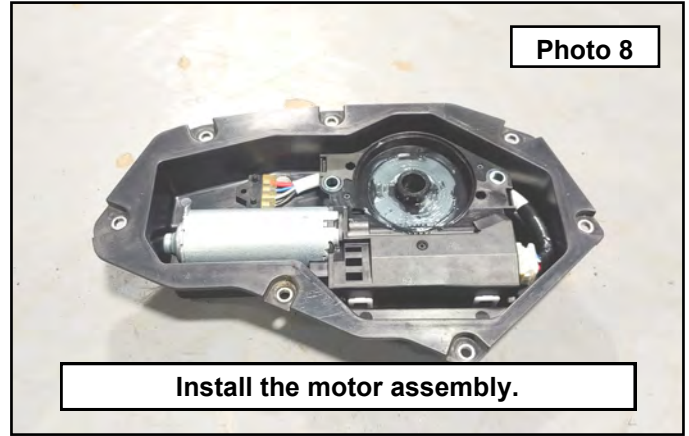

9. Apply a small bead of gasket maker around the lip of the housing. **Photo 9**
10. Install the new backing plate bracket to the housing using the provided bolts and nuts. Only hand tighten the hardware. **Photo 10**

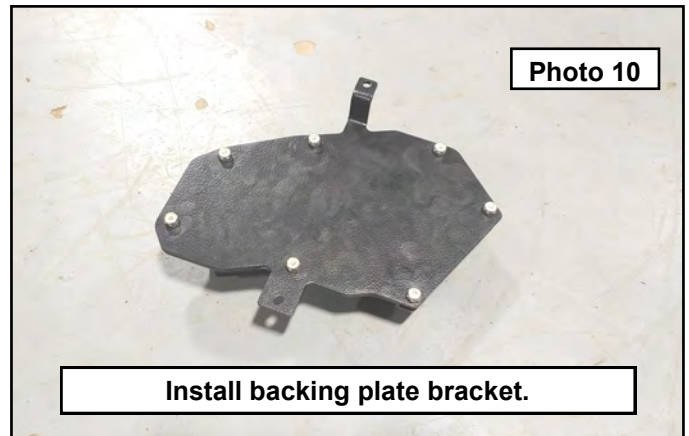
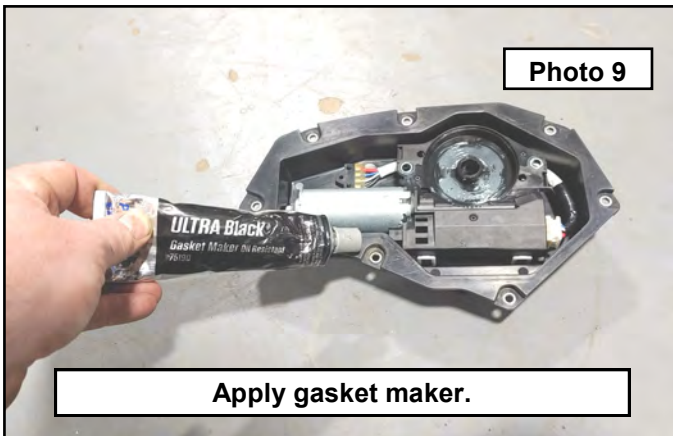

11. Locate the coolant hose bracket in the middle of the core support. Remove the hose from the plastic retainer. **Photo 11**
12. Remove the bracket from the core support using a 10mm wrench. **Photo 12**

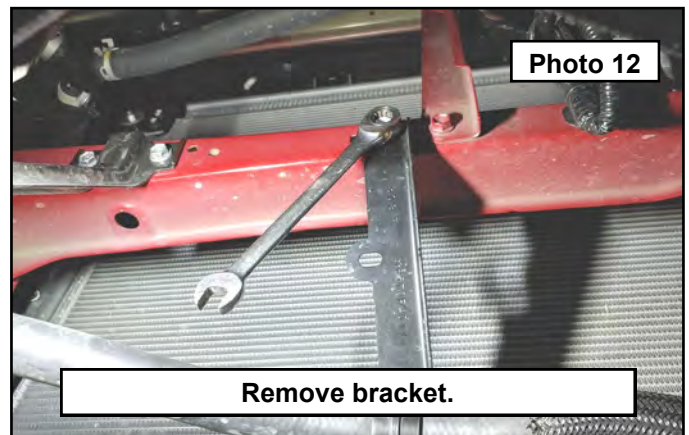
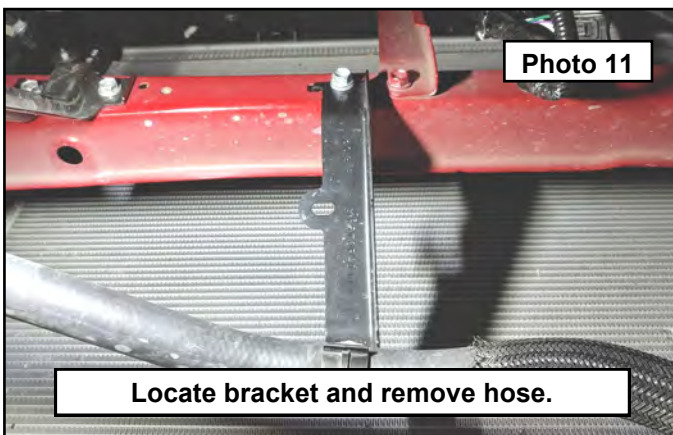

13. Install the assembled unit to the core support using the previously removed hardware and plug in electrical connector. **Photo 13**
14. Install the 1" P-Clamp as shown using the provided hardware. **Photo 14**

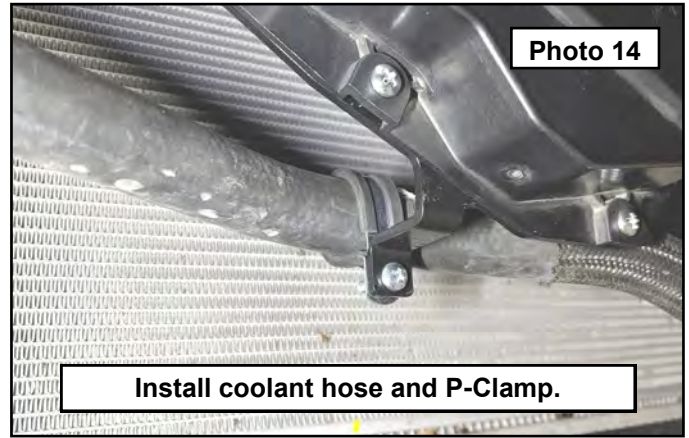

By purchasing any item sold by Rough Country, LLC, the buyer expressly warrants that he/she is in compliance with all applicable , State, and Local laws and regulations regarding the purchase, ownership, and use of the item. It shall be the buyers responsibility to comply with all Federal, State and Local laws governing the sales of any items listed, illustrated or sold. The buyer expressly agrees to indemnify and hold harmless Rough Country, LLC for all claims resulting directly or indirectly from the purchase, ownership, or use of the items.