

SKYJACKER

SUSPENSIONS

SKYJACKER.COM

2023 > Ford F250 Super Duty 4WD
 2023 > Ford F350 Super Duty 4WD
 Onboard Scales / Auto-Leveling
 Headlight Bracket
 Installation Instructions

Required Tools List:

- Metric Hex Key & Sockets \ Wrenches (8mm, 13mm, & 17mm)
- Torque Wrench



Before beginning the installation, read these instructions thoroughly & completely. Please refer to the Parts List to insure that all parts & hardware are received prior to disassembly of the vehicle. If any parts are found to be missing, contact SKYJACKER® Customer Service at 318-388-0816 to obtain the needed items. If you have any questions or reservations about installing this product, contact SKYJACKER® Technical Assistance at 318-388-0816.

Important Notes:

- Fits Models With Onboard Scales / Auto Leveling Headlight Option.
- Fits Models With OEM Radius Arms Only.
- Fits Models With 2.0-2.5 Inches Of Lift Height.

Kit Box Breakdown:

Part # F2325HLE

Item #	Description	Qty
F2325HLE-D	HEADLIGHT EXT BRKT, DR	1
F2325HLE-P	HEADLIGHT EXT BRKT, PA	1
HB-F23HLE	HDWR BAG: HEADLIGHT BRKT.	1

Hardware Bag Breakdown:

Part # HB-F23HLE

Item #	Description	Qty
10X20MMB	10MM X 20MM METRIC BOLT	2
10MMN	10MM NYLON INSERT LOCK NUT	2
38SAEW	3/8 SAE WASHER	4

Installation: **Note:** Save all factory components & hardware for reuse, unless noted.

1. Chock rear tires \ wheels. Ensure that vehicle transmission is in PARK & engage emergency brake. **Note:** Be sure steering wheel \ wheels are pointing straight forward.

Note: Ford's onboard scale with smart hitch monitoring system option attaches on each side of the vehicle. Upper OEM headlight sensors are located at "A" frame mount with a linkage pivot arm connected to a linkage mounting bracket on OEM radius arm. (Photo # 1)

CAUTION: Upper OEM Headlight Sensors & Pivot Arms Are Fragile. Handle with Care During Disassembly & Installation.



Note: Perform Steps 2-3 on One Side at a Time.

2. First, disconnect OEM linkage pivot arm from OEM mounting bracket on radius arm using an 8mm socket \ wrench. (Photo # 2)

Next, remove OEM linkage mounting bracket from OEM radius arm using a 13mm socket \ wrench. (Photo # 2)

3. **Note:** Skyjacker Headlight Extension Brackets Are Side Specific. # F2325HLE-D Driver & # F2325HLE-P Passenger.

First, connect OEM linkage pivot arm mounting bracket to appropriate Skyjacker Headlight Extension Bracket with supplied 10mm x 20mm Bolt with 3/8" SAE Washer from inside-to-outside. Attach brackets together on outside with supplied 3/8" SAE Washer & 10mm Nylon Insert Lock Nut using a 17mm socket \ wrench. (Photo # 3)

Second, attach Skyjacker \ OEM bracket assembly onto OEM radius arm mounting position with OEM hardware using a 13mm socket \ wrench. (Photo # 3) Torque 16 ft-lbs.

Third, attach OEM linkage pivot arm to OEM radius arm mounting bracket using an 8mm socket \ wrench. (Photo # 3)

Tighten 10mm hardware. Torque 32 ft-lbs.

Tighten 8mm hardware. Torque 106 in-lbs.

Note: Perform Steps 2-3 on Opposite Side Now.

Final Notes:

- After installation is complete, double check that all nuts & bolts are tight.
- With vehicle placed on ground, cycle steering lock to lock & inspect steering, suspension for proper operation, tightness & adequate clearance.
- After first 100 miles, check all hardware for proper torque & periodically thereafter.

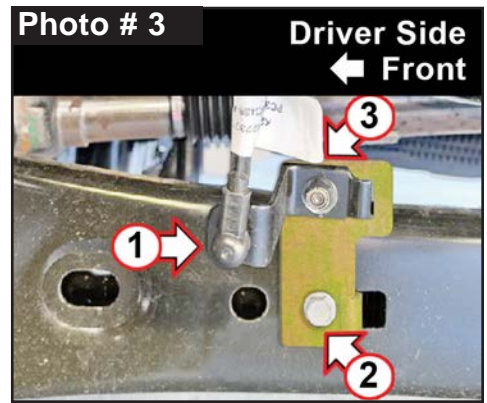
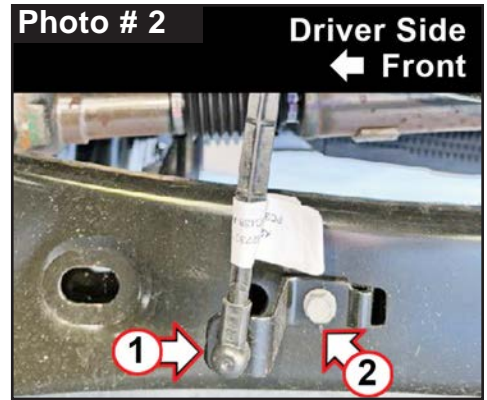

TORQUE SPECIFICATIONS					
INCH SYSTEM			METRIC SYSTEM		
Bolt Size	Grade 5	Grade 8	Bolt Size	Class 8.8	Class 10.9
5/16	180 in-lbs	240 in-lbs	6MM	102 in-lbs	108 in-lbs
3/8	30 ft-lbs	35 ft-lbs	8MM	16 ft-lbs	23 ft-lbs
7/16	45 ft-lbs	60 ft-lbs	10MM	32 ft-lbs	45 ft-lbs
1/2	65 ft-lbs	90 ft-lbs	12MM	55 ft-lbs	75 ft-lbs
9/16	95 ft-lbs	130 ft-lbs	14MM	85 ft-lbs	120 ft-lbs
5/8	135 ft-lbs	175 ft-lbs	16MM	130 ft-lbs	165 ft-lbs
3/4	185 ft-lbs	280 ft-lbs	18MM	170 ft-lbs	240 ft-lbs

Above Specifications Are Not to Be Used When Bolt Is Being Installed With a Bushing.

Seat Belts Save Lives, Please Wear Your Seat Belt.