

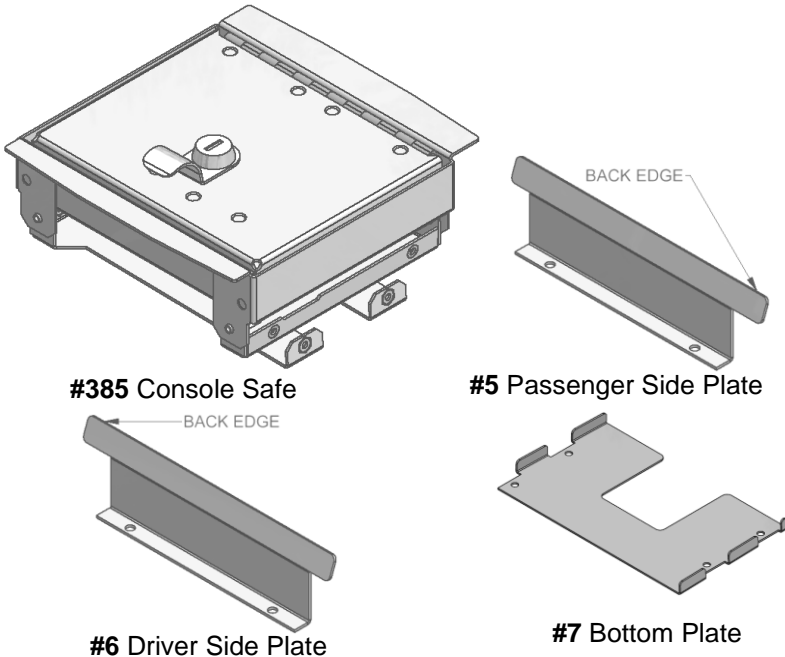


# INSTALLATION INSTRUCTIONS

Console Safe #385 for Ford Bronco

Please read and fill out the enclosed warranty registration card or register online at <https://tuffypromts.com/help/warranty-information/warranty-registration/> to activate your warranty.

## PARTS CHECKLIST



## SHIPPING PACKAGE CHECKLIST

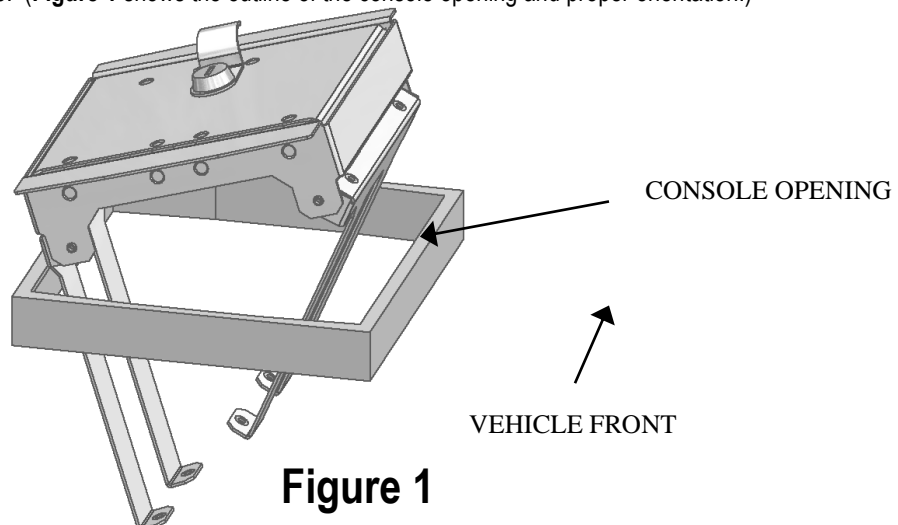


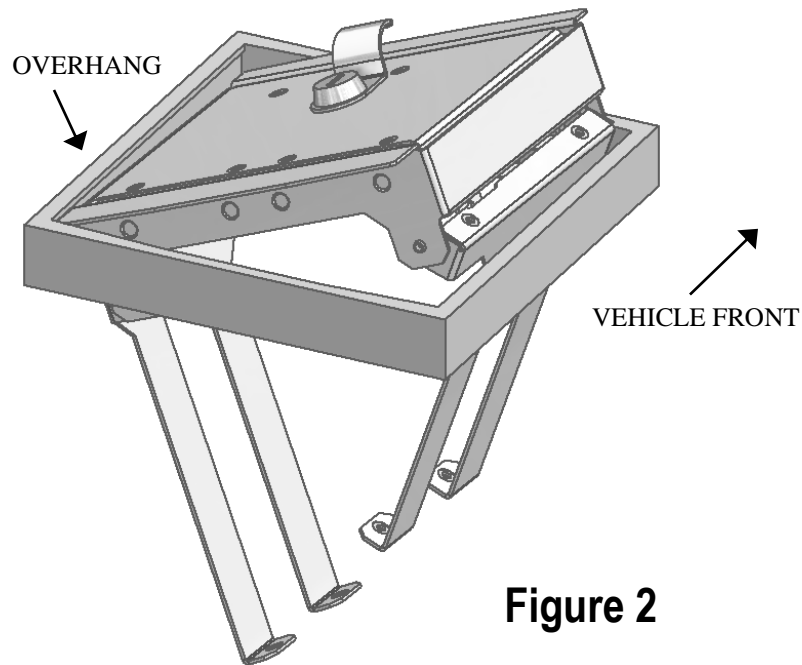
## TOOLS CHECKLIST

- Phillips Head Screwdriver
- 5/32" Hex Wrench
- 7/16" End Wrench

### **PLEASE READ ALL INSTRUCTIONS THOROUGHLY BEFORE STARTING INSTALLATION.**

1. Remove all contents from the shipping box and confirm that you have all of the components listed above.
2. Open the factory console lid and remove all contents (including the pad in the bottom of the console).
3. Place the Console Safe into the console on edge diagonally, with the upper surface of the Console Safe facing the driver side and the lock/finger pull to the front of the vehicle. (Figure 1 shows the outline of the console opening and proper orientation.)

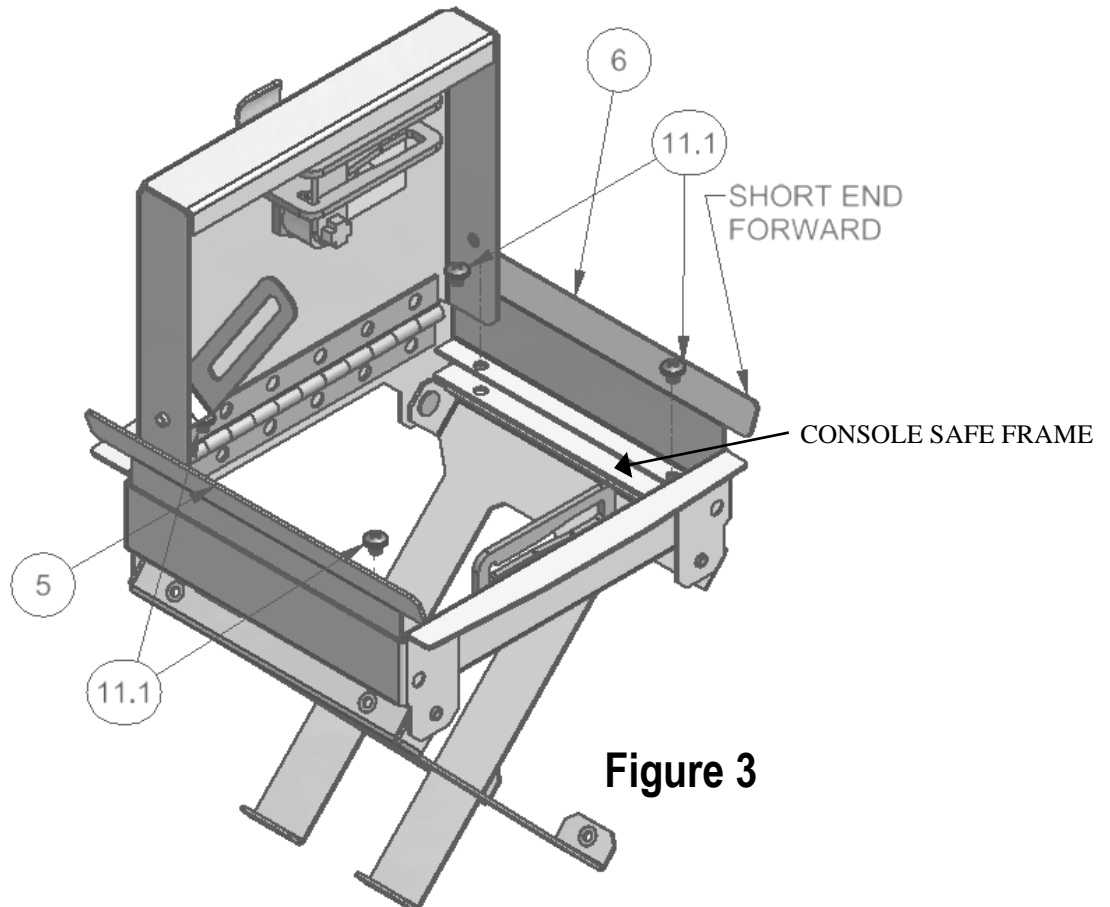




**Figure 2**

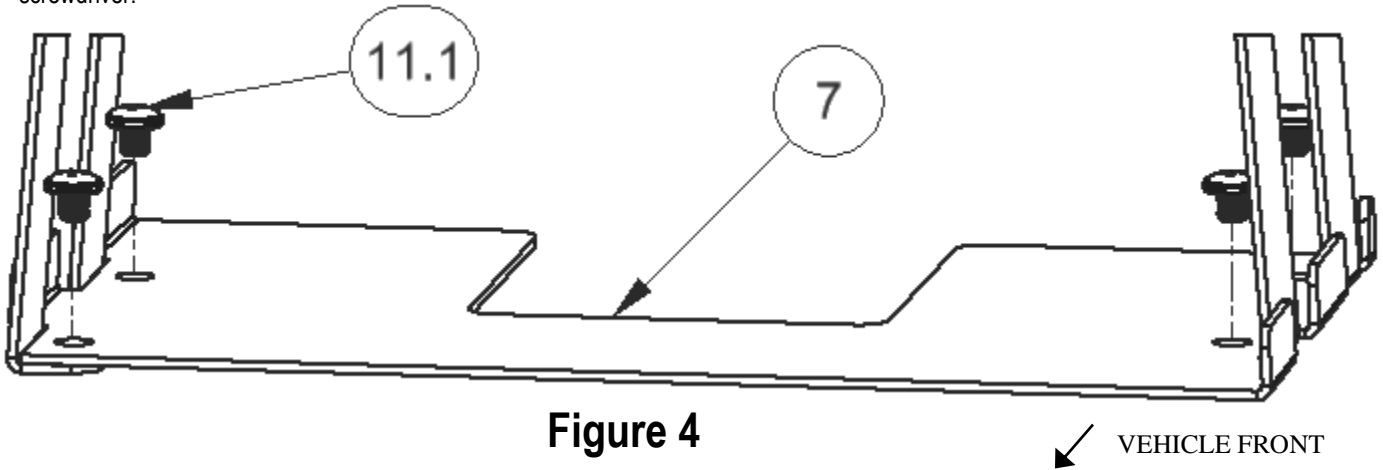
Keep the Console Safe in this orientation while you move it down into the console. Once the left edge is inside the console, push it underneath the overhang and continue to move the Console Safe down. See **Figure 2**. The fit is quite tight and may require a second effort at a slightly different angle. The Console Safe should now be resting on the bottom of the console with the logo facing up.

4. Open the Console Safe Lid and install the #5 Passenger and #6 Driver Plates between the console safe frame and lid frame. It will be easier to insert the Plates with the legs only partially unfolded. Fold the legs out completely then install the (4) #11.1 Machine Screws. See **Figure 3**. The Plates should be pushing up against the overhang of the console opening.



**Figure 3**

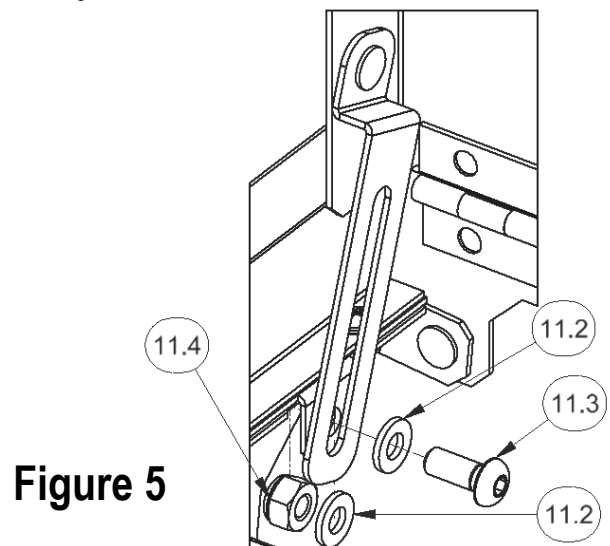
5. With the lid open, lift the main body of the Console Safe and push the legs out against the interior of the console.
6. Insert the (2) #7 Bottom Plate into the bottom of the console and install them using (4) #11.1 Machine Screws (short), as shown in **Figure 4**.  
NOTE: Due to the angle of the Console Safe legs, it is easiest to start the #11.1 Machine Screws by hand and finish tightening them with a screwdriver.



**Figure 4**

7. Replace contents of console and the pad that was removed in Step 2.
8. Open the lid and assemble the lid support hardware as shown in **Figure 5**. Tighten the hardware in small increments so that the lid remains supported as you require.

Note: Second nylon washer slips between moving slotted part, and stationary body. (#11.2 shown below assembly in **Figure 5**)



**Figure 5**

NOTE: Over time the friction that holds the lid in the open position may be reduced. To increase the friction it is necessary to tighten the assembly. Tighten in small increments and test by opening/closing the lid.

Call (800)348-8339 for Technical Support